

DEC 28 1988

3294

KENTUCKY HISTORIC RESOURCES
Individual Inventory Form

Resource # Be-342
Boone County

1. Name of Resource:
Huey, D. W., House

2. Original Owner:
Unknown

3. Other Names:
None

4. Prehistoric Site Building Object
Historic Site Structure Other

5. Location:
7812 East Bend Road
Burlington, KY

6. Owner's Name:
Gregory Salsbury []

7. Owner's Address:
7812 East Bend Road
Burlington, KY 41005

8. Evaluation: National Register []

9. Recognition & Date:
Nat.Landmark Local Landmark
Nat.Register HABS/HAER
Highway Marker KY Inventory 1977
KY Landmark Certificate

10. N.R.Status & Date:

11. N.R.Group:
District Name: []
Mult.Resource Area: Boone County []
Thematic Name: []

12. Historical Theme:
Primary: Architecture []
Secondary: []
Other: []

13. Statement of Significance:
This property is significant under criterion C as a good example of the Greek Revival style, significant to Boone County in the period 1840-1880, and of the I-house form, significant to Boone County in the period 1840-1900. The house is one of 34 I-houses identified in the county and one of 33 structures identified with primary []

14. History: Greek Revival elements.
The house was built by D. W. Huey. Lewis Conner bought the property in 1868. It stayed in the Conner family passing from father to son until the mid 1900s.

15. Source of historical information and/or contact person:
Conner family letters
Boone County Deed Books

16. Date:
Original Building c. 1840 []
Addition mid-20th c. []

17. Style: Greek Revival []
Federal []

18. Architect/Builder:
Thomas Zane Roberts (attributed)

19. No. of Stories: two []

20. Original Floor Plan: central passage []

21. Single Pile Double Pile N.A.

22. Roof Form & Material: Original
Not Original

23. Structural Material: brick []

24. Exterior Material: common bond brick/stone []

25. Foundation Material: stone []

26. Major Alterations: None
Moved/Rebuilt Other
Additions

27. Special Features:
engaged, fluted Greek Doric columns

28. Outbuildings: []

29. Original Function: farm dwelling []

30. Present Use: dwelling []

31. Condition: excellent []

32. Endangered: Yes
No

33. Attach Photos:
Roll: 9 Photo Nos: 8-21 No. of Slides:

34. Prepared by: Kenneth T. Gibbs

35. Organization: Boone Co. Hist. Pres. Rev. Brd.

36. Date: September 1986

37. New Survey Resurvey

KENTUCKY HISTORIC RESOURCES
 Individual Inventory Form

Resource # Be-342

38. UTM Point of Primary Building: Zone Easting Northing 39. G.I.S. Mod. []
 Quadrant: Rising Sun 16 695860 4316540 40. Coordi.Accuracy []

41. UTM Points of Boundary (for N. R. eligible sites only):

A.	-----	D.	-----
B.	-----	E.	-----
C.	-----	F.	-----

42. Total Acreage in Present Property: 51.47 43. Acreage included in proposed N.R. boundary: 0.688

44. Site Plan (and boundary description and justification for N.R. sites):

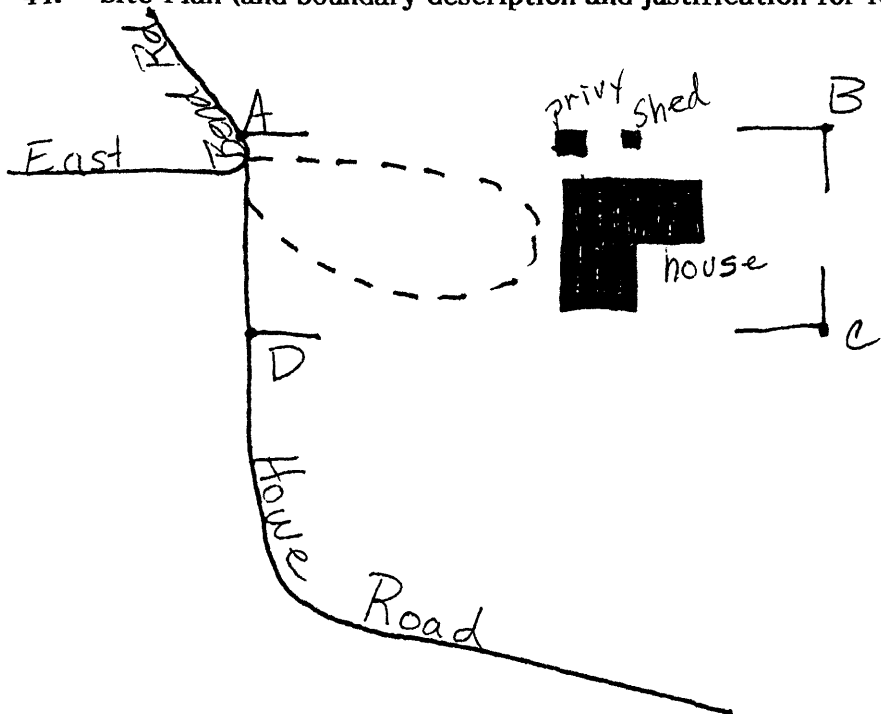

Beginning at a point where the north property line intersects with East Bend Road proceed east 300'. Then proceed south 100' along the fenceline, turning west 300' to the east side of Howe Road. Then proceed north 100' along the east side of Howe Road and then East Bend Road to the point of origin. The boundary includes the house, two outbuildings and the yard area around the house.

Contributing: 3 buildings

45. Description and House Plan:

In form, the two-story, brick, west-facing house is an I-house with a two-room ell, slightly shorter than the main block. In detailing and proportioning, the house blends the Federal and Greek Revival styles. The overall proportions and that of the front door, the jack arches in the basement openings and in the ell, and the style of the cornice all show links to Federal styling, while the use of stone lintels in the facade and, especially, the fluted Greek Doric columns at the front door, show use of Greek Revival sources.

All windows are 6/6 double-hung sash. The front porch, a likely later addition, has a replacement concrete floor. There is a mid-20th century addition constructed in brick and frame in the angle of the ell. The end chimneys in the main block are located in the interior, and the chimney in the ell is located between the two rooms of the ell.

A privy with a pyramidal roof and a shed are located to the north of the house and were erected during the period of significance and contribute to the significance of the property.

DEC 28 1988

3294

KENTUCKY HISTORIC RESOURCES
Individual Inventory Form

Resource # Be-342
Boone County

1. Name of Resource:
Huey, D. W., House

2. Original Owner:
Unknown

3. Other Names:
None

4. Prehistoric Site Building Object
Historic Site Structure Other

5. Location:
7812 East Bend Road
Burlington, KY

6. Owner's Name:
Gregory Salsbury []

7. Owner's Address:
7812 East Bend Road
Burlington, KY 41005

8. Evaluation: National Register []

9. Recognition & Date:
Nat.Landmark Local Landmark
Nat.Register HABS/HAER
Highway Marker KY Inventory 1977
KY Landmark Certificate

10. N.R.Status & Date:

11. N.R.Group:
District Name: []
Mult.Resource Area: Boone County []
Thematic Name: []

12. Historical Theme:
Primary: Architecture []
Secondary: []
Other: []

13. Statement of Significance:
This property is significant under criterion C as a good example of the Greek Revival style, significant to Boone County in the period 1840-1880, and of the I-house form, significant to Boone County in the period 1840-1900. The house is one of 34 I-houses identified in the county and one of 33 structures identified with primary []

14. History: Greek Revival elements.
The house was built by D. W. Huey. Lewis Conner bought the property in 1868. It stayed in the Conner family passing from father to son until the mid 1900s.

15. Source of historical information and/or contact person:
Conner family letters
Boone County Deed Books

16. Date:
Original Building c. 1840 []
Addition mid-20th c. []

17. Style: Greek Revival []
Federal []

18. Architect/Builder:
Thomas Zane Roberts (attributed)

19. No. of Stories: two []

20. Original Floor Plan: central passage []

21. Single Pile Double Pile N.A.

22. Roof Form & Material: Original
Not Original

23. Structural Material: brick []

24. Exterior Material: common bond brick/stone []

25. Foundation Material: stone []

26. Major Alterations: None
Moved/Rebuilt Other
Additions

27. Special Features:
engaged, fluted Greek Doric columns

28. Outbuildings: []

29. Original Function: farm dwelling []

30. Present Use: dwelling []

31. Condition: excellent []

32. Endangered: Yes
No

33. Attach Photos:
Roll: 9 Photo Nos: 8-21 No. of Slides:

34. Prepared by: Kenneth T. Gibbs

35. Organization: Boone Co. Hist. Pres. Rev. Brd.

36. Date: September 1986

37. New Survey Resurvey

KENTUCKY HISTORIC RESOURCES
Individual Inventory Form

Resource # Be-342

38. UTM Point of Primary Building: Zone Easting Northing 39. G.I.S. Mod. []
 Quadrant: Rising Sun 16 695860 4316540 40. Coordi.Accuracy []

41. UTM Points of Boundary (for N. R. eligible sites only):

A.	-----	D.	-----
B.	-----	E.	-----
C.	-----	F.	-----

42. Total Acreage in Present Property: 51.47 43. Acreage included in proposed N.R. boundary: 0.688

44. Site Plan (and boundary description and justification for N.R. sites):

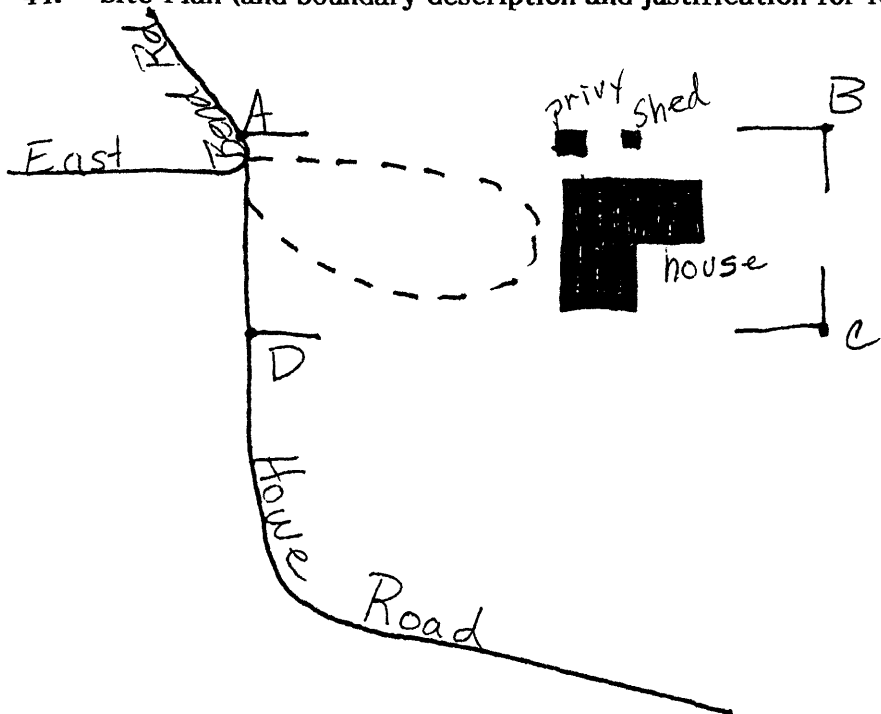

Beginning at a point where the north property line intersects with East Bend Road proceed east 300'. Then proceed south 100' along the fenceline, turning west 300' to the east side of Howe Road. Then proceed north 100' along the east side of Howe Road and then East Bend Road to the point of origin. The boundary includes the house, two outbuildings and the yard area around the house.

Contributing: 3 buildings

45. Description and House Plan:

In form, the two-story, brick, west-facing house is an I-house with a two-room ell, slightly shorter than the main block. In detailing and proportioning, the house blends the Federal and Greek Revival styles. The overall proportions and that of the front door, the jack arches in the basement openings and in the ell, and the style of the cornice all show links to Federal styling, while the use of stone lintels in the facade and, especially, the fluted Greek Doric columns at the front door, show use of Greek Revival sources.

All windows are 6/6 double-hung sash. The front porch, a likely later addition, has a replacement concrete floor. There is a mid-20th century addition constructed in brick and frame in the angle of the ell. The end chimneys in the main block are located in the interior, and the chimney in the ell is located between the two rooms of the ell.

A privy with a pyramidal roof and a shed are located to the north of the house and were erected during the period of significance and contribute to the significance of the property.