

~~MASSACHUSETTS HISTORICAL COMMISSION~~
~~291 WASHINGTON STREET, BOSTON, MA 02108~~

COMMONWEALTH OF MASSACHUSETTS
MASSACHUSETTS HISTORICAL COMMISSION
80 BOYLSTON STREET
BOSTON, MASSACHUSETTS 02116

Town Arlington, MA

Address 69 Oakland Avenue

Historic Name Taylor-Dallin House

Use: Present Residential

Original Residential

DESCRIPTION:

Date ca. 1898

Source Arlington maps & directories

Style Colonial Revival/Shingle Style

Architect Unknown

Exterior wall fabric Shingle

Outbuildings None

Major alterations (with dates) None

Moved No Date N/A

Approx. acreage less than one acre

Setting The house rests on a corner lot at Cliff Street and Oakland Avenue.

UTM: 19/320720/4698480

PHOTO: (3x3" or 3x5", black & white)
staple to left side of form

Photo number _____

SKETCH MAP

Show property's location in relation to nearest cross streets and/or geographical features. Indicate all buildings between inventoried property and nearest intersection. Indicate north.

See attached map

Recorded by Betsy Friedberg

Organization Mass. Historical Commission

Date 8/84

(Staple additional sheets here)

ARCHITECTURAL SIGNIFICANCE (Describe important architectural features and evaluate in terms of other buildings within the community.)

Situated on a rocky, tree-shaded corner lot in Arlington Heights is the home of the American sculptor Cyrus E. Dallin (1861-1944). This commodious structure is covered with dark brown wooden shingles. Its blend of Shingle- and Colonial Revival-style characteristics represents a variation on an often-repeated formula for turn-of-the-century New England suburban houses. Particularly noteworthy is the staircase leading to the verandah and the elegant curved bay that projects from the house's northeast corner. Dallin's studio, a separate building behind the main house, is no longer extant.

HISTORICAL SIGNIFICANCE (Explain the role owners played in local or state history and how the building relates to the development of the community.)

For forty-four years, Cyrus E. Dallin, an internationally acclaimed sculptor, lived in the large residence at the corner of Oakland Avenue and Cliff Street in Arlington Heights. Born in Springville, Utah, in 1861, he began modeling portrait heads from sun-dried clay at the age of seventeen. An exhibition of his works at a local fair impressed a visiting Boston mine owner. Consequently, C. H. Blanchard arranged for Dallin to study under the prominent Boston sculptor Truman Bartlett. He had a second apprenticeship with Sidney H. Morse of Quincy, Massachusetts. In 1882, he opened a studio on Tremont Street in Boston and won a prestigious design competition: his "Equestrian Statue of Paul Revere" was chosen from among the designs of Augustus Saint-Gaudens, Daniel Chester French, and Thomas Ball. Due to controversies surrounding the competition, the Revere statue was not installed behind the Old North Church (NAL 1966) until fifty-six years later.

Study in Paris and a brief return to Utah were followed by Dallin's purchase of 69 Oakland Avenue from Jack Taylor in 1899. From Dallin's studio came "a procession of great works... Tons of clay and piles of scaffolding came and went." By the time of his family's settlement in Arlington Heights, he had already produced works from his most famous sculptural series: his depictions of the North American Plains Indian include "The Signal of Peace" (exhibited at the Chicago World's Fair in 1893), "The Medicine Man," and The Boston Museum of Fine Art's famous "Appeal to the Great Spirit." Since 1914 his "Young Hunter at the Spring" has graced the grounds adjoining Arlington's Robbins Library (NR 1974; Town Center Historic District). Following the designs of the noted Boston architect R. Clipston Sturgis, he modeled the animal figures that decorate the base of the flagpole near Arlington Town Hall (NR 1974; Town Center Historic District). Dallin's other important works include statues of Isaac Newton (Library of Congress, Washington, D.C.), Anne Hutchinson (State

BIBLIOGRAPHY and/or REFERENCES (name of publication, author, date and publisher) continued below...

House Grounds, Boston), and General Hancock (Gettysburg, Pennsylvania). A faculty member of the Massachusetts College of Art for twenty-four years, Dallin also served on the Arlington Planning Board and was a trustee of Arlington's Robbins Library and Symmes Hospital. At his death in 1944, he was eulogized as "The Dean of American Sculptors."

CRITERIA FOR EVALUATION

The Taylor/Dallin House retains integrity of location, design, setting, materials, workmanship, feeling, and association. It meets Criterion B of the National Register of Historic Places for its association with one of Arlington's most prominent turn-of-the-century citizens.

BIBLIOGRAPHY

Cyrus E. Dallin: Let Justice Be Done by Rell G. Francis
1875 Beers & Co. Atlas
1884 Bird's Eye View of Arlington, Arlington Advocate
1898 Stadley & Co. Atlas
1923 Sanborn Map Co. Atlas
Arlington Directories of 1869/70, 1883, 1890, 1898, 1923

NATIONAL REGISTER OF HISTORIC PLACES
EVALUATION/RETURN SHEET

Taylor-Dallin House (Arlington MRA)
Middlesex County
MASSACHUSETTS

Working No. MAR 6 1985
Fed. Reg. Date: _____
Date Due: 4/4/85 - 4/20/85
Action: ACCEPT
RETURN 4-18-85
REJECT
Federal Agency: _____

- resubmission
- nomination by person or local government
- owner objection
- appeal

Substantive Review: sample request appeal NR decision

Reviewer's comments:

Recom./Criteria _____
Reviewer _____
Discipline _____
Date _____
_____ see continuation sheet

Nomination returned for: technical corrections cited below
 substantive reasons discussed below

1. Name

2. Location

3. Classification

Category	Ownership	Status	Present Use
	Public Acquisition	Accessible	

4. Owner of Property

5. Location of Legal Description

6. Representation in Existing Surveys

Has this property been determined eligible? yes no

7. Description

- | | | | |
|------------------------------------|---------------------------------------|------------------------------------|---|
| Condition | | Check one | Check one |
| <input type="checkbox"/> excellent | <input type="checkbox"/> deteriorated | <input type="checkbox"/> unaltered | <input type="checkbox"/> original site |
| <input type="checkbox"/> good | <input type="checkbox"/> ruins | <input type="checkbox"/> altered | <input type="checkbox"/> moved date _____ |
| <input type="checkbox"/> fair | <input type="checkbox"/> unexposed | | |

Describe the present and original (if known) physical appearance

- summary paragraph
- completeness
- clarity
- alterations/integrity
- dates
- boundary selection

8. Significance

Period _____ Areas of Significance—Check and justify below

Specific dates _____ Builder/Architect _____

Statement of Significance *(in one paragraph)*

- summary paragraph
- completeness
- clarity
- applicable criteria
- justification of areas checked
- relating significance to the resource
- context
- relationship of integrity to significance
- justification of exception
- other

Taylor (Lillian) House (Arlington, VA)
 National Historic Landmark
 National Park Service
 Department of the Interior

9. Major Bibliographical References

10. Geographical Data

Acreage of nominated property _____

Quadrangle name _____

UTM References _____

Verbal boundary description and justification _____

11. Form Prepared By

12. State Historic Preservation Officer Certification

The evaluated significance of this property within the state is:

____ national ____ state ____ local

State Historic Preservation Officer signature _____

title _____ date _____

13. Other

- Maps *map used to define boundaries unclear - scale covered over.*
- Photographs
- Other

Questions concerning this nomination may be directed to _____

Signed *D. Byers* Date *4/18/85* Phone: _____

**United States Department of the Interior
National Park Service**

**National Register of Historic Places
Inventory—Nomination Form**



Continuation sheet

Item number

Page

Multiple Resource Area
Thematic Group

Name Arlington Multiple Resource Area
State Middlesex County, MASSACHUSETTS

Nomination/Type of Review

Date/Signature

41. Russell Common

Entered in the
National Register

for Keeper Melora Byers 4/18/85

Attest

42. Shattuck, Ralph W., House

Entered in the
National Register

for Keeper Melora Byers 9/27/85

Attest

43. Sterling-Cutter, Ella
Mahalla, House

Entered in the
National Register

for Keeper Melora Byers 4/18/85

Attest

44. Swadkins, Thomas, House

Entered in the
National Register

for Keeper Melora Byers 4/18/85

Attest

45. Swan, Henry, House

Entered in the
National Register

for Keeper Melora Byers 9/27/85

Attest

46. Symmes, Jr., Stephen, House

Entered in the
National Register

for Keeper Melora Byers 4/18/85

Attest

47. Taylor-Dallin House

Entered in the
National Register

for Keeper Melora Byers 9/27/85

Attest

48. Wayside Inn

Entered in the
National Register

for Keeper Melora Byers 9/27/85

Attest

49. Whittemore House

Entered in the
National Register

for Keeper Melora Byers 4/18/85

Attest

50. Winn Farm

Entered in the
National Register

for Keeper Melora Byers 4/18/85

Attest

REC#
85002689

NATIONAL REGISTER OF HISTORIC PLACES
EVALUATION/RETURN SHEET

Taylor--Dallin House (Arlington MRA)
Middlesex County
MASSACHUSETTS

Working No. 3/6/95
Fed. Reg. Date: 2/4/86
Date Due: 9/28/85
Action: ACCEPT 9-27-85
 RETURN
 REJECT
Federal Agency: _____

Entered in ~~file~~
National Register

- resubmission
- nomination by person or local government
- owner objection
- appeal

Substantive Review: sample request appeal NR decision

Reviewer's comments:

Recom./Criteria _____
Reviewer _____
Discipline _____
Date _____
_____ see continuation sheet

Nomination returned for: _____ technical corrections cited below
_____ substantive reasons discussed below

1. Name

2. Location

3. Classification

Category	Ownership Public Acquisition	Status Accessible	Present Use

4. Owner of Property

5. Location of Legal Description

6. Representation in Existing Surveys

Has this property been determined eligible? yes no

7. Description

Condition	Check one	Check one
<input type="checkbox"/> excellent	<input type="checkbox"/> deteriorated	<input type="checkbox"/> unaltered
<input type="checkbox"/> good	<input type="checkbox"/> ruins	<input type="checkbox"/> altered
<input type="checkbox"/> fair	<input type="checkbox"/> unexposed	<input type="checkbox"/> original site
		<input type="checkbox"/> moved date _____

Describe the present and original (if known) physical appearance

- summary paragraph
- completeness
- clarity
- alterations/integrity
- dates
- boundary selection

8. Significance

Period _____ Areas of Significance—Check and justify below

Specific dates _____ Builder/Architect _____

Statement of Significance (*in one paragraph*)

- summary paragraph
- completeness
- clarity
- applicable criteria
- justification of areas checked
- relating significance to the resource
- context
- relationship of integrity to significance
- justification of exception
- other

9. Major Bibliographical References

10. Geographical Data

Acreage of nominated property _____

Quadrangle name _____

UTM References _____

Verbal boundary description and justification

11. Form Prepared By

12. State Historic Preservation Officer Certification

The evaluated significance of this property within the state is:

____ national ____ state ____ local

State Historic Preservation Officer signature

title _____ date _____

13. Other

- Maps
- Photographs
- Other

Questions concerning this nomination may be directed to _____

Signed _____ Date _____ Phone: _____



Taylor - Dallin House

Arlington MRA, MA

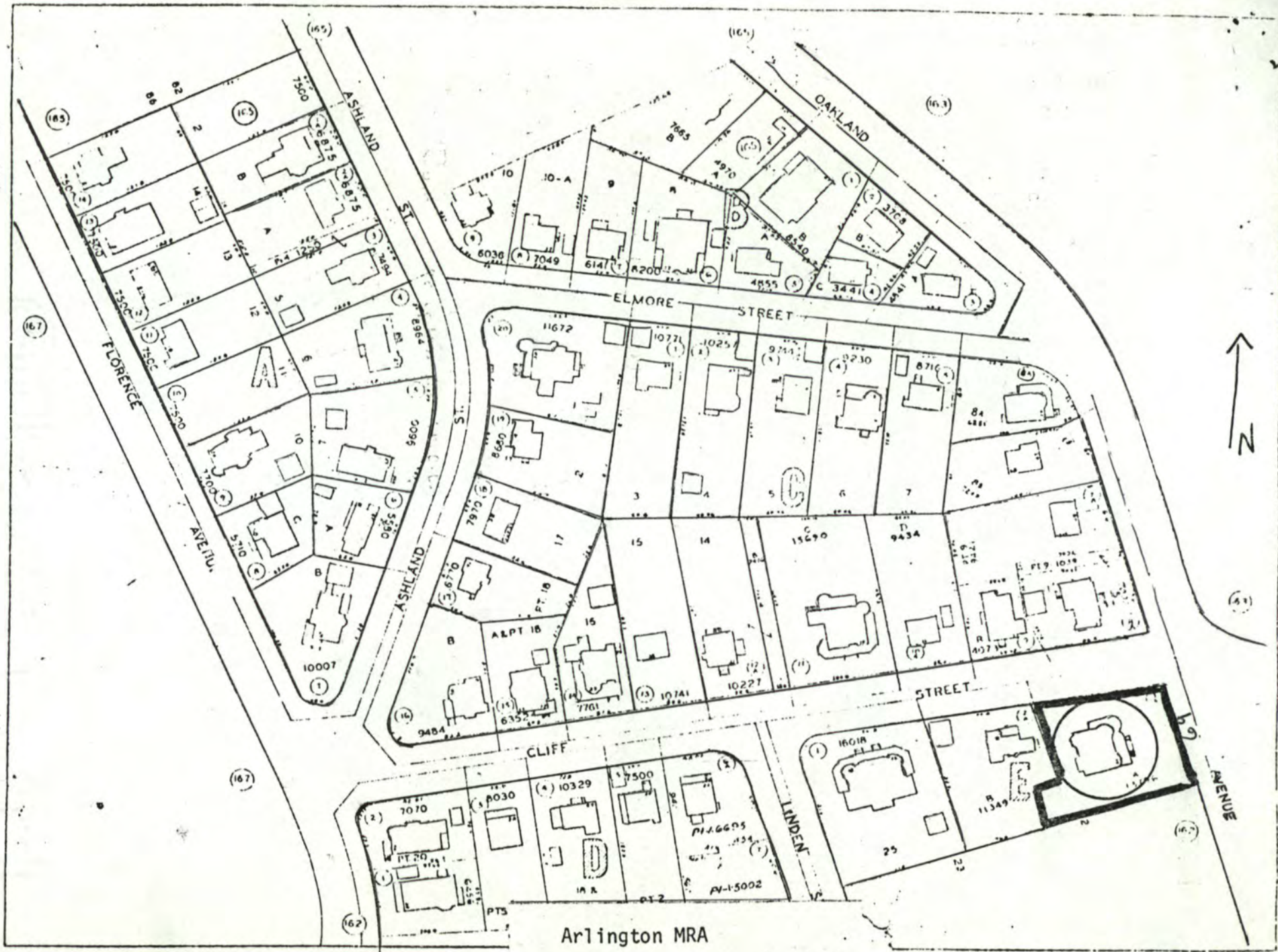

Arlington MRA

Taylor-Dallin House
69 Oakland Avenue

Scale: 1" = 120'
Arlington Town Assessors Map 1960

BLOCK PLAN NO 166
Arlington Assessors Maps

MAR 6 1965