

Iowa Site Inventory

Office of Historic Preservation
Iowa State Historical Department
East 12th & Grand Avenue
Des Moines, Iowa 50319

Site Number 13
District Name _____
Map Reference # 13

Identification

1. Site Name Round Barn, Bruce Township, Section 3, Benton County
 2. Village/Town/City Eagle Center vic. Township Bruce County Benton
 3. Street Address Off U.S. 218
 4. Legal Location 86 N 12 W 3 SE 1/4 of NW 1/4
Urban: subdivision block parcel subparcel
Rural: township range section 1/4 section of 1/4 section
 5. UTM Location: zone 15 easting 563,020 northing 4,682,260; Acreage less than one acre
 6. Owner(s) Name Kirk and Wanda McQuilkin
 7. Owner(s) Address RR#1, Box 195 La Porte City Iowa 50651
(Street address) (City) (State) (Zip)
 8. Use: Present Cattle Barn Original Cattle Barn

Description

9. Date of Construction 1910 Architect/Builder _____
 10. Building Type:
 single-family dwelling industrial other institutional religious
 multiple-family dwelling educational public agricultural
 commercial
 11. Exterior Walls: clapboard stone brick board and batten shingles stucco
 other Clay Tile
 12. Structural System: wood frame with interlocking joints wood frame with light members (balloon frame)
 masonry load-bearing walls iron frame steel frame with curtain walls reinforced concrete
 other _____
 13. Condition: excellent good fair deteriorated
 14. Integrity: original site moved—if so, when? _____
 Notes on alterations, additions (with dates and architect, if known) and any other notable features of building and site:
See reversed side.
 15. Related Outbuildings and Property: barn other farm structures carriage house garage privy
 other _____
 16. Is the building endangered? no yes—if so, why? _____
 17. Surroundings of the building: open land woodland scattered outbuildings densely built-up commercial
 industrial residential other _____

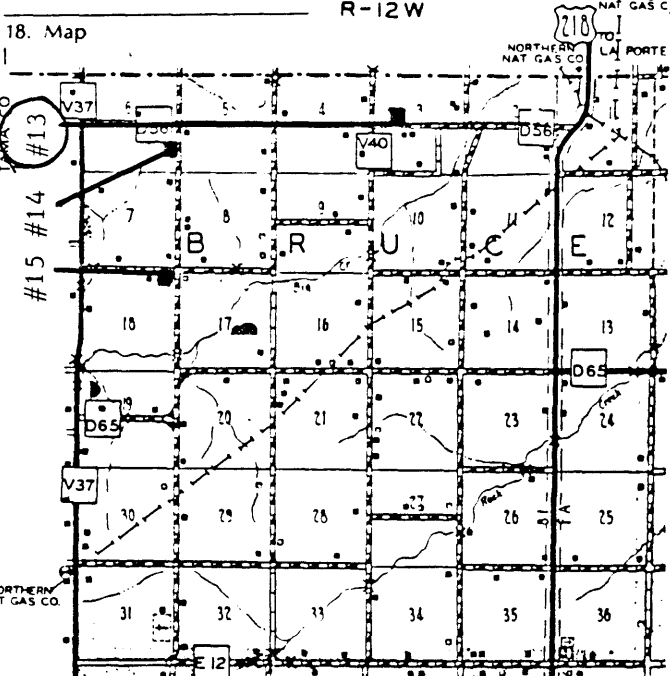

19. Photo 655 Frame 21 A View _____
 Roll _____

VBD: A circle with 80 foot diameter, based on center point of barn, excluding any nearby buildings.

MAY 27 1986
~~MAR 26 1986~~

Significance (Indicate sources of information for all statements)

20. Architectural significance

- a. Key structure/individually may qualify for the National Register
- b. Contributing structure
- c. Not eligible/intrusion

N/A

Continuation of 14. Integrity.

Interior - Open around central silo. Sold by J. G. McQuilkin. Diameter - 60'.
Silo - clay tile. 12' diameter. Conical roof with asphalt shingles. Round
garage/machine shed of clay tile on same farm.

Theme(s) True-Round; Iowa/King type; Johnston Bros. True-Round; Specialty Contractor; Clay Tile Supplier. Special Function; Catle type.

21. Historical Significance

- a. Key structure/individually may qualify for the National Register
- b. Contributing structure
- c. Not eligible/intrusion

See Continuation Sheet.

22. Sources (for primary and secondary sources, give complete facts of publication: author, title, place of publication, date, etc.):

John McQuilkin, La Porte City, IA 50651
Soike, Lowell J. Without Right Angles. Des Moines, Iowa: Iowa State Historical Department,
Office of Historic Preservation, 1983.

Prepared by _____ Date _____
Address _____ Telephone _____
Organization _____

For Office of Historic Preservation Use Only

1. Office Information Sources on this Property

- County Resource File
- Windshield Survey
- National Register
- Grants-In-Aid: _____
- Determination of Eligibility

Review and Compliance Project:

- Other _____
- Other _____
- Other _____

2. Subject Traces

- a. _____
- b. _____
- c. _____
- d. _____
- e. _____

3. Photo Images _____

- _____
- _____
- _____
- _____

Iowa Site Inventory

Office of Historic Preservation
Iowa State Historical Department
East 12th & Grand Avenue
Des Moines, Iowa 50319

Site Number 13

Continuation Sheet

Item Number(s)

One of two barns thought to have been sold by J.G. McQuilkin in his role as a representative of the Johnston Brothers' Clay Works. This barn is specifically characterized as a Johnston Brothers' sub-type by its exterior wall of "...small red clay tile in the lower story and larger tile above..." (Soike 1983). The conical roof is another common feature of the Johnston Brothers' design. The clay tile exterior wall and silo wall generally classify this barn as an Iowa Agricultural Experiment Station / Matt King influenced type. The use of structural clay tile was one of the later improvements in the history of round barns.

It is known from the 1979 Mail Questionnaire that this barn was originally a beef cattle barn, and that as of 1979 was still used for that purpose. The open interior is characteristic of this type.