

United States Department of the Interior
National Park Service

RECEIVED

MAY 29 1987

National Register of Historic Places
Registration Form

NATIONAL
REGISTER

This form is for use in nominating or requesting determinations of eligibility for individual properties or districts. See instructions in *Guidelines for Completing National Register Forms* (National Register Bulletin 16). Complete each item by marking "x" in the appropriate box or by entering the requested information. If an item does not apply to the property being documented, enter "N/A" for "not applicable." For functions, styles, materials, and areas of significance, enter only the categories and subcategories listed in the instructions. For additional space use continuation sheets (Form 10-900a). Type all entries.

1. Name of Property

historic name Ebenezer Mill
other names/site number N/A

2. Location

street & number Ebenezer Road N/A not for publication
city, town Knoxville vicinity
state Tennessee code TN county Knox code TN 293 zip code 37293

3. Classification

Ownership of Property	Category of Property	Number of Resources within Property	
<input checked="" type="checkbox"/> private	<input checked="" type="checkbox"/> building(s)	Contributing	Noncontributing
<input type="checkbox"/> public-local	<input type="checkbox"/> district	<u>1</u>	<u>0</u> buildings
<input type="checkbox"/> public-State	<input type="checkbox"/> site	<u>0</u>	<u>0</u> sites
<input type="checkbox"/> public-Federal	<input type="checkbox"/> structure	<u>0</u>	<u>0</u> structures
	<input type="checkbox"/> object	<u>0</u>	<u>0</u> objects
		<u>1</u>	<u>0</u> Total

Name of related multiple property listing:
N/A

Number of contributing resources previously listed in the National Register 0

4. State/Federal Agency Certification

As the designated authority under the National Historic Preservation Act of 1966, as amended, I hereby certify that this nomination request for determination of eligibility meets the documentation standards for registering properties in the National Register of Historic Places and meets the procedural and professional requirements set forth in 36 CFR Part 60. In my opinion, the property meets does not meet the National Register criteria. See continuation sheet.

Richard L. Boyer 5/22/87
Signature of certifying official Date
Deputy State Historic Preservation Officer, Tennessee Historical Commission
State or Federal agency and bureau

In my opinion, the property meets does not meet the National Register criteria. See continuation sheet.

Signature of commenting or other official Date

State or Federal agency and bureau

5. National Park Service Certification

I, hereby, certify that this property is:

entered in the National Register.
 See continuation sheet.

determined eligible for the National Register. See continuation sheet.

determined not eligible for the National Register.

removed from the National Register.

other, (explain:) _____

Arlene Byer 6/25/87
National Register Date of Action

for Signature of the Keeper Date of Action

6. Function or Use

Historic Functions (enter categories from instructions)

Current Functions (enter categories from instructions)

Industry/Processing/Extraction:
Manufacturing Facility

Work in progress

7. Description

Architectural Classification
(enter categories from instructions)

Materials (enter categories from instructions)

Other: Industrial

foundation Stone: Limestone
walls Wood: Weatherboard

roof Metal: Tin (Standing seam)

other

Describe present and historic physical appearance.

Ebenezer Mill, a two and one-half story frame structure with a one and one-half story shed addition to the rear, was built circa 1870. The mill is located on the east bank of Sinking Creek, which powered the turbine mill. Sinking Creek (now known as Ten Mile Creek) has evidently powered a mill in the Ebenezer Community for over 150 years. An earlier mill, now demolished, existed downstream from the present mill and like Ebenezer Mill was also associated with Statesview (NR 4/24/73). Ebenezer Mill is approximately three-quarters of a mile north of the Southern Railway and the early settlement of Ebenezer. The railroad was built through the western part of Knox County in the late 1860s. The mill is also located near the town of Concord, which was a shipping center on the Tennessee River in the late 19th century. This area of Knox County has been the subject of rapid urbanization in the past twenty to thirty years, but prior to that time was an area of rich agricultural lands and well-developed farms.

The Ebenezer Mill faces Ebenezer Road at a slight angle and is approximately forty-five feet wide and sixty feet deep. The east, or primary elevation, has two bays. The first story consists of a loading door of double width, with planked double doors, and a six over six double hung window. Two six over six double hung windows appear on the second story, and a fixed nine-light window is located in the gable end. The south elevation is also composed of two bays centered by six over six double hung windows. An entry door is located off-center on the first story, while on the second story, in addition to the windows, are the ends of two wooden chutes which mark air vents that served the wheat scouring machines. The shed addition is visible at the rear of the south elevation, its facade broken by a single planked wooden door. The mill's north elevation consists of two bays and the shed portion of the building, each marked by double hung six over six windows. To the rear of the building, on the west elevation, is the two bay shed portion of the mill, with six over six double hung windows in each bay and four-light fixed sash windows in the half story space above them. Above the terminus of the shed roof is the rear facade on the larger portion of the building, marked by six over six double hung windows at the second story and a nine-light fixed sash window at the gable end of the building.

Two interior spaces form the rooms of the mill building, and are devoted to milling functions. The rear, shed roof portion is the corn milling

See continuation sheet

United States Department of the Interior
National Park Service

National Register of Historic Places
Continuation Sheet

Section number 7 Page 2

Ebenezer Mill

operation and contains bins, a 48" French Flint burr stone, sheller, and bolting machine which is used to separate the husks from the corn. Records kept by past millers indicate that the corn mill was capable of producing up to thirty bushels of meal per hour.

The other large interior space is under the two and-one-half story portion of the mill and contains four flour mills, each of which could produce ten to fifteen barrels of flour per hour. In this multi-level space, the first and second floors are connected by a stair on the south wall of the building. On the first floor, four rolling mills (made by Nordyke & Marmon Co. of Indianapolis, Indiana, and patented in 1883 and 1885) crushed the wheat. It was then carried by elevators to the second floor. The machinery now installed in the mill was evidently purchased in 1890, since a mortgage of that date to Nordyke & Marmon was given by the Knox County Union Rolling Mill, a former owner. The mills remained in use until 1967.

A sawmill was also operated at the mill until about 1930. This machinery is still stored at the mill, and includes a 48" saw made by Geiser Manufacturing Co. in Buffalo, New York in 1884 and patented by A. B. Landis Co. of Waynesboro, Pennsylvania in 1877. At one time a feed mill also operated on the site.

The mill was a tub or a turbine mill and used water power generated by a mill dam on Sinking (Ten Mile) Creek. The original turbine, an Eclipse Double Turbine Waterwheel made by Stewell & Bierce Manufacturing Co. of Dayton, Ohio and dated 1868 and 1870, is still present, although not operational, in the basement of the building. The flue and mill dam were destroyed in flooding in 1942 and, from that time, the mill was powered by a combustion engine.

The Ebenezer Mill had deteriorated somewhat in the nearly two decades (1967 to date) that it was not operated. For the past year and a half, the present owner has been gradually making repairs to the structure, including replacing sills and weatherboarding, repairing window sashes and roofing, and repairing machinery. His intent is to return the mill to operation, producing corn meal, in the near future.

8. Statement of Significance

Certifying official has considered the significance of this property in relation to other properties:

nationally statewide locally

Applicable National Register Criteria A B C D

Criteria Considerations (Exceptions) A B C D E F G N/A

Areas of Significance (enter categories from instructions)

Industry
Engineering

Period of Significance

1870-1930

Significant Dates

c. 1870
c. 1890

Cultural Affiliation

N/A

Significant Person

N/A

Architect/Builder

Unknown

State significance of property, and justify criteria, criteria considerations, and areas and periods of significance noted above.

Ebenezer Mill is being nominated to the National Register of Historic Places under criteria A and C for its significance to Knox County in both industry and engineering. The mill is an important symbol of the agriculturally based milling industry significant to Knox County's 19th century growth and development, and, because the machinery historically associated with and used in the mill remains intact, it is an engineering site unique among other local mills.

A mill has existed in this vicinity since the 1830s when the Mansion Mill was part of the complex surrounding Statesview (NR 4/24/1973). The land was then owned by Col. Charles McClung who, in 1835, sold the property to Frederick S. Heiskell, with no mention made of Ebenezer Mill. The first mention of the mill occurred in 1871, when Heiskell made a deed of gift to his wife and daughters of land on Sinking Creek, including the land and mill building where Ebenezer Mill now stands. Heiskell heirs continued to transfer the property, always noting the mill, first between themselves in 1881, and then in 1890, to the Knox County Union Rolling Mill Co. Subsequent mortgages to the Nordyke & Marmon Co. of Indianapolis, Indiana, in 1890 and 1893, mark the installation of the present machinery. Flour and corn meal were marketed under the trade name of "Red Dog Flour and Meal" during this time.

The mill next changed hands in 1907 when it was purchased by P. S. Atchley and his wife, grandparents of the present owner. The mill was evidently in receivership for a time before this purchase and was operated by brothers R. A. and C. H. Sterling. After Mr. Atchley's purchase, Ebenezer Mill continued to operate with water power until 1942 when floodwaters in Sinking Creek washed away the mill dam. In 1943, operation of the mill resumed using a gasoline engine and continued until 1967.

The title transfers attached to milling operations on Sinking Creek are indications of the rise and fall of milling as an industry in Knox County. Prior to the 1880s, the agricultural economy of Knox County was tied closely to the cotton area of the south. Knox County farmers grew and

See continuation sheet

9. Major Bibliographical References

Deed Records, Knox County, Tennessee.
Knoxville News-Sentinel.
The French Broad-Holston Country: A History of Knox County, Tennessee.
Mary U. Rothrock, Ed.; Knoxville, TN, 1946.
Interviews with Lemuel Hooper Anderson, November, 1985; May, 1986; and January, 1987.

Previous documentation on file (NPS): N/A
 preliminary determination of individual listing (36 CFR 67) has been requested
 previously listed in the National Register
 previously determined eligible by the National Register
 designated a National Historic Landmark
 recorded by Historic American Buildings Survey # _____
 recorded by Historic American Engineering Record # _____

See continuation sheet

Primary location of additional data:
 State historic preservation office
 Other State agency
 Federal agency
 Local government
 University
 Other
Specify repository: _____

10. Geographical Data

Acreeage of property 1.12 acres

UTM References

A

1	6	7	6	4	4	6	0	3	9	7	6	1	0	0
Zone		Easting				Northing								

C

Zone		Easting				Northing								

B

Zone		Easting				Northing								

D

Zone		Easting				Northing								

See continuation sheet

Bearden, Tennessee 138NE

Verbal Boundary Description

Beginning 250 feet south of the intersection of the south right of way of George Williams Road and the west right of way of Ebenezer Road; then 150 feet south along Ebenezer Raod; then 300 feet westerly to the backline of the property now owned by Lemuel Hooper Anderson; then northerly 175 feet along said property line; then easterly 300 feet to the right of way of Ebenezer Road.

See continuation sheet

Boundary Justification

The boundaries as drawn include the mill and the site of the former millrace.

See continuation sheet

11. Form Prepared By

name/title Ann K. Bennett, Planner
organization Knoxville-Knox County Metropolitan Planning date March 7, 1987
street & number 400 Main Avenue Commission telephone (615) 521-2500
city or town Knoxville state Tennessee zip code 37902

United States Department of the Interior
National Park Service

National Register of Historic Places
Continuation Sheet

Section number 8 Page 2

Ebenezer Mill

shipped farm products into Alabama, using first the Tennessee River, and then railroads. Grain and livestock were Knox County's chief agricultural products and shipping rates on the river were even quoted for flour, rather than wheat. Flour was also shipped by rail to Charleston, South Carolina, for export.

After the 1880s, wheat grown in East Tennessee suffered in competition with western-grown wheat, and particularly the hard spring wheat which was higher in gluten than the soft wheat grown in East Tennessee and Knox County. Wheat continued to be grown here, however, and soft wheat flours using the locally-grown wheat were marketed in the south and southeast. However, the milling industry did not have the incentive to grow beyond large, individually-owned mills into a much larger industry. The market changes are probably one reason for the Ebenezer Mill being in receivership in the late 1880s.

Throughout the late 19th and early 20th centuries, corn continued to be an important East Tennessee product. Used for meal, animal feed, and the mash for small stills, corn products were milled at Ebenezer Mill during this time. The installation of feed and saw milling equipment at the Ebenezer Mill in the late 19th century probably helped insure its economic survival.

As mentioned earlier, milling was an important Knox County industry. No records have been discovered to indicate the total number of mills operating in Knox County from its settlement through the early years of the 20th century, but a recent sites survey indicates at least eight buildings which housed early mills still exist in the county. At least one of them is currently in operation using machinery purchased in the last few years, and not original to the building. Ebenezer Mill is the only known Knox County mill which still possesses machinery original to it. The unchanged nature of the machinery and its completeness (including wheat, corn, feed, and saw mill machinery) make Ebenezer Mill a unique example of the milling operations once so significant in Knox County. Ebenezer Mill is an excellent extant example of the Knox County milling industry as the mill has undergone only minor changes and retains its integrity.

BE DESIGNED BY STRUCTURAL
 ACTION 876. NO PORTION
 18 FLOOR SHALL BE BELOW
 100 = 874.7' ±)

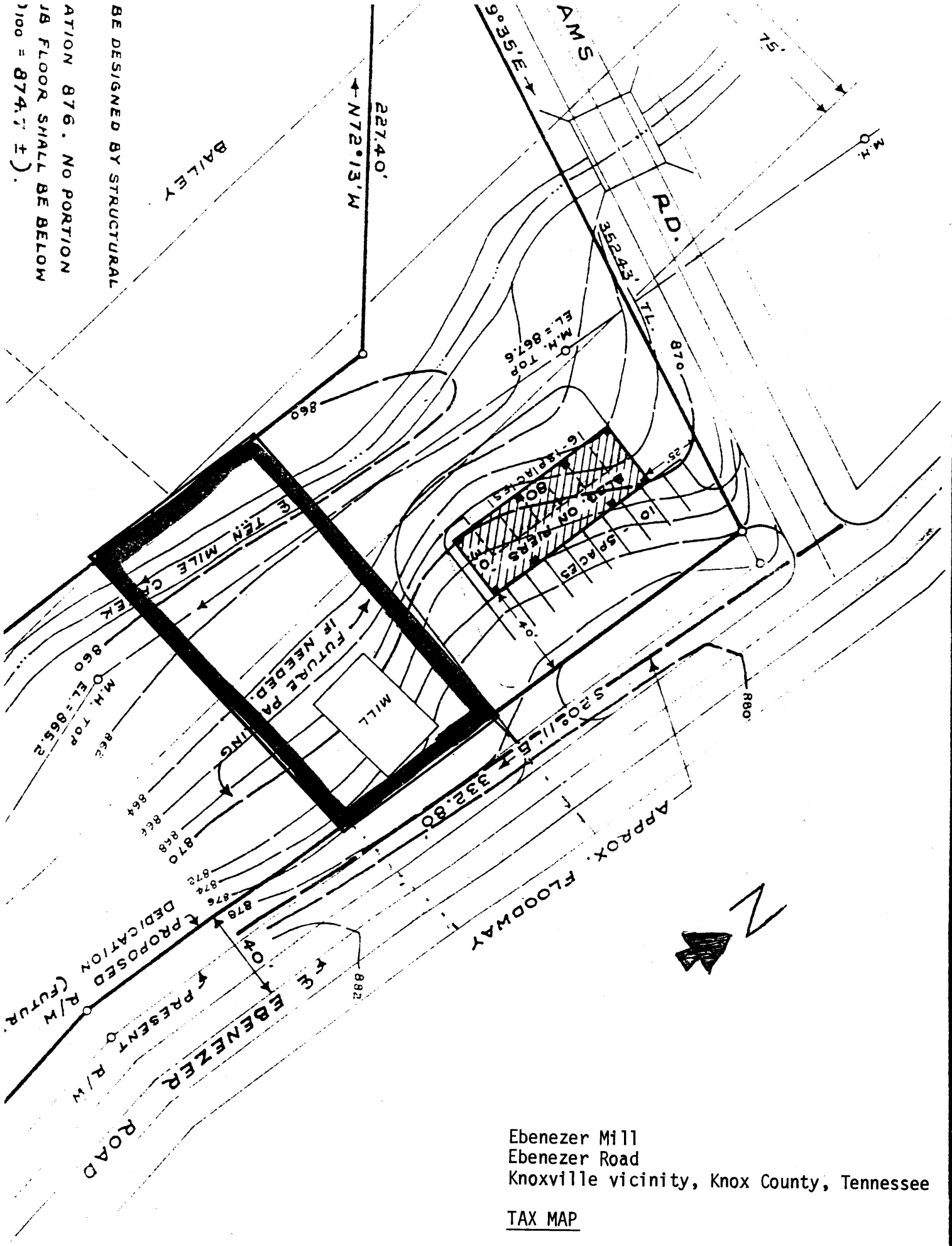

Ebenezer Mill
 Ebenezer Road
 Knoxville vicinity, Knox County, Tennessee

TAX MAP
 1" = 100'

MAY 29 1987

United States Department of the Interior
National Park Service

National Register of Historic Places Continuation Sheet

Section number _____ Page _____

Ebenezer Mill Knox County TENNESSEE
87001037

ADDITIONAL DOCUMENTATION APPROVED

Guy M. Lapsley 3/17/94

National Register of Historic Places Continuation Sheet

Section number

Page 1

Ebenezer Mill
Knox County, TN

The location of the Ebenezer Mill, Knox County, Tennessee was incorrectly identified on the U.S.G.S. map submitted with the nomination. The UTM References for Ebenezer Mill should read:

Bearden, Tennessee - 138NE
16/764060/3979220



State Historic Preservation Officer

2/22/94

Date

UNITED STATES DEPARTMENT OF THE INTERIOR
NATIONAL PARK SERVICE

NATIONAL REGISTER OF HISTORIC PLACES
EVALUATION/RETURN SHEET

REQUESTED ACTION: ADDITIONAL DOCUMENTATION

PROPERTY NAME: Ebenezer Mill

MULTIPLE NAME:

STATE & COUNTY: TENNESSEE, Knox

DATE RECEIVED: 2/19/10 DATE OF PENDING LIST:
DATE OF 16TH DAY: DATE OF 45TH DAY: 4/05/10
DATE OF WEEKLY LIST:

REFERENCE NUMBER: 87001037

NOMINATOR: STATE

REASONS FOR REVIEW:

APPEAL: N DATA PROBLEM: N LANDSCAPE: N LESS THAN 50 YEARS: N
OTHER: N PDIL: N PERIOD: N PROGRAM UNAPPROVED: N
REQUEST: N SAMPLE: N SLR DRAFT: N NATIONAL: N

COMMENT WAIVER: N

ACCEPT RETURN REJECT 3-17-10 DATE

ABSTRACT/SUMMARY COMMENTS:

Additional Documentation Approved

RECOM./CRITERIA Accept

REVIEWER Gordon Beall

DISCIPLINE History

TELEPHONE _____

DATE 3-17-10

DOCUMENTATION see attached comments Y/N see attached SLR Y/N

If a nomination is returned to the nominating authority, the nomination is no longer under consideration by the NPS.

National Register of Historic Places
Continuation Sheet

Section number

Page 1

Ebenezer Mill
Knox County, TN

The location of the Ebenezer Mill, Knox County, Tennessee was incorrectly identified on the U.S.G.S. map submitted with the nomination. The UTM References for Ebenezer Mill should read:

Bearden, Tennessee - 138NE
16/764060/3979220



State Historic Preservation Officer

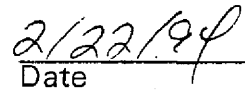

Date

Ebenezer Mill
Knox Co., TN
16/764060/3979220

KINGSTON 25 MI.
LENOIR CITY 12 MI.

8 MI. TO JUNCTION INTERSTATES 40 AND 75

5.4 MI. TO JUNCTION STATE HWY. 62 AT SOLWAY

