

640

AREA

FORM NO.

MASSACHUSETTS HISTORICAL COMMISSION
80 BOYLSTON STREET
BOSTON, MA 02116

262

Winchester, Mass., MRA

Town WINCHESTER

Address 420 Main Street

Historic Name William Simonds House

Photo (3"x3" or 3"x5", black and white) Indicate address of property on back of photo. Staple to left side of form.

Use: Present dwelling

Original dwelling

DESCRIPTION

Date 1877

Source Henry Simonds

Style Mansard

Architect unknown

Exterior Wall Fabric vinyl clapboards

Outbuildings garage-NC

Major Alterations (with dates) siding

c1980

Condition excellent

Moved no Date n/a

Acreage .47A / 20,393sq. ft. 08-0169

Setting multi-period residential area

on southern Main Street

Recorded by Henry Simonds

Organization Winchester Historical Comm.

Date 11/78; 10/87 revised by C. Jenkins

Sketch Map: Draw map showing property's location in relation to nearest cross streets and/or geographical features. Indicate all buildings between inventoried property and nearest intersection(s). Indicate north

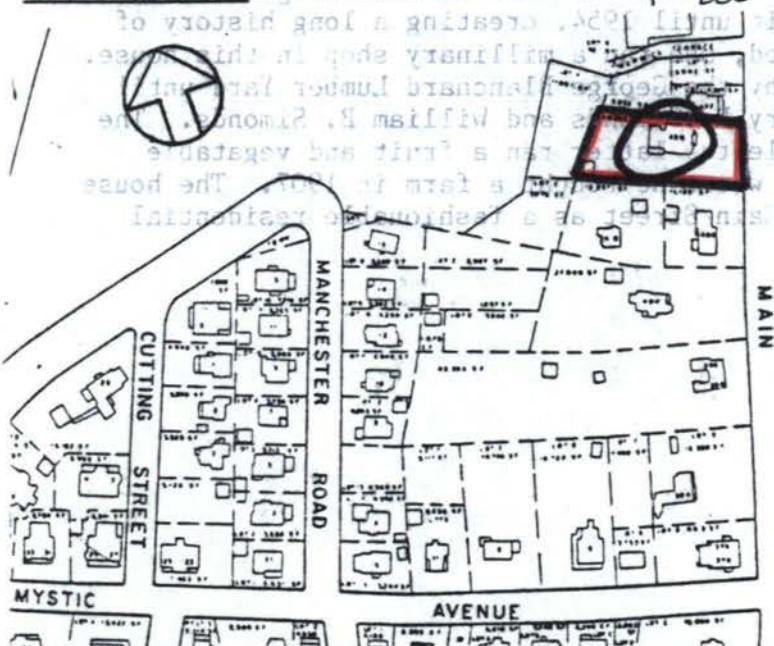

UTM REFERENCE 19, 324400 - 4701600

USGS QUADRANGLE LEXINGTON, MASS.

SCALE 1:25,000

NATIONAL REGISTER CRITERIA STATEMENT (if applicable)

The William Simonds House possesses integrity of location, design, setting, materials (partial), workmanship, feeling and associations. It is significant as a fine academic example of the Mansard style featuring a symmetrical three bay facade, a bell-cast mansard roof with patterned slate, projecting eaves resting on elaborate paired brackets, lavish use of wooden ornamentation, and polygonal bays flanking the entry. It also reflects the continuing development of South Main Street as a fashionable residential area. It meets criteria A and C of the National Register of Historic Places.

ARCHITECTURAL SIGNIFICANCE Describe important architectural features and evaluate in terms of other buildings within the community.

The Simonds House is a two story wood-frame structure enclosed by a bell-cast mansard roof of patterned slate. It displays a symmetrical three bay facade and lavish architectural ornamentation. Centered on the facade is a glazed, double-leaf entry with simple surround; the entry is flanked by polygonal bays linked by a one story porch, all featuring brackets and other detail. At the second story, narrow paired windows occupy the central bay while standard windows occupy the outer bays; all are headed by pediments. This fenestration is repeated in the dormers above. Other trim includes corner pilasters and elaborate paired brackets at the overhanging roofline. The only alteration to the house is the recent application of vinyl siding which was fortunately achieved without removal of any of the fine wooden trim.

HISTORICAL SIGNIFICANCE Explain the role owners played in local or state history and how the building relates to the development of the community.

This house was built in 1877 by William and Mary R. Simonds on land owned by Harrison Parker. At the death of Mary Simonds in 1915, it was left to Cora Simonds Morgan, their daughter, and her husband Benjamin who occupied it until 1954, creating a long history of family ownership. Before Cora Simonds was married, she ran a millinery shop in this house. Cora Morgan married Ben Morgan who was employed by the George Blanchard Lumber Yard until he died. William Simonds also had two sons, Henry R. Simonds and William B. Simonds. The former ran a provision store on Main Street, while the latter ran a fruit and vegetable wagon in the 1890s before moving to Hollis, N.H. where he bought a farm in 1907. The house reflects the continuing development of southern Main Street as a fashionable residential area in the 19th century.

BIBLIOGRAPHY and/or REFERENCES

Simonds, Henry. Family Reminiscences. Historic maps and atlases.

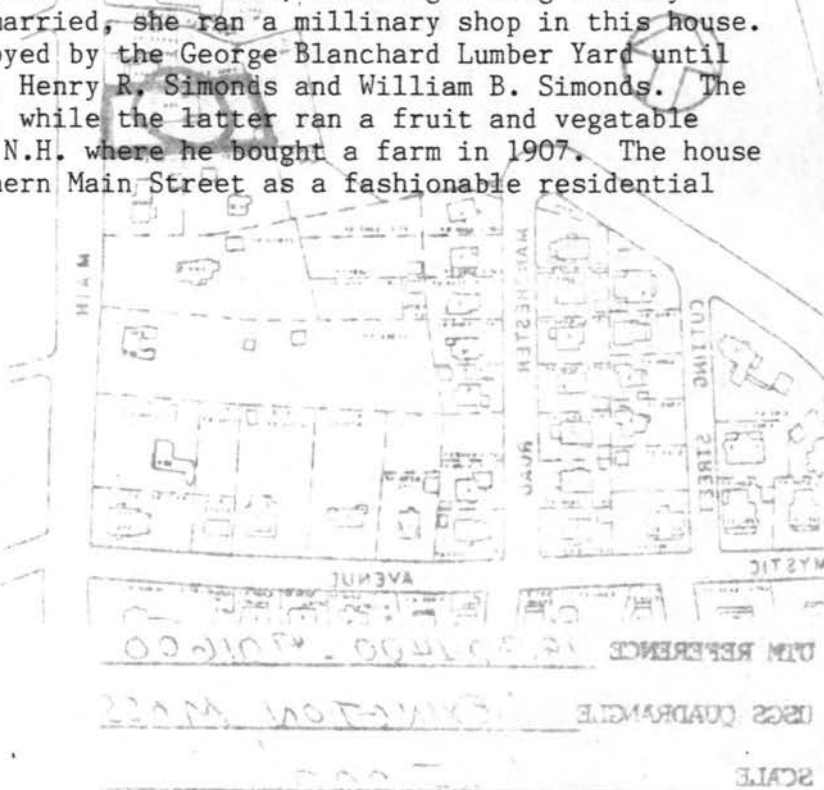

United States Department of the Interior
National Park Service

MAY 22 1989

National Register of Historic Places
Continuation Sheet

Section number _____ Page _____

Multiple Resource Area
Thematic Group

Name Winchester MRA
State Middlesex County, MASSACHUSETTS

Nomination/Type of Review	Date/Signature
41. Remick, Joseph, House Entered in the National Register	Keeper <u>Alvina Byers 7/5/89</u> Attest _____
42. Richardson, Zachariah, House Entered in the National Register	Keeper <u>Alvina Byers 7/5/89</u> Attest _____
43. Russell, Charles, House Entered in the National Register	Keeper <u>Alvina Byers 7/5/89</u> Attest _____
44. Russell, Arthur H., House Entered in the National Register	Keeper <u>Alvina Byers 7/5/89</u> Attest _____
45. Sharon House Entered in the National Register	Keeper <u>Alvina Byers 7/5/89</u> Attest _____
46. Simonds, William, House Entered in the National Register	Keeper <u>Alvina Byers 7/5/89</u> Attest _____
47. Skillings Estate House Entered in the National Register	Keeper <u>Alvina Byers 7/5/89</u> Attest _____
48. St. Mary's Catholic Church Entered in the National Register	Keeper <u>Alvina Byers 7/5/89</u> Attest _____
49. Stanton, Jacob, House Entered in the National Register	Keeper <u>Alvina Byers 7/5/89</u> Attest _____
50. Sullivan, Edward, House Substantive Review	Keeper <u>John F. Savage 7-5-89</u> Attest _____



^{Bill, jr}
Simonds House
420 Main St.
Winchester, MA MRA

1/88

MHC Inv # 262

Please refer to the map in the
Multiple Property Cover Sheet
for this property

Multiple Property Cover Sheet Reference Number: 64000303

National Register of Historic Places

Note to the record

Additional Documentation: 2014

UNITED STATES DEPARTMENT OF THE INTERIOR
NATIONAL PARK SERVICE

NATIONAL REGISTER OF HISTORIC PLACES
EVALUATION/RETURN SHEET

REQUESTED ACTION: ADDITIONAL DOCUMENTATION

PROPERTY NAME: Simonds, William, House

MULTIPLE NAME: Winchester MRA

STATE & COUNTY: MASSACHUSETTS, Middlesex

DATE RECEIVED: 11/19/13 DATE OF PENDING LIST:
DATE OF 16TH DAY: DATE OF 45TH DAY: 1/05/14
DATE OF WEEKLY LIST:

REFERENCE NUMBER: 89000640

NOMINATOR: STATE

REASONS FOR REVIEW:

APPEAL: N DATA PROBLEM: N LANDSCAPE: N LESS THAN 50 YEARS: N
OTHER: N PDIL: N PERIOD: N PROGRAM UNAPPROVED: N
REQUEST: N SAMPLE: N SLR DRAFT: N NATIONAL: N

COMMENT WAIVER: N

ACCEPT RETURN REJECT _____ DATE

ABSTRACT/SUMMARY COMMENTS:

Additional Documentation Approved

RECOM./CRITERIA Accept

REVIEWER Edson Beall

DISCIPLINE History

TELEPHONE _____

DATE 1.3.14

DOCUMENTATION see attached comments Y/N see attached SLR Y/N

If a nomination is returned to the nominating authority, the nomination is no longer under consideration by the NPS.



The Commonwealth of Massachusetts
William Francis Galvin, Secretary of the Commonwealth
Massachusetts Historical Commission

September 10, 2013

J. Paul Loether
National Park Service 2280, 8th Floor
National Register of Historic Places
1201 I (eye) Street, NW
Washington, D.C. 20005

Dear Mr. Loether:

Re: Address changes for properties listed on the NRHP

As we digitize our inventory of historic resources, we are discovering discrepancies in property addresses due to renumbering, changing the address to a side street that abuts the parcel, or assigning a precise address where none had existed. In some cases, property owners have notified us of an incorrect address. We are, therefore, writing to request technical corrections in the National Register records for the following properties in

Winchester (Middlesex County)

- Sanborn House (Aigremont) (NRIND 12/14/1981)—new address is **21 High Street** (formerly 15 High Street) 81000286 ✓
- Winchester Town Hall (NRIND 3/31/1983; NRDIS 11/21/1986)—new address is **71 Mount Vernon Street** (formerly 71 Mount Auburn Street, which was a typo) 83000837 ✓

The following were listed on 7/5/1989 as NRIND in the Winchester MRA

- Ayer, Thomas Prentiss House—new address is **10 Grove Street** (formerly 8-10 Grove Street) 84000630 ✓
- Childs, Webster House—new address is **9 Meadowcroft Road** (formerly 16A Ginn Road) 89000644 ✓
- Gardner, Edward House—new address is **0 Gardner Place** (formerly 89 Cambridge Street) 89000605 ✓
- Mason, John C. House—new address is **10 Hillside Avenue** (formerly 8-10 Hillside Avenue) 89000634 ✓
- Oak Knoll—new address is **17 Brooks Street** (formerly 39 Oak Knoll) 89000648 ✓

220 Morrissey Boulevard, Boston, Massachusetts 02125
(617) 727-8470 • Fax: (617) 727-5128
www.state.ma.us/sec/mhc

National Register of Historic Places
Memo to File

Correspondence

The Correspondence consists of communications from (and possibly to) the nominating authority, notes from the staff of the National Register of Historic Places, and/or other material the National Register of Historic Places received associated with the property.

Correspondence may also include information from other sources, drafts of the nomination, letters of support or objection, memorandums, and ephemera which document the efforts to recognize the property.

UNITED STATES DEPARTMENT OF THE INTERIOR
NATIONAL PARK SERVICE

NATIONAL REGISTER OF HISTORIC PLACES
EVALUATION/RETURN SHEET

REQUESTED ACTION: NOMINATION

PROPERTY NAME: Simonds, William, House

MULTIPLE NAME: Winchester MRA

STATE & COUNTY: MASSACHUSETTS, Middlesex

DATE RECEIVED: 5/22/89 DATE OF PENDING LIST: 6/06/89
DATE OF 16TH DAY: 6/22/89 DATE OF 45TH DAY: 7/06/89
DATE OF WEEKLY LIST:

REFERENCE NUMBER: 89000640

NOMINATOR: STATE

REASONS FOR REVIEW:

APPEAL: N DATA PROBLEM: N LANDSCAPE: N LESS THAN 50 YEARS: N
OTHER: N PDIL: N PERIOD: N PROGRAM UNAPPROVED: N
REQUEST: N SAMPLE: N SLR DRAFT: N NATIONAL: N

COMMENT WAIVER: N

ACCEPT RETURN REJECT 7/5/89 DATE Entered in the
National Register

ABSTRACT/SUMMARY COMMENTS:

RECOM./CRITERIA _____
REVIEWER _____
DISCIPLINE _____
DATE _____

DOCUMENTATION see attached comments Y/N see attached SLR Y/N

CLASSIFICATION

count resource type

STATE/FEDERAL AGENCY CERTIFICATION

FUNCTION

historic current

DESCRIPTION

architectural classification
 materials
 descriptive text

SIGNIFICANCE

Period Areas of Significance--Check and justify below

Specific dates Builder/Architect
Statement of Significance (in one paragraph)

summary paragraph
 completeness
 clarity
 applicable criteria
 justification of areas checked
 relating significance to the resource
 context
 relationship of integrity to significance
 justification of exception
 other

BIBLIOGRAPHY

GEOGRAPHICAL DATA

acreage verbal boundary description
 UTMs boundary justification

ACCOMPANYING DOCUMENTATION/PRESENTATION

sketch maps USGS maps photographs presentation

OTHER COMMENTS

Questions concerning this nomination may be directed to

_____ Phone _____

Signed _____ Date _____