

MONTANA HISTORICAL AND ARCHITECTURAL INVENTORY

Site # 15

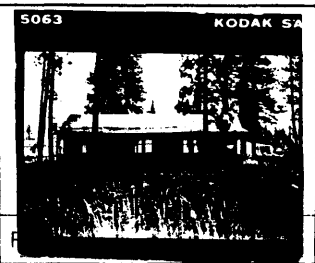

Legal Description: Block 29, lots 14-19
 Address: 210 Jefferson Street
 Ownership: name: Thompson Falls Woman's Club
 private public address: Box 442, Thompson Falls, MT 59873

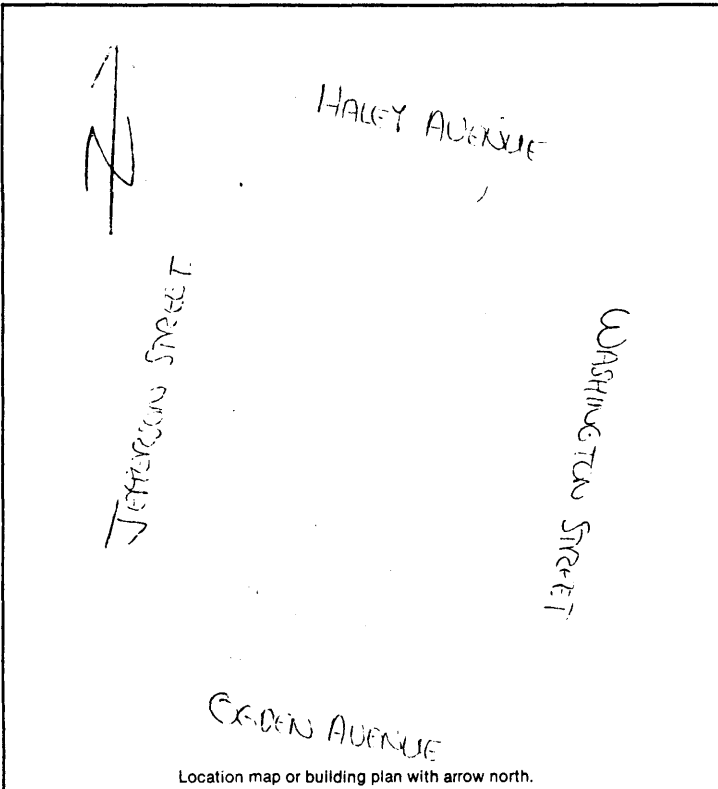

Historic Name: RINARD HOUSE
 Common Name: WOMEN'S CLUB
 Date of Construction: 1910 estimated documented
 Architect: N/A
 Builder: Unknown
 Original Owner: L. C. Rinard
 Original Use: residence
 Present Use: clubhouse
 Research Sources:
 abstract of title city directories
 plat records/maps sewer/water permits
 tax cards obituaries
 building permit biographies
 Sanborn maps — dates: 1914, 1922, 1927
 Bibliography:
1911 Assessment Book
Deedbook: 17, p. 120
Ordered Sale: 4, p. 457
Sanders County Ledger: 2/10/11

PHYSICAL DESCRIPTION: Describe present appearance of structure/site, then contrast and compare that with it's original appearance, noting additions, alterations, and changes in materials. Discuss significant architectural features.

The Thompson Falls Woman's Club is a one story, rectangular-shaped wood frame building with an exterior of log and mortar. Built on a stone and mortar foundation, the building has a south-facing, full width porch supported by rounded poles with a pole railing. A raised concrete foundation which supports the poles is open in the center and has two sets of four steps. The main facade has three sets of paired, 1/1 double hung windows with wooden casings, and a door on each side of the steps. A wooden sign placed above one of the doors reads "THOMPSON FALLS WOMAN'S CLUB." The east gable end has one casement window and wood shingles from the eaves to the peak. The north facade has a frame addition attached with two boarded doors and one 1/1 double hung window. A single 1/1 double hung window is located in the west gable end. A brick chimney pierces the wood shingled gable roof.

HISTORICAL SIGNIFICANCE: Justify how the persons, important events, and/or historical patterns associated with the structure/site and surrounding area lend the property significance.

Built in 1910, the Thompson Falls Woman's Club is significant for its association with the Woman's Club, which was originally founded in Thompson Falls in 1914. The building was originally used as a three room residence for Leonard Rinard, an attorney who arrived in 1906 and established a practice in the former Harriott building on Main Street. By 1907 Rinard had become secretary of the Sanders County Abstract and Title Insurance Company, and a year later had been elected as County Clerk and Recorder. He sold the property in 1914 and, after a series of owners, it was acquired in 1928 by the Woman's Club.

The first Woman's Club was formed in 1914 and convened at the home of its president, M.V. Brown. After a reorganization in 1921, twelve charter members became officially organized as a non-sectarian and non-political organization where women in Thompson Falls "can come and discuss issues and measures with the purpose of benefitting every man, woman and child in the community." The Woman's Club has always been involved with civic programs, and in 1922, in conjunction with the Sanders County and Montana Tuberculosis Society, they organized the first child welfare clinic in the community. In 1926 they were instrumental in persuading the town to convert a bandstand into a community bathhouse for public use. The group sponsors charity sales and fund raisers and helped to organize the first community library, and establish a community swimming pool and the Sanders County Historical Library. The Thompson Falls Woman's Club building is the oldest log building in the community. It remains essentially the same as when originally constructed, although the interior has been slightly altered to create a meeting room for the Club.

INTEGRITY: Assess the degree to which the structure/site, and surrounding area accurately convey the historical associations of the property.

Originally a three room house, an addition housing a kitchen was added shortly after construction of the house. A covered open porch on the east side of the addition may have been built then. It is now gone. Along with the west side casement window, they appear to be the only alterations on the exterior of the house. Inside, a meeting room formed by knocking down a wall, the kitchen moved to the old bedroom area, and a basement dug.

INFORMATION VALUE: Explain how the extant structure/site may demonstrate or yield information about its historic use or construction.

The importance of the Woman's Club in the community's history should qualify the clubhouse under criteria A. This is the oldest log structure in the town that can be documented. While minor changes have been made, the structure keeps its historical associations and may qualify under criteria C.

FORM PREPARED BY:

Name: John Lazuk

Address: 350 Strand, Missoula, MT

Date: October 25, 1984

GEOGRAPHICAL INFORMATION:

Acreage: Less than one acre.

USGS Quad: Thompson Falls, MT

UTM's: 11/624250/5272650