

KENTUCKY HISTORIC RESOURCES INVENTORY

Js-76

1. Historic Name (s) Morrison-Kenyon Library		22. ADD/County Bluegrass/Jessamine <span style="float:right">[ ][ ]</span>	
Original Owner Asbury College		23. Zoning Classification Magisterial District	
Present Name Morrison-Kenyon Library		24. U.S.G. S. Quadrant (15'/75') Wilmore	
3. Owner's Name Asbury College		25. UTM Reference 16   705600   4193020 Zone Easting Northing	
4. Owner's Address Wilmore 40390		26. Prehistoric Site Historic Site Building <input checked="" type="checkbox"/>	
5. Location Ky. 29, Wilmore		Object Structure	
6. Open to Public <input checked="" type="radio"/> Yes <input type="radio"/> No	7. Visible from road <input checked="" type="radio"/> Yes <input type="radio"/> No	8. Ownership Private <input checked="" type="checkbox"/> Local <input type="checkbox"/> State <input type="checkbox"/> Federal <input type="checkbox"/>	
9. Local Contact/Organization		27. District Name: Yes <input type="checkbox"/> No <input checked="" type="checkbox"/>	
10. Site Plan with North Arrow		28. Significance Evaluation National Register	
11. Architect Churchill & Gillig		29. Status National Landmark <input type="checkbox"/> National Register <input type="checkbox"/> Landmark Certificate <input type="checkbox"/> Kentucky Survey <input type="checkbox"/> Local Landmark <input type="checkbox"/> HABS/HAER <input type="checkbox"/>	
12. Builder		Date	
13. Date 1927		30. Theme Primary education <span style="float:right">[ ][ ]</span> Secondary libraries <span style="float:right">[ ][ ]</span> Other architecture/community <span style="float:right">[ ][ ]</span>	
14. Style Neo-Georgian <span style="float:right">[ ][ ]</span>		31. Endangered Yes <input type="checkbox"/> No <input checked="" type="checkbox"/>	
15. Original Use library		32.	
16. Present Use library		ATTACH PHOTO	
17. Condition Interior excellent <span style="float:right">[ ][ ]</span> Exterior excellent <span style="float:right">[ ][ ]</span>		Roll No. 35 Picture No. _____ Direction _____	
18. Description 5-bay, 2-story brick; 3-bay, flat-roofed monumental portico full-height round-arched windows in main face cut through floor line; stone detail fine proportions and detailing.		33. Tape No. _____ Negative No. _____	
19. History Howard A. Churchill (? - 1961) and John T. Gillig (? 1978) were Lexington architects; they designed Lexington Post Office and several Transylvania University buildings; cost \$54,000.		34. Prepared by: NCP-KTG	
20. Significance Architecture: one of the finest exemplars in the county of the Georgian Revival; the building exhibits fine design qualities.		35. Organization KHC	
21. Source of Information Head librarian.		36. Date summer 1977	
		37. Revision Dates _____ 38. Staff Review _____	

014/137

**KENTUCKY HISTORIC RESOURCE INVENTORY SUPPLEMENT  
BOUNDARY AND LOCATION INFORMATION**

Historic Property Name Morrison-Kenyon Library Site # JK 76  
 Multiple Resource/Thematic Nomination Title Jessamine Co

U.T.M. Coordinates - List multiple UTM's if property is ten or more acres.

A. 16 705600 4193020 D. \_\_\_\_\_  
 B. \_\_\_\_\_ E. \_\_\_\_\_  
 C. \_\_\_\_\_ F. \_\_\_\_\_

Verbal Boundary Description \_\_\_\_\_ Acreage 1 1/2 acres

*Building within A.B.C.D.E.F., fronting on  
main campus driveway*

Sketch of Site Plan (Showing outbuildings, structures, landscape features and the site boundary as described above.)

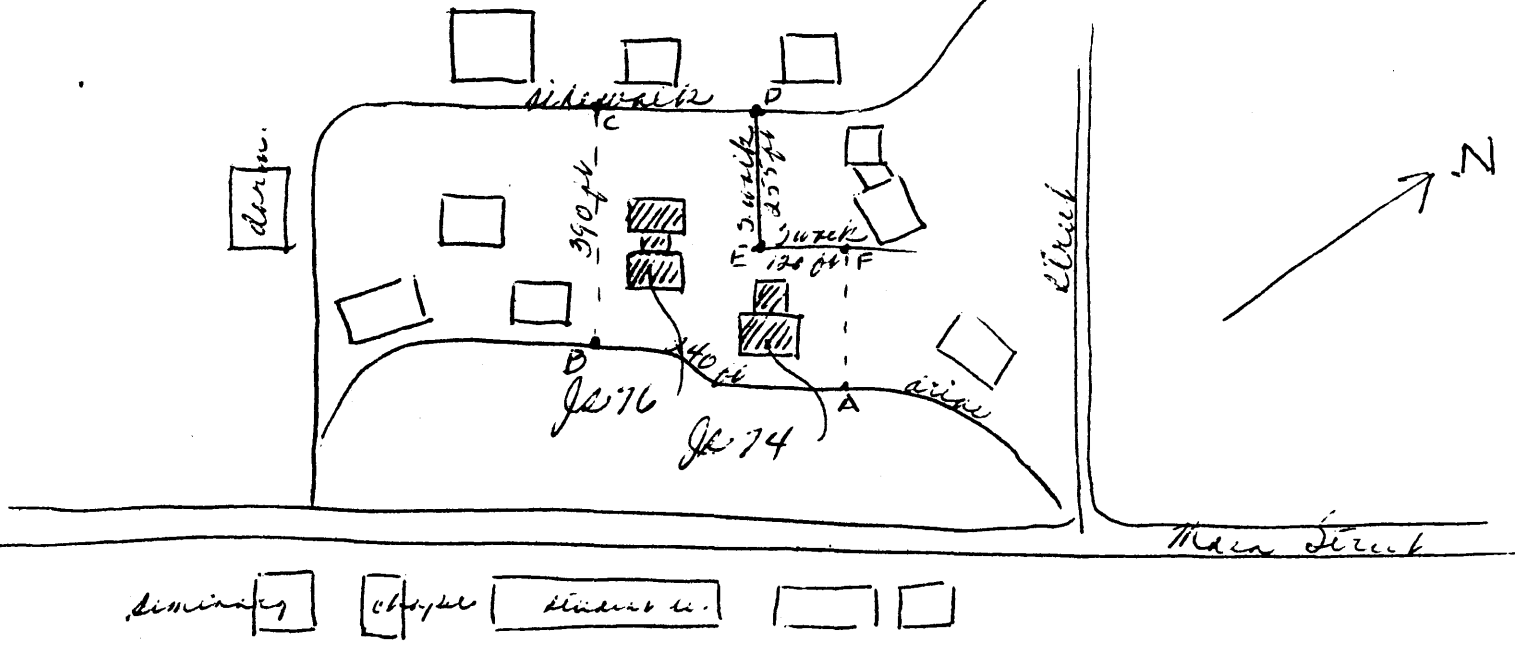

Official Courthouse Property Reference:

Marrison Kenyon Library  
 Multiple Resources of Jessamine Co., Ky.  
 UJM = 16 705600 4193020

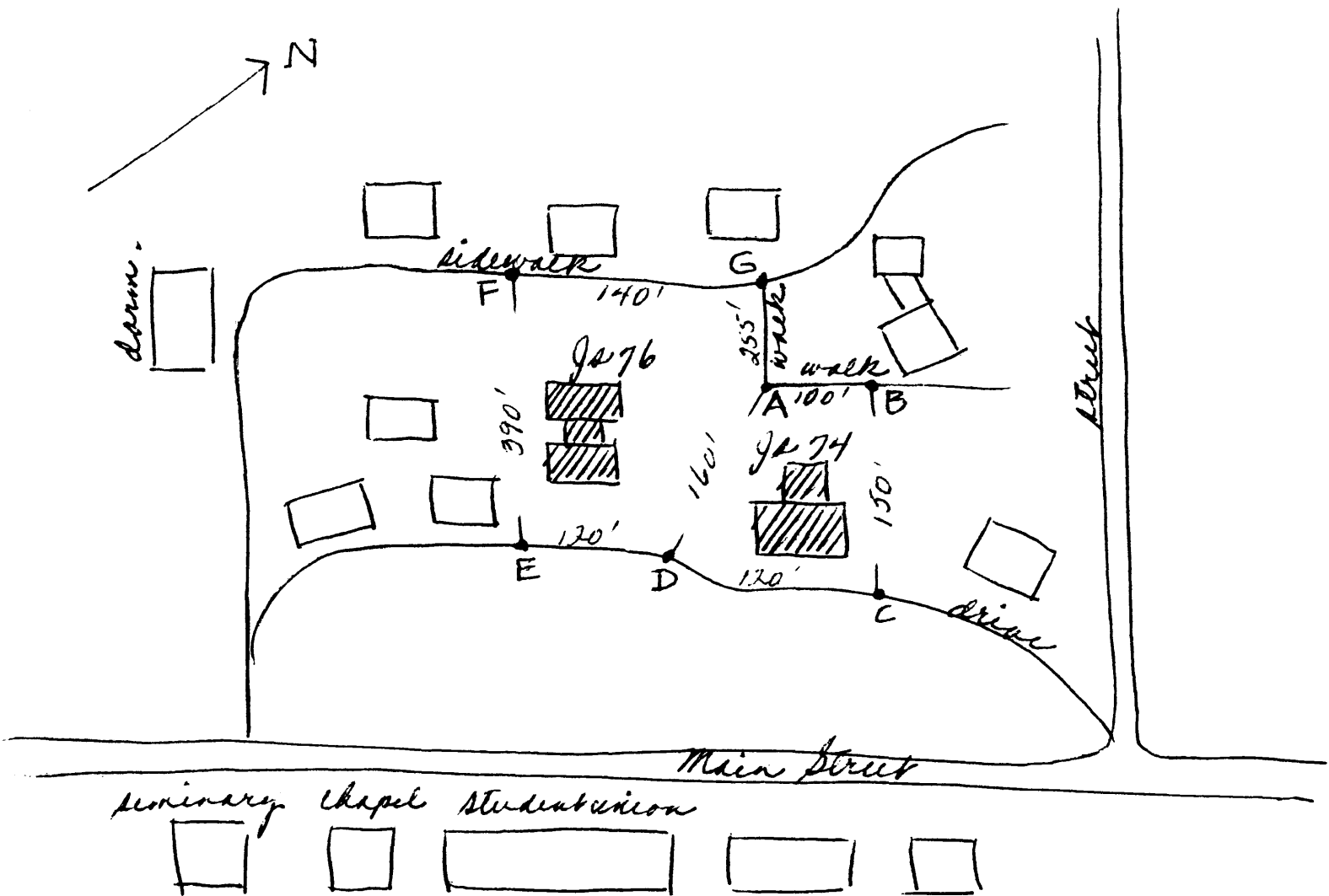

Beginning at A at a turn in a sidewalk, thence S 160' ft to D at a curve in the driveway, thence with drive 120 ft W to C, thence N W 390' to F at a sidewalk, thence with the walk 140 ft to G at another walk, thence SE 225' to the beginning, containing about 1 acre. and the library building