

**United States Department of the Interior
National Park Service**

For NPS use only

**National Register of Historic Places
Inventory—Nomination Form**

received JUN 26 1984

date entered JUL 26 1984

See instructions in *How to Complete National Register Forms*
Type all entries—complete applicable sections

1. Name

historic York Cliffs Historic District

and/or common

2. Location

street & number Agamenticus Avenue not for publication

city, town York, N/A vicinity of

state Maine code 23 county York code 031

3. Classification

Category	Ownership	Status	Present Use	
<input checked="" type="checkbox"/> district	<input type="checkbox"/> public	<input checked="" type="checkbox"/> occupied	<input type="checkbox"/> agriculture	<input type="checkbox"/> museum
<input type="checkbox"/> building(s)	<input checked="" type="checkbox"/> private	<input checked="" type="checkbox"/> unoccupied	<input type="checkbox"/> commercial	<input type="checkbox"/> park
<input type="checkbox"/> structure	<input type="checkbox"/> both	<input type="checkbox"/> work in progress	<input type="checkbox"/> educational	<input checked="" type="checkbox"/> private residence
<input type="checkbox"/> site	Public Acquisition	Accessible	<input type="checkbox"/> entertainment	<input type="checkbox"/> religious
<input type="checkbox"/> object	<u>N/A</u> in process	<input type="checkbox"/> yes: restricted	<input type="checkbox"/> government	<input type="checkbox"/> scientific
	<input type="checkbox"/> being considered	<input checked="" type="checkbox"/> yes: unrestricted	<input type="checkbox"/> industrial	<input type="checkbox"/> transportation
		<input type="checkbox"/> no	<input type="checkbox"/> military	<input type="checkbox"/> other:

4. Owner of Property

name Multiple Ownership (See Continuation Sheet)

street & number

city, town _____ vicinity of _____ state _____

5. Location of Legal Description

courthouse, registry of deeds, etc. York County Registry of Deeds

street & number

city, town Alfred, state Maine

6. Representation in Existing Surveys

title N/A has this property been determined eligible? N/A yes no

date _____ federal state county local

depository for survey records

city, town _____ state _____

7. Description

Condition

excellent
 good
 fair

deteriorated
 ruins
 unexposed

Check one

unaltered
 altered

Check one

original site
 moved date _____

Describe the present and original (if known) physical appearance

Scattered with generous grounds over a beautiful 25 acre seashore property are eight of the large summer houses which survive of the original thirteen built at York Cliffs. Erected (with the exception of one) between 1892 and 1901, these large residences clearly represent the kind of affluence which was lavished upon selected and exclusive enclaves along the Maine coast at the turn of the century. All but two are executed in the then popular Shingle Style calculated to blend comfortably into the coastal landscape. Developed by the York Cliffs Improvement Company, this spacious tract also boasted a large and handsome summer hotel, the Passaconaway Inn, now gone.

For the most part these "cottages" are in reasonably good condition and a number are now occupied on a year round basis.

Buildings contributing to the character of the district:

1. "Pinehurst Cottage": c. 1800, remodelled c. 1895.
Federal and Colonial Revival, frame, 2½ stories, clapboarded, hipped roof.
2. "Hillside Cottage": 1899-1900.
Shingle Style, frame, 2½ stories, shingled, gambrel roof.
Architect and builder: Everett Goodwin.
3. "Sunset Hill": 1895.
Queen Anne, frame, 2½ stories, shingled, hipped roof with facade turret.
4. "Edgemere": 1896.
Shingle Style, frame, 2½ stories, shingled, hipped roof.
5. "Boulder Cottage": c. 1894.
Shingle Style, frame, 2½ stories, shingled, gambrel roof.
6. Baker Cottage: 1901.
Shingle Style, frame, 2½ stories, shingled, gable roof.
Architect: F. C. Watson. Builder: Everett Goodwin.
7. Charles D. Kinney Cottage: c. 1894.
Shingle Style, frame, 2½ stories, shingled, gambrel roof.
8. Sara Day Cottage: 1899.
Shingle Style, frame, 2½ stories, shingled, gambrel roof.
Architect and builder: Everett Goodwin

8. Significance

Period	Areas of Significance—Check and justify below			
<input type="checkbox"/> prehistoric	<input type="checkbox"/> archeology-prehistoric	<input type="checkbox"/> community planning	<input type="checkbox"/> landscape architecture	<input type="checkbox"/> religion
<input type="checkbox"/> 1400-1499	<input type="checkbox"/> archeology-historic	<input type="checkbox"/> conservation	<input type="checkbox"/> law	<input type="checkbox"/> science
<input type="checkbox"/> 1500-1599	<input type="checkbox"/> agriculture	<input type="checkbox"/> economics	<input type="checkbox"/> literature	<input type="checkbox"/> sculpture
<input type="checkbox"/> 1600-1699	<input checked="" type="checkbox"/> architecture	<input type="checkbox"/> education	<input type="checkbox"/> military	<input checked="" type="checkbox"/> social/
<input type="checkbox"/> 1700-1799	<input type="checkbox"/> art	<input type="checkbox"/> engineering	<input type="checkbox"/> music	<input type="checkbox"/> humanitarian
<input checked="" type="checkbox"/> 1800-1899	<input type="checkbox"/> commerce	<input type="checkbox"/> exploration/settlement	<input type="checkbox"/> philosophy	<input type="checkbox"/> theater
<input checked="" type="checkbox"/> 1900-	<input type="checkbox"/> communications	<input type="checkbox"/> industry	<input type="checkbox"/> politics/government	<input type="checkbox"/> transportation
		<input type="checkbox"/> invention		<input type="checkbox"/> other (specify)

Specific dates N/A Builder/Architect N/A

Statement of Significance (in one paragraph)

The eight houses here nominated in the York Cliffs Historic District present one of the best surviving examples along the Maine coast of exclusive land development by companies catering to the wealthy who wished to participate in the new trend toward summer living by the sea.

An extensive brochure published by the York Cliffs Improvement Company correctly describes its land holdings as an area "which is rapidly gaining prestige as an exclusive and aristocratic resort combining all the qualities which form an attractive and desirable summer home." In addition to the sale of land, the company offered a spring fed water supply and sewerage disposal facilities. A golf course and stables were also available. It should be noted that when originally built, these houses had an unobstructed view of the ocean over open fields since grown up.

As in the case of other similar developments, the company early on built a fine hotel on the property to attract people to the area who might become future land purchasers. Later it served as a place of entertainment for the cottagers and their guests.

The land deeds issued by the company contained a number of restrictions designed to protect each land holder and thus make acquisition more attractive. These included a standard of cost and architectural excellence for each cottage erected.

Here represented is an era of relaxed affluence and vacation comfort seldom encountered in today's frantic search for summer recreation.

9. Major Bibliographical References

York Cliffs Improvement Company brochure.
 York Registry of deeds, Book 458, Page 469.
 The Old York Transcript, 1899. 1900.

10. Geographical Data

Acreage of nominated property 95
 Quadrangle name York Beach

Quadrangle scale 1:24000

UTM References

A	<u>19</u>	<u>370290</u>	<u>4783300</u>	B	<u>19</u>	<u>370330</u>	<u>4783260</u>
	Zone	Easting	Northing		Zone	Easting	Northing
C	<u>19</u>	<u>3701110</u>	<u>4783005</u>	D	<u>19</u>	<u>369770</u>	<u>4783160</u>
E	<u> </u>	<u> </u>	<u> </u>	F	<u> </u>	<u> </u>	<u> </u>
G	<u> </u>	<u> </u>	<u> </u>	H	<u> </u>	<u> </u>	<u> </u>

Verbal boundary description and justification

Beginning at the northwest corner of the "Pinehurst Cottage" (1) property the district boundary runs easterly along the rear property lines on the north side of Agamenticus Avenue to the northwest corner of the Baker Cottage (6) property, thence southeasterly along the west

List all states and counties for properties overlapping state or county boundaries

state	code	county	code

11. Form Prepared By

name/title Frank A. Beard, Historian
 organization Maine Historic Preservation Commission date May, 1983
 street & number 55 Capitol Street, Station #65 telephone 207/289-2132
 city or town Augusta, state Maine 04333

12. State Historic Preservation Officer Certification

The evaluated significance of this property within the state is:

national state local

As the designated State Historic Preservation Officer for the National Historic Preservation Act of 1966 (Public Law 89-665), I hereby nominate this property for inclusion in the National Register and certify that it has been evaluated according to the criteria and procedures set forth by the National Park Service.

State Historic Preservation Officer signature *Ernest S. Feltz*
 title S.H.P.O. date 6/13/84

For NPS use only

I hereby certify that this property is included in the National Register
 Entered in the
 National Register

for Melvyn Byers date 7/26/84
 Keeper of the National Register

Attest:

date

Chief of Registration

**United States Department of the Interior
National Park Service**

**National Register of Historic Places
Inventory—Nomination Form**

YORK CLIFFS HISTORIC DISTRICT

Continuation sheet

Item number

4

Page 2

Owners and Their Addresses:

1. "Pinehurst Cottage"
Mr. John F. King
R. R. #1
Cape Neddick, Maine 03902
2. "Hillside Cottage"
Mr. & Mrs. Donald Weiser
P. O. Box 612
York Beach, Maine 03910
3. "Sunset Hill"
Mr. Thomas L. Hinkle
Agamenticus Avenue
Cape Neddick, Maine 03902
4. "Edgemere"
Dr. Jay Hayden
R. R. #1
Cape Neddick, Maine 03902
5. "Boulder Cottage"
Mr. George Bushway
R. R. #1
Cape Neddick, Maine 03902
6. Baker Cottage
Mr. Robert D. Gordon
27 Chestnut Street
Boston, Massachusetts 02108
7. Charles D. Kinney Cottage
Mrs. A. Heywood Beeler
R. R. #1
Cape Neddick, Maine 03902
8. Sarah Day Cottage
Martin S. Ulan
R. R. #1
Cape Neddick, Maine 03902

**United States Department of the Interior
National Park Service**

**National Register of Historic Places
Inventory—Nomination Form**

YORK CLIFFS HISTORIC DISTRICT

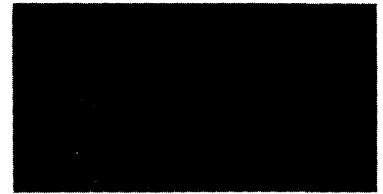

Continuation sheet

Item number

10

Page

2

line of said property to Agamenticus Avenue which it follows easterly to the north corner of the Charles D. Kinney property and southeasterly along the north-westline of said property to the east corner. From this point the line runs southwesterly along the rear property lines on the south side of Agamenticus Avenue to the south corner of the Sarah Day Cottage property (8), thence northwesterly along the southwest line of said property to Agamenticus Avenue which it follows westerly to the southwest corner of the "Pinehurst Cottage" property where it turns northerly along the west line of said property to the point of beginning.

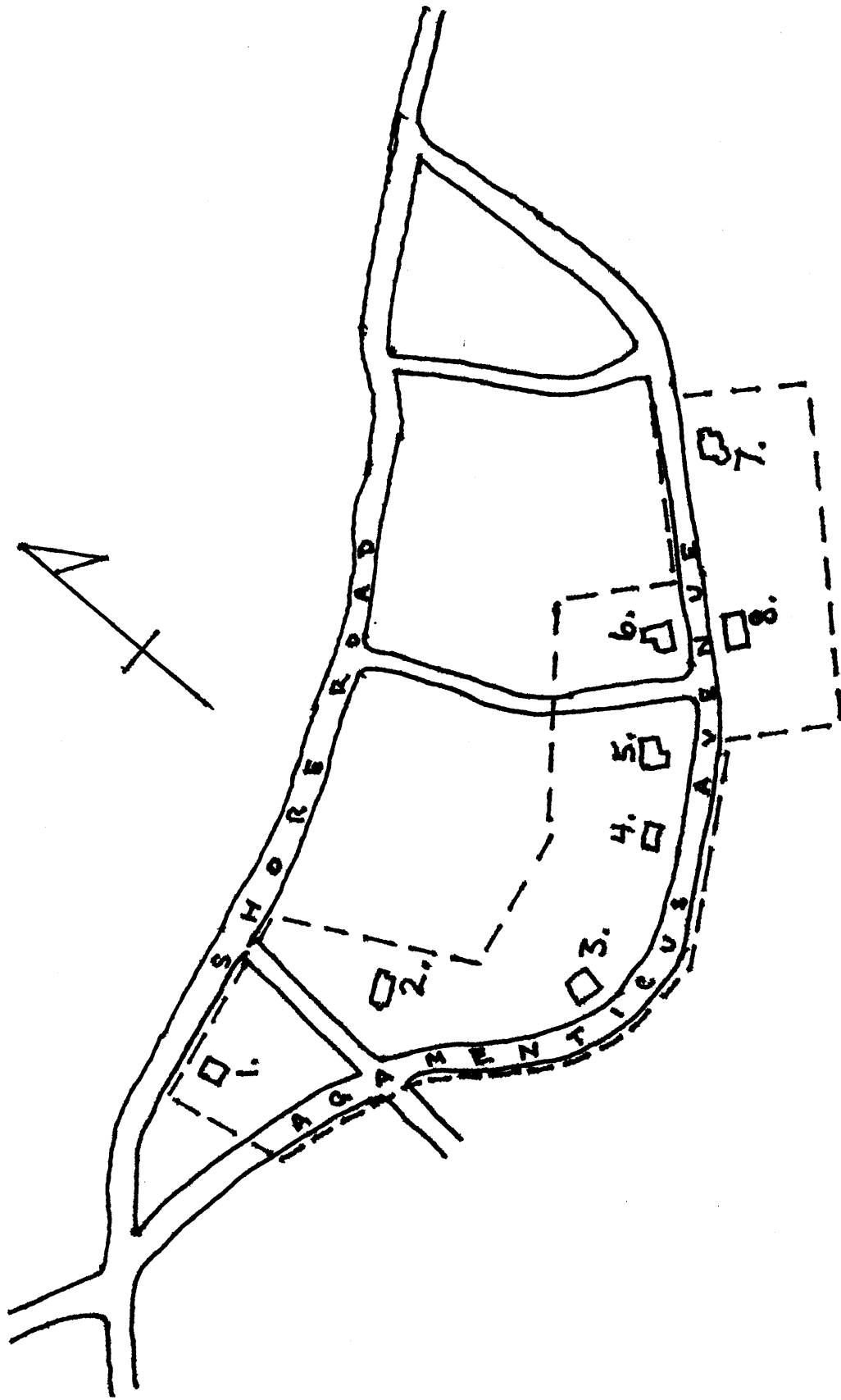

YORK CLIFFS HISTORIC DISTRICT

York, York County, Maine

District Boundary - - - - -