

United States Department of the Interior National Park Service

National Register of Historic Places Registration Form

NATIONAL REGISTER

This form is for use in nominating or requesting determinations of eligibility for individual properties or districts. See instructions in Guidelines for Completing National Register Forms (National Register Bulletin 18). Complete each item by marking "x" in the appropriate box or by entering the requested information. If an item does not apply to the property being documented, enter "N/A" for "not applicable." For functions, styles, materials, and areas of significance, enter only the categories and subcategories listed in the instructions. For additional space use continuation sheets (Form 10-900a). Type all entries.

1. Name of Property

historic name Ruston State Bank
other names/site number Ruston State Bank and Trust Company

2. Location

street & number 107 North Trenton
city, town Ruston
state Louisiana code LA county Lincoln code 061 zip code 71273

3. Classification

Table with columns: Ownership of Property, Category of Property, Number of Resources within Property (Contributing, Noncontributing). Includes checkboxes for private/public ownership and building/site/structure/object categories.

Name of related multiple property listing: N/A
Number of contributing resources previously listed in the National Register: 0

4. State/Federal Agency Certification

As the designated authority under the National Historic Preservation Act of 1966, as amended, I hereby certify that this nomination request for determination of eligibility meets the documentation standards for registering properties in the National Register of Historic Places and meets the procedural and professional requirements set forth in 36 CFR Part 60. In my opinion, the property meets does not meet the National Register criteria. See continuation sheet.
Signature of certifying official Leslie P. Tassin, LA State Historic Preservation Officer, Dept of Culture, Recreation and Tourism
Date September 28, 1990

In my opinion, the property meets does not meet the National Register criteria. See continuation sheet.
Signature of commenting or other official
Date
State or Federal agency and bureau

5. National Park Service Certification

I, hereby, certify that this property is:
[X] entered in the National Register.
[ ] See continuation sheet.
[ ] determined eligible for the National Register. [ ] See continuation sheet.
[ ] determined not eligible for the National Register.
[ ] removed from the National Register.
[ ] other, (explain:)
Entered in the National Register
Signature of the Keeper
Date of Action

---

**6. Function or Use**

---

Historic Functions (enter categories from instructions)

COMMERCIAL/TRADE - Financial Institution

---

---

---

Current Functions (enter categories from instructions)

COMMERCIAL/TRADE - Financial Institution

---

---

---

---

**7. Description**

---

Architectural Classification

(enter categories from instructions)

Beaux Arts

---

---

---

Materials (enter categories from instructions)

foundation concrete

---

walls stone

---

brick

---

roof asphalt

---

other 

---

---

---

**Describe present and historic physical appearance.**

The Ruston State Bank (1910) is a two-story, masonry structure decorated in the Beaux Arts style. It is located near the center of a party-wall block and faces a busy thoroughfare in downtown Ruston. Significant alterations include the loss of most of the interior and a 1955 expansion which took in a former store connecting to the bank on its north side. It is for its intact original Beaux Arts facade that the bank is being nominated to the National Register.

This stone facade is the decorative highlight of the building. Its major feature is an entrance which combines the idea of a Roman triumphal arch with that of a classical temple front. Elements of the Beaux Arts found here include 1) a flamboyant and over-large coffered barrel vault which breaks through the entablature above it, 2) two sets of monumental paired pilasters 3) the presence of a watertable which makes the building appear to stand upon a pedestal, 4) the use of sculpted elements (in this case anthemions) to enliven the roofline, and 5) the existence of excessive sculpted decoration in the spandrels of the arch and the tympanum of the pediment. This bas relief decoration consists of flowers and cartouches cast in an organic manner vaguely suggesting the influence of the Art Nouveau style. In addition to its Beaux Arts elements, the facade also displays a number of classical motifs. These include 1) Ionic capitals composed of scrolls and anthemions, 2) a pediment highlighted by a modillion band outlining its cornice, 3) a dentil band outlining the entablature, and 4) a second set of paired pilasters rising above and behind the pediment. The other walls of the structure (where visible above their party wall connections) are composed of brick laid in a simple common bond pattern.

In addition to the changes and additions described above, the bank has experienced the following alterations: 1) the 1927 installation of a clock on the facade, 2) replacement of windows and exterior doors, and 3) the covering of several openings on the rear elevation. The 1910 interior was destroyed by fire and no part remains. Almost all of a 1924 interior which replaced the earlier features was remodeled in conjunction with the 1955 expansion. Only a set of bas relief classical panels depicting griffins remains from the 1924 version. None of these changes is significant enough to seriously challenge the integrity of the building. The elaborately articulated facade remains virtually intact, the current openings are the same size and shape as the originals, and the exterior of the 1955 addition has been faced in stone in a style compatible with that of the original bank building. The clock is itself a historic addition and does not detract from the facade. The building is clearly recognizable as the structure erected by the Ruston State Bank in 1910 and is a landmark in Ruston's Central Business District. As such, it retains its National Register eligibility.

 See continuation sheet

**8. Statement of Significance**

Certifying official has considered the significance of this property in relation to other properties:

nationally     statewide     locally

Applicable National Register Criteria     A     B     C     D

Criteria Considerations (Exceptions)     A     B     C     D     E     F     G N/A

Areas of Significance (enter categories from instructions)  
architecture

Period of Significance  
1910

Significant Dates  
1910

Cultural Affiliation

N/A

Significant Person  
N/A

Architect/Builder  
unknown

State significance of property, and justify criteria, criteria considerations, and areas and periods of significance noted above.

The Ruston State Bank is locally significant in the area of architecture because it is a landmark among the early twentieth century buildings of downtown Ruston. It is also the only example of the Beaux Arts style within the community's Central Business District.

Although Ruston was founded in 1883, most of the buildings in its commercial district date from the early twentieth century. With the exception of a few late Italianate style business houses, the city's French style Federal Building, a late Gothic Revival style church, and two structures in the Moderne style, most of these buildings are block-like one and two story party-wall structures of plain utilitarian design. Many are distinguished by nothing more than slightly corbelled cornices. Against this background, the monumental Ruston State Bank stands as a visual landmark. With its set of paired monumental pilasters, its coffered barrel vault, and its highly articulated pediment and tympanum, the bank is clearly the most elaborately styled structure in the downtown area. Thus, it is a strong candidate for National Register listing.

Historical Note

The Ruston State Bank was founded in 1890. Although the downtown branch bank moved to a new building sometime after 1976, the 1910 Beaux Arts branch still functions as the bank's Trust and Financial Services Center.

See continuation sheet

**9. Major Bibliographical References**

Fletcher, Mary Frances, and Ropp, Ralph L., eds. Lincoln Parish History, Marceline, Mo.: Walsworth Publishing Company, 1976.

History of Ruston State Bank, typescript. Copy in National Register file.

Windshield survey of Ruston Central Business District.

See continuation sheet

Previous documentation on file (NPS): N/A

preliminary determination of individual listing (36 CFR 67) has been requested

previously listed in the National Register

previously determined eligible by the National Register

designated a National Historic Landmark

recorded by Historic American Buildings Survey # \_\_\_\_\_

recorded by Historic American Engineering Record # \_\_\_\_\_

Primary location of additional data:

State historic preservation office

Other State agency

Federal agency

Local government

University

Other

Specify repository: \_\_\_\_\_

**10. Geographical Data**

Acree of property less than one acre

UTM References

A 

1	5	5	3	3	9	0	0	3	5	9	8	9	5	0
Zone		Easting				Northing								

B 

Zone		Easting				Northing								

C 

--	--	--	--	--	--	--	--	--	--	--	--	--	--	--

D 

--	--	--	--	--	--	--	--	--	--	--	--	--	--	--

See continuation sheet

**Verbal Boundary Description**

Please refer to enclosed sketch map.

See continuation sheet

**Boundary Justification**

Boundary lines follow property lines. As shown on the sketch map, the northern and southern boundaries are party walls.

See continuation sheet

**11. Form Prepared By**

name/title National Register Staff  
organization Division of Historic Preservation date August 1990  
street & number P. O. Box 44247 telephone (504) 342-8160  
city or town Baton Rouge state Louisiana zip code 70804

Owner: Ruston State Bank  
P. O. Box 1130  
Ruston, LA 71273-1130

# Ruston State Bank

Ruston, Lincoln Parish, LA.

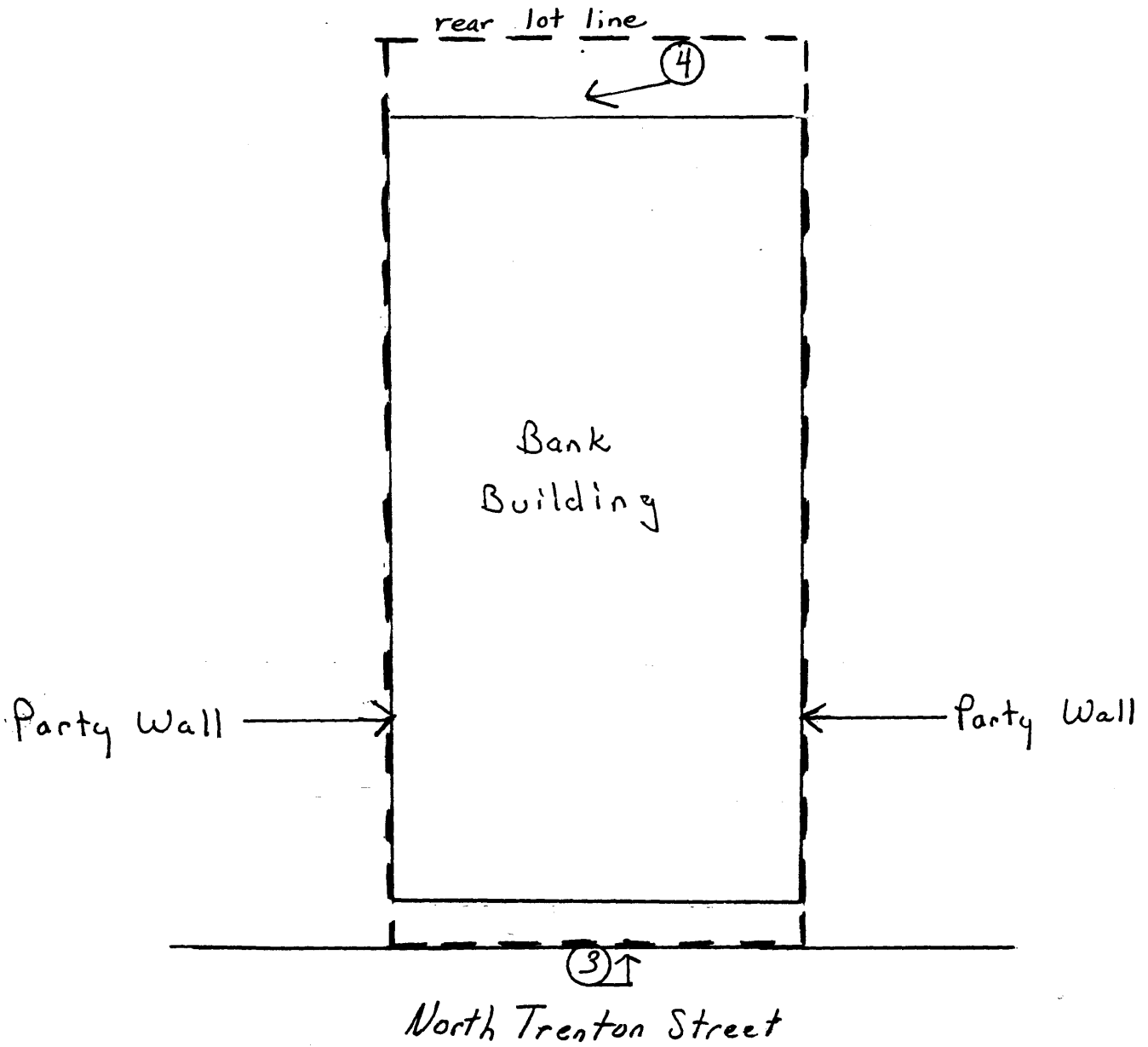

Boundary - - - -  
Scale : 1" = 20'

