

United States Department of the Interior National Park Service

National Register of Historic Places Registration Form

JAN 17 1989

NATIONAL REGISTER

This form is for use in nominating or requesting determinations of eligibility for individual properties or districts. See instructions in Guidelines for Completing National Register Forms (National Register Bulletin 16). Complete each item by marking "x" in the appropriate box or by entering the requested information. If an item does not apply to the property being documented, enter "N/A" for "not applicable." For functions, styles, materials, and areas of significance, enter only the categories and subcategories listed in the instructions. For additional space use continuation sheets (Form 10-900a). Type all entries.

1. Name of Property

historic name Engine Company 15 Fire Station other names/site number

2. Location

street & number 8 Fairfield Avenue city, town Hartford state Connecticut code CT county Hartford code 003 zip code 06114

3. Classification

Ownership of Property: public-local (checked). Category of Property: building(s) (checked). Number of Resources within Property: Contributing 1, Noncontributing 0. Name of related multiple property listing: Firehouses of Hartford, Connecticut.

4. State/Federal Agency Certification

As the designated authority under the National Historic Preservation Act of 1966, as amended, I hereby certify that this nomination request for determination of eligibility meets the documentation standards for registering properties in the National Register of Historic Places and meets the procedural and professional requirements set forth in 36 CFR Part 60. In my opinion, the property meets the National Register criteria. Signature of certifying official: [Signature], Director, Connecticut Historical Commission, January 10, 1989.

In my opinion, the property meets the National Register criteria. Signature of commenting or other official: _____ Date: _____

5. National Park Service Certification

I, hereby, certify that this property is: entered in the National Register. Entered in the National Register 3/2/89. Signature of the Keeper: [Signature]

6. Function or Use

Historic Functions (enter categories from instructions)

GOVERNMENT/fire station

Current Functions (enter categories from instructions)

GOVERNMENT/fire station

7. Description

Architectural Classification
(enter categories from instructions)

Colonial Revival

Materials (enter categories from instructions)

foundation brick

walls brick

roof other: tar and gravel

other stone

Describe present and historic physical appearance.

The firehouse of Engine Company 15 is located approximately two miles southwest of Hartford's downtown in an area of commercial and residential structures across from Trinity College. Built in 1909, the two-story brick building was designed in the Colonial Revival style, with its decorative features generally restricted to its facade.

The foundation of the building is composed of brownstone blocks on the facade, and brick elsewhere. The walls above are composed of red brick, with projecting courses along the corners of the facade imitating quoins (Photographs 1,3). Windows throughout the building are two-over-one double-hung sash, and are grouped in sets of threes along the facade. Above the facade windows are splayed brick lintels with stone keystones. Two stone string courses run along the facade between the first and second-floor levels above two square entrance bays with metal overhead doors. Below the flat roof and along the top of the walls runs a line of corbelled bricks (Photograph 2).

Early photographs reveal that the firehouse originally had a stone modillioned cornice and frieze along its facade as well as splayed lintels above the entrance bays (Photograph 4). These were removed sometime after 1911. Other features on the exterior appear to remain intact.

The first-floor apparatus room is supported by reinforced concrete piers in the basement, while the second floor is supported by steel and wood beams. The walls of the apparatus room are brick, marked at their center with a decorative brick string course, and the ceiling is covered in wood wainscot paneling (Photograph 5). Recessed at intervals in the wall are semi-circular spaces housing the sliding poles. To the rear of the first floor, behind the apparatus room, are a kitchen and lounge, an area which once served as the horses' stables. Still extant are iron posts set at regular intervals which marked the stall spaces.

The second floor retains much of what appears to be original woodwork, including door and window trim, double doors concealing the slide poles, and a few large wooden lockers. A drop ceiling has been added throughout most of this floor. To the rear of the second floor is a room which served as the hayloft, still with its loading door and exposed joists characteristic of such rooms.

A simple hose tower is located in the left center of the building near the stairway. Main features of the basement include wooden horizontal hose-drying racks and a coal bin in the furnace area.

8. Statement of Significance

Certifying official has considered the significance of this property in relation to other properties:

nationally statewide locally

Applicable National Register Criteria A B C D

Criteria Considerations (Exceptions) A B C D E F G N/A

Areas of Significance (enter categories from instructions)

Architecture
Community Planning and Development

Period of Significance

1909-1938

Significant Dates

1909

Cultural Affiliation

N/A

Significant Person

N/A

Architect/Builder

Zunner and Sellew

State significance of property, and justify criteria, criteria considerations, and areas and periods of significance noted above.

8 Fairfield Avenue was the first firehouse built for Engine Company 15, organized in 1909. It is one of two surviving Hartford firehouses built to house both men and horses. The loss of some of its exterior architectural features is compensated by the retention of interior features which clearly place it in this distinct period in the history of Hartford's fire service. Overall, the firehouse displays good integrity and is a fine example of the Colonial Revival style applied to the design of a firehouse.

The station was designed by Zunner and Sellew, a Hartford architectural partnership of George Zunner (1861-1936) and Burton A. Sellew (1878-1932), who practiced together briefly around 1908. Characteristic of their work are Neo-Classical commercial buildings with heavy cornices and splayed lintels, like those of the firehouse.

The firehouse meets the requirements for registration as outlined in the multiple property submission, "Firehouses of Hartford." Its original massing and layout are intact, and the basic elements that mark it as a firehouse remain: the large entrance bays, apparatus room, hose-drying tower and racks, upstairs sleeping quarters, watchroom, and sliding poles and chutes.

Taken as a whole, the firehouse retains integrity of design, materials, setting, and association. A basis on which to evaluate its significance is contained within the associated historic context, "Fire Service in Hartford, 1789-1939."

9. Major Bibliographical References

See multiple property form.

Previous documentation on file (NPS): N/A
 preliminary determination of individual listing (36 CFR 67) has been requested
 previously listed in the National Register
 previously determined eligible by the National Register
 designated a National Historic Landmark
 recorded by Historic American Buildings Survey # _____
 recorded by Historic American Engineering Record # _____

See continuation sheet

Primary location of additional data:

- State historic preservation office
- Other State agency
- Federal agency
- Local government
- University
- Other

Specify repository:

Connecticut Historical Society

10. Geographical Data

Acreeage of property approximately .25 acre

UTM References

A

1	8
---	---

6	9	1	8	9	5
---	---	---	---	---	---

4	6	2	3	4	7	5
---	---	---	---	---	---	---

Zone Easting Northing

B

--	--

--	--	--	--	--	--

--	--	--	--	--	--	--

Zone Easting Northing

C

--	--

--	--	--	--	--	--

--	--	--	--	--	--	--

D

--	--

--	--	--	--	--	--

--	--	--	--	--	--	--

See continuation sheet

Verbal Boundary Description

The nominated property occupies the City of Hartford Parcel Number 133-001-024.

See continuation sheet

Boundary Justification

The boundary of the property surrounds the building and the immediate setting historically associated with the firehouse.

See continuation sheet

11. Form Prepared By

Reviewed by John Herzan, National Register Coordinator

name/title Janice Elliott and David Ransom/Consultants
organization Connecticut Historical Commission date May 22, 1988
street & number 56 S. Prospect St. telephone 203-566-3005
city or town Hartford state CT zip code 06106

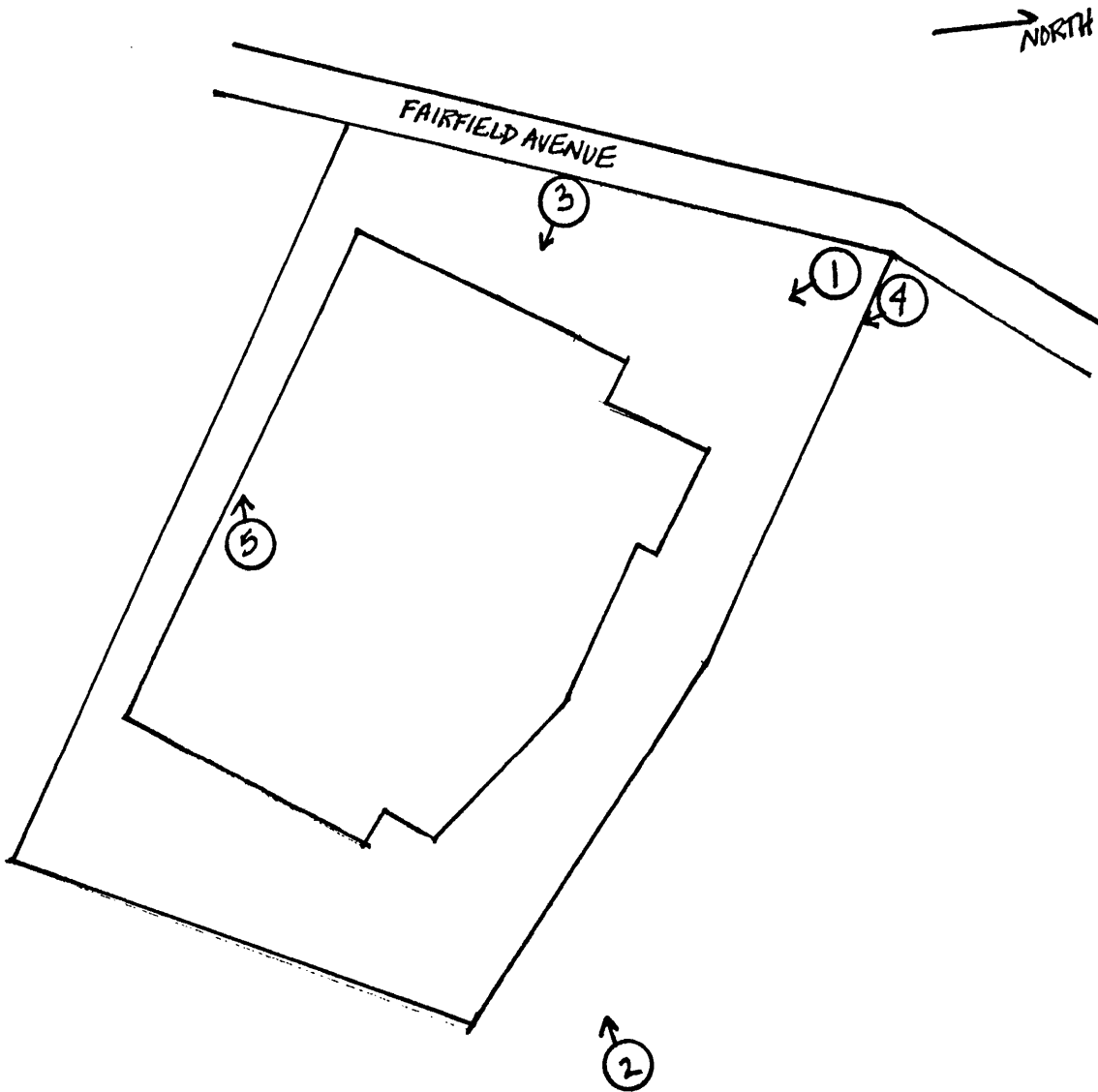

Sketch Map

Engine Company 15 Fire Station
8 Fairfield Avenue
Hartford, Connecticut

Not to Scale

Photo Key: ○→

United States Department of the Interior
National Park ServiceNational Register of Historic Places
Continuation Sheet8 Fairfield Avenue
Hartford, ConnecticutSection number Photos Page 1Photographs

All photographs were taken by Janice L. Elliott in April, 1988, unless otherwise noted. Negatives are on file with the Connecticut Historical Commission. Any photographs marked with an asterisk (*) may be reproduced only with permission of the Connecticut Historical Society, 1 Elizabeth Street, Hartford, Connecticut. Negatives for those photographs are on file with the Connecticut Historical Society.

<u>Number</u>	<u>Description</u>	<u>View</u>	<u>Comment</u>
1	8 Fairfield Avenue North and east elevations.	Southwest	
2	8 Fairfield Avenue East and south elevations.	Northwest	
3	8 Fairfield Avenue Detail, facade.	South	
4	8 Fairfield Avenue As it appeared in 1911.	Southwest	*CHS Photo
5	8 Fairfield Avenue Interior, wall of apparatus room.	Northwest	