

HARRISVILLE HISTORIC AND ARCHITECTURAL RESOURCES SURVEY  
INDIVIDUAL INVENTORY FORM

DISTRICT: -- SITE #: IP-4

PROPERTY NAME (HISTORIC): The Jabez Townsend House	OWNER (ORIGINAL): Jabez Townsend
PROPERTY NAME:	OWNER: Fred W. and Florence C. Abbt
LOCATION: At the southeast corner of the intersection of East Harrisville and Cherry Hill Roads.	ADDRESS: P. O. Box 222 Peterborough 03458
UTM REFERENCES: 18-741750-4757100	ACREAGE: 1.0 RANGE/LOT: IX-5-10
USGS QUADRANGLE: Monadnock	VERBAL BOUNDARY DESCRIPTION/JUSTIFICATION: See Site Map
DATE: 1853	
SOURCE: Town history, Deed and tax records	

PHYSICAL DESCRIPTION: The Jabez Townsend House adopts the ubiquitous gable-end-to-the-street 1½ story sidehall plan Greek Revival form which came to be the town's most persistent and popular style for the majority of the 19th century. An early example and the best preserved of its type in East Harrisville, it is clad in red clapboard with white trim and boasts stylish shouldered architraves over its 6/6 windows and principal entry door. A large upstairs dormer, a rear ell and a free standing garage have been added to the property. The house, which faces east toward the intersection, enjoys a setting of large old oaks and maples and huge glacial boulders now closed in enough to belie its original use as a farmhouse.

STATEMENT OF SIGNIFICANCE: The Jabez Townsend House is an especially stylish example of a locally popular 19th century building type which is additionally notable because it was built during a period (1853) when there was considerably more local construction in villages (cf. Pottersville and Harrisville Village) than in declining outlying areas. It is also distinguished by its current high level of maintenance and thus satisfies Criterion C of the National Register of Historic Places. Built as a farmhouse by a member of the prominent and active Townsend family, it is also noted for its association with and ownership by the Farwells. Lewis Farwell was postmaster for Eastview from 1898-c.1911, when the office was discontinued. Thus, historical associations, in addition to the fact that it is one of very few buildings to survive with any integrity in the once-flourishing settlement of Eastview, qualify it for nomination under Criterion A as well.

REFERENCES:

Deeds  
History of Dublin  
Tax Records

MAP: SEE CONTINUATION SHEET

DESCRIPTION OF VIEW:

Front elevation (east)  
Facing west

PHOTOGRAPHER: L. Shonk

NEGATIVE FILE #: 1-13; 12/6/83

RECORDED BY: Shonk/Meath/Cini

SPONSORING ORGANIZATION:

Historic Harrisville, Inc.

DATE: September 1983



HARRISVILLE HISTORIC AND ARCHITECTURAL RESOURCES SURVEY  
INDIVIDUAL INVENTORY FORM

DISTRICT	SITE #.
	IP-4

PROPERTY NAME (HISTORIC): The Jabez Townsend House	OWNER (ORIGINAL): Jabez Townsend
PROPERTY NAME:	OWNER: Fred W. and Florence C. Abbt
LOCATION: At the southeast corner of the intersection of East Harrisville and Cherry Hill Roads.	ADDRESS: P. O. Box 222 Peterborough 03458
	ACREAGE: 1.0      RANGE/LOT:

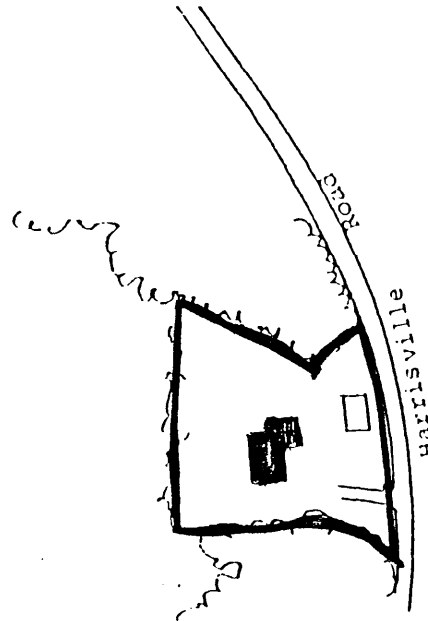

SCALE 1"=200'

- Contributing
- Non-contributing

VERBAL BOUNDARY DESCRIPTION / JUSTIFICATION:

Bounded on the north by the edge of trees, on the east by the Harrisville Road and on the south and west by the edge of trees.

Includes the immediate visual surroundings incorporating the features contributing to the property's architectural and historical significance.

Noted as property IP-4 on Town of Harrisville Map, included with this nomination.

The boundaries of the property are indicated by the heavy black line on the sketch map above.

United States Department of the Interior  
National Park Service

National Register of Historic Places  
Inventory—Nomination Form

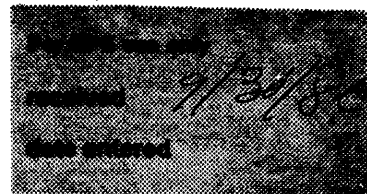

265  
4

Continuation sheet

Item number

Page

Multiple Resource Area  
Thematic Group

dnr-11

Name Harrisville MRA  
State Cheshire County, NEW HAMPSHIRE

~~Substantive Review~~ *over*

Patrick Andrus 1/14/88

Nomination/Type of Review

Date/Signature

1. Beech Hill Summer Home ✓  
District

~~Substantive Review~~ *for* Keeper

Patrick Ward Andrus 1/14/88

Attest

Betty L. Savage 1/14/88

2. Chesham Village District

~~Entered in the National Register~~ Keeper

Shelton Byers 1/24/88

Attest

3. Eaton, Moses, Jr., ✓  
House

~~Substantive Review~~ *for* Keeper

Patrick Andrus 1/14/88

Attest

Betty L. Savage 1/14/88

4. Gilchrest Homestead ✓

~~Substantive Review~~ *for* Keeper

Patrick Andrus 1/14/88

Attest

Betty L. Savage 1/14/88

5. Glenchrest ✓

~~Substantive Review~~ *for* Keeper

Patrick Andrus 1/14/88

Attest

Betty L. Savage 1/14/88

6. Harrisville Rural District

~~Substantive Review~~

Keeper

J. Rogers 2-18-87

Attest

7. Pottersville District

~~Entered in the National Register~~ Keeper

Shelton Byers 1/24/88

Attest

8. Silver Lake District

~~Entered in the National Register~~ Keeper

Shelton Byers 1/24/88

Attest

9. Stationmaster's House ✓

~~Substantive Review~~ *for* Keeper

Patrick Andrus 1/14/88

Attest

Betty L. Savage 1/14/88

10. Townsend, Jabez, House ✓

~~Substantive Review~~ *for* Keeper

Patrick Andrus 1/14/88

Attest

Betty L. Savage 1/14/88

- 50  
revised