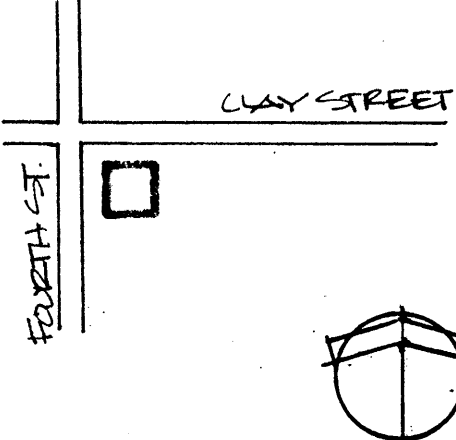

KENTUCKY HISTORIC RESOURCES INVENTORY

Site No. Sh - s60

1. Historic Name(s) Original Owner		22. ADD/County KIPDA / SHELBY 106	
2. Present Name Saffell Funeral Home		23. U.S.G.S. Quadrant (15'/75') SHELBYVILLE G.I.S. Mod. <input type="checkbox"/>	
3. Location <u>Corner of Fourth and Clay Sts.</u>		24. UTM Reference <u>16</u> <u>6563810</u> <u>42303810</u> Zone Easting Northing	
4. Owner's Name Mildred Saffell/ Charles Austin		25. Coordinate Accuracy <input type="checkbox"/>	
5. Owner's Address Box 427 Shelbyville, Ky. 40065		26. Prehistoric Site Historic Site <input type="checkbox"/> X Building <input checked="" type="checkbox"/> Other <input type="checkbox"/>	
6. Open to Public Yes <input type="checkbox"/> No <input type="checkbox"/>		7. Visible from road Yes <input checked="" type="checkbox"/> No <input type="checkbox"/>	
9. Local Contact/Organization SHELBY COUNTY HISTORICAL SOCIETY		8. Ownership Private <input type="checkbox"/> Local <input type="checkbox"/> State <input type="checkbox"/> Federal <input type="checkbox"/>	
10. Site Plan with North Arrow 		11. Architect	
		12. Builder	
		13. Date 1830 A. <input checked="" type="checkbox"/> B. <input type="checkbox"/>	
		14. Style A. Federal <input checked="" type="checkbox"/> B. <input type="checkbox"/>	
		15. Original Use S.F. Residence <input checked="" type="checkbox"/>	
		16. Present use Funeral Home	
		17. Condition Fair <input checked="" type="checkbox"/>	
18. Description Two story, three bay brick now stuccoed; side passage plan; interior end chimneys; faces Clay Street; detached two stage outbuilding borders 4th Street On 1882 Lake Map Lot # 52 Original Plat (Continue on Back)		19. History George Saffell bought the lot and the buildings from J.G. Goodman in 1929 (DB 108, page 70); J.G. Goodman received the property from J.W. Goodman; (Will Book 42, p.446)	
		20. Significance Despite early 20th century application of stucco this structure on an original town lot still provides an important link to Shelbyville's early settlement through its Federal characteristics and detailing.	
		21. Source of Information its Federal characteristics and detailing.	
		27. National Register District Name: MULTIPLE RESOURCES OF SHELBYVILLE _____	
		28. Significance Evaluation National Register <input type="checkbox"/>	
		29. Status National Landmark <input type="checkbox"/> Date _____ National Register <input type="checkbox"/> Landmark Certificate <input type="checkbox"/> Kentucky Survey <input type="checkbox"/> Local Landmark <input type="checkbox"/> HABS/HAER <input type="checkbox"/>	
		30. Historic Theme Primary <input type="checkbox"/> Secondary <input type="checkbox"/> Other <input type="checkbox"/>	
		31. Endangered Yes <input type="checkbox"/> No <input type="checkbox"/>	
		32. Preservation Project Status <input type="checkbox"/>	
		33. Roll No. <u>6: 17, 18, 19</u>	
		34. Prepared by: Helen Powell	
		35. Organization CARMAN AND POWELL, INC.	
		36. Date 1983	
		37. Revision Dates	
		38. Staff Review	

KENTUCKY HISTORIC RESOURCE INVENTORY SUPPLEMENT
BOUNDARY AND LOCATION INFORMATION

Historic Property Name Saffel Funeral Home Site # _____

Multiple Resource/Thematic Nomination Title Multiple Resources of Shelbyville

U.T.M. Coordinates - List multiple UTMs if property is ten or more acres.

A. 16 656380 4230380 D. _____

B. _____ E. _____

C. _____ F. _____

Verbal Boundary Description Acreage less than 1/2 acre

Beginning at a point in the northwest corner of the intersection of Fourth St. and Clay St.; then south 45 feet along the east right of way of Fourth Street to a point; then east 85 feet to a point; then north 45 feet to a point; then west with the south right of way of Clay Street to a point.

Sketch of Site Plan (Showing outbuildings, structures, landscape features and the site boundary as described above.)

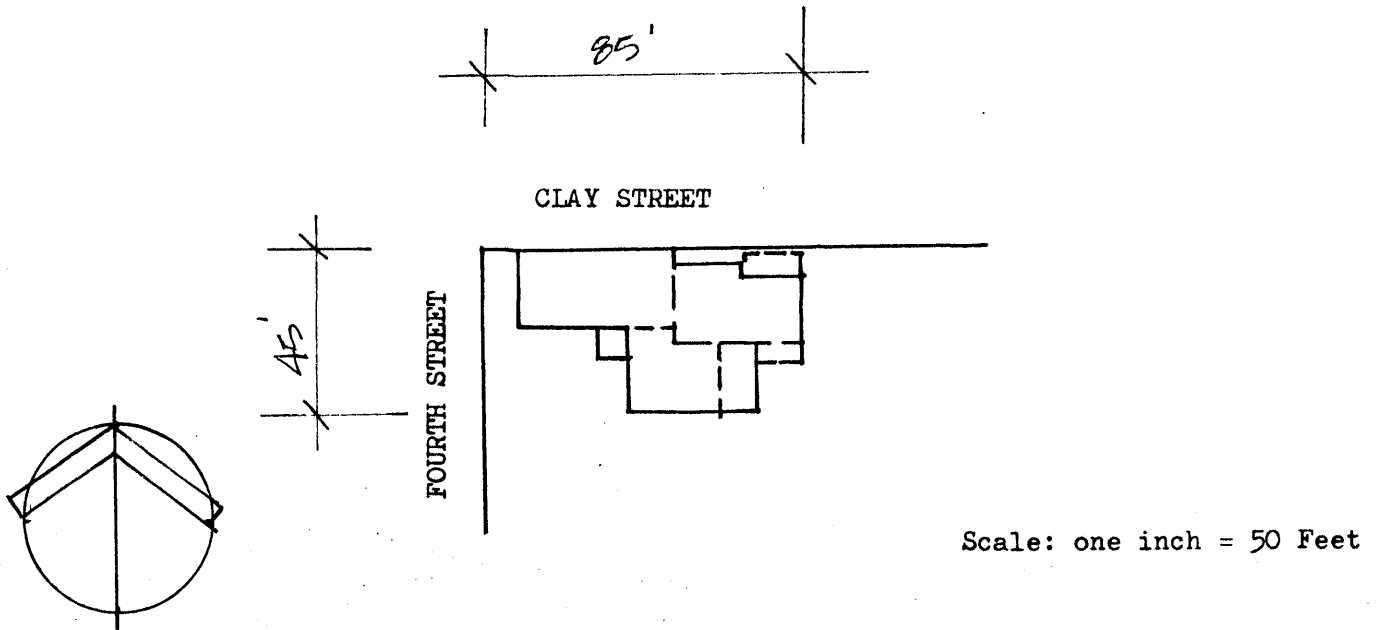

Official Courthouse Property Reference: