

FORM B - BUILDING

MASSACHUSETTS HISTORICAL COMMISSION
80 BOYLSTON STREET
BOSTON, MA 02116

AREA FORM NO.

163	NC-97
-----	-------

Town Newton, Mass. M.R.A.
Newton (Newton Centre)

Address 15 Bracebridge Road

Historic Name Mount Pleasant

Photo (3"x3" or 3"x5", black and white) Indicate address of property on back of photo. Staple to left side of form.

Use: Present dwelling

Original dwelling

DESCRIPTION

Date circa 1856

Source Water Records, stylistic analysis

Style Italianate

Architect unknown

Exterior Wall Fabric clapboard

Outbuildings none

Major Alterations (with dates) c.1890-
Colonial Revival decorative motifs

Condition Very Good

Moved no Date _____

Acreage 55213 sq. ft. (1.27 acres)

Setting suburban residential along
Cochituate Aqueduct.

Recorded by Archit, Pres, Assocs.

Organization Newton Historical Comm.

Date 5/83; rev. by H. White 3/86

Sketch Map: Draw map showing property's location in relation to nearest cross streets and/or geographical features. Indicate all buildings between inventoried property and nearest intersection(s). Indicate north

(SEE ATTACHED MAP)

UTM REFERENCE 19.318550.4688720

USGS QUADRANGLE NEWTON, MASS.

SCALE 1:25,000

NATIONAL REGISTER CRITERIA STATEMENT (if applicable)

Mount Pleasant is a well-preserved example of the Italianate style in Newton Centre, and has important associations with Roswell Turner and Charles Davis, both important figures in the nineteenth century development of the area; the house therefore meets Criteria B and C of the National Register of Historic Places.

ARCHITECTURAL SIGNIFICANCE Describe important architectural features and evaluate in terms of other buildings within the community.

Mount Pleasant represents the mainstream of Italianate design during the 1860s, as well as the suburban vogue for the Colonial Revival during the 1890s. This 2½ story house has a low-pitched gable roof of slate. The three-bay, center gabled facade with its shallow entrance pavilion are typical of the conservative and academic versions of the Italianate style. The hip-roofed tower and bracketed window lintels are characteristic features of the style. In the 1890s the house was given a Colonial Revival re-trimming which included applied pilasters on the center pavilion, and a portico on the south elevation. The unusual openwork enframingent of the entrance porch can also be seen on the Seth Adams house, c.1854, 72 Jewett Street, Newton Corner.

HISTORICAL SIGNIFICANCE Explain the role owners played in local or state history and how the building relates to the development of the community.

West of Centre Street, the area between Pelham Street and the pond was first developed by Roswell Turner, who began to acquire property there in the 1840s. In the 1860s many of the Turner properties, including his home at 15 Bracebridge Road (known as Mount Pleasant), were acquired by Charles S. Davis. King's Handbook of Newton (1889) comments that the Mount Pleasant estate was "notable for its luxuriant pine woods, and great ledges of conglomerate rock and picturesque flanking knolls." Charles S. Davis was an associate of the Boston piano manufacturing firm of Hallett & Davis, a member of the First Church and a regular participant in community affairs. Until his death in 1907, he played an active role in the development of Newton Centre.

BIBLIOGRAPHY and/or REFERENCES

Atlases: 1874, 1886, 1895, 1907

Maps: 1855

City Directories: 1907-George Taylor, Manager, Sears Bldg. B, house 106 Gibbs St.

Newton's 19th C. Architecture: Newton Centre, Oak Hill, Chestnut Hill, Comm. Ave.

Newton Historical Comm. 1985. p. 12.

**United States Department of the Interior
National Park Service**

**National Register of Historic Places
Inventory—Nomination Form**

For NPS use only

received 7/23/86

date entered

Continuation sheet

Item number

Page

Multiple Resource Area
Thematic Group

Name Newton MRA
State Middlesex County, MA

Nomination/Type of Review

Entered in the
National Register

Date/Signature

81. Hyde, Gershom, House

for Keeper Delores Byers 9/4/86

Attest

82. Jackson House

Entered in the
National Register

for Keeper Delores Byers 9/4/86

Attest

83. Jackson, Samuel, Jr.,
House

for Keeper Delores Byers 9/4/86

Attest

84. Jennison, Joshua, House

Entered in the
National Register

for Keeper Delores Byers 9/4/86

Attest

85. Judkins, Amos, House

Entered in the
National Register

for Keeper Delores Byers 9/4/86

Attest

86. King House

Entered in the
National Register

for Keeper Delores Byers 9/4/86

Attest

87. Kingsbury House

Entered in the
National Register

for Keeper Delores Byers 9/4/86

Attest

88. Kistler House

Entered in the
National Register

for Keeper Delores Byers 9/4/86

Attest

89. Merriam, Galen, House

Entered in the
National Register

for Keeper Delores Byers 9/4/86

Attest

90. Mount Pleasant

Entered in the
National Register

for Keeper Delores Byers 9/4/86

Attest

NATIONAL REGISTER OF HISTORIC PLACES
EVALUATION/RETURN SHEET

Mount Pleasant (Newton MRA)
Middlesex County
MASSACHUSETTS

Working No. _____
Fed. Reg. Date: JUL 23 1986 2/3/87
Date Due: 8/21/86 - 9/6/86
Action: ACCEPT 9-9-86
 RETURN
 REJECT
Federal Agency: _____

Entered in the
National Register

- resubmission
- nomination by person or local government
- owner objection
- appeal

Substantive Review: sample request appeal NR decision

Reviewer's comments:

Recom./Criteria _____
Reviewer _____
Discipline _____
Date _____
_____ see continuation sheet

Nomination returned for: technical corrections cited below
 substantive reasons discussed below

1. Name

2. Location

3. Classification

Category	Ownership Public Acquisition	Status Accessible	Present Use
----------	---------------------------------	----------------------	-------------

4. Owner of Property

5. Location of Legal Description

6. Representation in Existing Surveys

Has this property been determined eligible? yes no

7. Description

Condition	Check one	Check one
<input type="checkbox"/> excellent	<input type="checkbox"/> deteriorated	<input type="checkbox"/> original site
<input type="checkbox"/> good	<input type="checkbox"/> ruins	<input type="checkbox"/> moved date _____
<input type="checkbox"/> fair	<input type="checkbox"/> unexposed	

Describe the present and original (if known) physical appearance

- summary paragraph
- completeness
- clarity
- alterations/integrity
- dates
- boundary selection



Newton, Mass MRA

Mant Pleasant

- 15 Bracebridge Rd, N. Centre -
K-13 (27)

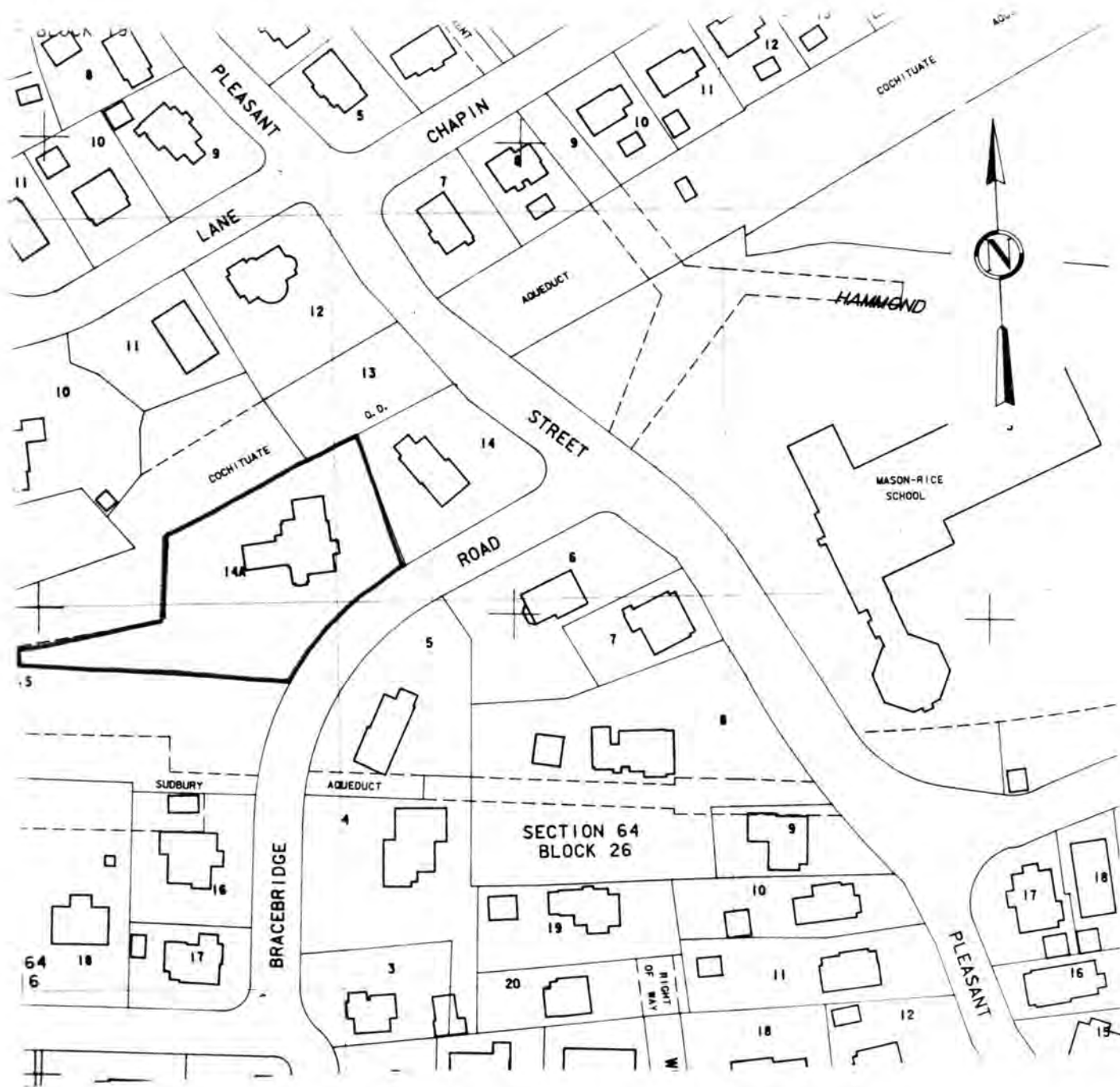

City of Newton Assessor's Maps. Sheet 89
 Metric Series. 1979
 Scale: UTM grid line interval = 100 meters (328 feet)

Newton, Mass. M.R.A.
 15 Bracebridge Road, Newton Centre
 "Mount Pleasant"
 64-16-14A