

**NATIONAL REGISTER OF HISTORIC PLACES
INVENTORY - NOMINATION FORM**

(Type all entries - complete applicable sections)

STATE: Utah	
COUNTY: Beaver	
FOR NPS USE ONLY	
ENTRY NUMBER	DATE
70.10.43.0010	10/6/70

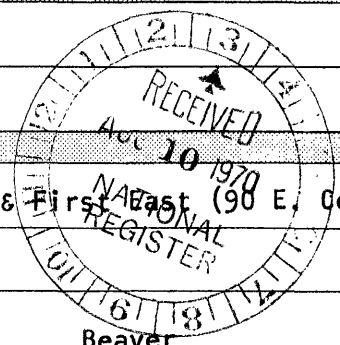

1. NAME

COMMON:
Beaver County Courthouse

AND/OR HISTORIC:

2. LOCATION

STREET AND NUMBER:
Southwest corner of Center Street & First East (98 E. Center)

CITY OR TOWN:
Beaver

STATE: **Utah** CODE: **43** COUNTY: **Beaver** CODE: **001**

3. CLASSIFICATION

CATEGORY (Check One)	OWNERSHIP	STATUS	ACCESSIBLE TO THE PUBLIC
District <input type="checkbox"/> Building <input checked="" type="checkbox"/>	Public <input checked="" type="checkbox"/>	Occupied <input checked="" type="checkbox"/>	Yes: Restricted <input checked="" type="checkbox"/>
Site <input type="checkbox"/> Structure <input type="checkbox"/>	Private <input type="checkbox"/>	Unoccupied <input type="checkbox"/>	Unrestricted <input type="checkbox"/>
Object <input type="checkbox"/>	Both <input type="checkbox"/>	Preservation work in progress <input type="checkbox"/>	No: <input type="checkbox"/>

PRESENT USE (Check One or More as Appropriate)

Agricultural <input type="checkbox"/>	Government <input checked="" type="checkbox"/>	Park <input type="checkbox"/>	Transportation <input type="checkbox"/>	Comments <input type="checkbox"/>
Commercial <input type="checkbox"/>	Industrial <input type="checkbox"/>	Private Residence <input type="checkbox"/>	Other (Specify) <input type="checkbox"/>	
Educational <input type="checkbox"/>	Military <input type="checkbox"/>	Religious <input type="checkbox"/>	Courthouse	
Entertainment <input type="checkbox"/>	Museum <input type="checkbox"/>	Scientific <input type="checkbox"/>		

4. OWNER OF PROPERTY

OWNERS NAME:
Beaver County

STREET AND NUMBER:
90 East Center Street

CITY OR TOWN: **Beaver** STATE: **Utah** CODE: **43**

5. LOCATION OF LEGAL DESCRIPTION

COURTHOUSE, REGISTRY OF DEEDS, ETC.:
Beaver County Courthouse

STREET AND NUMBER:
90 East Center Street

CITY OR TOWN: **Beaver** STATE: **Utah** CODE: **43**

APPROXIMATE ACREAGE OF NOMINATED PROPERTY: **0.8**

6. REPRESENTATION IN EXISTING SURVEYS

TITLE OF SURVEY:
Utah Historical American Buildings Survey

DATE OF SURVEY: **1968** Federal State County Local

DEPOSITORY FOR SURVEY RECORDS:
Utah Heritage Foundation

STREET AND NUMBER:
603 East South Temple

CITY OR TOWN: **Salt Lake City** STATE: **Utah** CODE: **43**

SEE INSTRUCTIONS

STATE: **Utah**
COUNTY: **Beaver**
FOR NPS USE ONLY
ENTRY NUMBER: **70.10.43.0010**
DATE: **10/6/70**

7. DESCRIPTION

CONDITION	(Check One)					
	Excellent <input type="checkbox"/>	Good <input checked="" type="checkbox"/>	Fair <input type="checkbox"/>	Deteriorated <input type="checkbox"/>	Ruins <input type="checkbox"/>	Unexposed <input type="checkbox"/>
INTEGRITY	(Check One)			(Check One)		
	Altered <input checked="" type="checkbox"/>	Unaltered <input type="checkbox"/>		Moved <input type="checkbox"/>	Original Site <input checked="" type="checkbox"/>	

DESCRIBE THE PRESENT AND ORIGINAL (if known) PHYSICAL APPEARANCE

The red brick two-story building, with basement and attic, exemplifies Victorian pretentiousness in public buildings of the 1880's. The overall dimensions are 39' x 55' excluding the rear additions. The foundations are whitewashed sandstone. The brick wall has a three-course projecting water table and headers each ninth course. The floors and roof are wood frame. The front steps have eleven risers and a curved sandstone railing partially plastered over. The front entrance is sheltered by a balcony supported by turned struts.

The main entrance doors are three-panel with a glass transom with a single vertical muntin. The windows and entrance openings are elliptically arched with brick voussoirs and ornamental wood keystones.

The roof is a steep green shingled mansard and low pitch standing seam. Small hipped dormers flank the large gabled dormers east and west and north tower. Tower has a clock on three sides in gables surmounted by shingle broach roof transition to octagonal louvered lantern topped by octagonal dome with four bullseye windows and iron weathervane.

The basement has vertical deep rooms open from the central hall. The first floor contains offices open to left and right of central corridor leading past the stair. A square courtroom occupies the front of the second floor. Behind is a stair landing with offices on either side. The attic is partially finished as small offices.

The original wood flooring has been covered with linoleum. The walls and ceilings are painted plaster. Interior doors are five panel with glass transoms to offices.

The courtroom ceiling is divided into nine coffers by beams in both directions with acorn pendants at intersections. Beams rest on turned struts coming out of flat pilasters. Two metal pipe columns under the back corners of this tower have metal capitals ornamented with leaves and an ornamental band at eye level. The judge's bench has small heavily moulded panels behind heavily ornamented columnar forms which support a sort of cornice which surrounds the counter surface. Windows and doors are framed with fluted pilasters; keystones of the elliptical arches are brackets surmounted by segmental arched pediments. Railings have partially turned balusters and newels with hemispherical bumps on balusters and sides of railing.

Though having undergone minor alterations, the structure's integrity remains. The site could easily be restored to a first-rate condition.

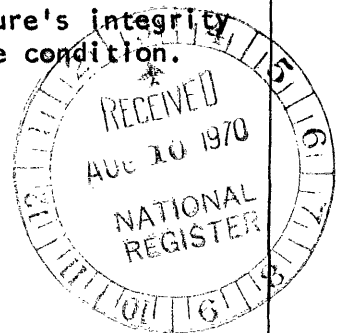

SEE INSTRUCTIONS

8. SIGNIFICANCE

PERIOD (Check One or More as Appropriate)

Pre-Columbian 16th Century 18th Century 20th Century
 15th Century 17th Century 19th Century

SPECIFIC DATE(S) (If Applicable and Known)

AREAS OF SIGNIFICANCE (Check One or More as Appropriate)

Aboriginal	<input type="checkbox"/>	Education	<input type="checkbox"/>	Political	<input checked="" type="checkbox"/>	Urban Planning	<input type="checkbox"/>
Prehistoric	<input type="checkbox"/>	Engineering	<input type="checkbox"/>	Religion/Phi-		Other (Specify)	<input type="checkbox"/>
Historic	<input type="checkbox"/>	Industry	<input type="checkbox"/>	losophy	<input type="checkbox"/>	_____	
Agriculture	<input type="checkbox"/>	Invention	<input type="checkbox"/>	Science	<input type="checkbox"/>	_____	
Art	<input type="checkbox"/>	Architecture		Sculpture	<input type="checkbox"/>	_____	
Commerce	<input type="checkbox"/>	Architecture	<input checked="" type="checkbox"/>	Social/Human-		_____	
Communications	<input type="checkbox"/>	Literature	<input type="checkbox"/>	itarian	<input type="checkbox"/>	_____	
Conservation	<input type="checkbox"/>	Military	<input type="checkbox"/>	Theater	<input type="checkbox"/>	_____	
		Music	<input type="checkbox"/>	Transportation	<input type="checkbox"/>	_____	

STATEMENT OF SIGNIFICANCE (Include Personages, Dates, Events, Etc.)

Beaver County had been created by the Territorial Legislature in 1855. General management of the county was entrusted to the County Court which consisted of a probate judge and three selectmen, who jointly possessed the power of the County Commissions today. In 1876 the 6,000 inhabitants of the county elected to build Beaver County Courthouse to house the Second Judicial District Court of the Territory of Utah.

Because of Indian unrest during the Black Hawk War, the trials of John D. Lee, associated with the Mountain Meadows Massacre, and a general desire on the part of the Federal government to maintain a watchful eye over "Mormons" to the south, both the courthouse, the seat of Federal authority, and Fort Cameron, with Federal troops nearby, played significant roles in the lives of these early Utahns. In fact, William Stokes, a former Union soldier, directed the building of the courthouse. The architect is unknown.

Although begun in 1876, the courthouse was not completed until 1882, at a cost of \$10,960. Fire partially destroyed the structure in 1889, but it was soon rebuilt with many improvements. Later additions to the rear include a 32' x 29' vault and a jail.

The second trial of John D. Lee was held in the Second Judicial District Court in Beaver, U.T. during December 1876. The courthouse, only in early excavation stages at the time, was not the site for these trials.

Nevertheless, this lovely courthouse remains in use today by Beaver County, an emblem of the pretentious construction in public buildings during the Territorial period. It also symbolizes the Federal Government's attempts to govern and "observe" the Mormons during a period when the practice of Polygamy heightened those conflicts.

SEE INSTRUCTIONS



9. MAJOR BIBLIOGRAPHICAL REFERENCES

Goeldner, Paul, Utah Catalog: Historic American Buildings Survey, Salt Lake City, 1969) pp 25, 53.
 Daughters of Utah Pioneers, Monuments to Courage, A History of Beaver County, Beaver Press, 1948.
 Bancroft, Hebert Howe, History of Utah, Bookcraft Inc., Salt Lake City, Utah, 1964.
 Neff, Andrew Love, History of Utah, 1847-1869, The Deseret News Press, Salt Lake City, 1940.
 "Cover Story: A Man Alone," American Bar Association Journal, LVI (March, 1970), 245-247.

10. GEOGRAPHICAL DATA

LATITUDE AND LONGITUDE COORDINATES DEFINING A RECTANGLE LOCATING THE PROPERTY			O R	LATITUDE AND LONGITUDE COORDINATES DEFINING THE CENTER POINT OF A PROPERTY OF LESS THAN ONE ACRE		
CORNER	LATITUDE	LONGITUDE		LATITUDE	LONGITUDE	
	Degrees Minutes Seconds	Degrees Minutes Seconds		Degrees	Minutes	Seconds
NW	0 ' "	0 ' "		38°	16'	26"
NE	0 ' "	0 ' "		112°	38'	20"
SE	0 ' "	0 ' "				
SW	0 ' "	0 ' "				

LIST ALL STATES AND COUNTIES FOR PROPERTIES OVERLAPPING STATE OR COUNTY BOUNDARIES

STATE:	CODE	COUNTY	CODE
STATE:	CODE	COUNTY:	CODE
STATE:	CODE	COUNTY	CODE
STATE:	CODE	COUNTY:	CODE

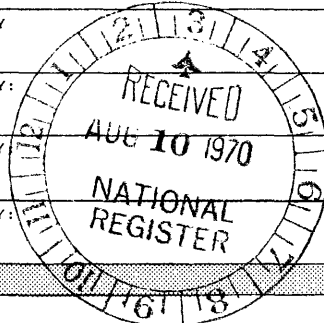

11. FORM PREPARED BY

NAME AND TITLE: **Melvin T. Smith**

ORGANIZATION: **Utah State Historical Society** DATE: **July 14, 1970**

STREET AND NUMBER: **603 East South Temple**

CITY OR TOWN: **Salt Lake City** STATE: **Utah** CODE: **43**

12. STATE LIAISON OFFICER CERTIFICATION

As the designated State Liaison Officer for the National Historic Preservation Act of 1966 (Public Law 89-665), I hereby nominate this property for inclusion in the National Register and certify that it has been evaluated according to the criteria and procedures set forth by the National Park Service. The recommended level of significance of this nomination is:

National State Local

Name: Milton L. Weilenmann
 Title: State Liaison Officer
 Date: July, 1970

NATIONAL REGISTER VERIFICATION

I hereby certify that this property is included in the National Register.

Ernest Allen Casanady
 Chief, Office of Archeology and Historic Preservation

Date: OCT 6 1970

ATTEST:

William J. Mustang
 Keeper of The National Register

Date: AUG 19 1970

SEE INSTRUCTIONS

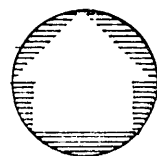
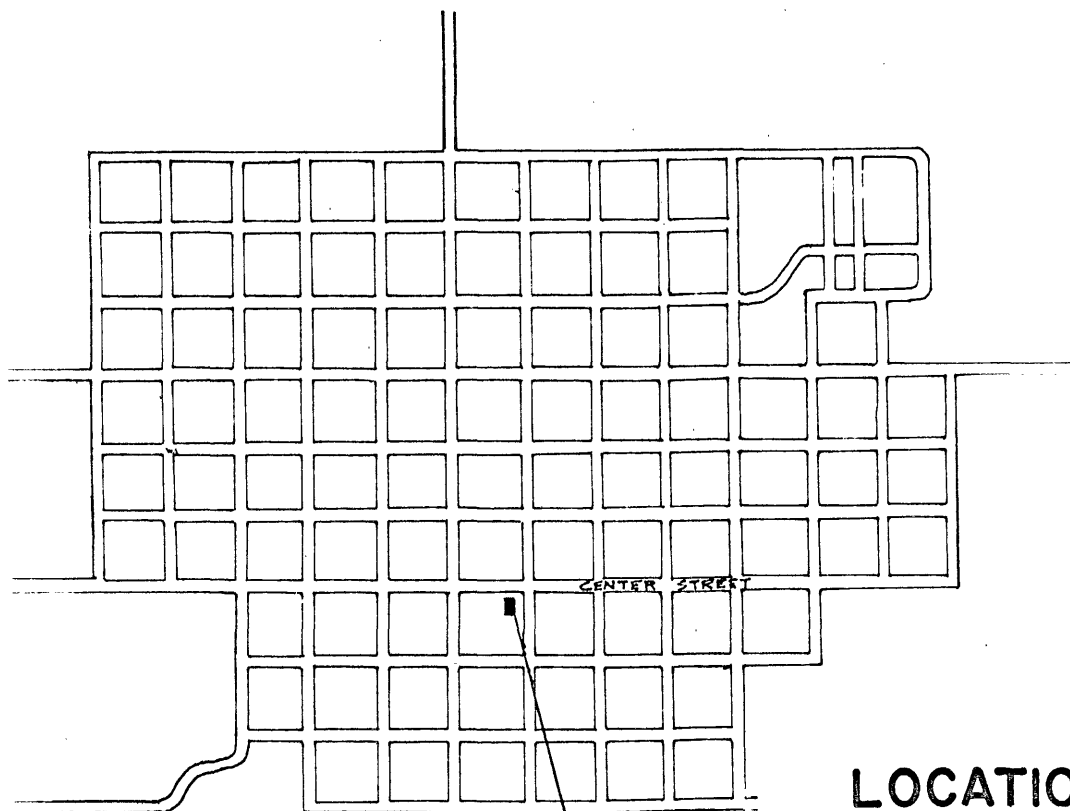

LOCATION MAP

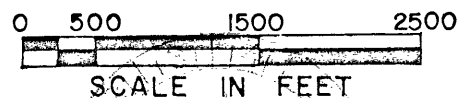

BEAVER COUNTY COURTHOUSE

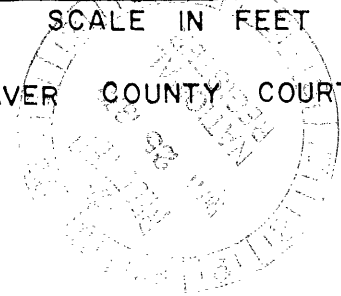

BEAVER COUNTY COURTHOUSE

90 EAST CENTER ST.
BEAVER, UTAH

LATITUDE : 38° - 16' - 26"
LONGITUDE : 112° - 38' - 20"
MAP FROM HABS DVG

DATE : MAY 1970

CENTER STREET

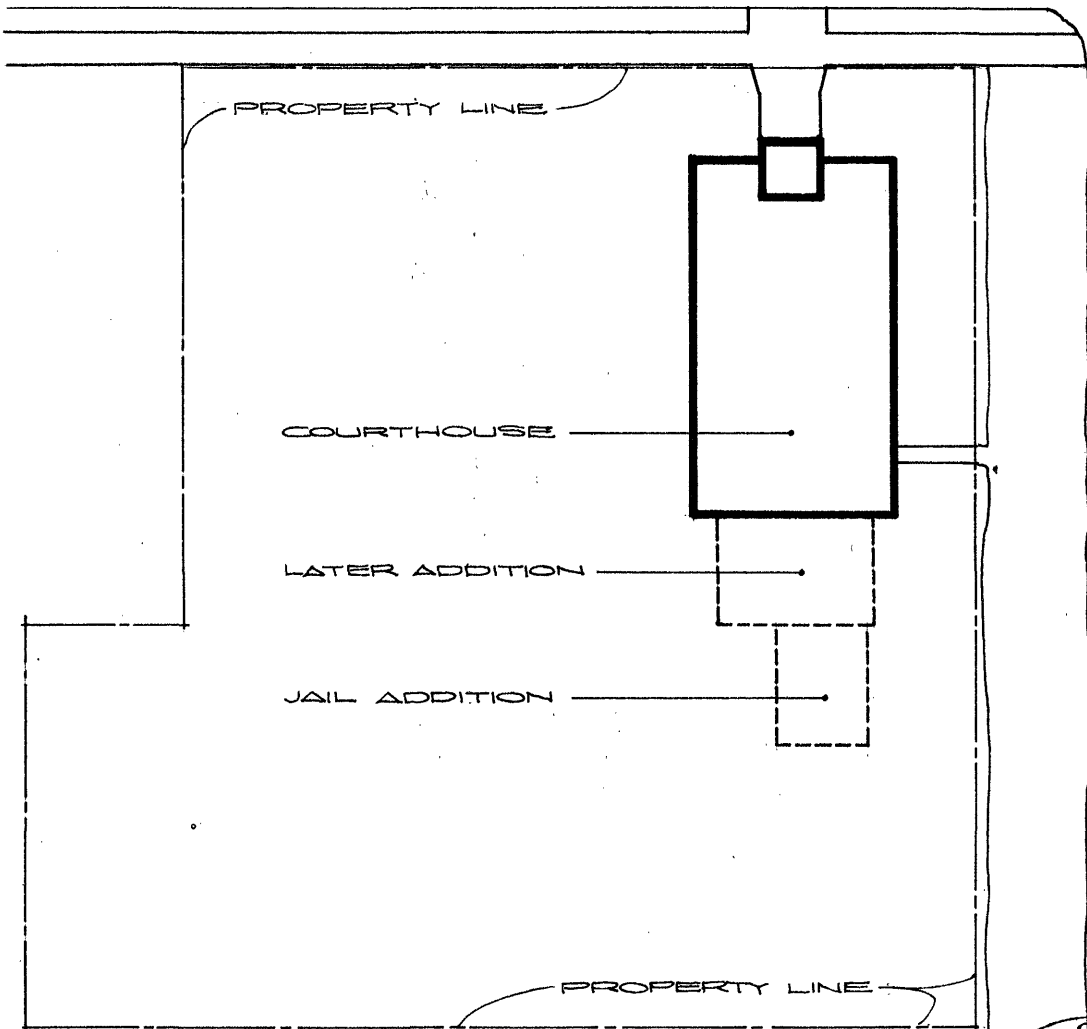

1ST EAST

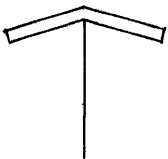
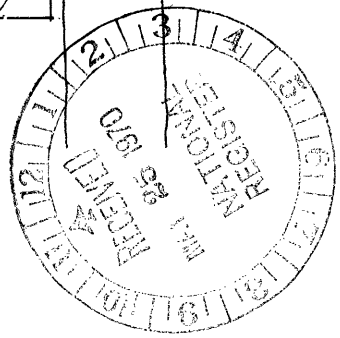

BEAVER COUNTY COURTHOUSE

90 EAST CENTER ST.
BEAVER, UTAH

LATITUDE : 38°-16'-20"
LONGITUDE : 112°-38'-20"
SCALE 1" = 40'

DATE: MAY 1970