

ARIZONA STATE HISTORIC PROPERTY INVENTORY

IDENTIFICATION Nogales Architectural/
 SURVEY AREA NAME: Historical Resource Survey
 HISTORIC NAME: Three Mediterranean Cottages on
Pajarito Street
 ADDRESS/LOCATION: 102-104 Pajarito
 CITY/TOWN: Nogales, Arizona
 TAX PARCEL NUMBER: 101-34-29
 OWNER: Georgios & K. Frijitjikas
 OWNER ADDRESS: 204 Potrero Avenue
Nogales, AZ 85621
 HISTORIC USE: residence
 PRESENT USE: residence
 BUILDING TYPE: multi-residential
 STYLE: Mediterranean
 CONSTRUCTION DATE: 1927
 ARCHITECT/BUILDER: unknown
 INTEGRITY: unaltered original site
 CONDITION: excellent

COUNTY: Santa Cruz SURVEY SITE: 9-20
 USGS QUAD: Nogales
T²⁴S R¹⁴E S / OF THE 1/4
 UTM 12-506120-3467290

Description (contd.)
 ROOF TYPE: flat/shed
 ROOF SHEATHING: Mexican clay tile
 EAVES TREATMENT: parapets/Mexican clay
tile coping
 WINDOWS: double hung (1/1) (2/2) wood
 ENTRY: differs for each unit: recessed
central
 PORCHES: parapeted entry porch
 STOREFRONTS: N/A

DESCRIPTION
 STORIES: 1 DIMENSIONS: (l) 30 (w) 25
 STRUCTURAL MATERIAL: adobe
 FOUNDATION MATERIAL: unknown
 WALL SHEATHING: stucco
 APPLIED ORNAMENT: articulated round arched
window hoods; inlaid glazed ceramic tile

NOTABLE INTERIOR: unknown
 OUTBUILDINGS: site comprises 3 cottages
and one garage
 ALTERATIONS:
 PHOTOGRAPH
 PHOTOGRAPHER: Jim Woodward
 DATE: April 1984 VIEW: West

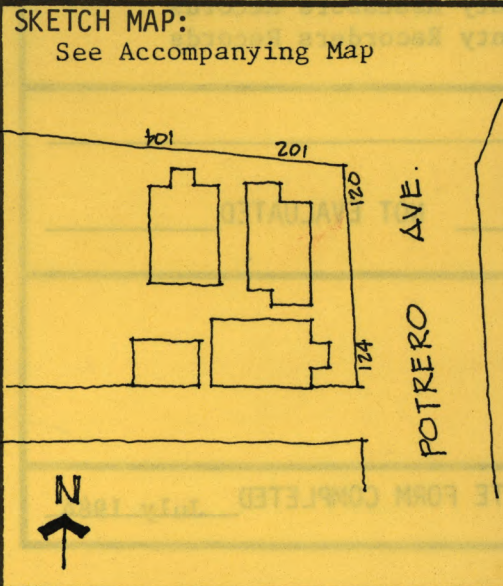

ADDITIONAL DESCRIPTION/ANALYSIS (annotated form):

SIGNIFICANCE:

AREAS OF SIGNIFICANCE: COMMERCE ___ COMMUNITY PLANNING ___ ECONOMICS ___
EXPLORATION/SETTLEMENT ___ GOVERNMENTAL ___ MILITARY ___ RELIGION ___ SCIENCE ___
THEATRE ___ TRANSPORTATION ___ TOURISM ___ OTHER(specify) Architecture

HISTORIC ASSOCIATIONS (be concise):

PROMINENT OCCUPANT/HISTORIC ASSOCIATION(S) _____

RELATIONSHIP TO LOCAL DEVELOPMENT Symbolic of the population growth in Nogales during Post WWI years.

CULTURAL AFFILIATIONS _____

ARCHITECTURAL STYLE Best example of Mediterranean style cottages in Nogales.

MAJOR ARCH. FORM/MATERIAL Rare use of adobe for its time period, but reflective of Period Revival styles general reintroduction of adobe construction during the late 1920s and early 1930s.

ENGINEERING/STRUCTURAL _____

DISTRICT/STREETScape CONTRIBUTION Prominent location at major intersection.

DISCUSSION AS REQUIRED:

See also: MRA Text, Item 7, pages 6 and 7.

CONTEXT: ISOLATED/RURAL ___ RESIDENTIAL STREET X COMMERCIAL ___ CENTRAL SQUARE ___
CBD: ___ OTHER: _____

BIBLIOGRAPHY/SOURCES:

- Sanborn Maps (~~1890, 1893, 1898, 1901, 1906, 1917~~, 1930)
- The Oasis _____
- Border Vidette _____
- Tucson Citizen _____
- _____
- _____
- _____
- Arizona State Library, Archives
Biography files
- County Assessors Records
- County Recorders Records

LISTING IN OTHER SURVEYS: _____

NATIONAL REGISTER STATUS:

LISTED ___ DETERMINED ELIGIBLE ___ DETERMINED NOT ELIGIBLE ___ NOT EVALUATED _____

COMMENTS/DEVELOPMENT PLANS/THREATS:

SURVEYOR Jim Woodward SURVEY DATE April 1984 DATE FORM COMPLETED July 1984