

United States Department of the Interior
National Park Service

1093



National Register of Historic Places Registration Form

This form is for use in nominating or requesting determinations for individual properties and districts. See instructions in *How to Complete the National Register of Historic Places Registration Form* (National Register Bulletin 16A). Complete each item by marking "x" in the appropriate box or by entering the information requested. If any item does not apply to the property being documented, enter "N/A" for "not applicable." For functions, architectural classification, materials, and areas of significance, enter only categories and subcategories from the instructions. Place additional entries and narrative items on continuation sheets (NPS Form 10-900a). Use a typewriter, word processor, or computer, to complete all items.

1. Name of Property

historic name Churchton and Shady Side Rosenwald Schools

other names Scott, Lula G., Community Center (preferred); AA-2217

2. Location

street & number 6243 Shady Side Road not for publication

city or town Shady Side vicinity

state Maryland code MD county Anne Arundel code 003 zip code 20764

3. State/Federal Agency Certification

As the designated authority under the National Historic Preservation Act of 1966, as amended, I hereby certify that this nomination request for determination of eligibility meets the documentation standards for registering properties in the National Register of Historic Places and meets the procedural and professional requirements set forth in 36 CFR Part 60. In my opinion, the property meets does not meet the National Register criteria. I recommend that this property be considered significant nationally statewide locally. (See continuation sheet for additional comments).

Signature of certifying official/Title

11-4-09
Date

State or Federal agency and bureau

In my opinion, the property meets does not meet the National Register criteria. (See continuation sheet for additional comments).

Signature of certifying official/Title

Date

State or Federal agency and bureau

4. National Park Service Certification

I hereby certify that this property is:

- entered in the National Register.
 - See continuation sheet.
- determined eligible for the National Register.
 - See continuation sheet.
- Determined not eligible for the National Register.
- removed from the National Register.
- other (explain): _____

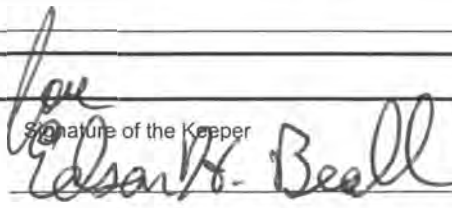
Signature of the Keeper

12-18-09
Date of Action

Scott, Lula G., Community Center (AA-2217)
Name of Property

Anne Arundel County, Maryland
County and State

5. Classification

Ownership of Property
(Check as many boxes as apply)

- private
- public-local
- public-State
- public-Federal

Category of Property
(Check only one box)

- building(s)
- district
- site
- structure
- object

Number of Resources within Property
(Do not include previously listed resources in the count)

Contributing	Noncontributing	
1	0	buildings
		sites
		structures
		objects
1	0	Total

Name of related multiple property listing
(Enter "N/A" if property is not part of a multiple property listing)

Rosenwald Schools of Anne Arundel County, MD

number of contributing resources previously listed in the National Register

0

6. Function or Use

Historic Functions
(Enter categories from instructions)

EDUCATION/School

Current Functions
(Enter categories from instructions)

EDUCATION/School
SOCIAL/Community center

7. Description

Architectural Classification
(Enter categories from instructions)

Other—Rosenwald School

Materials
(Enter categories from instructions)

foundation concrete
walls asbestos
roof asphalt
other

Narrative Description

(Describe the historic and current condition of the property on one or more continuation sheets)

United States Department of the Interior
National Park Service

National Register of Historic Places Continuation Sheet

AA-2217
Scott, Lula G., Community Center
Name of Property

Anne Arundel County, Maryland
County and State

Section 7 Page 1

Description Summary:

The Lula G. Scott Community Center in Shady Side, Anne Arundel County, Maryland consists of two frame, one-story, two-room plan Rosenwald Schools. One was built on the present site in 1926; the other was constructed in 1921 in the nearby community of Churchton and moved to the present location in 1953. A low addition was then constructed, linking the two school buildings back-to-back. The building achieved its current configuration in 1958 with the addition of a one-story, flat-roofed wing built at the south gable end of the combined Rosenwald Schools.

General Description:

Situated in a rural village setting on the east side of Shady Side Road in southeastern Anne Arundel County, the Lula G. Scott Community Center comprises two formerly separate buildings and two additions. Two frame, one-story, gable-roofed Rosenwald Schools are incorporated at the building's south end. The original section, at the building's northwest quarter, is the Shady Side Rosenwald School, constructed in 1926 facing Shady Side Road. The building's northeast quarter comprises the former Churchton Rosenwald School, constructed at another site in 1921 and moved to its present location in 1953. The two formerly separate school buildings are joined by a connecting addition approximately 20 feet wide, containing a kitchen, bathroom, hall and storage areas. This section was built in 1953 when the Churchton School was brought to the site. A wing to the south was built in 1958.

The two frame Rosenwald Schools are very similar in appearance. Both are approximately the same size, roughly measuring 70' x 25'. Exterior walls are sheathed in wooden siding with a "drop" or German profile. The Shady Side School rests on a concrete pier foundation, supplemented by concrete blocks. A concrete block foundation supports the relocated Churchton School, the 1953 connecting section, and the 1958 wing.

Both Rosenwald Schools are based on a two-room plan with a central entrance. The Shady Side School, which faces west toward Shady Side Road, has a central hall or passage, with one room on either side. The entrance features an extensively rebuilt portico, supported by modern metal posts. The paired metal-and-glass doors date to the 1950s. The east-facing Churchton School features a similar façade. The original portico appears relatively intact and retains its decorative Craftsman-style brackets. The Churchton School's two centrally-placed doors are the same as the Shady Side School, although the openings are spaced farther apart. The Churchton School's plan is altered and now consists of a single large room. An accordion divider attached to the east wall pulls out to separate the room into two equal-sized spaces. While dividers were sometimes

United States Department of the Interior
National Park Service

National Register of Historic Places Continuation Sheet

AA-2217
Scott, Lula G., Community Center
Name of Property

Section 7 Page 2

Anne Arundel County, Maryland
County and State

original features in Rosenwald Schools, oral history indicates that this divider is not an original consideration.

Both the Shady Side and Churchton schools are characterized by banks of multiple tall double-hung sash windows. The Shady Side School's principal façade contains a bank of five windows on either side of the center entrance, while the Churchton School features the same arrangement with banks of six windows.

The 1958 flat-roofed addition projects from the Rosenwald Schools' south gables, and is recessed from the front wall of the Shady Side School section approximately 6 feet. The addition's walls are sheathed in asbestos shingles. Long banks of tall, metal hopper windows occupy most of the addition's east and west walls. The south wall contains a pair of metal and glass doors, accented with an over-sized transom and sidelights. A flat-roofed metal portico protects the entrance. Access is achieved by concrete steps, or alternatively, via a wheelchair ramp. This opening currently serves as the principal entrance.

The Lula G. Scott Community Center has experienced a series of renovations. The Shady Side Rosenwald School, however, retains a significant amount of historic interior fabric including the chalkboards, chair rail and window and door surrounds, making it Anne Arundel County's best preserved example of a Rosenwald School. The Churchton School was believed to have lost much of its historic interior fabric; however, the original wainscoting was found intact behind modern wallboard. A rehabilitation and adaptive re-use project was carried out in 2003 in consultation with the Maryland Historical Trust and in accordance with the Secretary of the Interior's Standards for Rehabilitation.

8. Statement of Significance

Applicable National Register Criteria

(Mark "x" in one or more boxes for the criteria qualifying the property for National Register listing)

- A** Property is associated with events that have made a significant contribution to the broad pattern of our history.
- B** Property associated with the lives of persons significant in our past.
- C** Property embodies the distinctive characteristics of a type, period, or method of construction or represents the work of a master, or possesses high artistic values, or represents a significant and distinguishable entity whose components lack individual distinction.
- D** Property has yielded, or is likely to yield, information important in prehistory or history.

Criteria Considerations

(Mark "x" in all the boxes that apply)

Property is:

- A** owned by a religious institution or used for religious purposes.
- B** removed from its original location.
- C** a birthplace or grave.
- D** a cemetery.
- E** a reconstructed building, object, or structure.
- F** a commemorative property.
- G** less than 50 years of age or achieved significance within the past 50 years.

Narrative Statement of Significance

(Explain the significance of the property on one or more continuation sheets)

9. Major Bibliographical References

Bibliography

(Cite the books, articles, and other sources used in preparing this form on one or more continuation sheets)

Previous documentation on files (NPS):

- preliminary determination of individual listing (36 CFR 67) has been requested
- previously listed in the National Register
- previously determined eligible by the National Register
- designated a National Historic Landmark
- recorded by Historic American Buildings Survey # _____
- recorded by Historic American Engineering Record # _____

Area of Significance

(Enter categories from instructions)

- Education _____
- Ethnic Heritage (Black) _____
- Social History _____
- Architecture _____
- _____
- _____
- _____

Period of Significance

1921-1958

Significant Dates

1921, 1926, 1953, 1958

Significant Person

(Complete if Criterion B is marked above)

Cultural Affiliation

Architect/Builder

Variant of Julius Rosenwald Fund plan
"2 Room Shop B"

United States Department of the Interior
National Park Service

National Register of Historic Places Continuation Sheet

AA-2217
Scott, Lula G., Community Center
Name of Property

Section 8 Page 1

Anne Arundel County, Maryland
County and State

Note: This individual nomination follows a Multiple Property Documentation form titled *Rosenwald Schools in Anne Arundel County, Maryland, (1921-1932)*. Please refer to that document for a detailed exploration of the history and significance of the Julius Rosenwald Fund School Building program and information on African-American education in Anne Arundel County prior to desegregation.

Summary Statement of Significance:

The Lula G. Scott Community Center meets Registration Requirements specified in the Multiple Property Documentation form titled *Rosenwald Schools in Anne Arundel County, Maryland, (1921-1932)*.

The Lula G. Scott Community Center consists of the combined Shady Side and Churchton Rosenwald Schools and two 1950s additions. The Shady Side Rosenwald School was constructed at this location in 1926. It is the most intact example of a Rosenwald School surviving in Anne Arundel County, Maryland. The Churchton Rosenwald School was built in 1921 and was moved to its present site in 1953. Rosenwald Schools were constructed with financial and technical assistance provided by the Julius Rosenwald Fund, a private foundation named for the Chicago entrepreneur who directed the booming growth of Sears, Roebuck & Company in the early 20th century. The Rosenwald Fund School Building Program represents the most important advance in African-American education in southern states prior to desegregation. Between 1917 and 1932, the Julius Rosenwald Fund helped erect 5,357 schools for African-American students in 17 southern states. Rosenwald Schools were built according to plans provided or approved by the Julius Rosenwald Fund. These state-of-the-art plans were cost-efficient and embodied the latest educational design theories. In Maryland, 292 Rosenwald schools were constructed, 23 of which were built in Anne Arundel County. Including the two buildings incorporated into the Lula G. Scott Community Center, a total of ten of Anne Arundel County's 23 Rosenwald Schools survive.

The period of significance, 1921-1958, begins with the construction date of the Churchton Rosenwald School and extends to 1958, by which date the two school buildings had been combined on the present site and the resource had substantially achieved its present form and appearance.

Resource History and Historic Context:

The Churchton and Shady Side Rosenwald Schools which have been incorporated into the Lula G. Scott Community Center are architecturally significant as examples of Rosenwald School

United States Department of the Interior
National Park Service

National Register of Historic Places Continuation Sheet

AA-2217
Scott, Lula G., Community Center
Name of Property

Section 8 Page 2

Anne Arundel County, Maryland
County and State

design. They derive additional significance for their association with the Julius Rosenwald Fund's School Building Program, representing a milestone in the history of African American education prior to school desegregation following the U.S. Supreme Court's 1954 decision in *Brown vs. Topeka Board of Education*.

Rosenwald Schools were built with matching funds provided by the Julius Rosenwald Fund, which was a private foundation created by and named for the Chicago entrepreneur who directed the booming growth of Sears, Roebuck and Company in the early 20th century. Julius Rosenwald's interest in African American education developed from his admiration of Booker T. Washington. Rosenwald was deeply impressed by Washington's climb from poverty to educational leadership. He met Washington in 1911 and soon after became active in Washington's Tuskegee Institute. In 1917 Rosenwald established the Julius Rosenwald Fund and inaugurated his personal campaign to improve the quality of education for rural blacks in the South. Between 1917 and 1932 the Julius Rosenwald Fund provided financial and technical assistance that resulted in the creation of 5,357 schools for African American students in 17 southern states at a total cost of \$28,408,502 (Embree and Waxman: 1949). In Maryland 292 Rosenwald Schools were constructed, 23 of which were erected in Anne Arundel County. Ten of these 23 schools survive.

The vast majority of Rosenwald schools were built according to plans provided by the Julius Rosenwald Fund. Rosenwald Fund administrator, S.L. Smith developed these simple and efficient designs, with additional input from leading educational theorists. Rosenwald plans represented the state of the art in school architecture, and were provided free of charge to Boards of Education. The Rosenwald Fund required strict adherence to their building plans. Any deviation from an approved plan required approval prior to construction or risk losing financial support. Regular progress photographs were required to assure schools met the high standards the Fund demanded. Rosenwald Fund plans were so superior that they were used to build more than 15,000 white schools that had no financial relationship to the Fund (Embree and Waxman: 1949).

The Julius Rosenwald Fund School Building Program was carried out in conjunction with the Boards of Education of the various states and with contributions from the African-American and, in theory, the white communities. The state and county consistently bore the majority of the cost and agreed to maintain the new building as part of the public school system. The actual amount contributed by the Rosenwald Fund varied depending upon the size of the school, with contributions generally ranging from a minimum of \$200 for a 1-teacher school to \$6,000 for a 12-teacher school.

United States Department of the Interior
National Park Service

National Register of Historic Places Continuation Sheet

AA-2217
Scott, Lula G., Community Center
Name of Property

Section 8 Page 3

Anne Arundel County, Maryland
County and State

Out of the 23 Rosenwald Schools built in Anne Arundel County, 18 were a 2-teacher type known as the Fox Plan. This plan is named for Anne Arundel County School Superintendent, George Fox, who developed this design in association with S. L. Smith. The Fox Plan represents a variation on the published Rosenwald Fund design "Shop Plan B". In the Fox Plan, the laboratory and shop are omitted and the spaces combined for use as a second classroom.

Total cost of the Shady Side and Churchton Schools were \$3,500 and \$3,900 respectively. By way of comparison, the least expensive school constructed in Anne Arundel County was at Annapolis Neck, at a cost of \$1700. The Marley Neck School cost \$4,300 and was the most expensive Rosenwald School built in the county. The Shady Side School was constructed on property previously owned by John T. Turner. The Churchton School was originally situated on land donated by James and Mary Jane Thompson. Both are 2-teacher, Fox-Plan buildings. According to Julius Rosenwald Fund records at Fisk University in Nashville, Anne Arundel County paid \$2,600 toward the cost of the Shady Side School, with the Rosenwald Fund contributing \$700 and the African American community \$300. At Churchton, the County paid \$2,900, the Rosenwald Fund \$800 and the African American community \$200. Despite Julius Rosenwald's stipulation that white citizens contribute to the cost of a school, no donations were received from the white community for these or any Rosenwald School built in Anne Arundel County (Rosenwald Fund Archives).

Teachers instructing at Shady Side School prior to 1930 included Miss Randolph, Miss Woodson, Miss Mary Foreman and Miss Alston. In 1930 Miss Mary V. Wiseman became teaching principal and served until 1948. Churchton teachers included Mrs. Lula G. Scott (for whom the building is named), Mrs. Mary Queen, Miss Oliver, Miss Vivian Hicks, Miss Mary Foreman, Mrs. Rachel Brown, Mrs. Flora Andrews, Miss Mary V. Wiseman, Mrs. Helen Chase, Miss Julia Toliver, and Mrs. Alice Battle (Churchton, Shady Side and Lula G. Scott Reunion Brochure: 1998)

During the summer of 1953 the Churchton and Shady Side Schools were literally consolidated. The Churchton building was moved about 3 miles from its original site and located approximately 20 ft. east of the Shady Side School. An addition containing a kitchen, lavatories, hall and storage rooms was constructed linking the two school buildings. The combined entity was known as the Shady Side School until 1956, at which time the school was renamed the Lula G. Scott School. In 1958 a wing was added to the south end of the Rosenwald buildings.

Although the U.S. Supreme Court ruled in 1954 that segregation was unconstitutional, schools in Maryland were not thoroughly integrated until more than a decade later. In 1966 Shady Side's white school was integrated and served as the community's elementary school while the Lula G.

United States Department of the Interior
National Park Service

National Register of Historic Places Continuation Sheet

AA-2217
Scott, Lula G., Community Center
Name of Property

Section 8 Page 4

Anne Arundel County, Maryland
County and State

Scott School became the area's intermediate school. The Lula G. Scott School closed in 1970. In 1984 the building was renovated for use as a community center. In January 2003, a rehabilitation and adaptive re-use project started at the Lula G. Scott Center, in consultation with the Maryland Historical Trust and according to the Secretary of the Interior's Standards, to enable the building to house Head Start and Early Head Start programs as well as continue to function as a community center.

Evaluation of Integrity

The Churchton and Shady Side Rosenwald Schools incorporated within the Lula G. Scott Community Center retain sufficient architectural integrity to qualify for listing in the National Register under the Registration Requirements specified in the Multiple Property Documentation form titled *Rosenwald Schools in Anne Arundel County, Maryland, (1921-1932)*. The Shady Side school is the best preserved Rosenwald School in Anne Arundel County, with all of its major character-defining features remaining intact on both the exterior and interior. The Churchton School retains its historic exterior form and massing, siding material, and the characteristic banks of tall sash windows; its interior plan and detailing have been altered somewhat, but elements of original interior fabric survive beneath more recent treatments. Despite their physical incorporation into a composite structure, the buildings remain clearly distinguishable as independent examples of Rosenwald school design. Although the 1921 Churchton School was moved to this site from its original location, that relocation took place more than fifty years ago.

United States Department of the Interior
National Park Service

National Register of Historic Places Continuation Sheet

AA-2217
Scott, Lula G., Community Center
Name of Property

Section 8 Page 5

Anne Arundel County, Maryland
County and State

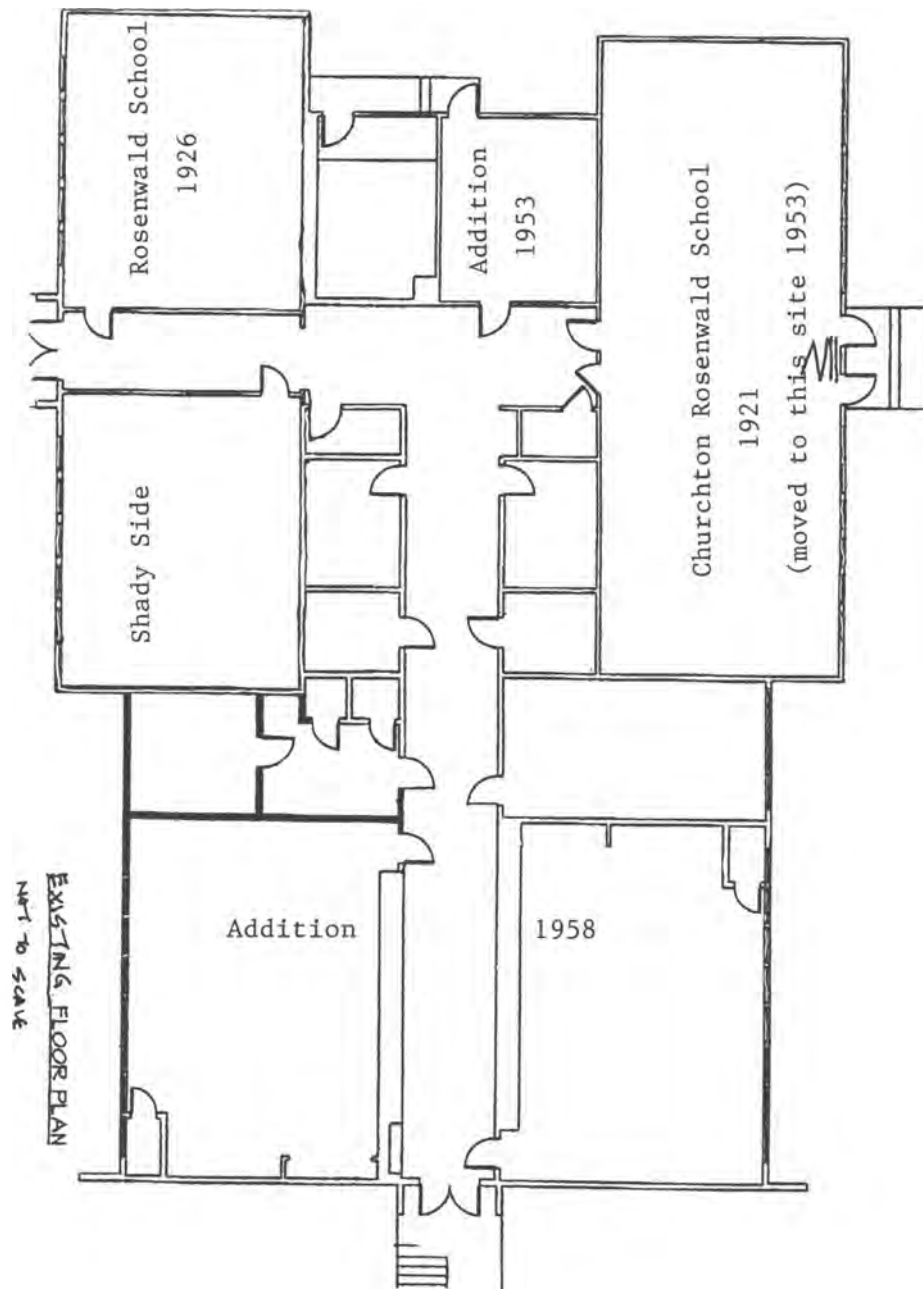

United States Department of the Interior
National Park Service

National Register of Historic Places Continuation Sheet

AA-2217
Scott, Lula G., Community Center
Name of Property

Section 9 Page 1

Anne Arundel County, Maryland
County and State

Major Bibliographical References:

Philip L. Brown. A Century of Separate But Equal: Education in Anne Arundel County. Vantage Press, New York (1988).

Edwin R. Embree and Julia Waxman. Investment in People: The Story of the Julius Rosenwald Fund. Harper and Brothers, New York, NY (1949).

David S. Jenkins, *A History of Colored Education in Anne Arundel County*, Master's Thesis, University of Maryland (1941).

Julius Rosenwald Fund Archives, Special Collections Library, Fisk University, Nashville Tennessee.

Donna M. Ware, Education in Anne Arundel County: An Historic Context, unpublished manuscript (1989), on file at Anne Arundel County Office of Environmental & Cultural Resources, Annapolis, Maryland.

United States Department of the Interior
National Park Service

National Register of Historic Places Continuation Sheet

AA-2217
Scott, Lula G., Community Center
Name of Property

Section 10 Page 1

Anne Arundel County, Maryland
County and State

Verbal Boundary Description:

5.248 acres shown on Anne Arundel County Tax Map 69, block 17, parcel 585 and described in Anne Arundel County Land Records, Liber 2637, Folio 344.

Boundary Justification:

The nominated property comprises the acreage historically associated with the resource.

UNITED STATES DEPARTMENT OF THE INTERIOR
NATIONAL PARK SERVICE

NATIONAL REGISTER OF HISTORIC PLACES
EVALUATION/RETURN SHEET

REQUESTED ACTION: NOMINATION

PROPERTY NAME: Scott, Lula G., Community Center

MULTIPLE NAME: Rosenwald Schools of Anne Arundel County, Maryland MPS

STATE & COUNTY: MARYLAND, Anne Arundel

DATE RECEIVED: 11/06/09 DATE OF PENDING LIST: 11/25/09
DATE OF 16TH DAY: 12/10/09 DATE OF 45TH DAY: 12/20/09
DATE OF WEEKLY LIST:

REFERENCE NUMBER: 09001093

REASONS FOR REVIEW:

APPEAL: N DATA PROBLEM: N LANDSCAPE: N LESS THAN 50 YEARS: N
OTHER: N PDIL: N PERIOD: N PROGRAM UNAPPROVED: N
REQUEST: N SAMPLE: N SLR DRAFT: N NATIONAL: N

COMMENT WAIVER: N

ACCEPT RETURN REJECT 12.18.09 DATE

ABSTRACT/SUMMARY COMMENTS:

**Entered in
The National Register
of
Historic Places**

RECOM./CRITERIA _____

REVIEWER _____ DISCIPLINE _____

TELEPHONE _____ DATE _____

DOCUMENTATION see attached comments Y/N see attached SLR Y/N

If a nomination is returned to the nominating authority, the nomination is no longer under consideration by the NPS.



AA-2217

SCOTT, LULA G., COMMUNITY CENTER
ANNE ARUNDEL COUNTY, MD

P. KURTZE, 11/09

MDSHPD

VIEW FROM NW

MD-ANNEARUNDELCO - SCOTTLULAGCOMMUNITY
CENTER - 0006.TIF

1 OF 8



AA-2217

SCOTT, LULA G., COMMUNITY CENTER

ANNE ARUNDEL COUNTY, MD

P. KURTZE, 11/09

MD SHPO

VIEW FROM W

MD - ANNE ARUNDEL CO -

SCOTTLULAG-COMMUNITYCENTER - 0004.TIF

#2 OF 8



AA-2217

SCOTT, LULA G., COMMUNITY CENTER
ANNE ARUNDEL COUNTY, MD

P. KURTZE, 11/09

MD SHPO

VIEW FROM W

SHADY SIDE ROSENWALD SCHOOL

MD-ANNE ARUNDEL CO -

SCOTT LULA G COMMUNITY CENTER - 0005.TIF

#3 OF 8



AA-2217

SCOTT, LULA G., COMMUNITY CENTER
ANNE ARUNDEL COUNTY, MD

P. KURTZE, 11/09

MD SHPD

VIEW FROM NE

MD-ANNEARUNDELCD-

SCOTTLULAGCOMMUNITYCENTER-0007.TIF

#4 OF 8



AA-2217

SCOTT, LULA G., COMMUNITY CENTER

ANNE ARUNDEL COUNTY, MD

P. KURTZE, 11/09

MD SHPO

VIEW FROM E

CHURCHTON ROSENWALD SCHOOL

MD-ANNE ARUNDEL CO

SCOTT LULA G COMMUNITY CENTER - 0009.TIF

5 OF 8



AA-2217

SCOTT, LVLG, COMMUNITY CENTER
ANNE ARUNDEL COUNTY, MD

P. KURTZE, 11/09

MDSHPO

TYPICAL CLASSROOM, FACING W
SHADYSIDE SCHOOL NORTH ROOM

MD - ANNE ARUNDEL CO -

SCOTT LVLG COMMUNITY CENTER_0013.TIF

#6 OF 8



AA-2217

SCOTT, LULA G., COMMUNITY CENTER
ANNE ARUNDEL COUNTY, MD

P. KURTZE, 11/09
MD SHPO

TYPICAL CLASSROOM, FACING W
SHADY SIDE SCHOOL NORTH ROOM

MD-ANNE ARUNDEL CO -

SCOTT LULA G COMMUNITY CENTER - 0015.TIF

7 OF 8



AA-2217

SCOTT, LULA G., COMMUNITY CENTER
ANNE ARUNDEL COUNTY, MD

P. KURTZE, 11/09

MD SHPO

INTERIOR, CHURCHTON SCHOOL, FACING SE

MD-ANNEARUNDELCO-

SCOTTLULAGCOMMUNITYCENTER - 0025.TIF



AA-2217
SCOTT,
LULA G.,
COMMUNITY
CENTER
ANNE ARUNDEL
COUNTY, MD
18-
368548-
4299437

Mapped by the Army Map Service
Edited and published by the Geological Survey
Control by USGS, USC&GS, USCE
Culture and drainage in part compiled from aerial
photographs taken 1938 and 1942. Topography by planetable
surveys 1944. Culture revised by the Geological Survey by
photogrammetric methods from aerial photographs taken
1955. Field check 1957
Hydrography compiled from USC&GS chart 550 (1957)
Polyconic projection. 1927 North American datum
10,000-foot grid based on Maryland coordinate system
1000-meter Universal Transverse Mercator grid ticks,
zone 18, shown in blue
Revisions shown in purple compiled by the Geological
Survey from aerial photographs taken 1977 and other source
data. This information not field checked. Map edited 1979

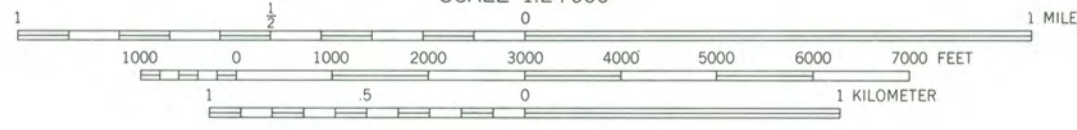
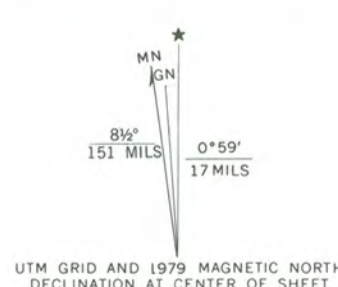

CONTOUR INTERVAL 20 FEET
DOTTED LINES REPRESENT 10-FOOT CONTOURS
NATIONAL GEODETIC VERTICAL DATUM OF 1929
DEPTH CURVES AND SOUNDINGS IN FEET—DATUM IS MEAN LOW WATER
SHORELINE SHOWN REPRESENTS THE APPROXIMATE LINE OF MEAN HIGH WATER
THE MEAN RANGE OF TIDE IS APPROXIMATELY 0.9 FOOT

THIS MAP COMPLIES WITH NATIONAL MAP ACCURACY STANDARDS
FOR SALE BY U.S. GEOLOGICAL SURVEY
DENVER, COLORADO 80225, OR RESTON, VIRGINIA 22092
A FOLDER DESCRIBING TOPOGRAPHIC MAPS AND SYMBOLS IS AVAILABLE ON REQUEST

ROAD CLASSIFICATION	
Heavy-duty	Light-duty
Medium-duty	Unimproved dirt
State Route	

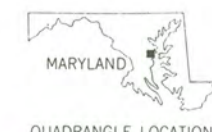

DEALE, MD.
N3845—W7630/7.5
1957
PHOTOREVISED 1979
AMS 5661 1 SE—SERIES V833



4
April 1, 2003

**Maryland
Department of
Housing and
Community
Development**

*Division of Historical and
Cultural Programs*

100 Community Place
Crownsville, Maryland 21032

410-514-7600

1-800-756-0119

Fax: 410-987-4071

Maryland Relay for the Deaf:
711 or 1-800-735-2258

<http://www.dhcd.state.md.us>

Robert L. Ehrlich, Jr.
Governor

Victor L. Hoskins
Secretary

Shawn S. Karimian
Deputy Secretary

Anne Arundel County
Office of Environmental and Cultural Resources
2664 Riva Road
Annapolis, Maryland 21401

Attention: Donna Ware

RE: CHURCHTON AND SHADYSIDE ROSENWALD SCHOOLS
Anne Arundel County, Maryland

Donna
Dear Ms. Ware:

The Churchton and Shadyside Rosenwald Schools will be considered by the Governor's Consulting Committee for nomination to the National Register of Historic Places on Tuesday, May 13, 2003. The National Register is the official list of historic properties recognized by the Federal Government as worthy of preservation for their significance in American history, architecture, archaeology, engineering, and culture. In Maryland, the nomination process is administered by the Maryland Historical Trust. Enclosed you will find a copy of the criteria under which properties are evaluated for listing. The meeting will be held at the People's Resource Center, 100 Community Place, Crownsville, Maryland, beginning at 10:00 a.m. You are welcome to attend this meeting.

Listing in the National Register results in the following for historic properties.

1. Consideration in planning for Federal, federally or state funded, licensed and assisted projects. Federal and state legislation requires that Federal agencies allow the Advisory Council on Historic Preservation and state agencies, including the Maryland Historical Trust, opportunity to comment on all projects affecting historic properties listed in the National Register. For further information please refer to Section 36, Code of Federal Regulations, Part 800 and Annotated Code of Maryland, Article 83B, Section 5-615 et seq. or call the Office of Preservation Services of the Maryland Historical Trust at (410) 514-7630.
2. Eligibility for Federal tax provisions. If a property is listed in the National Register, certain Federal tax provisions may apply. The Tax Reform

Act of 1986 revises the historic preservation tax incentives authorized by Congress in the Tax Reform Act of 1976, the Revenue Act of 1978, the Tax Treatment Extension Act of 1980, the Economic Recovery Tax Act of 1981, and the Tax Reform Act of 1984, and as of January 1, 1987, provides for a 20 percent investment tax credit with a full adjustment to basis for rehabilitating historic commercial, industrial, and rental residential buildings. The former 15 percent and 20 percent Investment Tax Credits (ITCs) for rehabilitation of older commercial buildings are combined into a single 10 percent ITC for commercial or industrial buildings built before 1936.

The Tax Treatment Extension Act of 1980 provides Federal tax deductions for charitable contributions for conservation purposes of partial interests in historically important land areas or structures. Whether these provisions are advantageous to a property owner is dependent upon the particular circumstances of the property and the owner. Because tax aspects outlined above are complex, individuals should consult legal counsel or the appropriate local Internal Revenue Service office for assistance in determining the tax consequences of the above provisions. For further information on certification requirements, please refer to 36 CFR 67 or the Office of Preservation Services of the Maryland Historical Trust at (410) 514-7630.

3. Eligibility for a Maryland income tax benefit for the rehabilitation of historic property. For further information on the Heritage Preservation Tax Credit, contact the Office of Preservation Services of the Maryland Historical Trust at (410) 514-7628.

4. Consideration of historic values in the decision to issue a surface coal mining permit where coal is located. In accord with the Surface Mining Control and Reclamation Act of 1977, there must be consideration of historic values in the decision to issue a surface coal mining permit where coal is located. For further information, please refer to 30 CFR 700 et seq.

5. Eligibility to apply for federal and state grants and state low interest loans for historic preservation projects. To determine the present status of such grants and loans, contact the Office of Preservation Services of the Maryland Historical Trust at (410) 514-7632.

Owners of private properties nominated to the National Register have an opportunity to concur in or object to listing in accord with the National Historic Preservation Act and 36 CFR 60. Any owner or partial owner of private property who chooses to object to listing may submit to the State Historic Preservation Officer a notarized statement certifying that the party is the sole or partial owner of the private property and objects to the listing. Each owner or partial owner of private property has one vote regardless of what portion of the property that party owns. If a majority of private property owners object, a property will not be listed; however, the State Historic Preservation Officer shall submit the nomination to the Keeper of the National Register of Historic Places for a determination of eligibility of the property for listing in the National Register. If the property is determined to be eligible for listing, although not formally listed, Federal agencies will be required to allow the Advisory Council on Historic Preservation and state agencies, including the Maryland Historical Trust, an opportunity to comment before the agency may fund, license, or assist a project which will affect the property. If you choose to object to the listing of your property, the notarized objection must be submitted to J. Rodney Little, State Historic Preservation Officer, ATTN: Peter Kurtze, Maryland Historical Trust, 100 Community Place, Crownsville, Maryland 21032-2023 by the date of the meeting given above.

Listing in the National Register does NOT mean that the Federal Government or the State of Maryland wants to acquire the property, place restrictions on the property, or dictate the color or materials used on individual buildings. Local ordinances or laws establishing restrictive zoning, special design review committees, or review of exterior alterations are not a part of the National Register program. Listing also does NOT require the owner to preserve or maintain the property or seek approval of the Federal Government or the State of Maryland to alter the property. Unless the owner applies for and accepts special Federal or state tax, licensing, or funding benefits, the owner can do anything with his property he wishes so long as it is permitted by state or local law.

If you wish to comment on whether the property should be nominated to the National Register, please send your comments to J. Rodney Little, State Historic Preservation Officer, ATTN: Peter E. Kurtze, before the Governor's Consulting Committee considers the nomination. Copies of the nomination, regulations and information on the National Register and Federal and State tax provisions are available from the Trust. If you have questions about this nomination, please contact Peter E. Kurtze, Administrator of Evaluation and Registration, Maryland Historical Trust at (410) 514-7649.

Sincerely,

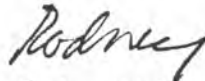

J. Rodney Little
Director-State Historic
Preservation Officer

JRL/jmg

cc: Hon. Janet S. Owens
Ms. Donna Hole
Dr. Al Luchenbach
Ms. Sherri Marsh



Maryland Department of Planning

Robert L. Ehrlich, Jr.
Governor
Michael S. Steele
Lt. Governor

Audrey E. Scott
Secretary
Florence E. Burian
Deputy Secretary

May 9, 2003

Mr. J. Rodney Little
Director, Division of Historical and Cultural Programs
Maryland Historical Trust
100 Community Place
Crownsville, MD 21032

STATE CLEARINGHOUSE RECOMMENDATION

State Application Identifier: MD20030319-0221

Applicant: Maryland Historical Trust

Project Description: Historic Nomination - CHURCHTON AND SHADY SIDE ROSENWALD SCHOOL

Project Location: County(ies) of Anne Arundel

Approving Authority: U.S. Department of the Interior DOI/NPS

CFDA Number: 15.914

Funds: Federal: \$ 0.00 State: \$ 0.00 Local: \$ 0.00 Other: \$ 0.00

Recommendation: Consistent

Dear Mr. Little:

In accordance with Presidential Executive Order 12372 and Code of Maryland Regulation 14.24.04, the State Clearinghouse has coordinated the intergovernmental review of the referenced project. This letter constitutes the State process review and recommendation. This recommendation is valid for a period of three years from the date of this letter.

Review comments were requested from the Maryland Department(s) of Natural Resources, Transportation, Anne Arundel County, and the Maryland Department of Planning.

The Maryland Department(s) of Natural Resources, and Transportation; Anne Arundel County; and the Maryland Department of Planning found this project to be consistent with their plans, programs, and objectives.

The State Application Identifier Number must be placed on any correspondence pertaining to this project. The State Clearinghouse must be kept informed if the approving authority cannot accommodate the recommendation.

Please remember, you must comply with all applicable state and local laws and regulations. If you need assistance or have questions, contact the State Clearinghouse staff person noted above at 410-767-4490 or through e-mail at gwagner@mdp.state.md.us. **Also please complete the attached form and return it to the State Clearinghouse as soon as the status of the project is known. Any substitutions of this form must include the State Application Identifier Number. This will ensure that our files are complete.**

Mr. J. Rodney Little
May 9, 2003
Page 2

Thank you for your cooperation with the MIRC process.

Sincerely,

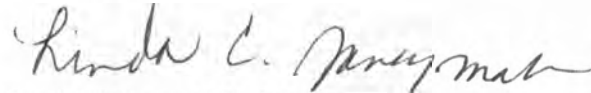

Linda C. Janey, J.D., Manager
Maryland State Clearinghouse
for Intergovernmental Assistance

LCJ:GW

Enclosure(s)

cc: Kathryn Orosz - DHCD/MHT
Carol Shull - National Register*
Ray Dintaman - DNR
Ronald Spalding - MDOT

Robert Caffrey - ANAR
Joe Tassone - MDPE

Larry Duket - MDPM

03-0221.CLS.doc

Robert L. Ehrlich, Jr.
Governor
Michael S. Steele
Lt. Governor
Victor L. Hoskins
Secretary
Shawn S. Karimian
Deputy Secretary



MARYLAND DEPARTMENT OF HOUSING
& COMMUNITY DEVELOPMENT

May 22, 2003

Trustees of Hall Memorial United Methodist Church
7780 Solley road
Glen Burnie, Maryland 21060

Attention: Helen Johnson

RE: MARLEY NECK ROSENWALD SCHOOL
Anne Arundel County, Maryland

Dear Ms. Johnson:

The above referenced property was considered by the Governor's Consulting Committee for nomination to the National Register of Historic Places on May 13, 2003. The Committee recommends nomination of the property. The next step in the process involves final preparation of the application materials by the Trust for submission to the National Register office in Washington. You will be advised in writing of the decision of the National Register on the nomination.

Sincerely,

Peter E. Kurtze
Administrator,
Evaluation and Registration

PEK/jmg

cc: State Clearinghouse #MD20030319-0227
Ms. Sherri Marsh





Maryland Department of Planning
Maryland Historical Trust

Martin O'Malley
Governor

Anthony G. Brown
Lt. Governor

Richard Eberhart Hall
Secretary

Matthew J. Power
Deputy Secretary

November 4, 2009



Mr. J. Paul Loether, Chief
National Register of Historic Places
National Park Service
1201 I (eye) St., NW
Mail Stop 2280
Washington, DC 20005

RE: SCOTT, LULA G., COMMUNITY CENTER
Anne Arundel County, Maryland

Dear Mr. Loether:

Enclosed is documentation for nominating the Lula G. Scott Community Center, Anne Arundel County, Maryland to the National Register of Historic Places. The state review board and the owners concur in my recommendation for listing. Should you have questions in this matter, please contact Peter Kurtze at (410) 514-7649.

Sincerely,

J. Rodney Little
Director-State Historic
Preservation Officer

JRL/jmg

cc: State Clearinghouse #MD20030319-0221

Enclosures: NR form and 9 continuation sheets
1 USGS map
8 - 5x7 b/w prints
1 - CD-R

Correspondence: letter, Little to Ware, 1 April 2003
letter, Janey to Little, 8 May 2003
letter, Kurtze to Johnson, 22 May 2003