

404

**United States Department of the Interior
Heritage Conservation and Recreation Service**

**National Register of Historic Places
Inventory—Nomination Form**

See instructions in *How to Complete National Register Forms*
Type all entries—complete applicable sections

For HCRS use only	
received	SEP 16 1980
date entered	OCT 23 1980

1. Name

historic James Marr House and Farm

and/or common

2. Location

NE of Columbus on

street & number Route 1, Marr Road not for publication

city, town Columbus vicinity of congressional district 9th Indiana

state Indiana code 018 county Bartholomew code 005

3. Classification

Category	Ownership	Status	Present Use
<input type="checkbox"/> district	<input type="checkbox"/> public	<input checked="" type="checkbox"/> occupied	<input checked="" type="checkbox"/> agriculture
<input checked="" type="checkbox"/> building(s)	<input checked="" type="checkbox"/> private	<input type="checkbox"/> unoccupied	<input type="checkbox"/> commercial
<input type="checkbox"/> structure	<input type="checkbox"/> both	<input type="checkbox"/> work in progress	<input type="checkbox"/> educational
<input type="checkbox"/> site	Public Acquisition	Accessible	<input checked="" type="checkbox"/> private residence
<input type="checkbox"/> object	<input type="checkbox"/> in process	<input type="checkbox"/> yes: restricted	<input type="checkbox"/> religious
	<input type="checkbox"/> being considered	<input type="checkbox"/> yes: unrestricted	<input type="checkbox"/> scientific
		<input type="checkbox"/> no	<input type="checkbox"/> transportation
			<input type="checkbox"/> other:

4. Owner of Property

name Ray Marr, Junior

street & number Route 1, Marr Road

city, town Columbus vicinity of _____ state Indiana

5. Location of Legal Description

courthouse, registry of deeds, etc. Bartholomew County Courthouse

street & number 3rd and Washington Streets

city, town Columbus state Indiana

6. Representation in Existing Surveys

title Indiana Historic Sites Inventory has this property been determined eligible? yes no

date Summer 1979 federal state county local

depository for survey records Indiana Dept. of Natural Resources

city, town Indianapolis state Indiana

7. Description

Condition		Check one	Check one
<input checked="" type="checkbox"/> excellent	<input checked="" type="checkbox"/> deteriorated	<input type="checkbox"/> unaltered	<input checked="" type="checkbox"/> original site
<input checked="" type="checkbox"/> good	<input type="checkbox"/> ruins	<input checked="" type="checkbox"/> altered	<input type="checkbox"/> moved date _____
<input type="checkbox"/> fair	<input type="checkbox"/> unexposed		

Describe the present and original (if known) physical appearance

The James Marr House and Farm is located in the northeast corner of Columbus Township on Marr Road about 25 feet from the busy thoroughfare. The farm has many of its original out buildings. All but one are in excellent or good condition. The grounds surrounding the house are also beautifully maintained. Brick walks, carefully groomed gardens and lovely old trees contribute to the visual harmony of the farm.

Construction on the James Marr House was completed in 1871. The house is a 2 story brick with walls 14" thick. The main part is square in plan. The facade is 3 bays wide, with the door in the center. Windows have flat openings, plain moulding surrounds and smooth stone sills and lintels. Tall first floor windows have 9/12 lights and extend to the water table. second floor windows have 9/9 lights. The entry door is recessed with paneled reveals, and flanked by large cast iron lanterns, circa 1925. The outside door is a double louvered door. The water table, foundation and front stoop are stone. The house has a gable roof with gables on the sides, plain wood entablature, and plain box cornice with returns. The roof is slate. There are 4 chimneys: twin banded brick chimneys centrally located in the main part of the house; a heavy Colonial Revival era chimney added in the early 20th century on the north side of the house; and a plain brick chimney in the center of the rear extension.

The rear extension forms an el with the main part of the house. It is a two story brick rectangle with a gable roof crossing the main roof. It has a plain frieze and a projecting cornice. A small, enclosed frame porch with lattice work, elliptical and tudor arched openings is on the south side of this part of the house. On the north side of the extension is a wood frame enclosed porch, formerly the summer kitchen. It has a shed roof, plain frieze, box cornice, horizontal wood siding, and large multi-light windows.

The interior of the main part of the house has a central hall and originally had 2 rooms on each side on each floor. The double parlors on the north side were made into one large living room, and the two bedrooms over the parlors were made into a larger master bedroom and bath in the early 20th century by the second generation occupying the house. At the same time the large marble fireplace and the large chimney on the north side were added. On the south side of the first floor are an office with a small marble fireplace and a dining room. Above these rooms are bedrooms. The rear extension contains the kitchen on the first floor and a bedroom on the second floor. The enclosed porch is now a family room. Ceiling heights on the first floor are 12' and on the second floor 12' 8". Tall door openings have architrave moulding surrounds. Doors are 6 paneled. Other woodwork includes high moulded baseboards, paneled wainscotting and wide cornice mouldings. The master bedroom has moulded window and door entablatures, and the kitchen has pedimented window hoods. Most of the woodwork is poplar. The straight stair in the central hall flares out at the bottom where there is a heavy turned walnut newell post. The banister is also walnut. Hall wallpaper installed in 1917 is still in good condition. New floorboards have been laid over the original oak flooring except in the kitchen. Louvered and paneled shutters are on all the windows. Many are (see continuation sheet 1)

8. Significance

Period	Areas of Significance—Check and justify below			
<input type="checkbox"/> prehistoric	<input type="checkbox"/> archeology-prehistoric	<input type="checkbox"/> community planning	<input type="checkbox"/> landscape architecture	<input type="checkbox"/> religion
<input type="checkbox"/> 1400-1499	<input type="checkbox"/> archeology-historic	<input type="checkbox"/> conservation	<input type="checkbox"/> law	<input type="checkbox"/> science
<input type="checkbox"/> 1500-1599	<input checked="" type="checkbox"/> agriculture	<input type="checkbox"/> economics	<input type="checkbox"/> literature	<input type="checkbox"/> sculpture
<input type="checkbox"/> 1600-1699	<input checked="" type="checkbox"/> architecture	<input type="checkbox"/> education	<input type="checkbox"/> military	<input type="checkbox"/> social/ humanitarian
<input type="checkbox"/> 1700-1799	<input type="checkbox"/> art	<input type="checkbox"/> engineering	<input type="checkbox"/> music	<input type="checkbox"/> theater
<input checked="" type="checkbox"/> 1800-1899	<input type="checkbox"/> commerce	<input type="checkbox"/> exploration/settlement	<input type="checkbox"/> philosophy	<input type="checkbox"/> transportation
<input checked="" type="checkbox"/> 1900-	<input type="checkbox"/> communications	<input type="checkbox"/> industry	<input type="checkbox"/> politics/government	<input type="checkbox"/> other (specify)
		<input type="checkbox"/> invention		

Specific dates 1871 - completed **Builder/Architect** James Marr (owner built)

Statement of Significance (in one paragraph)

The James Marr House and Farm is perhaps the best representation of a 19th century farm in Bartholomew County. It is also significant in that it has been farmed continuously by 6 generations of the same family, 5 of whom have occupied the present house, and because of the prominence of the Marr family in the county. The farm was first purchased by Lewis Marr, whose father was one of the first settlers and landowners in Bartholomew County, in 1852. Lewis' son, James, inherited the farm from his father in 1859. Like the others of its time, James Marr's farm was virtually self sufficient. In addition to the crops (corn, wheat, oats), livestock (milk cows, sheep, hogs, chickens), and apple orchards, the farm boasted a maple sugar camp, beehives and a blacksmith shop. Bricks for the farm buildings were fired on the property. Lumber used in building was supplied by trees on the farm. No resource was wasted. James was an economical man who kept strict accounts. According to his records, the house was built at a cost of \$4596.08. As the future generations of his family would be, James was involved in local politics and was a charter member of the Republican party. In 1890, when their youngest son, Edd, turned 21, James and Mary McCalla Marr passed on the job of farming to him and moved into 524 3rd Street in Columbus (listed on the National Register of Historic Places May 22, 1978). Edd and Maggie Dickey Marr lived in the house together for 52 years and were responsible for much updating of the house, including installing the first bathroom. They also put in an electric generator, believed to be the first one on a farm in Bartholomew County. Heretofore the lighting had been all by kerosene lamp, as James Marr was apparently too economical to install gas lighting in the house. Edd Marr was distinguished locally as a county commissioner, and in Indiana, as a member of the State Fair Board. After Edd's death, his son, Ray, and his wife, Jean Griffith Marr, took over the farm. Jean's remodeling included the milk house, the small porch and the addition of wainscoting to the interior. Ray's son, Ray Marr Junior, who has been a state legislator and is now a county commissioner, presently lives in the house with his wife, Martha Lou Bower Marr, and farms it with the help of his son, Guy, who lives in the tenant house.

9. Major Bibliographical References

Family Records

UTM NOT VERIFIED

10. Geographical Data

ACREAGE NOT VERIFIED

Acreege of nominated property approx. 8 acres

Quadrangle name Edinburg

Quadrangle scale 1:24000

UMT References

A	1 6	5 9 6 5 8 0	4 3 4 5 5 9 0
	Zone	Easting	Northing

B							
	Zone	Easting	Northing				

C							
	Zone	Easting	Northing				

D							
	Zone	Easting	Northing				

E							
	Zone	Easting	Northing				

F							
	Zone	Easting	Northing				

G							
	Zone	Easting	Northing				

H							
	Zone	Easting	Northing				

Verbal boundary description and justification

See Continuation Sheet

List all states and counties for properties overlapping state or county boundaries

state	code	county	code
-------	------	--------	------

state	code	county	code
-------	------	--------	------

11. Form Prepared By

name/title Laura Jones, preservation consultant

organization Preserve to Enjoy, Inc.
Columbus, Indiana

date March 18, 1980

street & number 153 Strathmore Rd. #2

telephone (617) 783-5412

city or town Brighton

state Massachusetts

12. State Historic Preservation Officer Certification

The evaluated significance of this property within the state is:

national state local

As the designated State Historic Preservation Officer for the National Historic Preservation Act of 1966 (Public Law 89-665), I hereby nominate this property for inclusion in the National Register and certify that it has been evaluated according to the criteria and procedures set forth by the Heritage Conservation and Recreation Service.

State Historic Preservation Officer signature

title State Historic Preservation Officer

date 9-9-80

For HCRS use only

I hereby certify that this property is included in the National Register

Keeper of the National Register

date 10/23/80

Attest:

date

Chief of Registration

**NATIONAL REGISTER OF HISTORIC PLACES
INVENTORY -- NOMINATION FORM**

FOR HCRS USE ONLY
RECEIVED SEP 16 1980
DATE ENTERED

CONTINUATION SHEET 1

ITEM NUMBER 7 PAGE 1

original and others have been fabricated to match the originals.

To the rear of the house is the Smoke House, a one story brick building with a gable roof, box cornice, board and batten door, stone foundation, and 2 small segmental arched windows. The Smoke House was built about the same time as the house. It is now used for storage.

To the north of the house is the Wash/Wood House. Now used as a pool house, it is a 2 story brick building, 1 by 2 bays, with a gable roof, box cornice, and segmental arched windows. It was also built about the same time as the house. This building was used as a garage by the third generation. A bay window has been added by the present owners where the garage door opening was. They have also added to the rear of the building a shed roofed screened in porch which overlooks a swimming pool surrounded by a cast iron fence.

The Milk House is a small, 1 story building with a hip roof with wood shingles and extended rafters, tongue in groove siding, lattice work and tudor arches similar to the small porch on the south side of the main house. It has a 4 panel door and 2 small windows. It was built in 1890 and remodeled in the early part of this century.

The Garage is a wood frame building with a steep pitched gable roof, extended rafters and verticle board siding. The door is a board and batten double sliding door.

In deteriorating condition is a Shed, which predates the house, of mortise and tenon construction. It has a gable roof with wood shingles and verticle board siding. Beams are hand hewn. This is presumed to be the oldest building on the farm and is now used for storage.

The Small Barn also predates the house. It is of mortise and tenon construction, has hand hewn beams, a gable roof, vertical board siding, clapboard siding in the gables, iron latches and strap hinges, a board and batten sliding door and stone footings.

Built in 1901, The Large Barn replaced an earlier barn which burned. Construction is wood frame. The barn has a gable roof, vertical board siding, iron latches, and strap hinges.

The Chicken House is now used as a garden house. It is a 1 story wood frame building with clerestory windows, clapboard siding, corner boards, extended rafters and a 4 panel door.

FHR-8-300A
(11/78)

UNITED STATES DEPARTMENT OF THE INTERIOR
HERITAGE CONSERVATION AND RECREATION SERVICE

**NATIONAL REGISTER OF HISTORIC PLACES
INVENTORY -- NOMINATION FORM**

FOR HCRS USE ONLY

RECEIVED SEP 18 1980

DATE ENTERED

CONTINUATION SHEET 2

ITEM NUMBER 7

PAGE 2

Across Marr Road, on property which is also part of the original farm, is a Tenant House which was built in the late 19th century. It is a 1 story frame house with a 4 bay facade, gable roof, extended rafters, vergeboard, double hung sash windows with 4/4 lights, octagonal shaped roof tiles, stone foundation and clapboard siding.

**United States Department of the Interior
Heritage Conservation and Recreation Service**

**National Register of Historic Places
Inventory—Nomination Form**



Continuation sheet James Marr House and Farm Item number 10

Page 3

Beginning at a point which lies on the centerline of Marr Road, one thousand thirty-two (1032) feet south of the Northeast corner of the Northwest quarter of the Northeast quarter of Section 5, Township 9 North, Range 6; thence five hundred (500) feet to the east; thence six hundred five (605) feet to the south; thence five hundred (500) feet west; thence two hundred (200) feet south along the centerline of Marr Road; thence two hundred (200) feet west; thence two hundred (200) feet north; thence two hundred (200) feet east; thence six hundred five (605) feet north along the centerline of Marr Road, to the place of beginning.

NE CORNER of the
NW 1/4 of the NE 1/4
of Sec 5, Twp 9 N
Range 6

1032's

500'

Marr Road (150' East)

605'

605'

500'

200'

200'

200'

200'

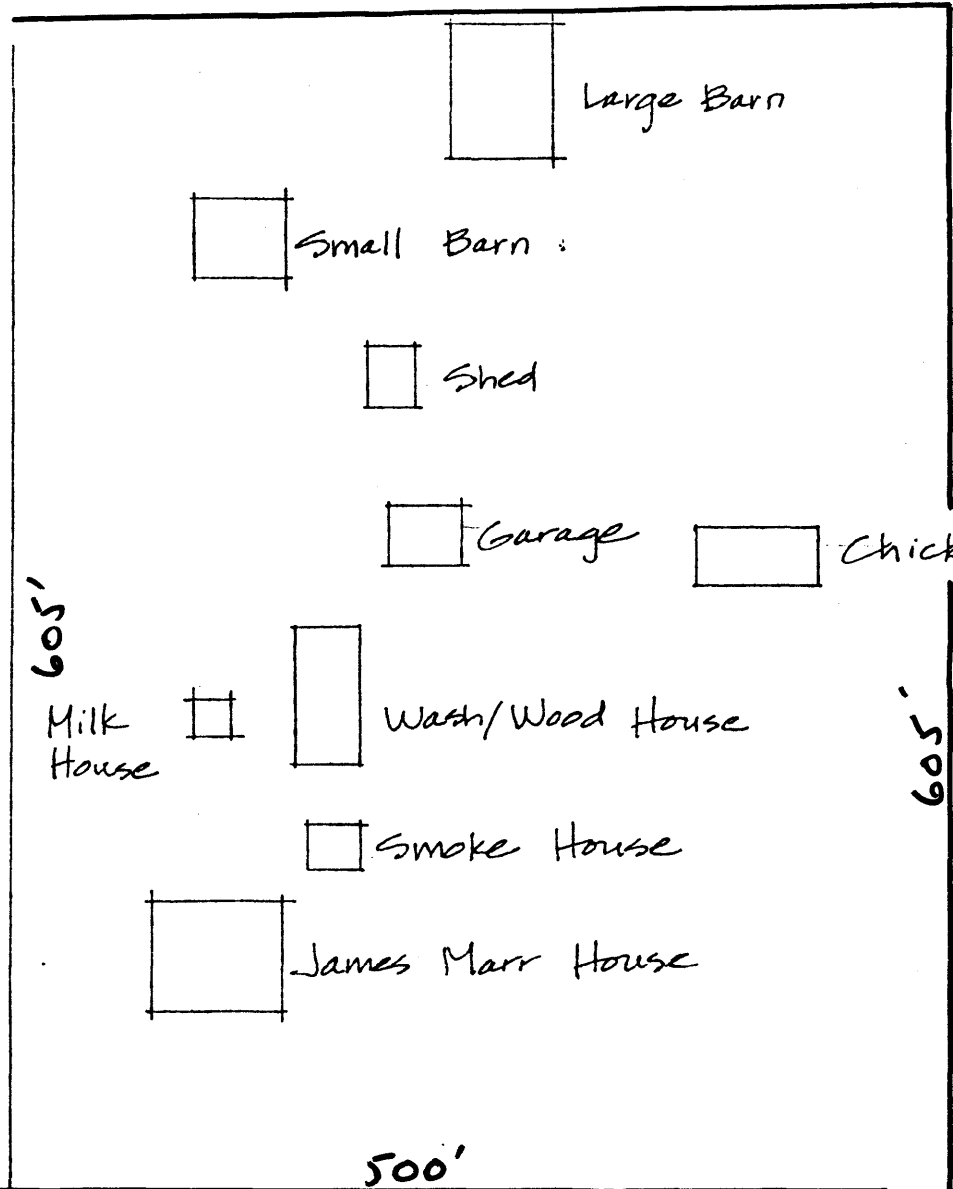

APPROXIMATE LOCATIONS / RELATIVE SIZES
OF BUILDINGS ON JAMES MARR FARM
COLUMBUS, INDIANA

↑ NORTH

SEP 16 1980

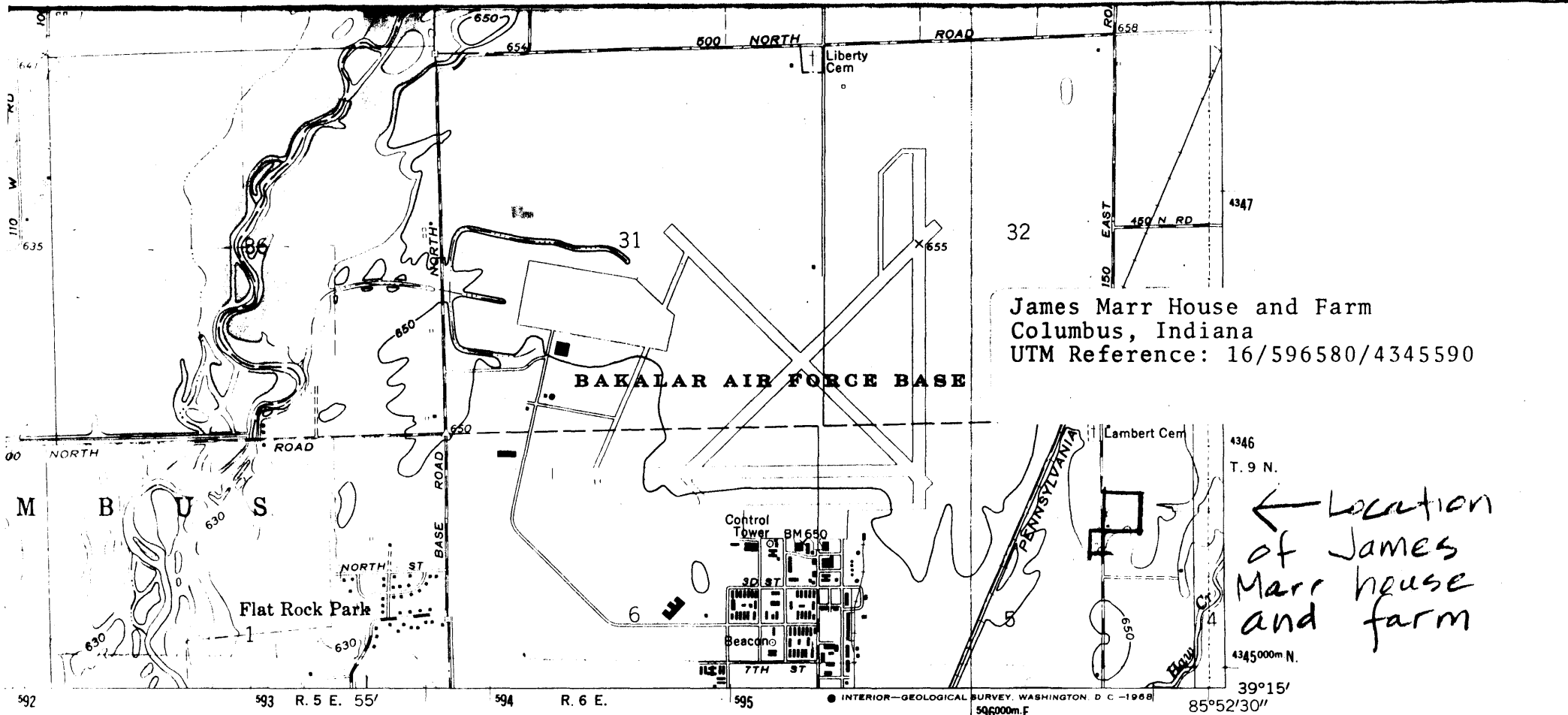

← Location of James Marr house and farm

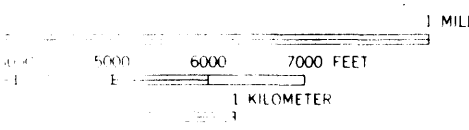

10 FEET
LEVEL



ROAD CLASSIFICATION

- Heavy-duty ——— Light-duty - - - - -
- Medium-duty - - - - - Unimproved dirt - - - - -
- Interstate Route ○ U. S. Route ○ State Route

EDINBURG, IND.

SW/4 EDINBURG 15' QUADRANGLE
N3915—W8552.5/7.5

1961

AMS 3862 IV SW—SERIES V851

ACCURACY STANDARDS
WASHINGTON, D. C. 20242
INDIANAPOLIS, INDIANA 46204
SYMBOLS IS AVAILABLE ON REQUEST

(ELIZABETHTOWN)
3862 III NE