

KENTUCKY HISTORIC RESOURCES INVENTORY

79003507 Wa-7

1. Historic Name (s) Jesse Middleton House  
 Original Owner William B. Smith\* / Jesse Middleton  
 Present Name \_\_\_\_\_  
 3. Owner's Name Ed Stout  
 4. Owner's Address Rt 17 Bowling Green  
 5. Location N. side Rt. 31W; cor. Rt. 1659 (Tuckertown Rd)  
 6. Open to Public  Yes  No  
 7. Visible from road  Yes  No  
 8. Ownership  Private  
 Local  
 State  
 Federal  
 9. Local Contact/Organization \_\_\_\_\_

22. ADD/County BARIV/WA     
 23. Zoning Classification Magisterial District   
 24. U.S.G. S. Quadrant (15'/75') Bristol  
 25. UTM Reference 116 564880 41102660  
 Zone Easting Northing  
 26. Prehistoric Site \_\_\_\_\_ Object \_\_\_\_\_  
 Historic Site \_\_\_\_\_ Structure \_\_\_\_\_  
 Building  
 27. District \_\_\_\_\_ Yes  No   
 Name: \_\_\_\_\_  
 28. Significance Evaluation NR

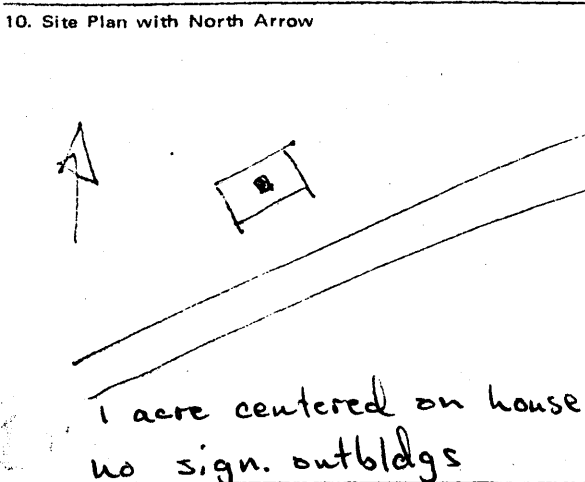

11. Architect \_\_\_\_\_  
 12. Builder \_\_\_\_\_  
 13. Date 1st 1/4 19th c.  
 14. Style Federal    
 15. Original Use dwelling - inn  
 16. Present Use dwelling  
 17. Condition    
 Interior poor  
 Exterior poor

29. Status \_\_\_\_\_ Date \_\_\_\_\_  
 National Landmark  
 National Register  
 Landmark Certificate  
 Kentucky Survey  
 Local Landmark  
 HABS/HAER  
 30. Theme arch.     
 Primary  
 Secondary  
 Other  
 31. Endangered  Yes  No

18. Description 2 story 3 bay brick - common bond - corbelled cornice - later 2 story frame ell - wooden lintels - enclosed corner staircase in SE corner - corner blocks - interior (central) brick chimney - very simple interior moldings - beaded vertical boards enclosing stair - beaded window surrounds - hall and parlor plan



19. History \* This property was purchased by William B. Smith in 1846. It had previously been owned by Edmund Hall - This house was reported to have been used as a stagecoach stop, built by the Middleton family  
 minister Samuel Templeton 1840-41 } ministers of  
 Joseph Templeton 1841-43 } First Presbyterian Church

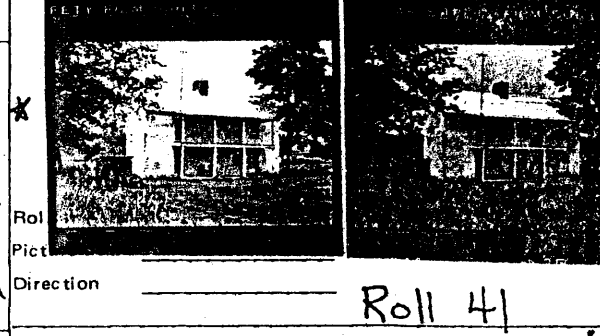

20. Significance Two of William Smith's sons served as ministers of the First Presbyterian Church in Bowling Green. Embodies an early manner of building; rare surviving example of an unusual type.

33. Tape No. \_\_\_\_\_ Negative No. A  
 34. Prepared by: KTG - JCH  
 35. Organization KHC  
 36. Date Spring 1978  
 37. Revision Dates \_\_\_\_\_ 38. Staff Review \_\_\_\_\_

21. Source of Information \* Sampler, An Album of Early Warren County Landmarks

(over)

APR 9 1200  
KENTUCKY HISTORICAL SOCIETY

Architecture :

7. Located on the historic main north-south route in the county, this structure is one of few in the state that reveal their original functions as stage coach stops. Unlike most buildings used as inns, taverns or stage coach stops, it was designed with a sense of informality and utility rather than in accordance with current notions of domestic styling. The central chimney is rare in Kentucky brick structures of this period, as is the use of a gallery in pre-Greek Revival architecture. The interior moldings are extremely simple.