

UNITED STATES DEPARTMENT OF THE INTERIOR
NATIONAL PARK SERVICE

**NATIONAL REGISTER OF HISTORIC PLACES
INVENTORY -- NOMINATION FORM**

FOR FEDERAL PROPERTIES

FOR NPS USE ONLY	
RECEIVED	MAR 27 1986
DATE ENTERED	SEP 25 1986

SEE INSTRUCTIONS IN *HOW TO COMPLETE NATIONAL REGISTER FORMS*
TYPE ALL ENTRIES -- COMPLETE APPLICABLE SECTIONS

1 NAME

HISTORIC

United States Post Office

AND/OR COMMON

Old Town Main Post Office

2 LOCATION

STREET & NUMBER

Center Street

N/A NOT FOR PUBLICATION

CITY, TOWN

Old Town

N/A VICINITY OF

CONGRESSIONAL DISTRICT
Second Congressional District

STATE

Maine 04468

CODE

5800

COUNTY

Penobscot

CODE

019

3 CLASSIFICATION

CATEGORY	OWNERSHIP	STATUS	PRESENT USE
<input type="checkbox"/> DISTRICT	<input checked="" type="checkbox"/> PUBLIC	<input checked="" type="checkbox"/> OCCUPIED	<input type="checkbox"/> AGRICULTURE <input type="checkbox"/> MUSEUM
<input checked="" type="checkbox"/> BUILDING(S)	<input type="checkbox"/> PRIVATE	<input type="checkbox"/> UNOCCUPIED	<input type="checkbox"/> COMMERCIAL <input type="checkbox"/> PARK
<input type="checkbox"/> STRUCTURE	<input type="checkbox"/> BOTH	<input type="checkbox"/> WORK IN PROGRESS	<input type="checkbox"/> EDUCATIONAL <input type="checkbox"/> PRIVATE RESIDENCE
<input type="checkbox"/> SITE	PUBLIC ACQUISITION	ACCESSIBLE	<input type="checkbox"/> ENTERTAINMENT <input type="checkbox"/> RELIGIOUS
<input type="checkbox"/> OBJECT	<input checked="" type="checkbox"/> IN PROCESS	<input checked="" type="checkbox"/> YES: RESTRICTED	<input checked="" type="checkbox"/> GOVERNMENT <input type="checkbox"/> SCIENTIFIC
	<input type="checkbox"/> BEING CONSIDERED	<input type="checkbox"/> YES: UNRESTRICTED	<input type="checkbox"/> INDUSTRIAL <input type="checkbox"/> TRANSPORTATION
		<input type="checkbox"/> NO	<input type="checkbox"/> MILITARY <input type="checkbox"/> OTHER:

4 AGENCY

REGIONAL HEADQUARTERS: (If applicable)

New England Field Real Estate and Buildings Office

STREET & NUMBER

1050 Waltham Street

CITY, TOWN

Lexington

N/A VICINITY OF

STATE

Massachusetts 02173

5 LOCATION OF LEGAL DESCRIPTION

COURTHOUSE,
REGISTRY OF DEEDS, ETC.

Penobscot County Registry of Deeds

STREET & NUMBER

97 Hammond Street

CITY, TOWN

Bangor

STATE

Maine 04468

6 REPRESENTATION IN EXISTING SURVEYS

TITLE

None

DATE

FEDERAL STATE COUNTY LOCAL

DEPOSITORY FOR
SURVEY RECORDS

CITY, TOWN

STATE

AUG 15 1986

7 DESCRIPTION

CONDITION		CHECK ONE	CHECK ONE
<input type="checkbox"/> EXCELLENT	<input type="checkbox"/> DETERIORATED	<input checked="" type="checkbox"/> UNALTERED	<input checked="" type="checkbox"/> ORIGINAL SITE
<input type="checkbox"/> GOOD	<input type="checkbox"/> RUINS	<input type="checkbox"/> ALTERED	<input type="checkbox"/> MOVED DATE _____
<input checked="" type="checkbox"/> FAIR	<input type="checkbox"/> UNEXPOSED		

DESCRIBE THE PRESENT AND ORIGINAL (IF KNOWN) PHYSICAL APPEARANCE

The Post Office is situated in the center of activity of the town. The exterior is entirely of dressed stone comprised of a high base with clearly defined windows, a two story portion with engaged columns at the corners and dividing the front facade into five bays; the center bay containing the entrance with a heavily carved architrave. The columns terminate in a plain fret which encircles the building and borders a series of small windows with diamond shaped grilles which are capped with a projecting parapet above.

The interior throughout has much of the original finishes and architectural treatment. The lobby has terrazzo floors with marble borders, marble wainscotting, wood panelled doors and casings, wood and glass transoms over the service counter and mail boxes and the vestibule has curved marble sides. There are some original light fixtures.

The building is in poor condition on the interior; however, renovation work is planned in the near future. The lobby is still in almost original configuration except that the original revolving door was replaced with aluminum store front entrance doors. The lobby is small and in need of rehabilitation and additional boxes.

The exterior was recently waterproofed and is in original condition except for a wooden loading dock enclosed which is very unsightly and greatly detracts from the rear elevation.

8 SIGNIFICANCE

PERIOD	AREAS OF SIGNIFICANCE -- CHECK AND JUSTIFY BELOW			
<input type="checkbox"/> PREHISTORIC	<input type="checkbox"/> ARCHEOLOGY-PREHISTORIC	<input type="checkbox"/> COMMUNITY PLANNING	<input type="checkbox"/> LANDSCAPE ARCHITECTURE	<input type="checkbox"/> RELIGION
<input type="checkbox"/> 1400-1499	<input type="checkbox"/> ARCHEOLOGY-HISTORIC	<input type="checkbox"/> CONSERVATION	<input type="checkbox"/> LAW	<input type="checkbox"/> SCIENCE
<input type="checkbox"/> 1500-1599	<input type="checkbox"/> AGRICULTURE	<input type="checkbox"/> ECONOMICS	<input type="checkbox"/> LITERATURE	<input type="checkbox"/> SCULPTURE
<input type="checkbox"/> 1600-1699	<input checked="" type="checkbox"/> ARCHITECTURE	<input type="checkbox"/> EDUCATION	<input type="checkbox"/> MILITARY	<input type="checkbox"/> SOCIAL/HUMANITARIAN
<input type="checkbox"/> 1700-1799	<input type="checkbox"/> ART	<input type="checkbox"/> ENGINEERING	<input type="checkbox"/> MUSIC	<input type="checkbox"/> THEATER
<input type="checkbox"/> 1800-1899	<input type="checkbox"/> COMMERCE	<input type="checkbox"/> EXPLORATION/SETTLEMENT	<input type="checkbox"/> PHILOSOPHY	<input type="checkbox"/> TRANSPORTATION
<input checked="" type="checkbox"/> 1900-	<input type="checkbox"/> COMMUNICATIONS	<input type="checkbox"/> INDUSTRY	<input type="checkbox"/> POLITICS/GOVERNMENT	<input type="checkbox"/> OTHER (SPECIFY)
		<input type="checkbox"/> INVENTION		

SPECIFIC DATES	Designed: 1912	BUILDER/ARCHITECT	Oscar Wenderoth, U.S. Treasury
	Constructed: 1914		Supervising Architect

STATEMENT OF SIGNIFICANCE

The Post Office was designed in 1912 and built in 1914, one of forty (40) post offices built throughout the United States that year. The building was built under the provisions of the Tarsney Act (1893-1912) and the first Omnibus Building Act of 1902. The building was one of the first buildings designed by Oscar Wenderoth (along with the Camden, Maine Post Office). The building design maintains James Knox Taylor's philosophy of designing "Classical Styles of Architecture" and the use of fine high quality, durable building materials and the use of symmetry and ornamentation. This building seems to contain many of the architectural elements and styling of James Knox Taylor's Bar Harbor Post Office (1908) and may have served as an influence of the somewhat more restrained Camden, Maine Post Office, also designed by Wenderoth in 1912.

The building is a strong reminder of the entirely eclectic period when public buildings were designed to inspire awe in the public. A building of classic design and materials, unique to its local; it is a strong focal point in the community and serves to dignify the area with an example of significant architectural effort.

9 MAJOR BIBLIOGRAPHICAL REFERENCES

History of Post Office Construction 1900-1940, July, 1982

Craig, Lois, ed., The Federal Presence: Architecture, Politics, and Symbols in the United States Government Building, Cambridge, Massachusetts: The MIT Press, 1979

10 GEOGRAPHICAL DATA

ACREAGE OF NOMINATED PROPERTY .51 (22,191 square feet)

UTM REFERENCES

A	1,9	5,27,0,6,0	4,9,7,5,1,0,0	B			
	ZONE	EASTING	NORTHING		ZONE	EASTING	NORTHING
C				D			

VERBAL BOUNDARY DESCRIPTION

The Post Office is located in an area close to the main business district. The building has approximately 123 feet of frontage on Center Street and approximately 164 feet of frontage on Shirley Street. The remainder of the lot is irregularly shaped.

LIST ALL STATES AND COUNTIES FOR PROPERTIES OVERLAPPING STATE OR COUNTY BOUNDARIES

STATE	CODE	COUNTY	CODE
STATE	CODE	COUNTY	CODE

11 FORM PREPARED BY

NAME / TITLE

Richard P. DeCoste, Architect

ORGANIZATION

SULLIVAN DESIGN GROUP, INC.

DATE

August 30, 1985

STREET & NUMBER

44 Adams Street

TELEPHONE

(617) 848-1545

CITY OR TOWN

Braintree

STATE

Massachusetts 02184

12 CERTIFICATION OF NOMINATION

STATE HISTORIC PRESERVATION OFFICER RECOMMENDATION

YES

NO

NONE

Earle C. Shepleworth, Jr.
STATE HISTORIC PRESERVATION OFFICER SIGNATURE

In compliance with Executive Order 11593, I hereby nominate this property to the National Register, certifying that the State Historic Preservation Officer has been allowed 90 days in which to present the nomination to the State Review Board and to evaluate its significance. The evaluated level of significance is National State Local.

FEDERAL REPRESENTATIVE SIGNATURE

TITLE

Director, Office of Real Estate

DATE

March 19, 1986

FOR NPS USE ONLY

I HEREBY CERTIFY THAT THIS PROPERTY IS INCLUDED IN THE NATIONAL REGISTER

Patrick Andrews

DATE

9/25/86

DIRECTOR, OFFICE OF ARCHEOLOGY AND HISTORIC PRESERVATION

ATTEST: *Beth L. Savage*

DATE

9/25/86

KEEPER OF THE NATIONAL REGISTER

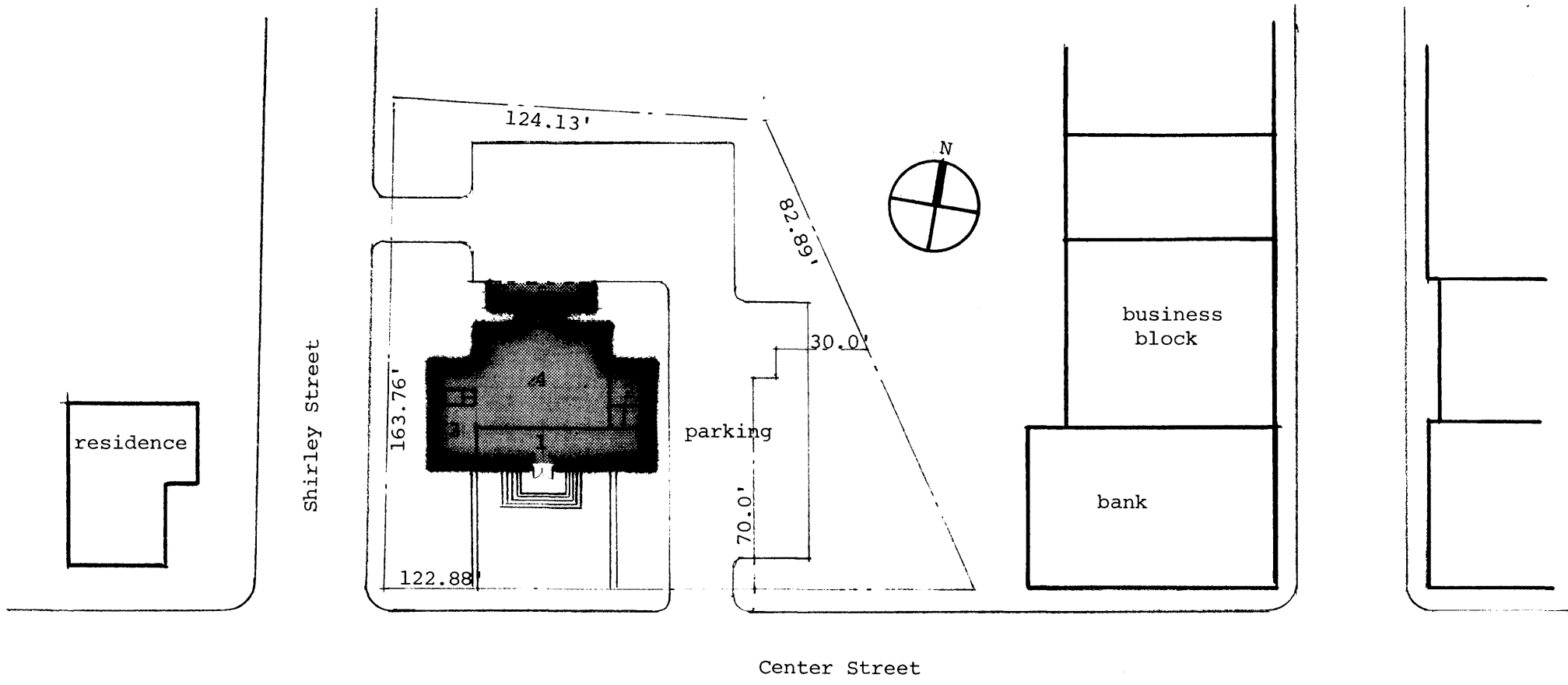

1. public lobby
2. postmaster
3. money order
4. work room
5. mail platform

