

**United States Department of the Interior
National Park Service**

**National Register of Historic Places
Inventory—Nomination Form**

For NPS use only

received MAR 23 1982

date entered

Continuation sheet

Item number

7

Page 5

3. (N-5822):

A. Property Name: Memorial Hall

B. Location and Verbal Boundary Description: Memorial Hall is located on the University of Delaware campus east of the intersection of South College Avenue and Kent Way. The property being nominated includes the building and 25-foot buffer zone only, situated on a piece of land including 57.82 acres (Property Tax Map, City of Newark, no. 26, lot no. 53).

C. Owner: University of Delaware, HULLIHEN Hall, Newark, Delaware 19711

D. Property Description:

Memorial Hall is a one and one half story "H" plan building with the original square block forming the central building wing. The exterior walls are made of brick laid in Flemish bond with glazed headers. White wood trim appears at the hipped roof center dome, and forms a molded boxed cornice with returns at each of the east and west gable end wings. Most window openings are double hung with 12 over 12 lights; each gable end window at the extreme wings has an arched frame with wide surroundings. A set of double doors with raised panels and an elliptical fanlight, flanked on either side by circular arched sash windows, is located at the north front facade. A large, three bay frame portico with Doric columns supporting a full entablature extends from the north facade of the main block. A similar portico also appears at the south facade. Reminiscent of Jefferson's designs for the University of Virginia, the architectural plan for Memorial Hall established a Georgian Revival motif for the remainder of the central campus buildings.

E. Historical Background:

Memorial Hall, originally known as Memorial Library, was erected on the University of Delaware campus in 1923 as a commemoration to Delaware soldiers who died in World War I. The interior memorial consists of a book of the dead resting on an altar surrounded by four bronze triptychs. Designed by Philadelphia architects Day and Klauder, the total cost of the building was \$340,000. Construction costs were raised through donation from citizens of Delaware.

The original building consisted of a central domed block which housed both the war memorial and exhibition foyer. Two wings on the east and west facades also provided office space and library study areas. The main library stacks, holding a collection of 140,000 books were located in the basement. Resulting from the flat roofs of each wing, drainage became a severe problem and in 1937 the basement flooded. This incident and other contributing problems prompted the reconstruction and enlargement of the building in 1938. Two expanded wings, with gable roofs were constructed at the east and west facades giving the building its overall "H" shape. The improved building served as the University's library until the new Morris Library was completed in the summer of 1963. Memorial Hall is now used as departmental offices and classroom space.

**United States Department of the Interior
National Park Service**

**National Register of Historic Places
Inventory—Nomination Form**

For NPS use only

received

date entered

Continuation sheet

Item number 7

Page 6

F. Significance:

Memorial Hall is a fine example of Georgian Revival architecture . It represents the early stages of the University's educational expansion and building development in the first decades of the century. It was among the first University of Delaware campus buildings designed by the prominent Philadelphia firm Day and Klauder, who were involved in the creation of the overall Jeffersonian plan for the new University, and who subsequently supervised the design and construction of many educational buildings flanking the University's south mall. The style of Memorial Hall and other buildings designed for the University by Day and Klauder was copied from surviving examples of Georgian architecture in Odessa and New Castle, Delaware, at the behest of H. Rodney Sharp. C.Z. Klauder's involvement with Memorial Hall and subsequent campus buildings contributed to his 1929 publication titled, College Architecture in America.

SKETCH MAP

Scale 1"-100'

N-5822
Memorial Hall

Property no. 26
Lot no. 53

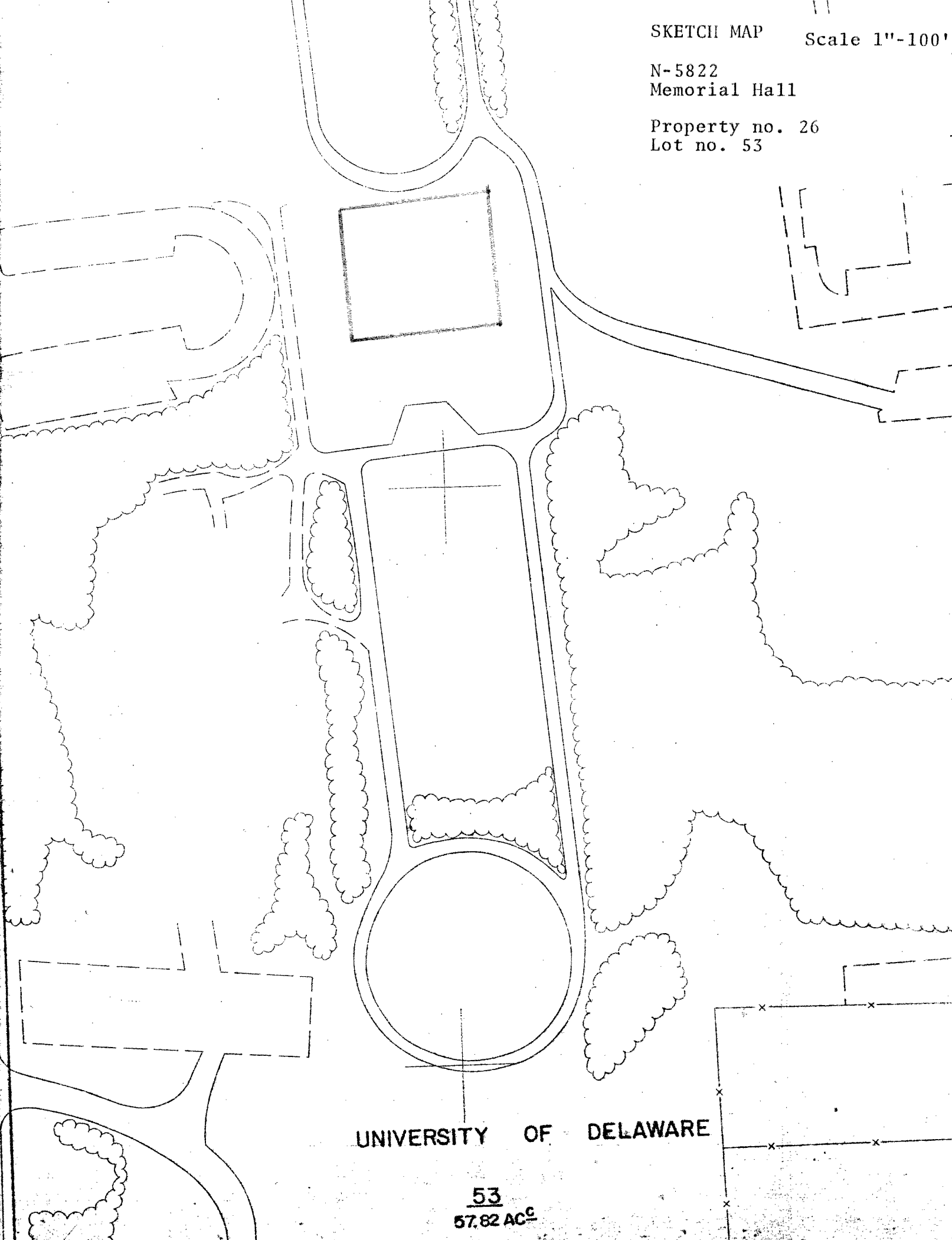

UNIVERSITY OF DELAWARE

53
57.82 AC^c