

KENTUCKY HISTORIC RESOURCES INVENTORY

Site No. Bb-187

1. Historic Name(s) <u>Sandusky house</u>		22. ADD/County <u>Bluegrass / Bourbon</u>	
Original Owner <u>Jacob or James Sandusky (or Sandoustky)</u>		23. U.S.G.S. Quadrant (15'/75') <u>Carlisle vic</u>	
2. Present Name <u>Sandusky house</u>		24. UTM Reference Zone <u>16</u> Easting <u>751760</u> Northing <u>4240960</u>	
3. Location <u>1 mi E of Blacks Crossroads Road on lane commencing 1 mi S of 68, on branch of</u>		25. Coordinate Accuracy <input type="checkbox"/>	
4. Owner's Name <u>Johann Th. Pavenstedt Klinkston</u>		26. Prehistoric Site <input type="checkbox"/> Object <input type="checkbox"/> Historic Site <input type="checkbox"/> Structure <input type="checkbox"/> Building <input checked="" type="checkbox"/> Other <input type="checkbox"/>	
5. Owner's Address <u>(over)</u>		27. National Register District Name: <input type="checkbox"/>	
6. Open to Public Yes <input type="checkbox"/> No <input checked="" type="checkbox"/>	7. Visible from road Yes <input type="checkbox"/> No <input checked="" type="checkbox"/>	8. Ownership Private <input checked="" type="checkbox"/> Local <input type="checkbox"/> State <input type="checkbox"/> Federal <input type="checkbox"/>	
9. Local Contact/Organization <u>Mrs. Miller, owner 484-3982</u>		28. Significance Evaluation <input type="checkbox"/>	
10. Site Plan with North Arrow <u>see attached boundary form</u>		29. Status National Landmark <input type="checkbox"/> Date _____ National Register <input type="checkbox"/> Landmark Certificate <input type="checkbox"/> Kentucky Survey <input type="checkbox"/> Local Landmark <input type="checkbox"/> HABS/HAER <input type="checkbox"/>	
11. Architect		30. Historic Theme Primary <u>Architecture</u> <input type="checkbox"/> C Secondary <u>Settlement</u> <input type="checkbox"/> K Other <input type="checkbox"/>	
12. Builder		31. Endangered Yes <input type="checkbox"/> No <input checked="" type="checkbox"/>	
13. Date <u>early 1790's / 1800's A.</u> <input type="checkbox"/> B. <input checked="" type="checkbox"/>		32. Preservation Project Status <input type="checkbox"/>	
14. Style A. <u>Federal</u> <input checked="" type="checkbox"/> B. <input type="checkbox"/>		Actual Cost in \$1,000s <input type="checkbox"/>	
15. Original Use <u>residence</u> <input checked="" type="checkbox"/> A. <input type="checkbox"/>		33. ATTACH PHOTO <u>in attached envelope</u>	
16. Present use <u>residence</u>		Roll No. _____	
17. Condition <u>excellent</u> <input checked="" type="checkbox"/> A. <input type="checkbox"/>		Picture No. _____	
18. Description <u>3 bay 1 1/2 story center passage dry stone house on high basement, with double pile stone wing on West. House has partially exterior chimneys on each end, 2 small attic windows; the 2</u> (Continue on Back) <u>(over)</u>		Direction _____	
No. Stories <u>1 1/2</u> <input checked="" type="checkbox"/> B. <input type="checkbox"/>		34. Prepared by: <u>C. M. Wooley</u>	
Single Pile <input checked="" type="checkbox"/> NA <input type="checkbox"/>		35. Organization _____	
Double Pile _____		36. Date <u>1982</u>	
Floor Plan <u>center passage</u> <input checked="" type="checkbox"/> I. <input type="checkbox"/>		37. Revision Dates _____ 38. Staff Review _____	
Structural Fabric <u>stone</u> A. <input checked="" type="checkbox"/> B. <input checked="" type="checkbox"/>			
Decorative Fabric <u>boussois</u> A. <input checked="" type="checkbox"/> B. <input type="checkbox"/>			
Roof Form <u>gable</u>			
19. History <u>Built by one of the Sandusky brothers who were among the earliest explorers to Ky; came down Ohio w. Capt James Harrod in 1774, were surveyors in Hancock Taylor's party the same year (over)</u>			
20. Significance <u>Good typical early stone house made special by double pile wing; in good condition.</u>			
21. Source of Information <u>1: Mrs Wade Hampton Whitley 18: inspection 19: R. Collins II pp 21, 367, 423</u>			

18. cont.:

front windows have pegged frames, ovolo trim, 11 stone poussoirs, and are larger size than usual with (4 ft x 6 ft) 12/12 sash, square sills; front door has transom, paneled jamb; cellar entrance under E front window. [as at Wd. 136]

Very good masonry, best on wing.

Interior has paneled wainscote with beaded frieze below chair rail.

The double pile stone wing of early date has 2 partially ulterior chimneys on W. end, stiple painting (original), no poussoirs. Because depth of wing is greater than house, and roofs have same pitch, an awkward flat roof connects the 2 ridges. Frames on wing are changed, attic window lengthened.

Hip roof porch added to front, front porch ^{wall} painted white; enclosed shed roofed addition on rear. There was a log or frame ell to rear of main house (prob. a separate kitchen), stone chimney remains. (photo 4)

House is 1 mile off present road on a branch of Hinckston's Creek.

19. cont.:

Had station in Bourbon in 1786.

5.

Johann Th. Pavenstedt

Pavenstedt and Pauli

Herrlichkeit 6

Postfach 10-10-80

Versicherungsborse

28 Bremen, W. Germany

VERBAL BOUNDARY DESCRIPTION & JUSTIFICATION

Beginning at A at the corner of the yard at the gate, there is
with fence around yard W 191 ft, N 162 ft, E 191 ft and
S 162 ft to the beginning containing the stone house and stone
chimney, about 2/3 acre. Outbuildings are recent.

SKETCH MAP OF SITE SHOWING BOUNDARIES AND KEY BUILDINGS AND FEATURES WITH NORTH ARROW.

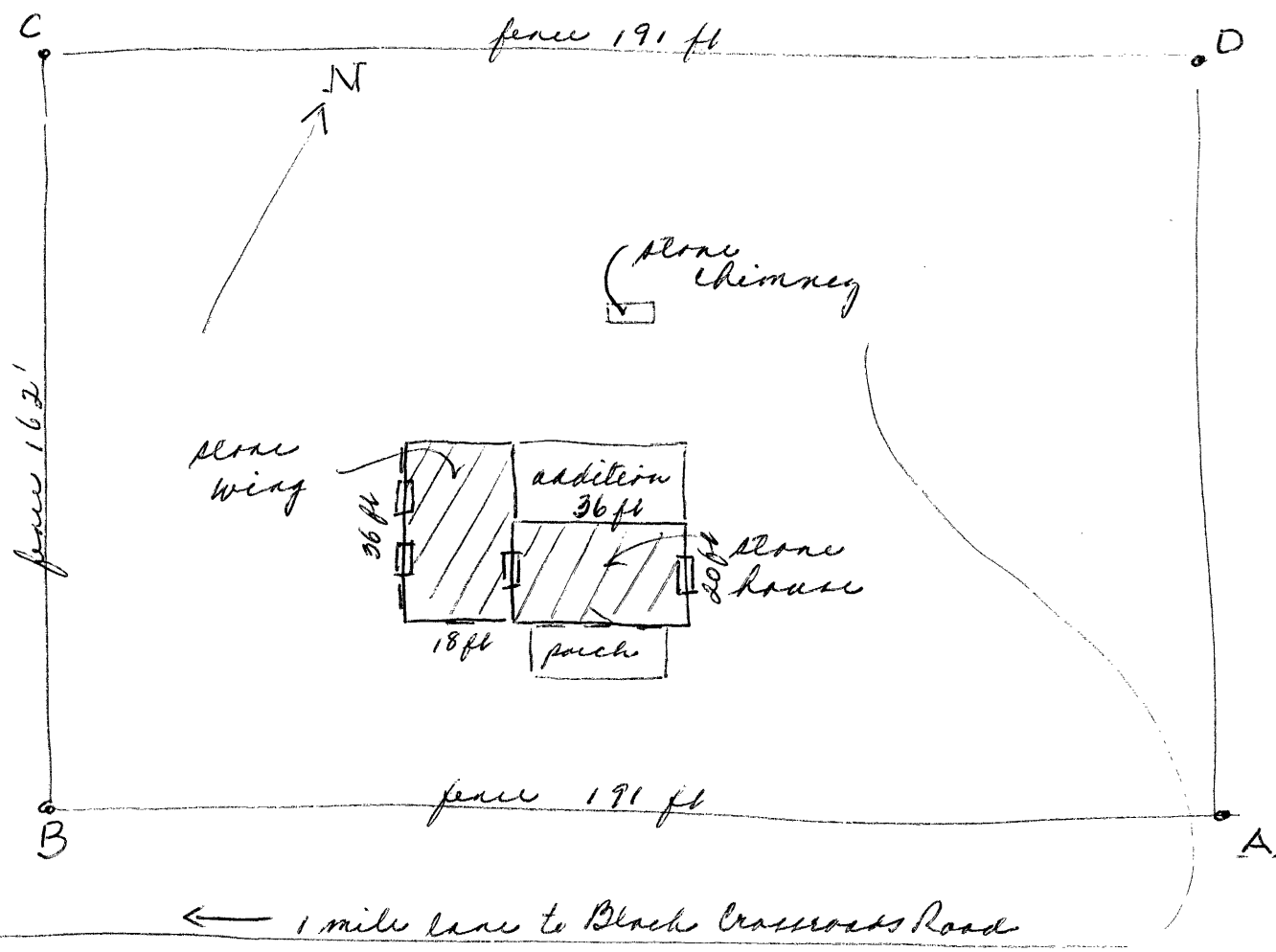

KENTUCKY HISTORIC RESOURCES INVENTORY

Site No. Bb-187

1. Historic Name(s) <u>Sandusky house</u>		22. ADD/County <u>Bluegrass / Bourbon</u>	
Original Owner <u>Jacob or James Sandusky (or Sandoustky)</u>		23. U.S.G.S. Quadrant (15'/75') <u>Carlisle vic</u>	
2. Present Name <u>Sandusky house</u>		24. UTM Reference Zone <u>16</u> Easting <u>751760</u> Northing <u>4240960</u>	
3. Location <u>1 mi N of Blacks Crossroads Road on lane commencing 1 mi S of 68, on branch of</u>		25. Coordinate Accuracy <input type="checkbox"/>	
4. Owner's Name <u>Johann Th. Pavenstedt Klinkston</u>		26. Prehistoric Site <input type="checkbox"/> Object <input type="checkbox"/> Historic Site <input type="checkbox"/> Structure <input type="checkbox"/> Building <input checked="" type="checkbox"/> Other <input type="checkbox"/>	
5. Owner's Address <u>(over)</u>		27. National Register District Name: <input type="checkbox"/>	
6. Open to Public Yes <input type="checkbox"/> No <input checked="" type="checkbox"/>	7. Visible from road Yes <input type="checkbox"/> No <input checked="" type="checkbox"/>	8. Ownership Private <input checked="" type="checkbox"/> Local <input type="checkbox"/> State <input type="checkbox"/> Federal <input type="checkbox"/>	
9. Local Contact/Organization <u>Mrs. Miller, owner 484-3982</u>		28. Significance Evaluation <input type="checkbox"/>	
10. Site Plan with North Arrow <u>see attached boundary form</u>		29. Status National Landmark <input type="checkbox"/> Date _____ National Register <input type="checkbox"/> Landmark Certificate <input type="checkbox"/> Kentucky Survey <input type="checkbox"/> Local Landmark <input type="checkbox"/> HABS/HAER <input type="checkbox"/>	
11. Architect		30. Historic Theme Primary <u>Architecture</u> <input type="checkbox"/> <u>C</u> Secondary <u>Settlement</u> <input type="checkbox"/> <u>K</u> Other <input type="checkbox"/>	
12. Builder		31. Endangered Yes <input type="checkbox"/> No <input checked="" type="checkbox"/>	
13. Date <u>early 1790's / 1800's A.</u> <input type="checkbox"/> <u>1</u> B. <input checked="" type="checkbox"/> <u>2</u>		32. Preservation Project Status <input type="checkbox"/>	
14. Style A. <u>Federal</u> <input checked="" type="checkbox"/> <u>B</u> B. <input type="checkbox"/>		Actual Cost in \$1,000s <input type="checkbox"/>	
15. Original Use <u>residence</u> <input checked="" type="checkbox"/> <u>a</u>		33. ATTACH PHOTO <u>in attached envelope</u>	
16. Present use <u>residence</u>		Roll No. _____	
17. Condition <u>excellent</u> <input checked="" type="checkbox"/> <u>a</u>		Picture No. _____	
18. Description <u>3 bay 1 1/2 story center passage dry stone house on high basement, with double pile stone wing on W end. House has partially exterior chimneys on each end, 2 small attic windows; the 2</u> <u>(Continue on Back) (over)</u>		Direction _____	
No. Stories <u>1 1/2</u> <input checked="" type="checkbox"/> <u>B</u>		34. Prepared by: <u>C.M. Wooley</u>	
Single Pile <input checked="" type="checkbox"/> NA <input type="checkbox"/>		35. Organization _____	
Double Pile _____		36. Date <u>1982</u>	
Floor Plan <u>center passage</u> <input checked="" type="checkbox"/> <u>1</u>		37. Revision Dates _____ 38. Staff Review _____	
Structural Fabric <u>stone</u> A. <input checked="" type="checkbox"/> <u>B</u> B. <input checked="" type="checkbox"/> <u>B</u>			
Decorative Fabric <u>boussois</u> A. <input checked="" type="checkbox"/> <u>2</u> B. <input type="checkbox"/>			
Roof Form <u>gable</u>			
19. History <u>Built by one of the Sandusky brothers who were among the earliest explorers to Ky; came down Ohio w. Capt James Harrod in 1774, were surveyors in Hancock Taylor's party the same year (over)</u>			
20. Significance <u>Good typical early stone house made special by double pile wing; in good condition.</u>			
21. Source of Information <u>1: Mrs Wade Hampton Whitley</u> <u>18: inspection</u> <u>19: R. Collins II pp 21, 367, 423</u>			

18. cont.:

front windows have pegged frames, ovolo trim, 11 stone poussoirs, and are larger size than usual with (4 ft x 6 ft) 12/12 sash, square sills; front door has transom, paneled jamb; cellar entrance under E front window. [as at Wd. 136]

Very good masonry, best on wing.

Interior has paneled wainscote with beaded frieze below chair rail.

The double pile stone wing of early date has 2 partially ulterior chimneys on W. end, stiple painting (original), no poussoirs. Because depth of wing is greater than house, and roofs have same pitch, an awkward flat roof connects the 2 ridges. Frames on wing are changed, attic window lengthened.

Hip roof porch added to front, front porch ^{wall} painted white; enclosed shed roofed addition on rear. There was a log or frame ell to rear of main house (prob. a separate kitchen), stone chimney remains. (photo 4)

House is 1 mile off present road on a branch of Hinckston's Creek.

19. cont.:

Had station in Bourbon in 1786.

5.

Johann Th. Pavenstedt

Pavenstedt and Pauli

Herrlichkeit 6

Postfach 10-10-80

Versicherungsborse

28 Bremen, W. Germany

VERBAL BOUNDARY DESCRIPTION & JUSTIFICATION

Beginning at A at the corner of the yard at the gate, there is
with fence around yard W 191 ft, N 162 ft, E 191 ft and
S 162 ft to the beginning containing the stone house and stone
chimney, about 2/3 acre. Outbuildings are recent.

SKETCH MAP OF SITE SHOWING BOUNDARIES AND KEY BUILDINGS AND FEATURES WITH NORTH ARROW.

