

NOV 26 1986

KENTUCKY HISTORIC RESOURCES
Individual Inventory Form

Resource # BE-352
BOONE County

1. Name of Resource: Watts House

2. Original Owner: Unknown

3. Other Names: Valley Heights Farm

4. Prehistoric Site Building Structure Object Other

5. Location: West side Williams Road
Two miles north of Bullittsville

6. Owner's Name: Earl Souther, Sr. [P]

7. Owner's Address: 933 Williams Road
Burlington, Kentucky 41005

8. Evaluation: [G]

9. Recognition & Date:
 Nat.Landmark Local Landmark
 Nat.Register HABS/HAER
 Highway Marker KY Inventory
 KY Landmark Certificate

10. N.R.Status & Date:

11. N.R.Group:
 District Name: []
 Mult.Resource Area: []
 Thematic Name: Early Stone Buildings []

12. Historical Theme:
 Primary: Architecture [030]
 Secondary: Settlement [140]
 Other: []

13. Statement of Significance:
 This is a very good example of an unusually large settlement period stone house. It is the only one in Kentucky with a five-bay, hall-parlor plan where the entrance is not in the center bay.
 []

14. History:
 Watts family, latter 19th century.
 Souther family since 1916. History not researched.

15. Source of historical information and/or contact person:
 Interview with Owner

16. Date: Original Building late 18th [9]
 Addition []

17. Style: Federal [21]
 []

18. Architect/Builder: Unknown

19. No. of Stories: Two [2]

20. Original Floor Plan: Hall Parlor [HP]

21. Single Pile Double Pile N.A.

22. Roof Form & Material: Original
 Gable Not Original

23. Structural Material: Stone [S]

24. Exterior Material: Stone [S]

25. Foundation Material: Stone [S]

26. Major Alterations: Moved/Rebuilt None Other
 Additions

27. Special Features: Feather-tooling Pattern

28. Outbuildings: None [0]

29. Original Function: Residence [01A]

30. Present Use: Residence [01A]

31. Condition: Fair [F]

32. Endangered: Yes
 No

33. Attach Photos:
 Roll: 3 Photo Nos:5-6A No. of Slides: x

34. Prepared by: Carolyn Murray-Wooley

35. Organization: Kentucky Heritage Council

36. Date: October 1983

37. New Survey Resurvey

KENTUCKY HISTORIC RESOURCES
 Individual Inventory Form

Resource # BE-352

38. UTM Point of Primary Building: Zone Easting Northing 39. G.I.S. Mod. []
 Quadrant: Lawrenceburg 16 694580 4329720 40. Coordi.Accuracy []

41. UTM Points of Boundary (for N. R. eligible sites only):

A.	<u>16</u>	<u>694560</u>	<u>4329860</u>	D.	<u>16</u>	<u>694400</u>	<u>4329720</u>
B.	<u>16</u>	<u>694620</u>	<u>4329740</u>	E.	---	---	---
C.	<u>16</u>	<u>694480</u>	<u>4329620</u>	F.	---	---	---

42. Total Acreage in Present Property: _____ 43. Acreage included in proposed N.R. boundary: 13.8 acres
 44. Site Plan (and boundary description and justification for N.R. sites):

See Attached Site Plan

45. Description and House Plan:

Uncommon two-story, five-bay, hall-parlor, dry-stone house with main entrance in second bay. Interior chimneys each end. Voussoirs with feather-tooling pattern but without keystones. Quoins also have feather-tooling. Square stone steps. Solid stone lintels over cellar windows. Pegged frames with square sills, windows same size on first and second floors, 6/6 sash; square windows in attic each side of chimney in southeast end with nosed sills. House has two story, four-bay stone wing on northwest end apparently built at same time as house--there is no break in the southwest wall masonry, where walls of house and wing are flush. Wing ridge centered to include two-story porch; exterior chimney on wing off-centered of ridge, centered in room; one attic window in northwest end beside chimney. Wing walls whitewashed under porch. Porch projects slightly beyond northeast house wall.

Hall parlor plan has three bays in parlor with door in center; two bays in parlor which was the dining room. Enclosed corner stair on partition wall arises from northeast wall in dining room.

The wing of the house is the kitchen and servants quarters. Stair to two upstairs rooms originally arose from porch, now in kitchen. Originally the only access to main house from wing was via porch door in northwest end of main house.

House is located on knoll between Williams Road and branch of Garrison Creek. Spring in hillside southwest of house. Present barns and outbuildings are 20th century. Farm contains 160 acres, prime farmland and woodland. Now Valley Heights Farm.

Changes: Porch posts and trim replaced. Main house gable cornice enlarged. Some wing openings altered, but originals match frames and voussoirs of main house.

KENTUCKY HISTORIC RESOURCE INVENTORY SUPPLEMENT
BOUNDARY AND LOCATION INFORMATION

Historic Property Name Stone house Site # 120-352

Multiple Resource/Thematic Nomination Title _____

U.T.M. Coordinates - List multiple UTMs if property is ten or more acres.

A. 16 694560 4329860 D. 16 694410 4329720

B. 16 694620 4329740 E. _____

C. 16 694480 4329620 F. _____

Verbal Boundary Description _____ Acreage 13.8

Site enclosed by A-B-C-D, as shown. A-B is with the road.
B-C is partially on the property line, C-D is on the creek.
The outbuildings and barns are non-contributing.

Sketch of Site Plan (Showing outbuildings, structures, landscape features and the site boundary as described above.)

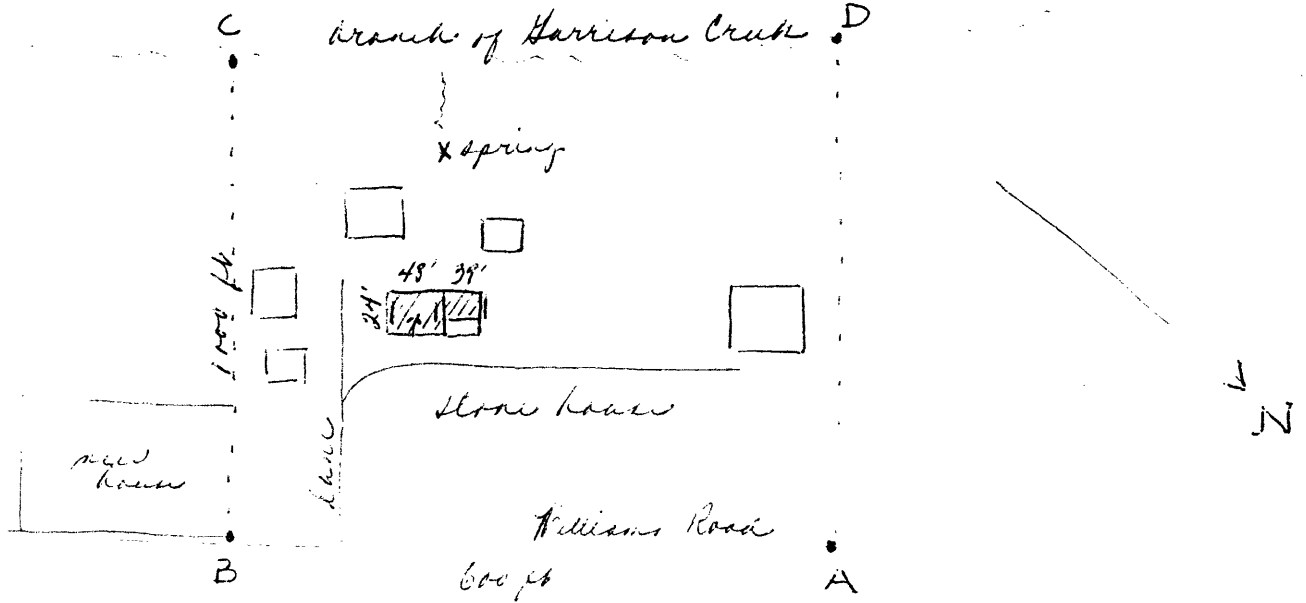

Official Courthouse Property Reference:

Boone County, Ky.

NOV 26 1986

KENTUCKY HISTORIC RESOURCES
Individual Inventory Form

Resource # BE-352
BOONE County

1. Name of Resource: Watts House

2. Original Owner: Unknown

3. Other Names: Valley Heights Farm

4. Prehistoric Site Building Object
Historic Site Structure Other

5. Location: West side Williams Road
Two miles north of Bullittsville

6. Owner's Name: Earl Souther, Sr. [P]

7. Owner's Address: 933 Williams Road
Burlington, Kentucky 41005

8. Evaluation: [G]

9. Recognition & Date:
Nat.Landmark Local Landmark
Nat.Register HABS/HAER
Highway Marker KY Inventory
KY Landmark Certificate

10. N.R.Status & Date:

11. N.R.Group:
District Name: []
Mult.Resource Area: []
Thematic Name: Early Stone Buildings []

12. Historical Theme:
Primary: Architecture [030]
Secondary: Settlement [140]
Other: []

13. Statement of Significance:
This is a very good example of an unusually large settlement period stone house. It is the only one in Kentucky with a five-bay, hall-parlor plan where the entrance is not in the center bay.
[]

14. History:
Watts family, latter 19th century.
Souther family since 1916. History not researched.

15. Source of historical information and/or contact person:
Interview with Owner

16. Date: Original Building late 18th [9]
Addition []

17. Style: Federal [21]
[]

18. Architect/Builder: Unknown

19. No. of Stories: Two [2]

20. Original Floor Plan: Hall Parlor [HP]

21. Single Pile Double Pile N.A.

22. Roof Form & Material: Original
Gable Not Original

23. Structural Material: Stone [S]

24. Exterior Material: Stone [S]

25. Foundation Material: Stone [S]

26. Major Alterations: None
Moved/Rebuilt Other
Additions

27. Special Features: Feather-tooling Pattern

28. Outbuildings: None [0]

29. Original Function: Residence [01A]

30. Present Use: Residence [01A]

31. Condition: Fair [F]

32. Endangered: Yes
No

33. Attach Photos:
Roll: 3 Photo Nos:5-6A No. of Slides: x

34. Prepared by: Carolyn Murray-Wooley

35. Organization: Kentucky Heritage Council

36. Date: October 1983

37. New Survey Resurvey

KENTUCKY HISTORIC RESOURCES
 Individual Inventory Form

Resource # BE-352

38. UTM Point of Primary Building: Zone Easting Northing 39. G.I.S. Mod. []
 Quadrant: Lawrenceburg 16 694580 4329720 40. Coordi.Accuracy []

41. UTM Points of Boundary (for N. R. eligible sites only):

A.	<u>16</u>	<u>694560</u>	<u>4329860</u>	D.	<u>16</u>	<u>694400</u>	<u>4329720</u>
B.	<u>16</u>	<u>694620</u>	<u>4329740</u>	E.	---	---	---
C.	<u>16</u>	<u>694480</u>	<u>4329620</u>	F.	---	---	---

42. Total Acreage in Present Property: 43. Acreage included in proposed N.R. boundary: 13.8 acres

44. Site Plan (and boundary description and justification for N.R. sites):

See Attached Site Plan

45. Description and House Plan:

Uncommon two-story, five-bay, hall-parlor, dry-stone house with main entrance in second bay. Interior chimneys each end. Voussoirs with feather-tooling pattern but without keystones. Quoins also have feather-tooling. Square stone steps. Solid stone lintels over cellar windows. Pegged frames with square sills, windows same size on first and second floors, 6/6 sash; square windows in attic each side of chimney in southeast end with nosed sills. House has two story, four-bay stone wing on northwest end apparently built at same time as house--there is no break in the southwest wall masonry, where walls of house and wing are flush. Wing ridge centered to include two-story porch; exterior chimney on wing off-centered of ridge, centered in room; one attic window in northwest end beside chimney. Wing walls whitewashed under porch. Porch projects slightly beyond northeast house wall.

Hall parlor plan has three bays in parlor with door in center; two bays in parlor which was the dining room. Enclosed corner stair on partition wall arises from northeast wall in dining room.

The wing of the house is the kitchen and servants quarters. Stair to two upstairs rooms originally arose from porch, now in kitchen. Originally the only access to main house from wing was via porch door in northwest end of main house.

House is located on knoll between Williams Road and branch of Garrison Creek. Spring in hillside southwest of house. Present barns and outbuildings are 20th century. Farm contains 160 acres, prime farmland and woodland. Now Valley Heights Farm.

Changes: Porch posts and trim replaced. Main house gable cornice enlarged. Some wing openings altered, but originals match frames and voussoirs of main house.

KENTUCKY HISTORIC RESOURCE INVENTORY SUPPLEMENT
BOUNDARY AND LOCATION INFORMATION

Historic Property Name Stone house Site # 120-352

Multiple Resource/Thematic Nomination Title _____

U.T.M. Coordinates - List multiple UTMs if property is ten or more acres.

A. 16 694560 4329860 D. 16 694410 4329720

B. 16 694620 4329740 E. _____

C. 16 694480 4329620 F. _____

Verbal Boundary Description _____ Acreage 13.8

Site enclosed by A-B-C-D, as shown. A-B is with the road.
B-C is partially on the property line, C-D is on the creek.
The outbuildings and barns are non-contributing.

Sketch of Site Plan (Showing outbuildings, structures, landscape features and the site boundary as described above.)

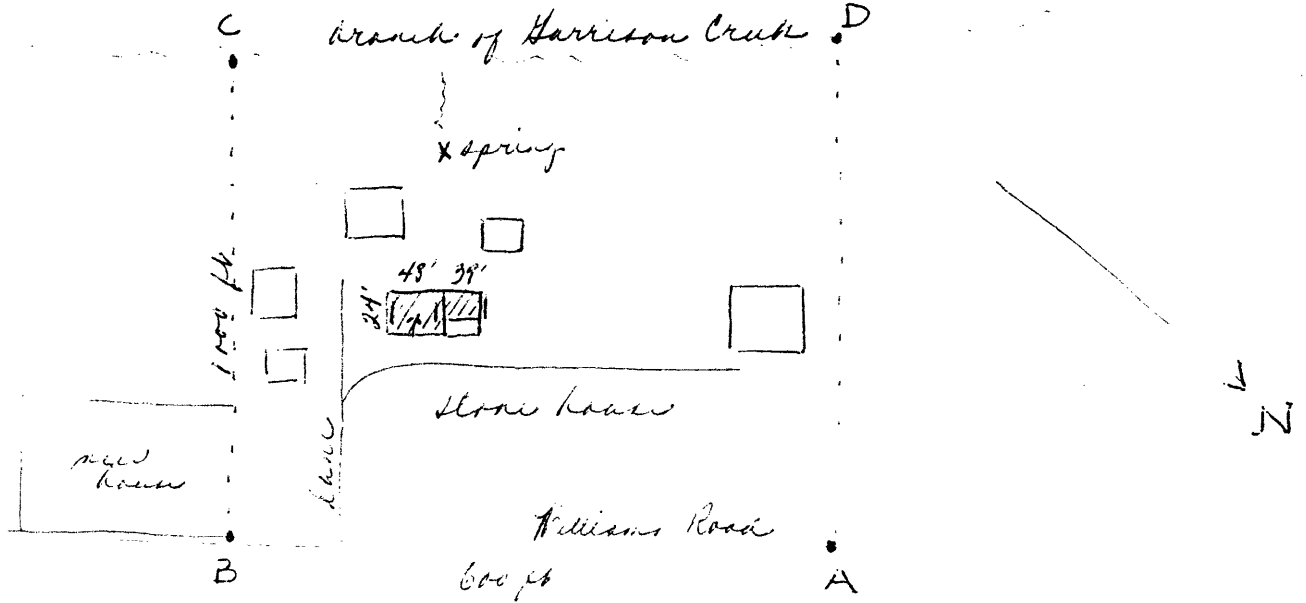

Official Courthouse Property Reference:

Boone County, Ky.