

United States Department of the Interior  
National Park Service

For NPS use only

National Register of Historic Places  
Inventory—Nomination Form

received SEP 19 1986  
date entered

See instructions in *How to Complete National Register Forms*  
Type all entries—complete applicable sections

OCT 16 1986

1. Name

historic Tioga Commissary

and/or common same

2. Location

street & number Tioga Road, adjacent to Missouri-Pacific Railroad N/A not for publication

city, town Tioga N/A vicinity of

state LA code 22 parish Rapides code 079

3. Classification

<b>Category</b>	<b>Ownership</b>	<b>Status</b>	<b>Present Use</b>	
<input type="checkbox"/> district	<input type="checkbox"/> public	<input checked="" type="checkbox"/> occupied	<input type="checkbox"/> agriculture	<input type="checkbox"/> museum
<input checked="" type="checkbox"/> building(s)	<input checked="" type="checkbox"/> private	<input type="checkbox"/> unoccupied	<input checked="" type="checkbox"/> commercial	<input type="checkbox"/> park
<input type="checkbox"/> structure	<input type="checkbox"/> both	<input type="checkbox"/> work in progress	<input type="checkbox"/> educational	<input type="checkbox"/> private residence
<input type="checkbox"/> site	<b>Public Acquisition</b>	<b>Accessible</b>	<input type="checkbox"/> entertainment	<input type="checkbox"/> religious
<input type="checkbox"/> object	<input type="checkbox"/> N/A in process	<input checked="" type="checkbox"/> yes: restricted	<input type="checkbox"/> government	<input type="checkbox"/> scientific
	<input type="checkbox"/> N/A being considered	<input type="checkbox"/> yes: unrestricted	<input type="checkbox"/> industrial	<input type="checkbox"/> transportation
		<input type="checkbox"/> no	<input type="checkbox"/> military	<input type="checkbox"/> other:

4. Owner of Property

name Fred Price (318) 640-9907

street & number P. O., Box 811

city, town Tioga N/A vicinity of state LA 71477

5. Location of Legal Description

courthouse, registry of deeds, etc. Rapides Parish Courthouse

street & number 701 Murray Street P. O., Box 952

city, town Alexandria state LA 71301

6. Representation in Existing Surveys

title LA Historic Sites Survey has this property been determined eligible?  yes  no

date 1985  federal  state  county  local

depository for survey records LA State Historic Preservation Office

city, town Baton Rouge state LA

---

## 7. Description

---

<b>Condition</b>		<b>Check one</b>	<b>Check one</b>	
<input type="checkbox"/> excellent	<input type="checkbox"/> deteriorated	<input type="checkbox"/> unaltered	<input checked="" type="checkbox"/> original site	
<input type="checkbox"/> good	<input type="checkbox"/> ruins	<input checked="" type="checkbox"/> altered	<input type="checkbox"/> moved	date <u>N/A</u>
<input checked="" type="checkbox"/> fair	<input type="checkbox"/> unexposed			

---

### **Describe the present and original (if known) physical appearance**

The Tioga Commissary (c.1900) is a single story, frame, galleried building of no particular architectural style. It is located next to the Missouri-Pacific railroad line in what remains of the old Tioga sawmill community. The building has been little altered since construction.

The structure consists of a single large space with two rows of hypostyle square posts. The interior is plain with flush board sheathing on the walls and ceiling. The floorboards are original as are some of the counters.

The principal elevation features a thirteen bay chamfered post gallery with a beaded board entablature and a forward-facing gable at each end. Under each gable is a standard commercial plate glass shopfront with paneled bulkheads. The facade is ornamented with panels of diagonally set beaded boards.

The only changes in the building since construction have been the installation of fixed awnings over the rear and side windows and burglar bars on all the windows. These alterations, of course, are certainly minor.

# 8. Significance

Period	Areas of Significance—Check and justify below			
<input type="checkbox"/> prehistoric	<input type="checkbox"/> archeology-prehistoric	<input type="checkbox"/> community planning	<input type="checkbox"/> landscape architecture	<input type="checkbox"/> religion
<input type="checkbox"/> 1400–1499	<input type="checkbox"/> archeology-historic	<input type="checkbox"/> conservation	<input type="checkbox"/> law	<input type="checkbox"/> science
<input type="checkbox"/> 1500–1599	<input type="checkbox"/> agriculture	<input type="checkbox"/> economics	<input type="checkbox"/> literature	<input type="checkbox"/> sculpture
<input type="checkbox"/> 1600–1699	<input type="checkbox"/> architecture	<input type="checkbox"/> education	<input type="checkbox"/> military	<input type="checkbox"/> social/ humanitarian
<input type="checkbox"/> 1700–1799	<input type="checkbox"/> art	<input type="checkbox"/> engineering	<input type="checkbox"/> music	<input type="checkbox"/> theater
<input type="checkbox"/> 1800–1899	<input type="checkbox"/> commerce	<input type="checkbox"/> exploration/settlement	<input type="checkbox"/> philosophy	<input type="checkbox"/> transportation
<input checked="" type="checkbox"/> 1900–	<input type="checkbox"/> communications	<input checked="" type="checkbox"/> industry	<input type="checkbox"/> politics/government	<input type="checkbox"/> other (specify)
		<input type="checkbox"/> invention		

**Specific dates** c.1900 **Builder/Architect** Builder; Lee Lumber Company

**Statement of Significance (in one paragraph)** Criterion A

The Tioga Commissary is locally significant in the area of industry because it is an important visual reminder of the early twentieth century lumber boom in Rapides Parish.

Three factors have shaped the economic development of Rapides Parish: agriculture, transportation systems (the Red River and numerous railroads), and the lumber industry. The first two are themes running throughout the parish's history, while the lumber industry's "golden years" were the first three decades of this century. The first large mill, the J. A. Bentley Lumber Company, was established in 1891 in Zimmerman by J. A. Bentley and E. W. Zimmerman. Before very long the ensuing lumber boom had changed the face of Rapides Parish, with twelve or so sawmill towns dotting the landscape, towns such as Ball, Tioga, McNary, Woodworth and Longleaf. Of course, crucial to this boom was the railroad. Tioga, for example, had three lines passing through it, as well as being the western terminus for a branch line.

Lee Lumber Company operated out of Tioga from 1900 until 1925, when the timber resources were depleted and the mill was closed. Although the extent of historic structures in Tioga during the 1900-1925 era is not documented, it is certain that the community was never a large company town like Elizabeth, Fisher or Bogalusa. For example, Elizabeth had a population of about 3,000 during its boom years and boasted numerous company built and owned buildings in addition to housing (schools, churches, hotels, a mercantile store, a hospital, etc.). Tioga, to put things in perspective, had only a population of about 400, and probably never had much more than housing, the commissary, and the mill.

The recently completed historic structures survey for Rapides Parish reveals that little remains to directly represent the sawmill era. Extant resources include a sawmill at Longleaf, the commissary at Tioga, a superintendent's house at McNary, an owner's house and a small abandoned post office at Longleaf, and a few cottages scattered here and there. Of these, the sawmill and commissary are the lumber industry's most exemplary resources because, unlike a worker's cottage where an individual family might have lived, they were centers of company activities, embracing all or most of the people involved in the lumbering operation. Indeed, commissaries were often social focal points where workers gathered, were paid and received their provisions.

# 9. Major Bibliographical References

SEE CONTINUATION SHEET

# 10. Geographical Data

Acreeage of nominated property @ 1/2 acre

Quadrangle name Ball, LA

Quadrangle scale 1:24000

### UTM References

A 15 554320 3472000  
Zone Easting Northing

B [ ][ ] [ ][ ][ ][ ] [ ][ ][ ][ ][ ]  
Zone Easting Northing

C [ ][ ] [ ][ ][ ][ ][ ] [ ][ ][ ][ ][ ][ ]

D [ ][ ] [ ][ ][ ][ ][ ] [ ][ ][ ][ ][ ][ ]

E [ ][ ] [ ][ ][ ][ ][ ] [ ][ ][ ][ ][ ][ ]

F [ ][ ] [ ][ ][ ][ ][ ] [ ][ ][ ][ ][ ][ ]

G [ ][ ] [ ][ ][ ][ ][ ] [ ][ ][ ][ ][ ][ ]

H [ ][ ] [ ][ ][ ][ ][ ] [ ][ ][ ][ ][ ][ ]

### Verbal boundary description and justification

Please refer to enclosed sketch map. All of the land under single ownership could not be included because the 4.8 acres contains numerous non-related structures. So boundaries were chosen to isolate the significant nominated resource.

### List all states and counties for properties overlapping state or county boundaries

state	N/A	code	county	code
state		code	county	code

# 11. Form Prepared By

name/title National Register Staff ASSISTED BY OWNER  
Division of Historic Preservation

organization State of Louisiana date August 1986

street & number P. O. Box 44247 telephone (504) 922-0358

city or town Baton Rouge state LA 70804

# 12. State Historic Preservation Officer Certification

The evaluated significance of this property within the state is:

\_\_\_ national \_\_\_ state  local

As the designated State Historic Preservation Officer for the National Historic Preservation Act of 1966 (Public Law 89-665), I hereby nominate this property for inclusion in the National Register and certify that it has been evaluated according to the criteria and procedures set forth by the National Park Service.

State Historic Preservation Officer signature *Robert B. DeBlieux*  
Robert B. DeBlieux

title State Historic Preservation Officer date September 12, 1986

### For NPS use only

I hereby certify that this property is included in the National Register

*Jane Allores Byer* Entered in the date 10-16-86  
Keeper of the National Register National Register

Attest: \_\_\_\_\_ date \_\_\_\_\_  
Chief of Registration

**United States Department of the Interior  
National Park Service**

**National Register of Historic Places  
Inventory—Nomination Form**

For NPS use only  
received  
date entered

Continuation sheet Tioga Commissary

Item number

9

Page

1

Rapides Parish, LA

9. Bibliographical References

Abandoned Mills Report: Parts of Central Louisiana. Prepared by Kisatchie National Forest, October 23, 1935. (Supplied by lumber historian Anna Burns)

Alexandria Daily Town Talk Centennial Edition, 1983, Vol. 3.

Alexandria Daily Town Talk Sesquicentennial Edition, 1807-1957.

Caldwell, John Michael. "The Forest of the Vintage: A Geography of Industrial Lumbering in North Central Louisiana, 1890-1920." M. A. thesis, University of Oklahoma, 1975.

Comprehensive Historic Structures Survey, Rapides Parish. Louisiana State Historic Preservation Office.

Kerr, Ed. "The History of Forestry in Louisiana." Forests & People, 1963.

Register of Sawmill Equipment for 1912. Compiled by American Lumberman, Chicago, 1912. (Supplied by lumber industry historian Anna Burns)

# TIOGA COMMISSARY RAPIDES PARISH, LA.

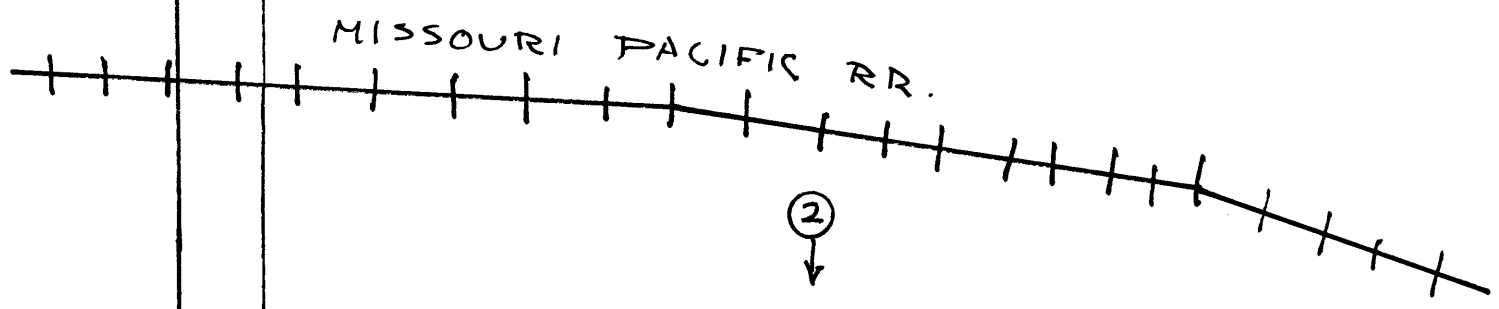
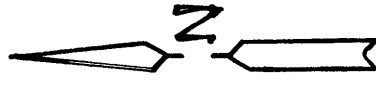

MISSOURI PACIFIC RR.

② ↓

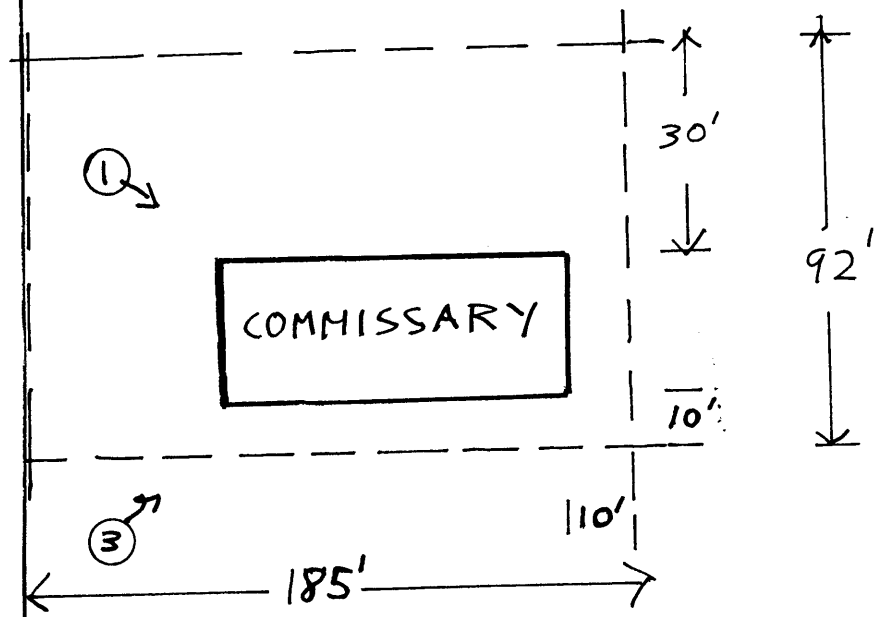

① ↓

COMMISSARY

30'

92'

10'

110'

185'

TIOGA RD.

NORTH BOUNDARY FOLLOWS TIOGA RD.  
SOUTH, EAST, & WEST BOUNDARIES  
PARALLEL BUILDING ELEVATIONS  
AT DISTANCES SHOWN

— — — —  
BOUNDARY

APPROX. 1/2 ACRE

(NOT TO SCALE)