

Davenport  
Department of Community Development  
Iowa Office of Historic Preservation  
Dennett, Muessig & Associates, Ltd.

# DAVENPORT SURVEY 1982

SITE #82-10-10-E1404                      MAP NUMBER 5  
HISTORIC DISTRICT  
NAME Theodore Eldridge House  
ADDRESS 1404 East 10th St.



LEGAL DESCRIPTION Fulton's Add., Block 11, Lots  
7 & 8

ACREAGE ap.1    ZONE R-6M    UTM 15/704020    4600300  
OWNER Eugene & Linda K. Dwyer                      TITLE H  
1404 E. 10th St.  
Davenport IA 52803

## DESCRIPTION

ARCHITECTURAL STYLE	Italianate/Villa	DATE	c.1878
FORM	2 stories, hipped roof, 3-bay front w/entry to left at base of rectangular, 3-stage tower; polygonal window bay east side		
MATERIALS	brick on coursed stone foundation; brick chimney; wood trim		
FENESTRATION	new aluminum sash, set below segmental arched heads		
FEATURES	double-door entry w/chamfered top corners; bracketted modillion cornice, with molding strip defining frieze; dormered tower roof; pedimented porch w/sunburst and latticework superimposed over entrance; main veranda w/thin columns; bowed front wall		
ALTERATIONS	porches appear to date from later in the 19th century		
SITE	set well back from street on shaded lot		

**ARCHITECTURAL SIGNIFICANCE** The Eldridge house is a distinguished local example of the Victorian Italianate style. It is one of a handful of residences built here in the early-mid 1870's that were clearly inspired by the Villa style. Basically, these houses combined the rectangular, hipped-roof form of the Italianate with the Villa-style tower, and also featured, though not always, the latter's asymmetry of form. The bowed front wall of the Eldridge house is a most unusual feature, and may indicate that this house was a work of local architect Willett Carroll, to whom the only other example of this feature (in the Price-Vollmer house on Brady Street) is attributed. In fact, if the south wing of the Price-Vollmer house were removed, it would bear a remarkable resemblance to the Eldridge house.

If Carroll were indeed the architect of the Eldridge house, its significance is further enhanced, as few works by this important 19th century architect have been recorded in the city.

**HISTORICAL DATA**

Theodore Eldridge (cousin of early Davenport settler and real estate speculator, D.C. Eldridge) was in residence at this address by 1878. Eldridge operated a restaurant and confectionery (ice cream) known as "Eldridge Bros." in downtown Davenport. Eldridge lived above his business before moving to E. 10th Street.

**HISTORICAL SIGNIFICANCE**

**SOURCES** John Milner Associates, East Davenport Survey, 1977  
Davenport City Directories, 1873, 1878, 1881, 1891  
Oszuscik, Philippe. A History of the Architecture and Urbanization of Nineteenth Century Davenport, Iowa. Ph.D., University of Iowa, 1979.

**ARCHITECTURAL EVALUATION**

DESIGN excellent STATURE focus  
LEVEL OF SIGNIFICANCE local

CONTEXT good FABRIC good/exc  
DISTRICT CLASSIFICATION

**HISTORICAL EVALUATION**

PRIMARY THEME  
LEVEL OF SIGNIFICANCE

SECONDARY THEME

NATIONAL REGISTER ELIGIBLE YES

PHOTO ID M17-23; 1764-13

Martha H. Bowers, Architectural Historian

Marlys Svendsen, Historian

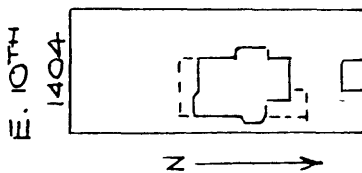

FOR DIVISION OF HISTORIC PRESERVATION USE ONLY

1 DATE RECEIVED \_\_\_\_\_

2 DATE OF STAFF EVALUATION \_\_\_\_\_

	A ARCHITECTURAL	B HISTORICAL
ELIGIBLE FOR NRHP	<input type="checkbox"/>	<input type="checkbox"/>
NOT ELIGIBLE FOR NRHP	<input type="checkbox"/>	<input type="checkbox"/>

3 NRHP ACTION

A STATE REVIEW COMM	APP <input type="checkbox"/>	DISAPP <input type="checkbox"/>	TABLED <input type="checkbox"/>	DATE _____
B FEDERAL REVIEW	APP <input type="checkbox"/>	DISAPP <input type="checkbox"/>	TABLED <input type="checkbox"/>	DATE _____

4 DHP SOURCES

<input type="checkbox"/> COUNTY RESOURCES	<input type="checkbox"/> R B C _____
<input type="checkbox"/> WSHIELD SURVEY	<input checked="" type="checkbox"/> DAVENPORT A/H SURVEY
<input type="checkbox"/> NRHP	<input type="checkbox"/> _____
<input type="checkbox"/> GRANT _____	<input type="checkbox"/> _____

5 SUBJECT TRACES \_\_\_\_\_

6 PHOTO \_\_\_\_\_