

FORM A. - AREA SURVEY

MASSACHUSETTS HISTORICAL COMMISSION  
Office of the Secretary, State House, Boston

Form numbers in this area	Area no.
East Cambridge	EC I.2.

2. Photo (3x3" or 3x5")  
Staple to left side of form  
Photo number 1101-20A,  
1101-21A  
1101-22A  
1101-27A

1. Town Cambridge  
Name of area (if any) Winter Street  
National Register District
3. General date or period 1830s - 1850s
4. Is area uniform (explain):  
in style? yes - primarily late Georgian  
in condition? yes - most are in good condition.  
in type of ownership? yes - private (owned individually)  
in use? yes - residential

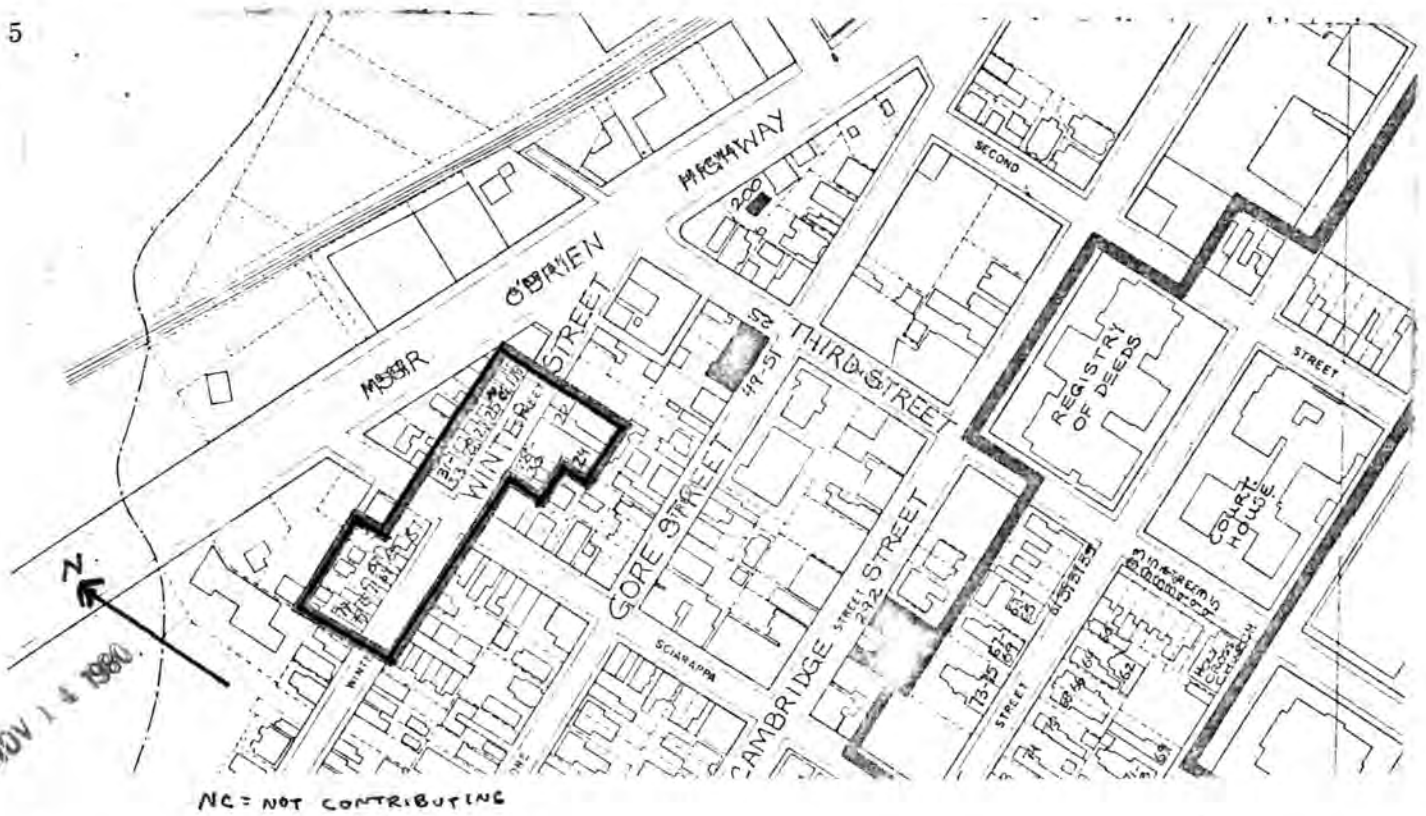

DO NOT WRITE IN THIS SPACE  
USGS Quadrant \_\_\_\_\_  
MHC Photo no. \_\_\_\_\_

1.119 Acres

(over)

6. Recorded by Harriet White/Bainbridge  
Bunting  
Organization Cambridge Historical Comm.  
Date 1964/1980  
UTM-BOSTON SOUTH  
19/328600/4693060

**7. Historical data. Explain the historical/architectural importance of this area.**

Winter Street was laid out by the Lechmere Point Corporation in 1811 as part of its plan for developing East Cambridge. Located between two major thoroughfares, Bridge and Cambridge Streets, Winter Street became a desirable location for workers' housing after industries began to settle along Bridge Street to take advantage of the transportation afforded by Craigie's Bridge and the Millers River. During the 1830s and 40s, a variety of workers' cottages were built on Winter Street to house employees of the area's thriving industries, particularly Bay State Glass Company and New England Glass Company. Of the 41 persons listed on Winter Street in the 1849 Cambridge Directory, more than a third were employed in the glass factories; the rest were carpenters, bakers, and machinists. Residents ranged from day laborers and glass workers to the superintendent of the New England Glass Company.

Winter Street provides an excellent example of a neighborhood of Late Georgian workers' cottages, the most characteristic form of modest single family housing in East Cambridge in the first half of the 19th century. Of the 16 houses included in the district, 14 were built before 1854. The standard house type is a narrow center hall frame cottage with simple Late Georgian cornice. Set close together with steep gable ends facing the street, these cottages opened onto narrow side yards and created a distinctive 19th century streetscape. Winter Street retains both this streetscape and a full range of workers' cottages from the smallest one-and-a-half story examples to a variety of double houses. It is the best surviving grouping of this characteristic house type in East Cambridge.

SIGNIFICANT BUILDINGS:

Thomas Leighton House (1833-34), 22 Winter Street:

This two-and-a-half story Late Georgian workers' cottage is an important example of the early 19th century housing built in East Cambridge for skilled glass workers. Somewhat larger than most, the narrow house sits directly on the sidewalk with its steep gable end facing the street and a center entrance facing a characteristically narrow side yard. The house was built for Thomas H. Leighton, a master English glass worker who was brought to East Cambridge in 1826

8. Bibliography and/or references such as local histories, deeds, assessor's records, early maps, etc.

INVENTORY FORM CONTINUATION SHEET

MASSACHUSETTS HISTORICAL COMMISSION  
Office of the Secretary, Boston

Page 2

Community: East Cambridge	Form No: ECI.2
Property Name: Winter St. N.R.D.	

Indicate each item on inventory form which is being continued below.

Thomas Leighton House - cont'd:

to be superintendent of the New England Glass Company. Leighton was one of many skilled artisans recruited by New England Glass in England and Scotland, and much of the company's early success is attributable to his expert management. The Leighton family remained deeply involved in East Cambridge and the New England Glass company throughout most of the 19th century. After Thomas' death in 1849, his son John succeeded him as superintendent of the company, while four other sons and several grandsons also became expert glassblowers and engravers with New England Glass. The house remained in the Leighton family until 1890.

74 Winter Street (1838):

This two-and-a-half story workers' cottage is the best preserved example of the house type occupied by skilled artisans at the New England Glass Company in the first half of the 19th century. Characteristic Late Georgian eaves and cornice of the house contrast with the bracketed entrance hood added in the 1870s. The house was one of four on Winter Street built for Atherton Haugh Stevens, an East Cambridge grocer who served as town selectman from 1828-31. Stevens was a direct descendant of Atherton Haugh who moved into East Cambridge in 1635 and amassed an estate of nearly 300 acres covering most of the upland of East Cambridge. The house was recorded by HABS in 1964.

77-79 Winter Street (1838):

This typical two-and-a-half story center entrance workers' cottage was built for Atherton Stevens in 1838 and sold the next year to another prominent East Cambridge grocer, Horatio Hovey.

67, 71 Winter Street (1843-44):

The smallest of four houses on Winter Street built for Atherton Stevens, these modest Late Georgian one-and-a-half story frame cottages were first rented and then sold to a series of East Cambridge artisans.

24 Winter Street (pre-1854):

Built before 1854, this two-and-a-half story workers' cottage was moved to its present location at the rear of the lot by 1873. Like 22 Winter Street, this house follows the characteristic East Cambridge form with a symmetrical center entrance, five bay facade facing the side yard and tall chimneys along the rear slope of the roof.

21,25,27,29 Winter Street (pre-1854):

This row of four one-and-a-half story frame workers' cottages with five bay facades and steep gable roofs provides an excellent example of the simplest and most characteristic form of single family housing built in East Cambridge during the first half of the 19th century.

Staple to Inventory form at bottom

INVENTORY FORM CONTINUATION SHEET

MASSACHUSETTS HISTORICAL COMMISSION  
Office of the Secretary, Boston

Community:

East Cambridge

Form No:

HC I.2

Property Name: Winter St. N.R.D.

Page 3

Indicate each item on inventory form which is being continued below.

28-30 Winter Street (pre-1854):

Built before 1854, this wide one-and-a-half story frame house is actually composed of two standard two-room center hall plan workers' cottages set back to back with party wall chimneys along the ridge of the wide gable.

31-33 Winter Street (pre-1854):

An unusual double house built before 1854, 31-33 Winter Street has paired entrances facing the street rather than a side yard. This variation in siting was followed in other corner houses in the Winter Street area. In the 1870s elaborate bracketed hoods were added over the deeply recessed entrances, and 33 Winter Street was enlarged to three stories.

61 Winter Street (pre-1854):

Although it follows the basic East Cambridge workers' cottage plan with two rooms and a center entrance, 61 Winter Street appears considerably larger than its neighbors because its corner location allows the main facade of the house to face the street. The heavier cornice and broad entrance further emphasize the larger scale of the house.

65 Winter Street (pre-1854):

This one-and-a-half story workers' cottage has a handsome entrance hood with spindle frieze and brackets added circa 1880.

19 Winter Street (c. 1850s):

A one-and-a-half story workers' cottage built in the late 1850s, 19 Winter Street shows the persistence of this single family house form in East Cambridge.

34-42 Winter Street (c. 1870s):

This three-story bracketed tenement block built in the 1870s reflects the need for increased workers housing in this neighborhood in the second half of the 19th century.

The Winter Street National Register District includes portions of Winter Street between Third and Fifth Streets (see Cambridge Community Development P. D. Quad Map 1A). Its boundaries were determined by the density of workers' cottages extant.

-END-

Staple to Inventory form at bottom

United States Department of the Interior  
National Park Service

National Register of Historic Places  
Inventory—Nomination Form

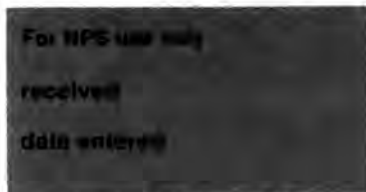

Continuation sheet

Item number

Page 1 of 17

Multiple Resource Area  
Thematic Group

dnr-11

Name Cambridge Multiple Resource Area  
State MA

Nomination/Type of Review

Date/Signature

- |  |          |                                  |
|--|----------|----------------------------------|
| ✓ 1. East Cambridge Historic District<br>Substantive Review        | ✓ Keeper | <u>William H. Brahan 6-30-83</u> |
|  | Attest   | _____                            |
| ✓ 2. Winter Street Historic District<br>Substantive Review         | ✓ Keeper | <u>William H. Brahan 4-13-82</u> |
|  | Attest   | _____                            |
| ✓ 3. Upper Magazine Street Historic District<br>Substantive Review | ✓ Keeper | <u>William H. Brahan 4-13-82</u> |
|  | Attest   | _____                            |
| ✓ 4. Hastings Square Historic District<br>Substantive Review       | ✓ Keeper | <u>William H. Brahan 4-13-82</u> |
|  | Attest   | _____                            |
| ✓ 5. Salem-Auburn Streets Historic District<br>Substantive Review  | ✓ Keeper | <u>William H. Brahan 4-13-82</u> |
|  | Attest   | _____                            |
| ✓ 6. Inman Square Historic District<br>Substantive Review          | ✓ Keeper | <u>William H. Brahan 4-13-82</u> |
|  | Attest   | _____                            |
| ✓ 7. Old Cambridgeport Historic District<br>Substantive Review     | ✓ Keeper | <u>William H. Brahan 6-30-83</u> |
|  | Attest   | _____                            |
| ✓ 8. Norfolk Street Historic District<br>Substantive Review        | ✓ Keeper | <u>William H. Brahan 4-13-82</u> |
|  | Attest   | _____                            |
| ✓ 9. Cambridge Gateway Historic District<br>Substantive Review     | ✓ Keeper | <u>William H. Brahan 4-13-82</u> |
|  | Attest   | _____                            |
| ✓ 10. Bigelow Street Historic District<br>Substantive Review       | ✓ Keeper | <u>William H. Brahan 4-13-82</u> |
|  | Attest   | _____                            |

**DOE/OWNER OBJECTION**

NATIONAL REGISTER OF HISTORIC PLACES

United States Department of the Interior  
National Park Service

EVALUATION / RETURN SHEET

Property: Winter Street Historic District  
(Cambridge Multiple Resource Area)  
State, County: MA - Middlesex  
Federal Agency: \_\_\_\_\_

Working No. 11-14-80-2862  
Fed. Reg. Date: \_\_\_\_\_  
Date Due: 4/17/82  
Action:  ACCEPT 4/13/82  
 RETURN \_\_\_\_\_  
 REJECT \_\_\_\_\_

- resubmission
- nomination by person or local government
- owner objection
- appeal

photos 4  
maps \_\_\_\_\_

Substantive Review:  sample  request  appeal  NR decision

Reviewer's comments:

*Concentration of Hall Georgian workers' housing*

Recom./Criteria C  
Reviewer Braham  
Discipline Arch/His  
Date 4.5.82  
 see continuation sheet

Nomination returned for:  technical corrections cited below  
 substantive reasons discussed below

1. Name

2. Location

3. Classification

Category	Ownership	Status	Present Use
	Public Acquisition	Accessible	

4. Owner of Property

5. Location of Legal Description

6. Representation in Existing Surveys

Has this property been determined eligible?  yes  no

7. Description

Condition		Check one	Check one
<input type="checkbox"/> excellent	<input type="checkbox"/> deteriorated	<input type="checkbox"/> unaltered	<input type="checkbox"/> original site
<input type="checkbox"/> good	<input type="checkbox"/> ruins	<input type="checkbox"/> altered	<input type="checkbox"/> moved date _____
<input type="checkbox"/> fair	<input type="checkbox"/> unexposed		

Describe the present and original (if known) physical appearance

- summary paragraph
- completeness
- clarity
- alterations/integrity
- dates
- boundary selection

---

## 8. Significance

Period \_\_\_\_\_ Areas of Significance—Check and justify below

Specific dates \_\_\_\_\_ Builder/Architect \_\_\_\_\_

Statement of Significance (in one paragraph)

- \_\_\_\_\_ summary paragraph
- \_\_\_\_\_ completeness
- \_\_\_\_\_ clarity
- \_\_\_\_\_ applicable criteria
- \_\_\_\_\_ justification of areas checked
- \_\_\_\_\_ relating significance to the resource
- \_\_\_\_\_ context
- \_\_\_\_\_ relationship of integrity to significance
- \_\_\_\_\_ justification of exception
- \_\_\_\_\_ other

---

## 9. Major Bibliographical References

---

## 10. Geographical Data

Acres of nominated property \_\_\_\_\_

Quadrangle name \_\_\_\_\_

USGS Reference \_\_\_\_\_

Verbal boundary description and justification \_\_\_\_\_

---

## 11. Form Prepared By

---

## 12. State Historic Preservation Officer Certification

The evaluated significance of this property within the state is:

\_\_\_\_\_ national \_\_\_\_\_ state \_\_\_\_\_ local

State Historic Preservation Officer signature \_\_\_\_\_

Title \_\_\_\_\_ Date \_\_\_\_\_

---

## 13. Other

- \_\_\_\_\_ Maps
- \_\_\_\_\_ Photographs
- \_\_\_\_\_ Other

Questions concerning this nomination may be directed to \_\_\_\_\_

Signed \_\_\_\_\_ Date \_\_\_\_\_ Phone: 202 272-3504

Comments for any item may be continued on an attached sheet



1101-21A

NOV 14 1980

0720

Cambridge NRA, Ma

Winter St. H.D.

79-65 Winter St.

1101-21A



1101-27A

NOV 14 1980

0790

Cambridge MRA, Ma  
Winter St. H.P.

22 Winter St.

1101-27A



1101-20A

NOV 14 1980

0720

Cambridge MRA, Ma

Winter St H.D.

WINTER ST.

75 Winter St.

1101-20A



1101-22A

NOV 14 1980

079C

Cambridge NRA, Ma  
Winter St. H.D.

65 Winter St.

1101-22A

Please refer to the map in the  
Multiple Property Cover Sheet  
for this property

Multiple Property Cover Sheet Reference Number: 64000275