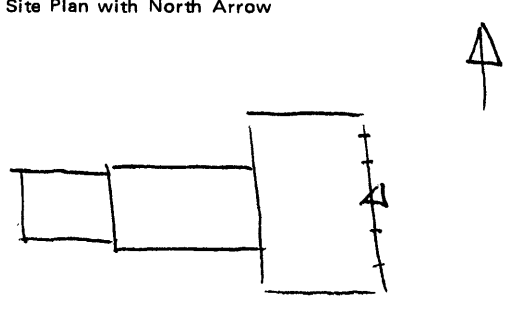

1. Historic Name (s) <u>A. M. Young House</u> Original Owner Present Name		22. ADD/County <u>Bluegrass/Jessamine</u>							
3. Owner's Name <u>Mrs. H. E. Coons</u>		23. Zoning Classification <u>Magisterial District</u>							
4. Owner's Address <u>Tates Creek Pike, Lexington, KY 40503</u>		24. U.S.G. S. Quadrant (15'/75') <u>Coletown</u>							
5. Location <u>1/2 m. W. of Ash Grove Pike; 1/4 m. W. of Tates Creek Road</u>		25. UTM Reference <table style="width:100%; border-collapse: collapse;"> <tr> <td style="border: 1px solid black; padding: 2px;"><u>116</u></td> <td style="border: 1px solid black; padding: 2px;"><u>720160</u></td> <td style="border: 1px solid black; padding: 2px;"><u>4201980</u></td> </tr> <tr> <td style="font-size: 8px; text-align: center;">Zone</td> <td style="font-size: 8px; text-align: center;">Easting</td> <td style="font-size: 8px; text-align: center;">Northing</td> </tr> </table>		<u>116</u>	<u>720160</u>	<u>4201980</u>	Zone	Easting	Northing
<u>116</u>	<u>720160</u>	<u>4201980</u>							
Zone	Easting	Northing							
6. Open to Public Yes <input type="checkbox"/> No <input checked="" type="checkbox"/>	7. Visible from road Yes <input type="checkbox"/> No <input checked="" type="checkbox"/>	26. Prehistoric Site Historic Site <input checked="" type="checkbox"/> Building							
8. Ownership Private <input checked="" type="checkbox"/> Local <input type="checkbox"/> State <input type="checkbox"/> Federal <input type="checkbox"/>		27. District Name: Yes <input type="checkbox"/> No <input checked="" type="checkbox"/>							
9. Local Contact/Organization		28. Significance Evaluation <u>National Register</u>							
10. Site Plan with North Arrow  <p style="text-align: center;">See Attached Sheet</p>		29. Status National Landmark <input type="checkbox"/> National Register <input type="checkbox"/> Landmark Certificate <input type="checkbox"/> Kentucky Survey <input type="checkbox"/> Local Landmark <input type="checkbox"/> HABS/HAER <input type="checkbox"/>							
		11. Architect							
		12. Builder							
		13. Date <u>1st 1/4 19th c.</u>							
		14. Style <u>Federal</u>							
		15. Original Use <u>house</u>							
		16. Present Use <u>house</u>							
17. Condition Interior <input type="checkbox"/> Exterior <u>good</u>		30. Theme Primary <u>architecture</u> Secondary _____ Other _____							
18. Description <u>1 1/2 story, 5-bay brick; Flemish bond; dentils on box cornice; segmental-arched basement openings with flat jack arches; 2-course, jack arches; closers at windows as well as corners; fine brickwork; sidelights and transom at main door (e); central passage plan; original ell</u> <u>for similar simple Federal houses, see JS 12,45,66,99</u>		31. Endangered Yes <input type="checkbox"/> No <input checked="" type="checkbox"/>							
19. History <u>Andrew Muldrow Young was a local architecture-builder in the mid-19th century</u> <u>atlas 1877 - A.M. Young</u>		32. <p style="text-align: center;">ATTACH PHOTO</p>							
20. Significance <u>Architecture: owned by an important local architect-builder, this house is a good example of a popular house type in the Federal period in Jessamine County, the one-story central passage house.</u>		Roll No. <u>45</u> Picture No. _____ Direction _____							
21. Source of Information		33. Tape No. _____ Negative No. _____							
22. Source of Information		34. Prepared by: <u>NCP-KTG</u>							
23. Source of Information		35. Organization <u>KHC</u>							
24. Source of Information		36. Date <u>Summer 1977</u>							
25. Source of Information		37. Revision Dates _____ 38. Staff Review _____							

114/1

Young, A. M., House (Jessamine County M.R.A) (JS-7)

18. Description

Very well built and unaltered Federal house of the kind popular in Jessamine County--one story, central passage. Owned by an important local architect-builder.

One-story, five-bay, central passage Flemish bond brick house. Interior end chimneys, flat arches of gauged brick, pencilled joints. Has pegged window frames, nosed sills 9/6 sash; late Federal entrance with sidelights and flat topped transom, reeded trim and corner blocks. All joists are whole logs in main block and rear ell. Exterior cellar entrance on south end (rebuilt with block).

Rear ell (once separate, now connected by later shed roofed hyphen on old brick foundation) is two story, has original gambrel roof (uncommon) and pegged window and has a one-story room at the rear.

Interior of house has original mantels, presses and chair rail.

Changes are:

"Craftsman" style front porch replaces original gable roofed porch which spanned slightly projecting center bay.

Probably open rear porch converted to rooms and frame bathroom added behind it beside the ell.

Cornice replaced
New metal shutters
New roofing

Frame smokehouse is behind house.

North of house and included in boundary is a two-pen center passage log barn. Shed roofed additions span each long side and west end. The pens are 18' square, the passage 24'. Had wooden shingle roof, new metal.

KENTUCKY HISTORIC RESOURCE INVENTORY SUPPLEMENT
BOUNDARY AND LOCATION INFORMATION

Historic Property Name Andrew Muldrow Young house Site # JD-7
Multiple Resource/Thematic Nomination Title Jesseamine Co.

U.T.M. Coordinates - List multiple UTMs if property is ten or more acres.

A. 16 720490 4201930 D. 16 719980 4202080
B. 16 720340 4201430 E. 16 720250 4202140
C. 16 720000 4201770 F. _____

Verbal Boundary Description _____ Acreage 67 acres

Site enclosed by A.B.C.D.E as shown, contains the brick house, smoke house and log barn.

Sketch of Site Plan (Showing outbuildings, structures, landscape features and the site boundary as described above.)

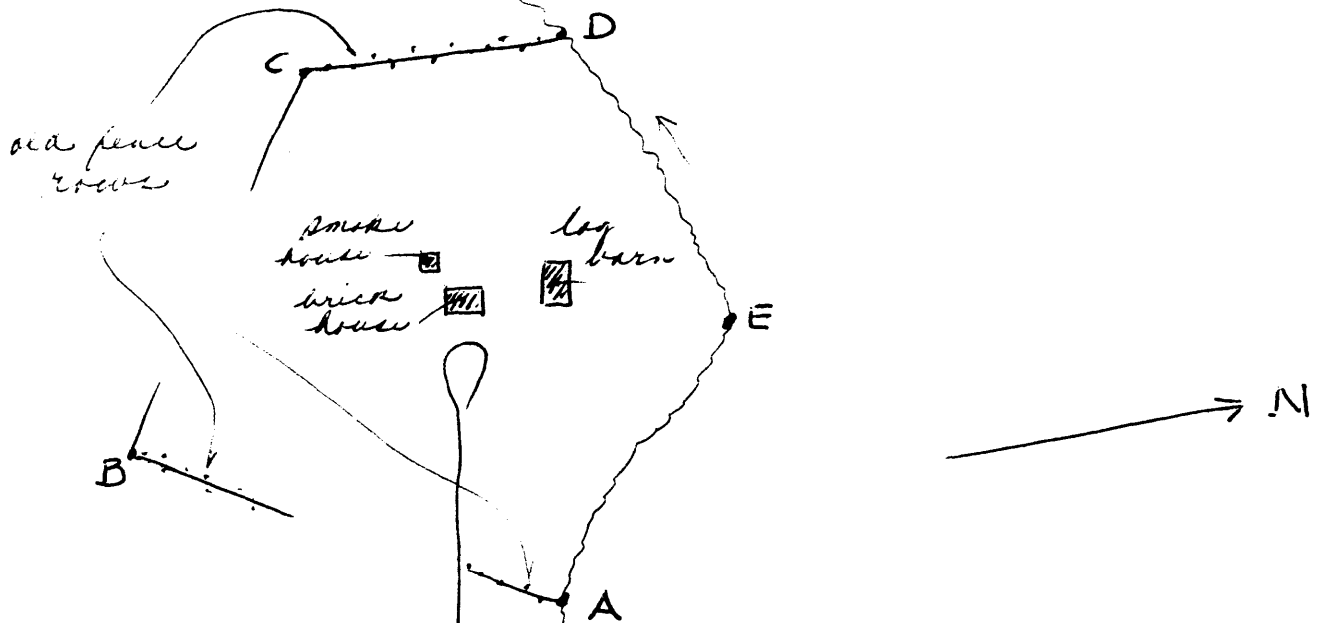

Official Courthouse Property Reference:

Ky 1980

61464