

**United States Department of the Interior
National Park Service**

For NPS use only

**National Register of Historic Places
Inventory—Nomination Form**

received OCT 20 1986

date entered

See instructions in *How to Complete National Register Forms*
Type all entries—complete applicable sections

1. Name

historic Davis-Rozelle Residence

and/or common Mountview (Preferred)

2. Location

street & number 913 Franklin Road N/A not for publication

city, town Brentwood N/A vicinity of

state Tennessee code 047 county Williamson code 187

3. Classification

Category	Ownership	Status	Present Use
<input type="checkbox"/> district	<input type="checkbox"/> public	<input checked="" type="checkbox"/> occupied	<input type="checkbox"/> agriculture
<input checked="" type="checkbox"/> building(s)	<input checked="" type="checkbox"/> private	<input type="checkbox"/> unoccupied	<input type="checkbox"/> commercial
<input type="checkbox"/> structure	<input type="checkbox"/> both	<input type="checkbox"/> work in progress	<input type="checkbox"/> educational
<input type="checkbox"/> site	Public Acquisition	Accessible	<input type="checkbox"/> entertainment
<input type="checkbox"/> object	<input type="checkbox"/> in process	<input checked="" type="checkbox"/> yes: restricted	<input type="checkbox"/> government
	<u>N/A</u> being considered	<input type="checkbox"/> yes: unrestricted	<input type="checkbox"/> industrial
		<input type="checkbox"/> no	<input type="checkbox"/> military
			<input type="checkbox"/> museum
			<input type="checkbox"/> park
			<input checked="" type="checkbox"/> private residence
			<input type="checkbox"/> religious
			<input type="checkbox"/> scientific
			<input type="checkbox"/> transportation
			<input type="checkbox"/> other:

4. Owner of Property

name Charles Ray Bell

street & number 913 Franklin Road

city, town Brentwood N/A vicinity of state Tennessee 37027

5. Location of Legal Description

courthouse, registry of deeds, etc. Williamson County Courthouse

street & number Courthouse

city, town Franklin state Tennessee

6. Representation in Existing Surveys

title Williamson County Survey See continuation sheet
TDOT Survey Files has this property been determined eligible? yes no

date 1982 federal state county local
1982

depository for survey records Tennessee Historical Commission, 701 Broadway
Tennessee Department of Transportation, 505 Deaderick Street

city, town Nashville Tennessee 37219
Nashville state Tennessee 37203

7. Description

Condition		Check one	Check one
<input type="checkbox"/> excellent	<input type="checkbox"/> deteriorated	<input type="checkbox"/> unaltered	<input checked="" type="checkbox"/> original site
<input checked="" type="checkbox"/> good	<input type="checkbox"/> ruins	<input checked="" type="checkbox"/> altered	<input type="checkbox"/> moved date _____
<input type="checkbox"/> fair	<input type="checkbox"/> unexposed		

Describe the present and original (if known) physical appearance

Mountview, a transitional Greek Revival/Italianate residence, is located on a flat semi-wooded lot in Brentwood, Tennessee in northern Williamson County. The two story, ell-shaped, brick house was built in 1860. The house, which faces Franklin Road (Highway 31) on the east, has woodland and pasture to the south and a modern subdivision on the north and west. A wooden board fence delineates the property's boundaries. Limestone block piers flank the driveway entrance, and the south pier contains a stone tablet inscribed, "Mountview."

The three bay front (east) facade of the house is dominated by a monumental center portico. The two story portico is composed of four square, paneled columns with Corinthian-like capitals, a paneled parapet with a centered, shallow, triangular pediment, and paired brackets. A lattice-work railing surrounds the balcony porch. The recessed entrance is a double leaf, four panel door, flanked by pilasters and sidelights and surmounted with a four light transom. The two top panels of the door and the top lights of the sidelights have round arch moldings. The molded doorframe contains a carved flower on each side, level with the door handle. The windows on the main facade are paired, double-hung, 4/4 sash, separated by a decorated paneled mullion and joined by a single wood lintel.

Extending east from the northern end of the main block is a two story brick ell that terminates with two joined, flush, gable chimneys on the west facade. Single flush gable chimneys are located on the north and south gable ends. The north facade of the house contains five 6/6 double hung windows, two small 4/4 double hung windows, and a single leaf entrance. The entrance is located on the west end and is sheltered by a portion of a porch roof that extends to the original detached kitchen. The small brick kitchen contains one 6/6 double hung window.

The south facade of the house contains a single 6/6 double hung window on the first story of the original brick section of the house. A two story frame addition has been added to the west end of the house. The frame addition contains a tripartite window (4/4, 6/6, 4/4) on the first story. There are also two small 6/6 double hung windows, one on each story.

The rear or west facade of the house is composed of a variety of heights and textures. A one and two story frame addition occupies the area formed by the ell of the 1860 brick house. The first story of the frame addition was built in 1924 and the second story in 1976. A screened-in porch extends from the frame addition to a small, shed roof, frame addition on the original detached brick kitchen. A single leaf entrance is located on the southern end of the frame addition.

Mountview contains three rooms and a central hall on the first floor of the brick portion of the house and four bedrooms on the second floor. The frame addition consists of a kitchen/breakfast area on the first floor and a dressing room/bath on the second floor.

The central hall contains a curving staircase that begins along the south wall. The staircase has a tapered, octagon-shaped, newel post, turned balusters, and decorative scroll work applied to the sides of the stairs. A rear entrance of double leaf French doors is located on the west wall under the stairs. Four doors lead from the central hall into adjoining rooms. The doors all have shouldered architrave surrounds, deep paneled reveals, and paired French doors. The French doors probably date from the 1924 alterations.

**United States Department of the Interior
National Park Service**

**National Register of Historic Places
Inventory—Nomination Form**

For NPS use only
received
date entered

Continuation sheet

Mountview

Item number 7

Page 2

On the south side of the central hall is the current dining room. The fireplace, located on the south wall, has a brick surround and a shouldered architrave mantel. On the west wall of the dining room is a second doorway. The entrance has paired French doors, surmounted by a seven light transom and flanked by four light sidelights. This doorway may have originally been an exterior entrance, prior to the construction of the frame addition.

There are four bedrooms on the second floor, three of which are directly over the downstairs rooms. All three of these rooms contain identical fireplaces with plain pilaster and entablature mantels. The fourth bedroom is located on the east side of the large landing hall and contains the two-leaf, French door entrance to the portico's balcony. A large bathroom was added between the two bedrooms on the north side in 1924. A modern dressing room/bath was added in 1976 in a frame addition off the south bedroom.

Although changes have been made to the interior of Mountview, the house retains much of its original integrity with its wide board floors, deep baseboards, fireplaces, and wood trim. The majority of changes that have occurred to Mountview were in 1924 and have since gained significance on their own accord.

Directly behind the southwest corner of the house is a narrow, two-story, brick smokehouse on a limestone foundation. The smokehouse, contemporary with the house, has a gable roof with a simple boxed cornice. A single leaf door and small window are located on the east side of the building.

South of the house are two small frame outbuildings dating from the turn of the century. One is a narrow, one and a half story shed with a gable roof. The raking eaves of the building are trimmed with pierced bargeboard in a modified fleur-de-lis pattern. A single leaf entrance and a four light window are located on the west gable end. The east end contains two openings filled with lattice-work. The second frame outbuilding is a one story garage and shed structure located west of the frame shed. This simple frame building has decorative bargeboard along the east gable end.

8. Significance

Period	Areas of Significance—Check and justify below			
<input type="checkbox"/> prehistoric	<input type="checkbox"/> archeology-prehistoric	<input type="checkbox"/> community planning	<input type="checkbox"/> landscape architecture	<input type="checkbox"/> religion
<input type="checkbox"/> 1400–1499	<input type="checkbox"/> archeology-historic	<input type="checkbox"/> conservation	<input type="checkbox"/> law	<input type="checkbox"/> science
<input type="checkbox"/> 1500–1599	<input type="checkbox"/> agriculture	<input type="checkbox"/> economics	<input type="checkbox"/> literature	<input type="checkbox"/> sculpture
<input type="checkbox"/> 1600–1699	<input checked="" type="checkbox"/> architecture	<input type="checkbox"/> education	<input type="checkbox"/> military	<input type="checkbox"/> social/
<input type="checkbox"/> 1700–1799	<input type="checkbox"/> art	<input type="checkbox"/> engineering	<input type="checkbox"/> music	<input type="checkbox"/> humanitarian
<input checked="" type="checkbox"/> 1800–1899	<input type="checkbox"/> commerce	<input type="checkbox"/> exploration/settlement	<input type="checkbox"/> philosophy	<input type="checkbox"/> theater
<input checked="" type="checkbox"/> 1900–	<input type="checkbox"/> communications	<input type="checkbox"/> industry	<input type="checkbox"/> politics/government	<input type="checkbox"/> transportation
		<input type="checkbox"/> invention		<input type="checkbox"/> other (specify)

Specific dates 1860, 1924 **Builder/Architect** Unknown

Statement of Significance (in one paragraph)

Mountview is being nominated under National Register criterion C for its architectural significance to Brentwood, Williamson County, Tennessee. The two story, transitional, Greek Revival/Italianate house was built in 1860 by William A. (Buck) and Judith Robertson Owen Davis.

Mountview is an excellent example of the transition from the formal Greek Revival style to the highly decorated Italianate style. The formal symmetry of the central hall plan house and the monumental center portico, composed of classical elements, show the stylistic elements of the Greek Revival period. The bracketed cornice, the paired windows, the embellishment of decoration of the wood surfaces, and the arched moldings of the side-light windows and upper door panels reflect the Italianate details added to the Greek Revival form house.

In 1865, Davis sold the house to Ashley Bascom Rozelle, a retired Methodist minister who reportedly stopped overnight on his way to purchase property in Franklin and, instead, bought the Davis property. The Rozelle family continued to live in the house until it was sold at auction to Charles P. Wilson in 1924. The Wilson family was responsible for many of the modern (1924) changes to the house, including the addition of the bathrooms, the rear frame addition, and the screened-in rear porch that connects the house to the original detached kitchen.

Although there have been alterations and additions to the house, they are, for the most part, minor changes that have acquired their own significance. The additions to the house have occurred at the rear and are of frame construction, easily distinguishable from the original brick structure. Even the original detached kitchen remains, in a sense, detached from the house, due to the openness of the screened-in porch.

The property includes three outbuildings, two contributing and one non-contributing. The brick smokehouse and frame shed contribute to the property, while the frame garage/shed is non-contributing.

9. Major Bibliographical References

Bowman, Virginia McDaniel. Historic Williamson County: Old Homes and Sites. Nashville: Blue and Gray, 1974.
Little, Vance. Historic Brentwood. Brentwood, TN: J.M. Publications, 1985.

10. Geographical Data

Acreage of nominated property 5 acres
Quadrangle name Oak Hill, Tennessee 308SE Quadrangle scale 1:24000

UTM References

A	<u>16</u>	<u>518400</u>	<u>3984360</u>	B	<u> </u>	<u> </u>	<u> </u>
	Zone	Easting	Northing		Zone	Easting	Northing
C	<u> </u>	<u> </u>	<u> </u>	D	<u> </u>	<u> </u>	<u> </u>
E	<u> </u>	<u> </u>	<u> </u>	F	<u> </u>	<u> </u>	<u> </u>
G	<u> </u>	<u> </u>	<u> </u>	H	<u> </u>	<u> </u>	<u> </u>

Verbal boundary description and justification The boundary follows the existing property lines as shown on the enclosed map, less a 17 foot wide strip of land extending 368 feet along Franklin Road. This includes sufficient property to protect the historical integrity of the house.

List all states and counties for properties overlapping state or county boundaries

state	<u>N/A</u>	code	<u>N/A</u>	county	<u>N/A</u>	code	<u>N/A</u>
state	<u>N/A</u>	code	<u>N/A</u>	county	<u>N/A</u>	code	<u>N/A</u>

11. Form Prepared By

name/title Janice Nolan, Staff Historian
Elizabeth A. Straw, Historic Preservation Specialist
 organization Tennessee Department of Transportation
Tennessee Historical Commission date July 1986
 street & number 505 Deaderick Street telephone (615) 741-5363
701 Broadway telephone (615) 742-6722
 city or town Nashville state Tennessee 37203
Nashville state Tennessee 37219

12. State Historic Preservation Officer Certification

The evaluated significance of this property within the state is:

national state local

As the designated State Historic Preservation Officer for the National Historic Preservation Act of 1966 (Public Law 89-665), I hereby nominate this property for inclusion in the National Register and certify that it has been evaluated according to the criteria and procedures set forth by the National Park Service.

Deputy State Historic Preservation Officer signature Herbert L. Sawyer
 title Executive Director, Tennessee Historical Commission date 10/14/86

For NPS use only

I hereby certify that this property is included in the National Register

Entered in the
National Register

date 11-20-86

Herbert L. Sawyer
 for Keeper of the National Register

Attest:

date

Chief of Registration

**United States Department of the Interior
National Park Service**

**National Register of Historic Places
Inventory—Nomination Form**

For NPS use only
received
date entered

Continuation sheet Mountview

Item number 6

Page 2

REPRESENTATION IN EXISTING SURVEYS

DOT/FHWA requested a determination of eligibility on Mountview in 1982. The property was determined eligible by the Keeper of the National Register on November 22, 1982.

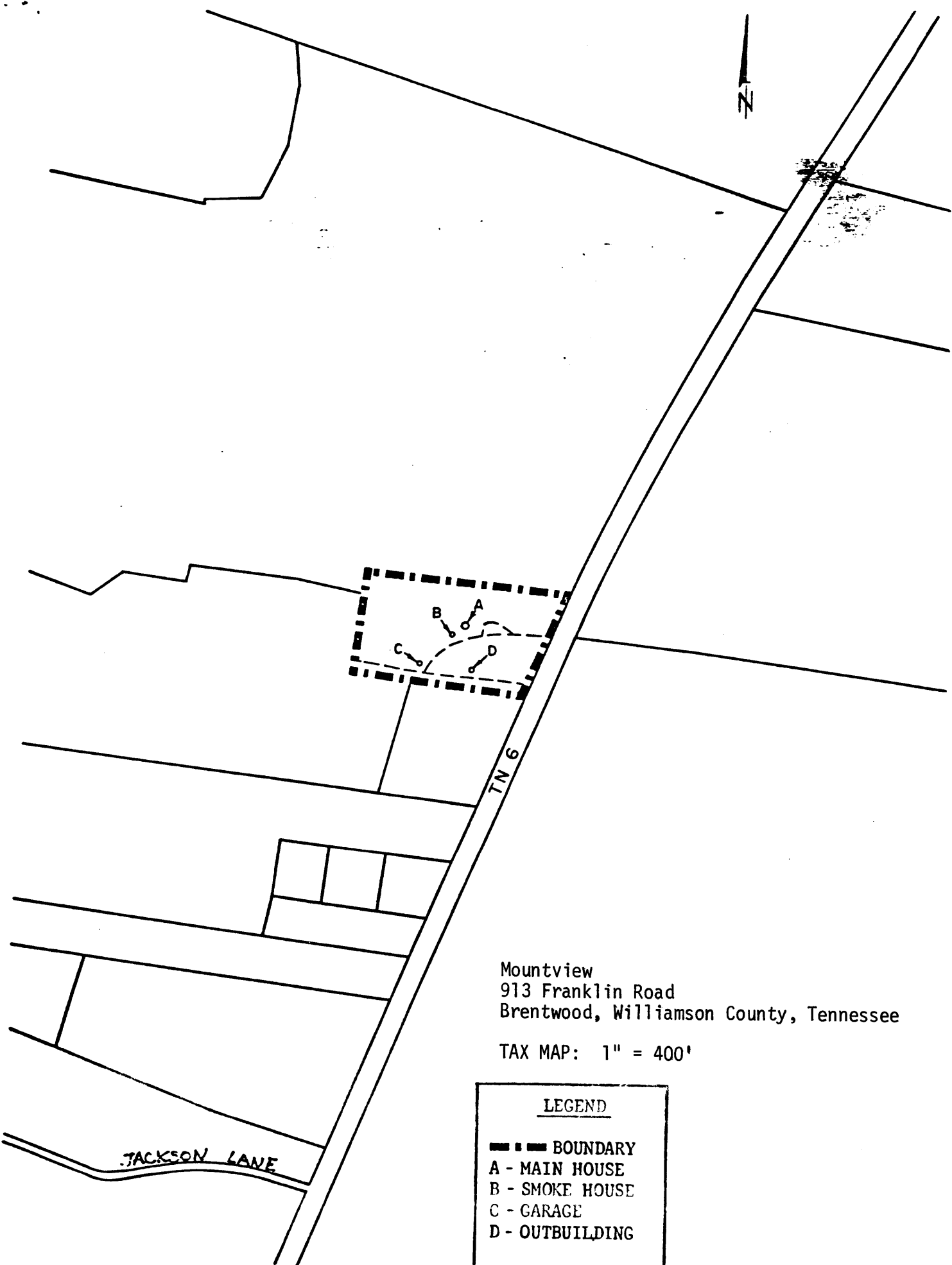

Mountview
913 Franklin Road
Brentwood, Williamson County, Tennessee

TAX MAP: 1" = 400'

LEGEND

- ▬▬▬ BOUNDARY
- A - MAIN HOUSE
- B - SMOKE HOUSE
- C - GARAGE
- D - OUTBUILDING

SCALE: 1" = 400'