

roll # 80000522

FORM B - BUILDING

MASSACHUSETTS HISTORICAL COMMISSION  
Office of the Secretary, State House, Boston

In Area no.	Form no.
	79-L

1. Town Worcester  
 Address Green Hill Parkway  
 Name Green Hill Park Shelter  
 Present use shelter/concession vac

2. Photo (3x3" or 3x5")  
 Staple to left side of form  
 Photo number \_\_\_\_\_

Present owner City of Worcester

3. Description:

Date 1910-1911

Source City Documents

Style elements of Oriental architecture

Architect George H. Clemence

Exterior wall fabric fieldstone piers

Outbuildings (describe) none

Other features hip roof and dormers

with upward curving eaves in imitation of Oriental architecture, wood frame roof on metal supports

Altered no Date \_\_\_\_\_

Moved no Date \_\_\_\_\_

5. Lot size: part of Green Hill Park  
Assessors' Book 57, p.3  
see map 79 for nominated area  
 One acre or less \_\_\_\_\_ Over one acre x

UTM  
 19/270540/4684590

Approximate frontage not applicable

Approximate distance of building from street  
15'

6. Recorded by B.R. Pfeiffer

Organization Worc. Heritage Pres. Soc.

Date November 1977

7. Original owner (if known) City of Worcester  
 Original use park shelter and "refectory"  
 Subsequent uses (if any) and dates same (no food concession at present)

8. Themes (check as many as applicable)

Aboriginal	<input type="checkbox"/>	Conservation	<input type="checkbox"/>	Recreation	<input type="checkbox"/>
Agricultural	<input type="checkbox"/>	Education	<input type="checkbox"/>	Religion	<input type="checkbox"/>
Architectural	<input checked="" type="checkbox"/>	Exploration/ settlement	<input type="checkbox"/>	Science/ invention	<input type="checkbox"/>
The Arts	<input type="checkbox"/>	Industry	<input type="checkbox"/>	Social/ humanitarian	<input type="checkbox"/>
Commerce	<input type="checkbox"/>	Military	<input type="checkbox"/>	Transportation	<input type="checkbox"/>
Communication	<input type="checkbox"/>	Political	<input type="checkbox"/>		
Community development	<input type="checkbox"/>				

9. Historical significance (include explanation of themes checked above)

The Green Hill Park Shelter is an open pavilion consisting of sixteen square posts of field stone which support a high hip roof with curved eaves and ridge. Part of the structure's south end contains an enclosed area originally planned as a concession stand. The simplicity of the structure's design, its fine construction and Oriental influences mark it as the most architecturally sophisticated of Worcester's park pavilions, most of which were built in the early twentieth century.

The shelter stands in Green Hill Park, a tract of 500 acres which the heirs of the Hon. Andrew Green gave to the city of Worcester in 1906. At the time of the donation the property was laid out as a private estate, containing a Victorian Gothic mansion and other buildings (now demolished) which had been occupied by the Green family since the eighteenth century. Unclear references from the City Documents suggest that the city hired the prominent landscape architectural firm of Olmstead Brothers to plan paths, plantings, etc. in order to convert the Green estate into a public park, although individual park structures seem to have been designed by local firms. Because of the park's large size, only the land which immediately surrounds the Green Hill Park Shelter and that which protects its view to Green Hill Pond have been included in this nomination (See Map 79)

10. Bibliography and/or references (such as local histories, deeds, assessor's records, early maps, etc.)

City Documents #65 (Nov. 30, 1910) pp. 173, 839; #66 (Nov. 30, 1911) pp. 182, 184.  
 Nutt, C. History of Worcester and Its People, vol. I, pp. 436-438 (illustration)

Property Worcester Multiple Resource Area (Postal Inventory)

State MA (Worcester) Working Number 8.30.79.2060

**TECHNICAL**

**CONTROL**

Photos 383 + 13  
Maps 2, 63

Excellent multiple resource nomination for the entire city of Worcester. Both the general description or statement of significance & the individual inventory sheets are well done. Each type of property included is well justified, & reasons are listed for not including others at this time (e.g. 3-deckers). Opposition is high. Minor problems with some properties are listed on attached sheets.

**HISTORIAN**  
Call/Accept  
Lightner  
10-30-79

Concur with Bruce's comments on 102-L-3, 116-CBD-11, 117-E, and 130-CBD-50 and 44. Integrity and/or boundaries need to be addressed specifically on individual forms. DOUBLE

**ARCHITECTURAL HISTORIAN**  
**ARCHEOLOGIST**

116-CBD-11 - Destroyed, cannot be listed.  
130-CBD-44 - I am not convinced this has lost integrity. See attached.  
102-L-3 - Period of significance and categorization of 1 bldg need to be discussed with State.

With 3 exceptions all properties appear to me to meet the criteria and the forms are adequate. ~~Both~~ <sup>both</sup> technically and to determine significance. Although some of the forms did not contain strong statements of significance the resource categories were thoroughly discussed in the body of the nomination; therefore significance was established. VSDs were not necessary because

**OTHER**  
ACCEPT  
MacDonald  
2/23/80

of the scale maps and clearly delineated boundaries. Pledge was missing on some properties but is now included after the 2/11/corrections. The only properties that I do not recommend listing are

**HAER**  
Inventory \_\_\_\_\_  
Review \_\_\_\_\_

✓ 116-CBD-13 - DESTROYED BY FIRE MD - 10 CBD - 11  
130-CBD-44 - DOES NOT RETAIN INTEGRITY FOR INDIVIDUAL ELIGIBILITY

✓ 102-L-3 I ~~am~~ <sup>am</sup> NOT CONVINCED ABOUT BOUNDARIES BUT BELIEVE THEY WOULD BE OK. ~~BASED~~ ON ADDITIONAL DOCUMENTATION SUBMITTED - I DEFER JUDGEMENT.

**REVIEW UNIT CHIEF**

Recommend listing all properties <sup>now</sup> except these 3. Return 116-CBD-11 to State (not eligible); ~~with it~~ <sup>to discuss further</sup> w/NR staff + State. DOUBLE  
Return 102-L-3 to state for correction;  
HOLD 130-CBD-44 for info from state

**BRANCH CHIEF** 3/3/80

Staff conference 3/5/80 - agreed to action as noted below:

**KEEPER**

Accept with exception of 116-CBD-11 (official notification of fire & claims from State), 102-L-3 (returning to state for revision - also returning 116-CBD-11) and 130-CBD-44 (Ltrly frmt from state)

*Spedha*  
3/5/80

National Register Write-up \_\_\_\_\_ Send-back \_\_\_\_\_ Entered MAR 5 1980  
Federal Register Entry 2.3.81 Re-submit \_\_\_\_\_ SEE 3/13/80 REPORT



Green Hill Park Shelter

30 AUG 1979

Worcester MRA, Ma

79-A

Green Hill Parkway

MAR

west elevation

5 1980

M

JAN 1978

by Berkeley

Prestige Prints

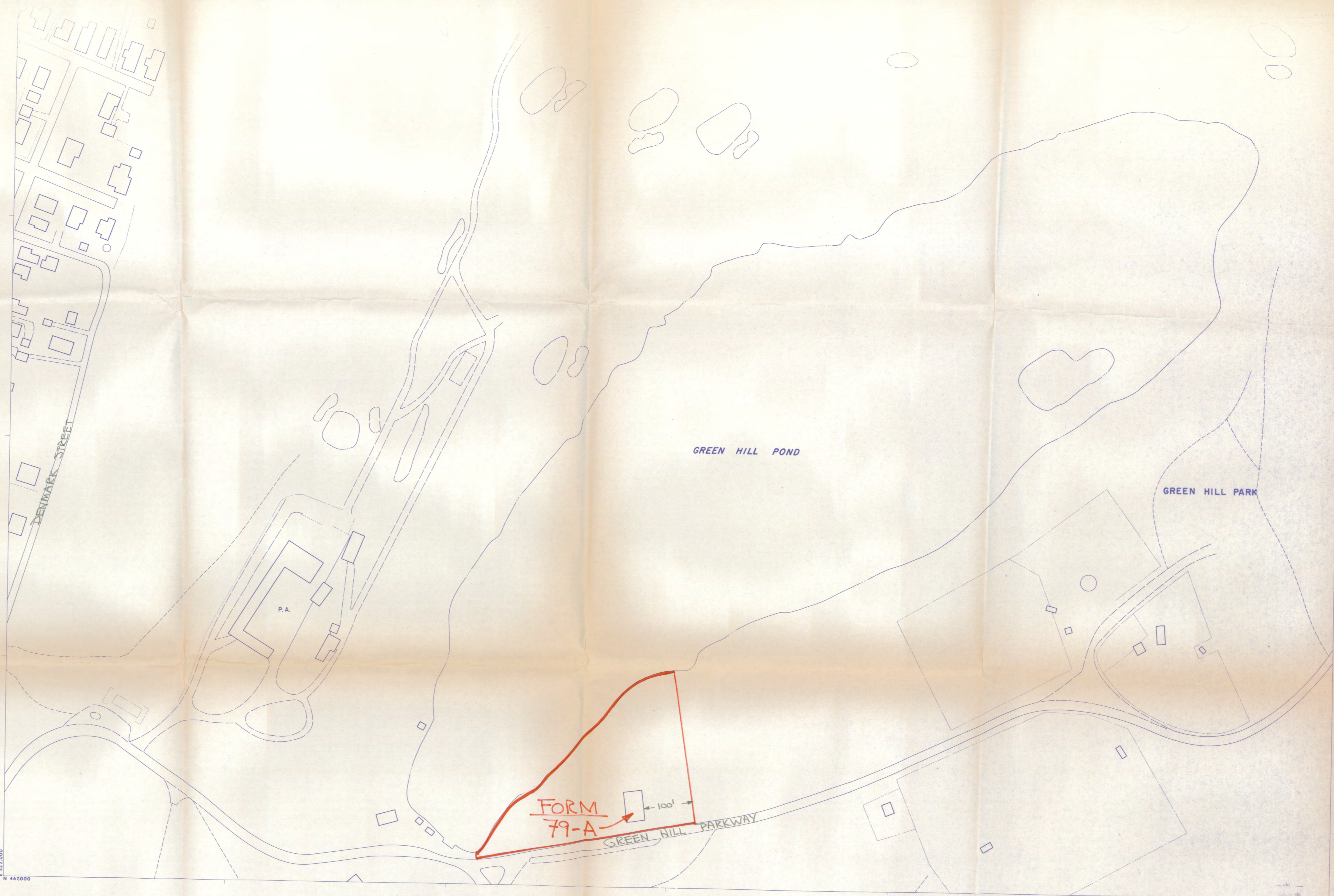

E 592 000  
N 467 000

COMPILED BY PHOTOGRAMMETRIC METHODS  
**moore survey & mapping corp.**  
 CONTROL BY MASS. GEODETIC SURVEY, U.S.C. & G.S., & M.S.&M. CORP.  
 UPDATED BY \_\_\_\_\_ DATE: \_\_\_\_\_

THIS MAP REPRODUCED FROM MAPPING MEETING NATIONAL MAP ACCURACY STANDARDS AT A SCALE OF 1"=200'

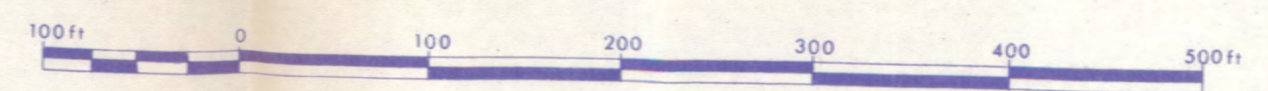

500 FOOT GRID BASED ON MASS RECTANGULAR COORDINATE SYSTEM

INDEX

66	67	68
78		80
90	91	92

CITY OF WORCESTER  
 MASSACHUSETTS  
 PLANIMETRIC BASE MAP

PROJECT: M.S.M. 2517 DATE OF PHOTOGRAPHY: \_\_\_\_\_ SHEET 79 OF 220 SHEETS



