

JUN 7 1985

NPS Form 10-900
(3-82)

OMB No. 1024-0018
Exp. 10-31-84

United States Department of the Interior
National Park Service

For NPS use only

National Register of Historic Places
Inventory—Nomination Form

received AUG 12 1985

date entered SEP 12 1985

See instructions in *How to Complete National Register Forms*
Type all entries—complete applicable sections

1. Name

historic The Dr. Solomon M. Whipple House (preferred) ✓

and/or common The Clough House or Woodward House

2. Location

street & number Main Street (200' East of the intersection of Main St and Pleasant Street) N/A not for publication

city, town New London vicinity of

state New Hampshire code 33 county Merrimack code 013

3. Classification

Category	Ownership	Status	Present Use	
<input type="checkbox"/> district	<input type="checkbox"/> public	<input checked="" type="checkbox"/> occupied	<input type="checkbox"/> agriculture	<input type="checkbox"/> museum
<input checked="" type="checkbox"/> building(s)	<input checked="" type="checkbox"/> private	<input type="checkbox"/> unoccupied	<input type="checkbox"/> commercial	<input type="checkbox"/> park
<input type="checkbox"/> structure	<input type="checkbox"/> both	<input type="checkbox"/> work in progress	<input type="checkbox"/> educational	<input checked="" type="checkbox"/> private residence
<input type="checkbox"/> site	Public Acquisition	Accessible	<input type="checkbox"/> entertainment	<input type="checkbox"/> religious
<input type="checkbox"/> object	<input type="checkbox"/> in process	<input type="checkbox"/> yes: restricted	<input type="checkbox"/> government	<input type="checkbox"/> scientific
	<input type="checkbox"/> being considered	<input checked="" type="checkbox"/> yes: unrestricted	<input type="checkbox"/> industrial	<input type="checkbox"/> transportation
	<input checked="" type="checkbox"/> N/A	<input type="checkbox"/> no	<input type="checkbox"/> military	<input checked="" type="checkbox"/> other: rental apt.

4. Owner of Property

name The Dr. Solomon M. Whipple House (a partnership)

street & number P.O. Box 1670, Main Street

city, town New London N/A vicinity of state NH 03257

5. Location of Legal Description

courthouse, registry of deeds, etc. Merrimack County Courthouse
Merrimack County Register of Deeds

street & number 163 North Main Street

city, town Concord state NH 03301

6. Representation in Existing Surveys

title See Continuation Sheet has this property been determined eligible? yes no

date federal state county local

depository for survey records

city, town state

7. Description

Condition		Check one	Check one
<input checked="" type="checkbox"/> excellent	<input type="checkbox"/> deteriorated	<input type="checkbox"/> unaltered	<input checked="" type="checkbox"/> original site
<input type="checkbox"/> good	<input type="checkbox"/> ruins	<input checked="" type="checkbox"/> altered	<input type="checkbox"/> moved date <u>N/A</u>
<input type="checkbox"/> fair	<input type="checkbox"/> unexposed		

Describe the present and original (if known) physical appearance

Located on Main Street in the middle of New London, New Hampshire, The Dr. Solomon M. Whipple House is a two-story, white, painted, wood frame Greek Revival home with two typical New Hampshire Continuous Architecture additions connecting to the renovated barn. The windows throughout are multipaned unless otherwise described below.

The original two story wood frame structure, built (1850) in the Greek Revival idiom, measures sixteen feet by thirty-six feet and is three bays wide, one room deep. On the front (north) facade, the siding is eight inch flush wood boards which are joined to produce a smooth surface. The rest of the siding is wood clapboard with three and one half inch weather exposure. The ridge line of the eight in twelve pitch asphalt shingled roof runs parallel to the street with triangular pediments formed by the gables on either end. These are distinguished by triangular louvered vents in the gable wall. One chimney with one operable flue still remains in the location of an original chimney and is located off the library behind the north west side of this section of the house. A tripartite window is centered over the front door on the second floor. The rest of the windows are six-over-six large light windows with thin wood mullions, placed symmetrically on the facade. The first floor windows have broad, heavily molded wood window heads; the second floor windows butt up to the heavy entablature above. Each window has a set of exterior and interior wood shutters. The wide wood entablature runs along the front facade and returns and runs under the dominant gable ends. The portico entablature is similar in detail with the addition of dentils. Heavy Doric style pilasters are located at each corner (except at the corner where the original section butts into the first addition) of the building with the architrave of the entablature resting on top of the capital. The main entry is a four-panel wooden door flanked by five-light side lights. The 1940's front portico has two fluted wooden Doric columns supporting a projecting cornice and flat roof deck with balustrade defining its edges. Two Doric pilasters frame the front entry.

The interiors of the Greek Revival section include a front parlor with wide board horizontal wainscoting and chair rail and a library with wide board (up to 22") vertical panels and wood plank flooring, all said to have come from the same tree, and an operable brick fireplace. The second floor has two symmetrical bedrooms and a short hall. In the

See Continuation Sheet

8. Significance

Period	Areas of Significance—Check and justify below			
<input type="checkbox"/> prehistoric	<input type="checkbox"/> archeology-prehistoric	<input type="checkbox"/> community planning	<input type="checkbox"/> landscape architecture	<input type="checkbox"/> religion
<input type="checkbox"/> 1400-1499	<input type="checkbox"/> archeology-historic	<input type="checkbox"/> conservation	<input type="checkbox"/> law	<input type="checkbox"/> science
<input type="checkbox"/> 1500-1599	<input type="checkbox"/> agriculture	<input type="checkbox"/> economics	<input type="checkbox"/> literature	<input type="checkbox"/> sculpture
<input type="checkbox"/> 1600-1699	<input checked="" type="checkbox"/> architecture	<input type="checkbox"/> education	<input type="checkbox"/> military	<input type="checkbox"/> social/
<input type="checkbox"/> 1700-1799	<input type="checkbox"/> art	<input type="checkbox"/> engineering	<input type="checkbox"/> music	<input type="checkbox"/> humanitarian
<input checked="" type="checkbox"/> 1800-1899	<input type="checkbox"/> commerce	<input type="checkbox"/> exploration/settlement	<input type="checkbox"/> philosophy	<input type="checkbox"/> theater
<input type="checkbox"/> 1900-	<input type="checkbox"/> communications	<input type="checkbox"/> industry	<input type="checkbox"/> politics:government	<input type="checkbox"/> transportation
		<input type="checkbox"/> invention		<input type="checkbox"/> other (specify)

Specific dates 1850 Builder/Architect Not known

Statement of Significance (in one paragraph)

The Dr. Solomon M. Whipple House is an excellent example of a Greek Revival style home. Built in 1850, the two-story wood frame structure is the only example of Greek Revival in the area, based on a house by house survey. Prominently located in the center of town adjacent to the New London Town Common, it is a striking statement as one looks across the well-manicured lawns of the Common to the triangular pediment, Doric pilasters, and broad entablature. The later additions reflect the characteristic New Hampshire practice of combining the house, its additions, and the barn into one long composition, as protection against savage winter gales and heavy snows.

The three bay Main Street elevation is bold in silhouette, broad in proportion and has simplified detailing. Bilateral symmetry is evident throughout, and -as was typical- the house has been painted white. The low roof pitch mimics the temple rooflines of ancient Greece. The eave line faces Main Street and the temple facades, with their heavy pediment gable which is trimmed with mouldings along its base and sloping sides, face the town common and the side street, Whipple Court, very visible as one travels up and down Main Street. The heavy entablature and cornice continue to form a pedimented gable. The substitution of the Greek anta form for columns was used. These square Doric order pilasters were applied to the corners of the structure. The omission of fluting from the Doric Style was typical particularly in country work. Also, the Whipple House is characteristic of the American form of the Greek Style in that triglyphs and mutules on the entablature have been omitted. The wall surface of the front facade was kept as smooth as possible with flush wide wood boards horizontally applied with no overlap. The six-over-six windows have the typical large lights with slim muntins. The door opening is flanked by side lights. All windows and the door are trabeated, with the first floor windows having heavily molded heads. The structure shows evidence of the influence of the noted Boston architect, Asher Benjamin; it has a certain masculine sense, forthright character, and largeness of scale. There is something almost stark about the building. Hallmarks of Benjamin's designs have been incorporated, such as the use of a flatter cornice with a greater projection than was used in the classic style, eight times diameter pilasters, and the use of flat bands and fillets.

See Continuation Sheet

9. Major Bibliographical References

See Continuation Sheet

10. Geographical Data

Acreeage of nominated property .6 of an acre

Quadrangle name Kearsarge, NH

Quadrangle scale 1:625000 series

UTM References

A

1	9	2	5	8	3	5	0	4	8	1	0	8	5	0
Zone			Easting					Northing						

B

Zone			Easting					Northing						

C

Zone			Easting					Northing						

D

Zone			Easting					Northing						

E

Zone			Easting					Northing						

F

Zone			Easting					Northing						

G

Zone			Easting					Northing						

H

Zone			Easting					Northing						

Verbal boundary description and justification

See Continuation Sheet

Taxmap: 84 Lot 13

List all states and counties for properties overlapping state or county boundaries

state N/A code county code

state N/A code county code

11. Form Prepared By

name/title Deirdre McCrystal, AIA; President

organization Sheerr & McCrystal, Inc. date 7-10-84

street & number Scytheville Row, P.O. Box 1500 telephone 603-526-9347

city or town New London state NH 03257

12. State Historic Preservation Officer Certification

The evaluated significance of this property within the state is:

national state local

As the designated State Historic Preservation Officer for the National Historic Preservation Act of 1966 (Public Law 89-665), I hereby nominate this property for inclusion in the National Register and certify that it has been evaluated according to the criteria and procedures set forth by the National Park Service.

State Historic Preservation Officer signature 

title New Hampshire State Historic Preservation Officer date 7/29/85

For NPS use only

I hereby certify that this property is included in the National Register

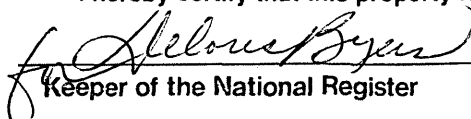
 Keeper of the National Register date 9/12/85

Attest: _____ date _____

Chief of Registration

**United States Department of the Interior
National Park Service**

**National Register of Historic Places
Inventory—Nomination Form**

For NPS use only

received

date entered

Continuation sheet 1

Item number 6

Page 1

The Department of the Interior, National Park Service, on June 29, 1984 made a preliminary determination that The Dr. Solomon M. Whipple House is a "certified historic structure" (Part 1) and they have determined that the proposed rehabilitation project meets with the Secretary of Interior's "Standards for Rehabilitation" (Part 2).

The Whipple House can be found on the following maps and surveys:

The Merrimac County Map of 1858, Surveys by H.F. Walling, Published
by Smith & Peavy, Boston & New York;

The Town & City Atlas of the State of New Hampshire, 1892;
USGS Survey, Mount Kearsarge Quadrangle, NH, 1926 Survey, 1928 & 1956
edition.

**United States Department of the Interior
National Park Service**

**National Register of Historic Places
Inventory—Nomination Form**

For NPS use only

received

date entered

Continuation sheet 2

Item number 7

Page 1

center entry hall is the main staircase with wood railing and simple balustrades. There is a simple triangular head above every window and door (except the front door which goes right to the crown moulding). The window casings take the form of fluted pilasters in a simple rusticated style. The original basement with stone walls and hewn timbers contains one of two furnaces in the house.

Immediately behind (south of) the main block is a two-story ell which measures twenty-five feet by thirty-three feet. This section was originally a kitchen ell to the main house, but has undergone major renovations by Dr. Whipple, the original owner, and his family who owned the building for over ninety years, and again in the late 1940's by Dr. Clough who moved the eastern facade out ten feet and added the second floor hip dormer. The wood framed addition has the same clapboard as the sides of the original section. The first floor windows are not as rigidly symmetrical, but consist of two five feet by six feet windows at the corners and two two feet by three feet windows evenly spaced in the center. The interior rooms on the first floor consist of a sitting room, dining room with two built-in china cabinets, kitchen, and powder room. The sitting room is connected to the parlor room of the original section by a gracious eight foot opening. The second floor rooms are bedrooms and baths; most of the windows have lintels designed in the same triangular head as the main block.

**United States Department of the Interior
National Park Service**

**National Register of Historic Places
Inventory—Nomination Form**

For NPS use only

received

date entered

Continuation sheet 3

Item number 7

Page 2

Beyond the ell is a two-story wood addition, of more recent vintage (1943), which replaces an old breezeway that connected the house to the barn. It has the same clapboard siding as the two other sections. There are two shed dormers, one on either side of the ridge which run the length of the section. All windows are six-over-six double-hung sash symmetrically placed on the facades. There is an entry door on the east facade. There is a chimney on the backside that is the flue for a furnace. The first floor interior has an entry foyer that now connects the rest of the house and an apartment for the house manager. A stairway ascends to a second floor hall and two bedrooms.

The structure's connected sections terminate with what was originally a barn but had been modified into a garage, including Texture 1-11 siding and overhead doors. As part of certified rehabilitation in 1984, the garage doors were removed, and replaced with windows, and clapboarding was applied to blend with the rest of the structure. This section now contains bedrooms.

**United States Department of the Interior
National Park Service**

**National Register of Historic Places
Inventory—Nomination Form**

For NPS use only
received
date entered

Continuation sheet 4

Item number 8

Page 1

The plan and interiors also reflect the simple bilateral symmetry of the classical influence. The original basic house plan is geometrically regular and rectangular. The interior window and door trim emulates the Greek Style. Simplified Greek triangular pediments were used over all openings. Oversized casings simulating pilasters with Doric Style fluting were used in the public rooms.

The house was built in 1850 by Dr. Solomon M. Whipple, who was the town physician and community leader. Dr. Whipple, the town doctor longer than any other physician, was also President of the New Hampshire Medical Society in 1876. Dr. Whipple had his office in the house. His children contributed greatly to the area including the building of the town hall, the Whipple Memorial Hall, the founding of Kearsarge Telephone Company (still the phone company today); and the founding of one of the area's first stage lines. After the Whipple heirs, the house passed on in 1941 to Dr. William P. Clough, Jr. where it remained until recent times. Dr. Clough was also one of New London's most prominent citizens and town leader as well as being it's eminent physician for thirty-five years; he also had his office practice in this house. Dr. "Bill", as he is still remembered, was chairman of the New London Planning Board, President of the New London Outing Club and Fellow of the American College of Surgeons. The building has a long tradition of housing generations of New London's most beloved doctors and their practices.

United States Department of the Interior
National Park Service
National Register of Historic Places
Inventory—Nomination Form

For NPS use only
received
date entered

Continuation sheet 5

Item number 9

Page 1

The references to Whipple House, Dr. Solomon M. Whipple and/or Dr. W.P. Clough, Jr. may be found in the following publications:

M.B.Lord, A History of the Town of New London, Merrimac County, NH,
(Concord, NH: Rumford Press, 1899);

J.D.Squires, Ph.D., Mirror to America, A History of New London, NH,
(Concord, NH: Evans Printing Co. Inc., 1952)

D.H.Hurd, editor, The History of Merrimac and Belnap Counties, NH,
(Philadelphia, PA: J.W. Lewis & Co., 1885)

New Hampshire 1850 Census

H.B.Whipple, A Partial List of the Descendants of Mathew Whipple,
(High Point, NC, 1969)

The Genealogy of the Descendants of John Clough of Salisbury, Mass.
Vol. II, (Littleton, NH: Courier Printing Co., 1966)

Sesqui-Centennial Celebration, New London, NH, the 150th Anniversary
(Franklin, NH: Town & Robie Printers, 1929)

Historical Sketches of New London, NH, 1779-1979, Seven Townspeople
(New London, NH: Country Press, 1978)

New London, New Hampshire: The First 200 Years, (New London, NH: The
Country Press, 1980)

Honor Roll of the First-Century Families (1779-1879)

Interviews:

Dorothy (Whipple) Illig, granddaughter of Dr. Solomon M.
Whipple, 6 June, 1984;

Mrs. William P. Clough, Jr., previous owner, Feb. 1984;

Mrs. John Clough, Dec. 1983;

Mr. & Mrs. Sumner Woodward, previous and current owners,
ongoing interviews from Nov. 1983 to present;

Mildred Tunis, New London Historical Society, New London
Town Historian & Archivist, Nov. 1983.

**United States Department of the Interior
National Park Service**

**National Register of Historic Places
Inventory—Nomination Form**

For NPS use only
received
date entered

Continuation sheet 7

Item number 10

Page 1

From Warranty Deed:

Certain tract of land with the buildings thereon situate on the southerly side of Main Street, said New London, bounded and described as follows:

Beginning at a stone bound on the southerly side of said Main Street at the easterly corner of the school house lot so-called, the same being the northwesterly corner of the premises herein conveyed; thence S 47 W 168 feet to a stone bound at land now or formerly of Maude H. Shepard; thence S 45 E along land of said Maude H. Shepard and land now or formerly of Charles E. Shepard & Son, Inc. 157 feet more or less to a point; thence N 46 E 63 feet along land of Charles E. Shepard & Son, Inc.; thence along same course on land now or formerly of Maude H. Shepard 107 feet 6 inches to a stone post on the southerly side of said Main Street; thence northwesterly along said highway 157 feet more or less to the point of beginning.

[New London, NH town tax map #84, Lot #13]

The nominated property includes the surviving property still associated with the Dr. Solomon M. Whipple House.

Note: The boundaries of the nominated property have been highlighted in yellow on the attached sketch map (8-10-2).

United States Department of the Interior
National Park Service

National Register of Historic Places
Inventory—Nomination Form

For NPS use only

received

date entered

Continuation sheet 8

Item number 10

Page 2

THE DR. SOLOMON M. WHIPPLE HOUSE
New London, N.H.

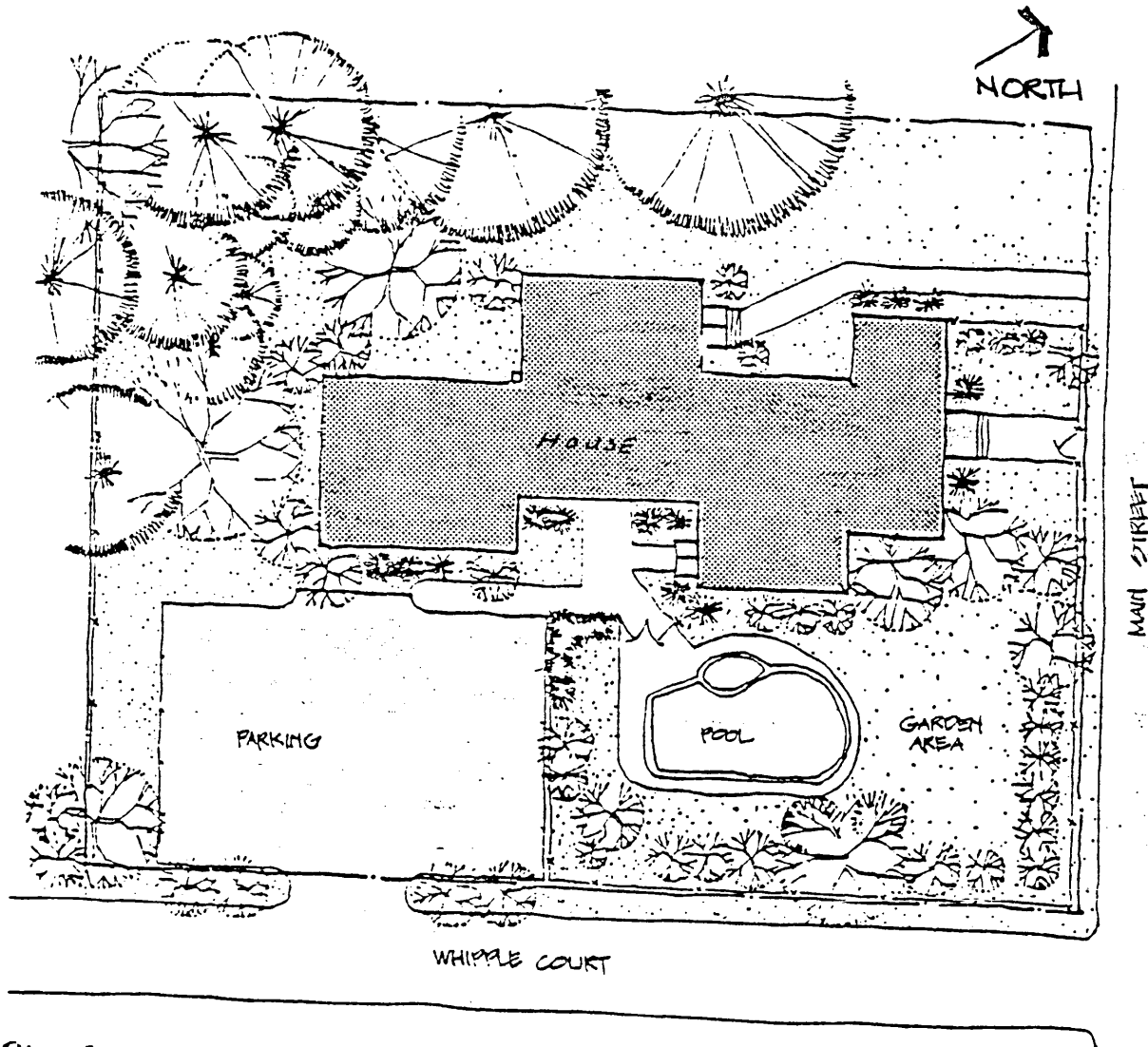

Site Plan
Scale 1" = 40'

**United States Department of the Interior
National Park Service**

**National Register of Historic Places
Inventory—Nomination Form**

For NPS use only

received

date entered

Continuation sheet 9

Item number support document Page 1

This certifies that the appearance of the photographs has not changed.