

TENNESSEE MULTIPLE PROPERTY FORM

TITLE: Historic Resources of Grundy County

COUNTY: Grundy

SITE: 16

HISTORIC NAME: Hampton, E. L., House  
COMMON NAME: Mrs. Fritz Baggenstoss House  
ADDRESS: Depot and Oak Streets  
Tracy City, Tennessee

OWNER: Mrs. Fritz Baggenstoss  
ADDRESS: Depot and Oak Streets  
Tracy City, Tennessee 37387

HISTORIC USE: Residence                      CURRENT USE: Residence  
CATEGORY/BUILDING TYPE: Residence  
DATE OF CONSTRUCTION: c.1896              ARCHITECT/BUILDER: unknown  
ORIGINAL SITE: yes      MOVED: N/A      DATE: N/A  
ORIGINAL OWNER/SIGNIFICANT INDIVIDUALS: E. L. Hampton

HAS THIS PROPERTY BEEN DETERMINED ELIGIBLE?    no                      DATE: N/A

CONTRIBUTING:		NON-CONTRIBUTING:	
buildings	3	buildings	1
structures	0	structures	0
sites	0	sites	0
objects	0	objects	0
TOTAL	3	TOTAL	1

VERBAL BOUNDARY DESCRIPTION AND JUSTIFICATION:  
Parcel #15. See Map #16. The boundaries for the E. L. Hampton House include the property historically associated with the house.

ACREAGE: 1.2 acres  
UTM REFERENCE: Tracy City 99SW  
16/614540/3902220

BIOGRAPHICAL REFERENCES:  
Grundy County Tax Records and Deeds

PREPARED BY: Elizabeth A. Straw, Historic Preservation Specialist  
ADDRESS: Tennessee Historical Commission  
701 Broadway  
Nashville, Tennessee 37219

TENNESSEE MULTIPLE PROPERTY FORM - CONTINUATION SHEET

TITLE: Historic Resources of Grundy County

SITE: 16

PAGE: 2

DESCRIPTION:

The E. L. Hampton House is a two story frame vernacular Queen Anne house located on the corner of Depot and Oak Streets in Tracy City. The front or southeast facade of the house, contains an open stone porch in the ell of the house and a bay window on the front gable. The bay window contains three two over two windows, a very wide entablature, and panels under the windows. The open porch is curved on the northeast end and has diagonal tounge and grove paneling on the inner walls.

The rear or northwest facade of the house has been altered somewhat by the conversion of the house into apartments. A second entry door was added next to the original, new windows were added and one original window appear to have been removed. The southwest facade of the house contains a two story bay window surmounted by a gable roof. The first story of the bay is paneled similar to the bay window on the front facade, has a wide overhang and entablature, and contains an entrance in the center. The second story of the bay window is plain in design. The northeast facade of the house has very little detail and has been altered somewhat by the addition of a small picture window on the first story. The majority of windows in the house are two over two double hung sash. Although the house has been altered by the conversion of a single family dwelling into apartments and by a few modern windows, it does retain its basic integrity.

The interior of the E. L. Hampton House was inaccessible.

There are three outbuildings on the property, a non-contributing four stall carport, a contributing well house and a contributing tenant house.

SIGNIFICANCE:

CRITERIA: B

CONSIDERATION: N/A

AREA OF SIGNIFICANCE: Industry

PERIOD OF SIGNIFICANCE/SIGNIFICANT DATES: circa 1896-1924

LEVEL OF SIGNIFICANCE: Local

The E. L. Hampton House is nominated under National Register criterion B for the significance of E. L. Hampton in mining industry in Grundy County. The house was built in circa 1885 by E. L. Hampton, a ticket agent for the Nashville, Chattanooga and St. Louis Railroad. In April of 1904 E. L. Hampton leased the land holdings from TCI and organized the Tennessee Consolidated Coal Company. Although the TCC was often involved in major labor disputes with local miners, the company continued to operate until the 1960's. E. L. Hampton was the president of TCC and an important person in both the coal mining industry and in Tracy City. Hampton resided in this house until circa 1924 when it was sold to Mr. and Mrs. Fritz Baggenstoss. The period that Hampton resided in the house was an important and the most productive period of mining for T.C.C.

**TENNESSEE MULTIPLE PROPERTY FORM - CONTINUATION SHEET**

**TITLE:** Historic Resources of Grundy County

**SITE:** 16

**PAGE:** 2

**DESCRIPTION:**

The E. L. Hampton House is a two story frame vernacular Queen Anne house located on the corner of Depot and Oak Streets in Tracy City. The front or southeast facade of the house, contains an open stone porch in the ell of the house and a bay window on the front gable. The bay window contains three two over two windows, a very wide entablature, and panels under the windows. The open porch is curved on the northeast end and has diagonal tongue and groove paneling on the inner walls.

The rear or northwest facade of the house has been altered somewhat by the conversion of the house into apartments. A second entry door was added next to the original, new windows were added and one original window appear to have been removed. The southwest facade of the house contains a two story bay window surmounted by a gable roof. The first story of the bay is paneled similar to the bay window on the front facade, has a wide overhang and entablature, and contains an entrance in the center. The second story of the bay window is plain in design. The northeast facade of the house has very little detail and has been altered somewhat by the addition of a small picture window on the first story. The majority of windows in the house are two over two double hung sash. Although the house has been altered by the conversion of a single family dwelling into apartments and by a few modern windows, it does retain its basic integrity.

The interior of the E. L. Hampton House was inaccessible.

There are three outbuildings on the property, a non-contributing four stall carport, a contributing well house and a contributing tenant house.

**SIGNIFICANCE:**

**CRITERIA:** B

**CONSIDERATION:** N/A

**AREA OF SIGNIFICANCE:** Industry

**PERIOD OF SIGNIFICANCE/SIGNIFICANT DATES:** circa 1896-1924

**LEVEL OF SIGNIFICANCE:** Local

The E. L. Hampton House is nominated under National Register criterion B for the significance of E. L. Hampton in mining industry in Grundy County. The house was built in circa 1895 by E. L. Hampton, a ticket agent for the Nashville, Chattanooga and St. Louis Railroad. In April of 1904 E. L. Hampton leased the land holdings from TCI and organized the Tennessee Consolidated Coal Company. Although the TCC was often involved in major labor disputes with local miners, the company continued to operate until the 1960's. E. L. Hampton was the president of TCC and an important person in both the coal mining industry and in Tracy City. Hampton resided in this house until circa 1924 when it was sold to Mr. and Mrs. Fritz Baggenstoss. The period that Hampton resided in the house was an important and the most productive period of mining for T.C.C.

United States Department of the Interior  
National Park Service

National Register of Historic Places  
Inventory—Nomination Form

Historic Resources of

Continuation sheet Grundy County

Item number 10

Page 16

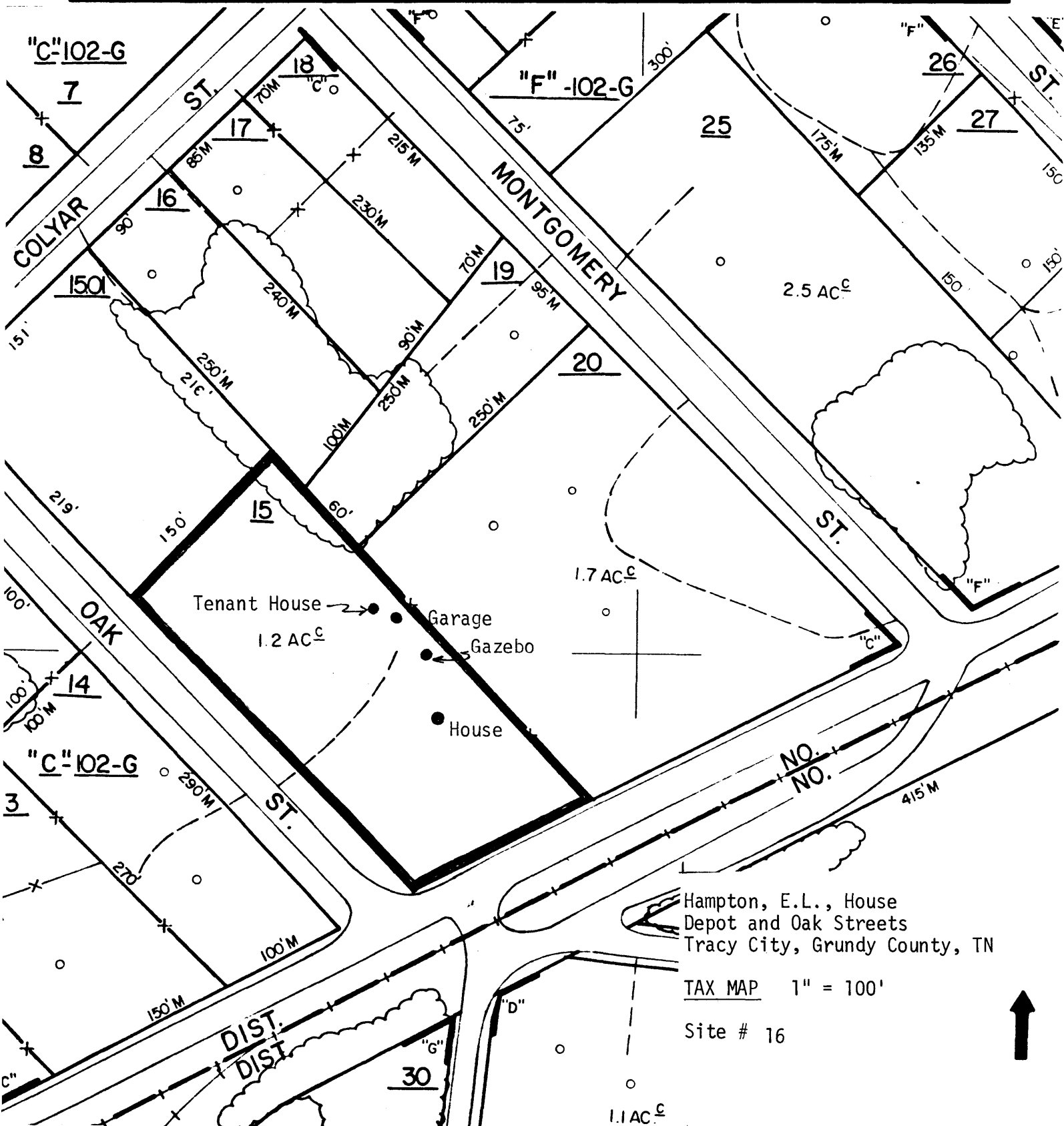

Hampton, E.L., House  
Depot and Oak Streets  
Tracy City, Grundy County, TN

TAX MAP 1" = 100'

Site # 16

