

United States Department of the Interior
National Park Service

RECEIVED

DEC 13 1993

NATIONAL REGISTER

National Register of Historic Places
Registration Form

This form is for use in nominating or requesting determinations for individual properties and districts. See instructions in *How to Complete the National Register of Historic Places Registration Form* (National Register Bulletin 16A). Complete each item by marking "x" in the appropriate box or by entering the information requested. If an item does not apply to the property being documented, enter "N/A" for "not applicable." For functions, architectural classification, materials, and areas of significance, enter only categories and subcategories from the instructions. Place additional entries and narrative items on continuation sheets (NPS Form 10-900a). Use a typewriter, word processor, or computer, to complete all items.

1. Name of Property

historic name Cooper House

other names/site number Hicks House; WD 230

2. Location

street & number N.S. Leestown Rd., 9/10 mi, E. of I-64 Midway Exit not for publication N/A

city or town Midway vicinity

state Kentucky code KY county Woodford code 239 zip code 40347

3. State/Federal Agency Certification

As the designated authority under the National Historic Preservation Act, as amended, I hereby certify that this nomination request for determination of eligibility meets the documentation standards for registering properties in the National Register of Historic Places and meets the procedural and professional requirements set forth in 36 CFR Part 60. In my opinion, the property meets does not meet the National Register criteria. I recommend that this property be considered significant nationally statewide locally. (See continuation sheet for additional comments.)

David M. Meyer SHPO/Ex. Director 11/18/93
Signature of certifying official/Title Date

State Historic Preservation Office/Kentucky Heritage Council
State of Federal agency and bureau

In my opinion, the property meets does not meet the National Register criteria. (See continuation sheet for additional comments.)

Signature of certifying official/Title Date

State or Federal agency and bureau

4. National Park Service Certification

I hereby certify that the property is:

- entered in the National Register. See continuation sheet.
- determined eligible for the National Register See continuation sheet.
- determined not eligible for the National Register.
- removed from the National Register.
- other, (explain): _____

for Signature of the Keeper

Gregory M. Rapley Entered in the National Register of Action 1/27/94

Cooper House
Name of Property

Woodford, Kentucky
County and State

5. Classification

Ownership of Property
(Check as many boxes as apply)

- private
- public-local
- public-State
- public-Federal

Category of Property
(Check only one box)

- building(s)
- district
- site
- structure
- object

Number of Resources within Property
(Do not include previously listed resources in the count.)

Contributing	Noncontributing	
3	0	buildings
		sites
1	1	structures
		objects
4	1	Total

Name of related multiple property listing
(Enter "N/A" if property is not part of a multiple property listing.)
Historic and Architectural Resources
of North West Woodford County, Kentucky

**Number of contributing resources previously listed
in the National Register**
0

6. Function or Use

Historic Functions
(Enter categories from instructions)

DOMESTIC / single dwelling

DOMESTIC / secondary structure

Current Functions
(Enter categories from instructions)

DOMESTIC / single dwelling

DOMESTIC / secondary structure

7. Description

Architectural Classification
(Enter categories from instructions)

LATE 19TH AND EARLY 20th CENTURY REVIVAL/
Classical Revival

LATE VICTORIAN / Queen Anne Revival

Materials
(Enter categories from instructions)

foundation STONE / Limestone

walls BRICK

roof ASPHALT

other _____

Narrative Description
(Describe the historic and current condition of the property on one or more continuation sheets.)

Cooper House
Name of Property

Woodford, Kentucky
County and State

8. Statement of Significance

Applicable National Register Criteria

(Mark "x" in one or more boxes for the criteria qualifying the property for National Register listing.)

- A** Property is associated with events that have made a significant contribution to the broad patterns of our history.
- B** Property is associated with the lives of persons significant in our past.
- C** Property embodies the distinctive characteristics of a type, period, or method of construction or represents the work of a master, or possesses high artistic values, or represents a significant and distinguishable entity whose components lack individual distinction.
- D** Property has yielded, or is likely to yield, information important in prehistory or history.

Criteria Considerations

(Mark "x" in all the boxes that apply.)

Property is:

- A** owned by a religious institution or used for religious purposes.
- B** removed from its original location.
- C** a birthplace or grave.
- D** a cemetery.
- E** a reconstructed building, object, or structure.
- F** a commemorative property.
- G** less than 50 years of age or achieved significance within the past 50 years.

Narrative Statement of Significance

(Explain the significance of the property on one or more continuation sheets.)

9. Major Bibliographical References

Bibliography

(Cite the books, articles, and other sources used in preparing this form on one or more continuation sheets.)

Previous documentation on file (NPS):

- preliminary determination of individual listing (36 CFR 67) has been requested
- previously listed in the National Register
- previously determined eligible by the National Register
- designated a National Historic Landmark
- recorded by Historic American Buildings Survey # _____
- recorded by Historic American Engineering Record # _____

Areas of Significance

(Enter categories from instructions)

ARCHITECTURE

Period of Significance

c. 1900-1920

Significant Dates

N/A

Significant Person.

(Complete if Criterion B is marked above)

N/A

Cultural Affiliation

N/A

Architect/Builder

Lacefield, Robert W. and Sons, builders

Primary location of additional data:

- State Historic Preservation Office
- Other State agency
- Federal agency
- Local government
- University
- Other

Name of repository:

Kentucky Heritage Council

Cooper House
Name of Property

Woodford, Kentucky
County and State

10. Geographical Data

Acreage of Property 4 acres

UTM References Midway, KY. 7.5 min. quad 1848
(Place additional UTM references on a continuation sheet.)

1

116	704780	4225000
Zone	Easting	Northing

2

Zone	Easting	Northing

3

Zone	Easting	Northing

4

Zone	Easting	Northing

 See continuation sheet

Verbal Boundary Description
(Describe the boundaries of the property on a continuation sheet.)

Boundary Justification
(Explain why the boundaries were selected on a continuation sheet.)

11. Form Prepared By

name/title Christine Amos, Historian
organization Burry & Amos, Inc. date December 1, 1992
street & number 926 Main Street telephone (502) 633-5530
city or town Shelbyville state Kentucky zip code 40065

Additional Documentation

Submit the following items with the completed form:

Continuation Sheets

Maps

- A **USGS map** (7.5 or 15 minute series) indicating the property's location.
- A **Sketch map** for historic districts and properties having large acreage or numerous resources.

Photographs

Representative **black and white photographs** of the property.

Additional Items

(Check with the SHPO or FPO for any additional items)

Property Owner

(Complete this item at the request of SHPO or FPO.)

name Parrishwood Farm c/o Mrs. Ruth Roach
street & number P.O. Box 327 telephone (606) 846-4419
city or town Midway state Kentucky zip code 40347

Paperwork Reduction Act Statement: This information is being collected for applications to the National Register of Historic Places to nominate properties for listing or determine eligibility for listing, to list properties, and to amend existing listings. Response to this request is required to obtain a benefit in accordance with the National Historic Preservation Act, as amended (16 U.S.C. 470 et seq.).

Estimated Burden Statement: Public reporting burden for this form is estimated to average 18.1 hours per response including time for reviewing instructions, gathering and maintaining data, and completing and reviewing the form. Direct comments regarding this burden estimate or any aspect of this form to the Chief, Administrative Services Division, National Park Service, P.O. Box 37127, Washington, DC 20013-7127; and the Office of Management and Budget, Paperwork Reductions Projects (1024-0018), Washington, DC 20503.

7. Written Narrative Description

The property is the residence and buildings of the domestic area for a 277 acre farm with traditional tobacco barns and agricultural buildings on a landscape that is utilized both for tobacco and hay as well as for raising Thoroughbred horses, the latter use a recent transformation. The nominated area contains three contributing buildings, one contributing structure and approximately four acres.

1. Main residence, contributing building, early 1900s. A two-story, brick masonry, turn-of-the-century, Classical Revival residence with asymmetrical facade and interior plan. The main original portion has large, single light sash with rusticated stone lintels and sills. The seven course common bond brick, originally red, is painted grey. The house rests on a random ashlar limestone foundation with raised mortar bed. The front has a wide, wrapping porch with dentilled frieze and stone Tuscan columns; an entry with 12 light door and projecting front gabled bay with returns. The asphalt shingled roof is a central hip with multi-gables extending over the projecting bays of the plan. The design details are mainly focused on material variety and pleasing proportions. The original red brick with limestone detail would have presented a lively, polychrome mass. To the rear elevations are a two-story frame addition to the east side (circa 1945) and a more recent, one-story frame addition to the rear with six light sash windows and a seamed metal roof.

2. Pool, non-contributing structure. A recently-built, in ground swimming pool to the east of the house.

3. Stone incinerator square, contributing structure, c.1910. Located in the rear yard area, measuring @ 10' square, a dry laid stone wall about 30" high with gated opening to the south side and exterior concrete mortar. The square was probably constructed about the time of the house and is used to burn trash.

4. Garage, contributing building, c.1920. A two-bay, board and batten, early 20th century frame garage with narrow clapboard in the gable ends, asphalt shingled gable roof, tongue and groove sliding bay doors and concrete perimeter foundation, 20'6" by 20'6".

5. Storage shed, contributing building, c. 1920. Located behind (N.) of the garage, a board and batten shed with asphalt shingled pyramidal hip roof with slightly flared extended eaves, concrete perimeter foundation, replacement sliding windows and entry in the east wall. The building measures 11'6" by 13'.

6. Stone frontage fence, contributing structure, c. 1910.

A mortared, random ashlar, quarried stone fence with coping separates the front yard area from the Leestown Road to the south.

8. Narrative Statement of Significance

The Cooper House is architecturally significant on a local level under Criteria C, as a good area example of early 20th century domestic architecture, a context developed in the North West Woodford County Multiple Property Document. The house is an atypical area example of early 20th century eclectic architecture that combines design and material details from both the Queen Anne and Classical Revival styles. New homes like this one presented innovative architectural ideas to an area whose long standing residential traditions included center passage plans and symmetrical fenestration. This area of Woodford County contains turn-of-the-century residences firmly rooted in the Queen Anne (Blackburn's Fort) and Classical and Colonial Revival styles (W.E. Simms House at Airdrie, Lucas Broadhead House, both nominated with this MPL). The Cooper House, however, is a successful, eclectic marriage of the two influences. The asymmetrical plan, multi-roof planes and fenestration patterns recall the Victorian, while the smooth brick finish and unadorned porch with stone Tuscan columns clearly suggest Revival influences. For this reason, the Cooper House is viewed as a significant architectural resource of the area.

The house was built about the turn-of-the-century for Henry Cooper by R.W. Lacefield and Sons, builders from Midway responsible for many barns and homes in this area of north Woodford County. Among other residences attributed to the Lacefields are the W.E. Simms house at Airdrie, the Davis house (both included in the Big Sink Rural Historic District), the mansion at Parrish Hill Farm in Midway (listed on the National Register), and the McKinnivan and Nugent houses at Wallace Station and Nugents Crossroad, (district nominated respectively as part of this MPL). Although built for Cooper, the farm is known locally as the Hicks Farm for its long association with that farming family.

9. Bibliographic References

Interview with Dr. and Mrs. Ben Roach, Midway, Kentucky, July, 1992.

10. Verbal Boundary Description

The boundary of the nominated area is delineated by a rectangle measuring 165' by 330' contained by the points A through D on the accompanying scaled site map. Point A begins at the north edge of Leestown Road and the yard fence boundary meeting point. The map is based on information found on the Woodford County Property Valuation Assessor map #48, parcel#6, which is the official location of the property.

Boundary Justification The boundary includes the domestic yard area immediately surrounding the residence and contains the buildings and structures that contribute to the property's historic significance and integrity. Although the residence is part of a larger farm with several historic agricultural buildings, the farm acreage has been renovated from a diversified farm to one supporting primarily Thoroughbred farming activities within the past twenty years.



COOPER HOUSE
BOUNDARY
(WD 230)

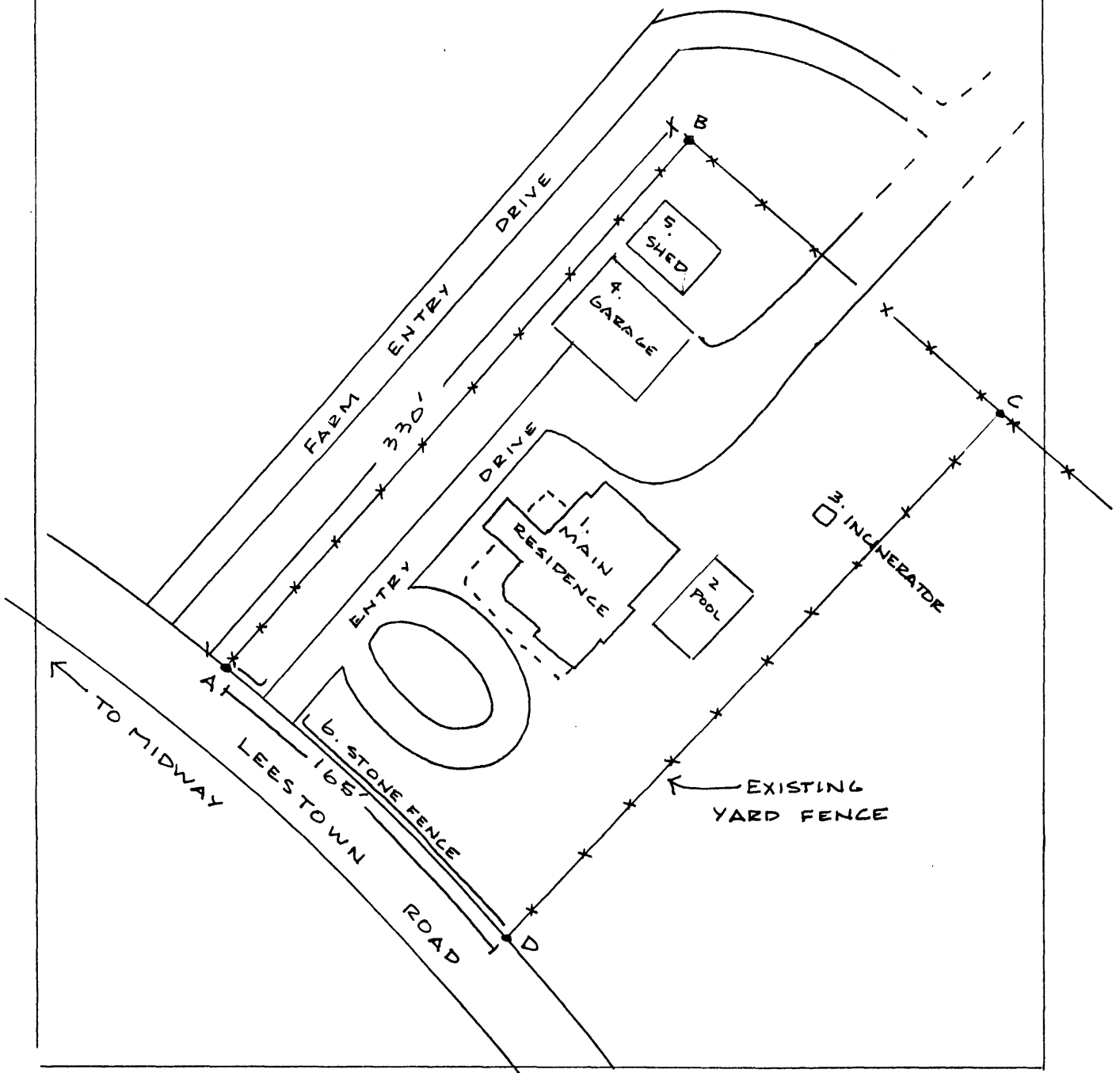

PHOTO LOG: Cooper House (Hicks House, WD 230)

Property location: Woodford County, Kentucky.

Photographer: Christine Amos

Date of photograph: 1992

Location of original negative: Kentucky Heritage Council,
Frankfort, Kentucky

1. Looking northeast to front (south) and west side of residence.
2. Looking northwest to front and east side of residence.
3. Looking southeast to garage and storage building (rear elevations).