

KENTUCKY HISTORIC RESOURCES INVENTORY

Site No. WSS-60

1. Historic Name(s) Johnson's Chapel AME Zion Church		22. ADD/County Lincoln Trail/Wash. 1115	
Original Owner		23. U.S.G.S. Quadrant (15'/75') Springfield G.I.S. Mod. 108	
2. Present Name As above		24. UTM Reference 16 657260 4172070	
3. Location S. sd. E. High St., Springfield, Ky		Zone Easting Northing	
4. Owner's Name Trustees, Johnson's Chapel		25. Coordinate Accuracy	
5. Owner's Address E. High St., Springfield, Ky. 40069		26. Prehistoric Site Object Historic Site Structure <u>Building</u> Other	
6. Open to Public Yes <u>X</u> No	7. Visible from road Yes <u>X</u> No	27. National Register District Name: N/A	
8. Ownership Private <u>X</u> Local State Federal		28. Significance Evaluation NR <u>N</u>	
9. Local Contact/Organization Owner		29. Status National Landmark National Register Landmark Certificate Kentucky Survey Local Landmark HABS/HAER	
10. Site Plan with North Arrow		30. Historic Theme Primary <u>Architecture</u> Secondary <u>Black His</u> Other	
	11. Architect		31. Endangered Yes No <u>X</u> 32. Preservation Project Status N/A Actual Cost in \$1,000s 33. ATTACH PHOTO
	12. Builder Wilse McElroy		
	13. Date 1872* A <u>4</u> B		
	14. Style A. Gothic Rev. <u>D</u> B.		
	15. Original Use Church <u>H</u>		
	16. Present use As above		
	17. Condition Good <u>B</u>		
18. Description 3 bay facade; extended entrance w/pyramidal roofed tower; stained glass window over door contains name HILL; windows E. and W. of tower closed; stained windows in bldg.		34. Prepared by: Joe DeSpain	
19. History The church was built in 1872 on a newly purchased lot on High Street by builder Wilse McElroy, who was a member. The church is a descendant of a pre-Civil War congregation, and is a focus of the Black community.		35. Organization Green Co. Hist. Soc., Inc.	
20. Significance The property is significant under criterion C, as an important example of late 19th c. Gothic arch. and under criterion A, as an important local black history		36. Date 25 Apr. 1983	
21. Source of Information site with important associations. *Cornerstone Mrs. Martha Davis, Interview, 25 Apr. 1983		37. Revision Dates 38. Staff Review	

(Continue on Back)

KENTUCKY HISTORIC RESOURCE INVENTORY SUPPLEMENT
BOUNDARY AND LOCATION INFORMATION

Historic Property Name Johnson's Chapel A.M.E. Zion Church Site # WSS-60

Multiple Resource/Thematic Nomination Title Washington County Multiple Resource Area

U.T.M. Coordinates - List multiple UTM's if property is ten or more acres.
16 657260 4172070

A. _____ D. _____

B. _____ E. _____

C. _____ F. _____

Verbal Boundary Description

Acreage less than one acre

The boundaries correspond to town lot R6-9. Beginning at point A on the south side of High Street proceed south 150 feet to point B, thence west 100 feet to point C, thence north 150 feet to point D, thence east 100 feet to the point of origin. The boundaries were chosen to include the church and its immediate site. The property includes one contributing and no noncontributing buildings.

Sketch of Site Plan (Showing outbuildings, structures, landscape features and the site boundary as described above.)

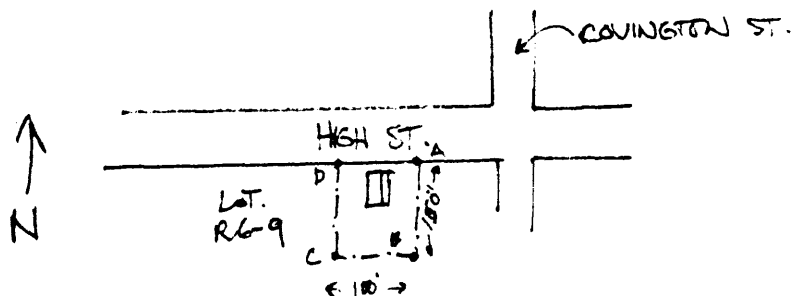

Official Courthouse Property Reference:

Washington County Courthouse, Springfield, Kentucky