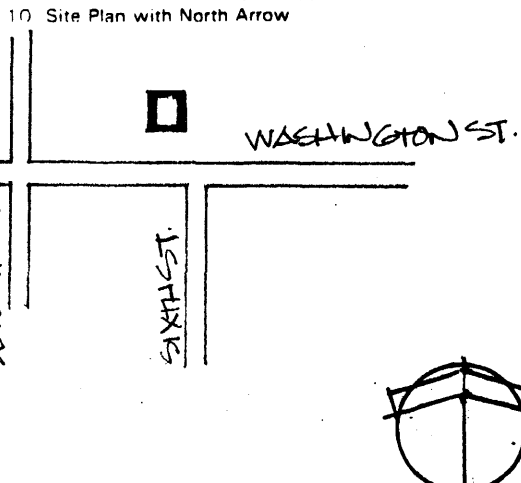
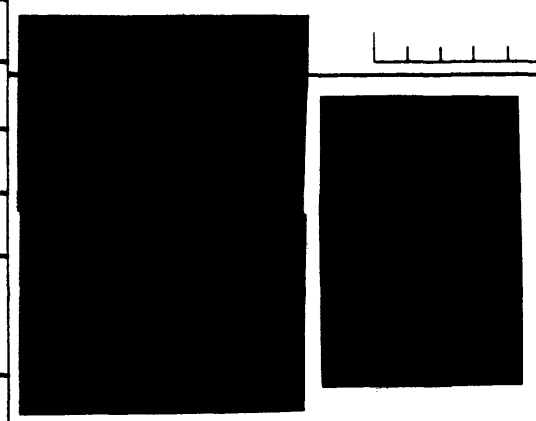

KENTUCKY HISTORIC RESOURCES INVENTORY

Site No. Sh - S 12

1. Historic Name(s) <b>Tevis Cottage</b> Original Owner <b>Julia Ann H. Tevis</b>		22. ADD/County <b>KIPDA / SHELBY</b> <span style="border: 1px solid black; padding: 2px;">106</span>	
2. Present Name <b>Tevis Cottage</b>		23. U.S.G.S. Quadrant (15'/75') <b>SHELBYVILLE</b> <span style="border: 1px solid black; padding: 2px;">  </span>	
3. Location <b>607 Washington St., Shelbyville, Ky. 40065</b>		24. UTM Reference <span style="border: 1px solid black; padding: 2px;">16</span> <span style="border: 1px solid black; padding: 2px;">656080</span> <span style="border: 1px solid black; padding: 2px;">4230640</span> Zone Easting Northing	
4. Owner's Name <b>Mark J. Scarce</b>		25. Coordinate Accuracy <span style="border: 1px solid black; padding: 2px;">  </span>	
5. Owner's Address <b>610 Magnolia St. Shelbyville, Ky. 40065</b>		26. Prehistoric Site Object Historic Site Structure <input checked="" type="checkbox"/> Building Other	
6. Open to Public Yes <input type="checkbox"/> No <input type="checkbox"/>	7. Visible from road Yes <input checked="" type="checkbox"/> No <input type="checkbox"/>	8. Ownership Private <input type="checkbox"/> Local <input type="checkbox"/> State <input type="checkbox"/> Federal <input type="checkbox"/>	
9. Local Contact/Organization <b>SHELBY COUNTY HISTORICAL SOCIETY</b>		27. National Register District Name: <b>MULTIPLE RESOURCES OF SHELBYVILLE</b> <span style="border: 1px solid black; padding: 2px;">  </span>	
10. Site Plan with North Arrow 		28. Significance Evaluation <b>National Register</b> <span style="border: 1px solid black; padding: 2px;">  </span>	
11. Architect		29. Status <span style="border: 1px solid black; padding: 2px;">  </span> Date	
12. Builder		National Landmark <input type="checkbox"/> National Register <input type="checkbox"/> Landmark Certificate <input type="checkbox"/> Kentucky Survey <input type="checkbox"/> Local Landmark <input type="checkbox"/> HABS/HAER <input type="checkbox"/>	
13. Date <b>1830 ; 1920 A. <span style="border: 1px solid black; padding: 2px;">2</span> B. <span style="border: 1px solid black; padding: 2px;">6</span></b>		30. Historic Theme Primary <input type="checkbox"/> Secondary <input type="checkbox"/> Other <input type="checkbox"/>	
14. Style A. Federal <input checked="" type="checkbox"/> <span style="border: 1px solid black; padding: 2px;">B</span> B. Classical Rev. <input type="checkbox"/>		31. Endangered Yes <input type="checkbox"/> No <input type="checkbox"/>	
15. Original Use <b>S.F. Residence</b> <span style="border: 1px solid black; padding: 2px;">A</span>		32. Preservation Project Status <span style="border: 1px solid black; padding: 2px;">  </span>	
16. Present use <b>Same</b>			
17. Condition <b>Good</b> <span style="border: 1px solid black; padding: 2px;">B</span>			
No. Stories <b>1 1/2</b> <span style="border: 1px solid black; padding: 2px;">B</span>			
Single Pile <input type="checkbox"/> NA <input type="checkbox"/> Double Pile <input checked="" type="checkbox"/>			
Floor Plan <b>Central Hall D.P.</b> <span style="border: 1px solid black; padding: 2px;">K</span>			
Structural Fabric <b>Log; Frame</b> A. <span style="border: 1px solid black; padding: 2px;">B</span> B. <span style="border: 1px solid black; padding: 2px;">D</span>		A. <input type="checkbox"/> B. <input type="checkbox"/>	
Decorative Fabric A. <input type="checkbox"/> B. <input type="checkbox"/>		Roof Form <b>Gable</b>	
19. Description <b>1 1/2 story, 3 bay; 2 exterior end chimneys, step-shouldered; pedimented porch of wooden piers; palladian motif window in dormer from 20th century; log core; windows enlarged</b>		Roll No. <b>7: 9, 10, 11</b> Picture No. _____ Direction _____	
(Continue on Back)		34. Prepared by: <b>Helen Powell</b> <span style="float: right;">KTG/KHC 1979</span>	
20. Significance <b>The floorplan of the Tevis Cottage includes the log core of a house from the early settlement of Shelbyville. The house also embodies the characteristics of the local variations on the Classical Revival style.</b>		35. Organization <b>CARMAN AND POWELL, INC.</b>	
21. Source of Information <b>Frances Cottongim</b>		36. Date <b>1983</b>	
		37. Revision Dates _____ 38. Staff Review _____	

KENTUCKY HISTORIC RESOURCE INVENTORY SUPPLEMENT  
BOUNDARY AND LOCATION INFORMATION

Historic Property Name Tevis Cottage Site # SH-S-12  
Multiple Resource/Thematic Nomination Title Multiple Resources of Shelbyville

U.T.M. Coordinates - List multiple UTM's if property is ten or more acres.

A. 16 656080 4230640 D. \_\_\_\_\_  
B. \_\_\_\_\_ E. \_\_\_\_\_  
C. \_\_\_\_\_ F. \_\_\_\_\_

Verbal Boundary Description Acreage less than 1/2 acre

From a point in the northeast corner of the intersection of Washington and Seventh St., 250 feet east to a point of beginning; then north 80 feet to a point; then east 60 feet to a point; then south 80 feet to a point; then 60 feet west to the point of beginning.

Sketch of Site Plan (Showing outbuildings, structures, landscape features and the site boundary as described above.)

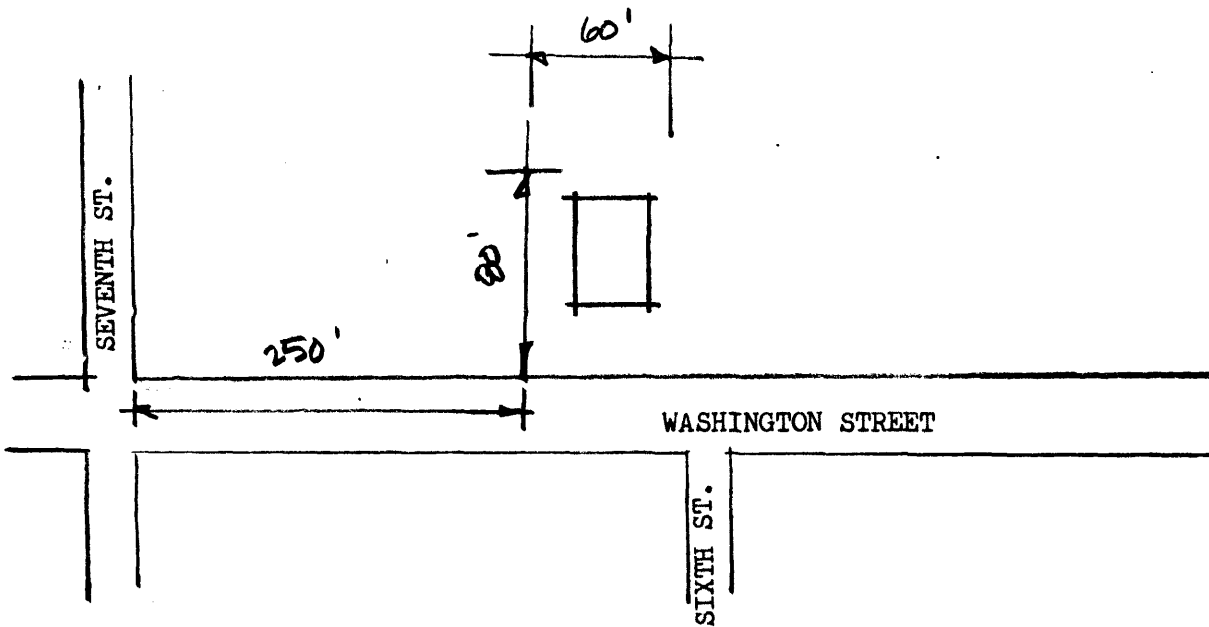

Official Courthouse Property Reference: