

UNITED STATES DEPARTMENT OF THE INTERIOR
 NATIONAL PARK SERVICE
NATIONAL REGISTER OF HISTORIC PLACES
INVENTORY -- NOMINATION FORM
 FOR FEDERAL PROPERTIES

FOR NPS USE ONLY
 RECEIVED **OCT 31 1985**
 DATE ENTERED **DEC 12 1985**

SEE INSTRUCTIONS IN *HOW TO COMPLETE NATIONAL REGISTER FORMS*
 TYPE ALL ENTRIES -- COMPLETE APPLICABLE SECTIONS

1 NAME

HISTORIC

United States Post Office

AND/OR COMMON

Ansonia Main Post Office

2 LOCATION

STREET & NUMBER

237 Main Street

N/A NOT FOR PUBLICATION

CITY, TOWN

Ansonia

N/A VICINITY OF

CONGRESSIONAL DISTRICT

Fifth Congressional District

STATE

Connecticut 06401

CODE

0010

COUNTY

New Haven

CODE

009

2 CLASSIFICATION

CATEGORY

- DISTRICT
- BUILDING(S)
- STRUCTURE
- SITE
- OBJECT

OWNERSHIP

- PUBLIC
- PRIVATE
- BOTH
- PUBLIC ACQUISITION**
- N/A IN PROCESS
- BEING CONSIDERED

STATUS

- OCCUPIED
- UNOCCUPIED
- WORK IN PROGRESS
- ACCESSIBLE**
- YES: RESTRICTED
- YES: UNRESTRICTED
- NO

PRESENT USE

- AGRICULTURE
- COMMERICAL
- EDUCATIONAL
- ENTERTAINMENT
- GOVERNMENT
- INDUSTRIAL
- MILITARY
- MUSEUM
- PARK
- PRIVATE RESIDENCE
- RELIGIOUS
- SCIENTIFIC
- TRANSPORTATION
- OTHER

4 AGENCY

REGIONAL HEADQUARTERS: *(If applicable)*

New England Real Estate and Buildings Office

STREET & NUMBER

1050 Waltham Street

CITY, TOWN

Lexington

N/A VICINITY OF

STATE

Massachusetts 02173

5 LOCATION OF LEGAL DESCRIPTION

COURTHOUSE,
 REGISTRY OF DEEDS, ETC.

City Hall - Town and City Clerks' Office

STREET & NUMBER

253 Main Street

CITY, TOWN

Ansonia

STATE

Connecticut 06401

6 REPRESENTATION IN EXISTING SURVEYS

TITLE

None

DATE

FEDERAL STATE COUNTY LOCAL

DEPOSITORY FOR
 SURVEY RECORDS

CITY, TOWN

STATE

7 DESCRIPTION

CONDITION		CHECK ONE	CHECK ONE
<input type="checkbox"/> EXCELLENT	<input type="checkbox"/> DETERIORATED	<input type="checkbox"/> UNALTERED	<input checked="" type="checkbox"/> ORIGINAL SITE
<input checked="" type="checkbox"/> GOOD (exterior)	<input type="checkbox"/> RUINS	<input checked="" type="checkbox"/> ALTERED	<input type="checkbox"/> MOVED DATE _____
<input checked="" type="checkbox"/> FAIR (interior)	<input type="checkbox"/> UNEXPOSED		

DESCRIBE THE PRESENT AND ORIGINAL (IF KNOWN) PHYSICAL APPEARANCE

The Post Office is located in the heart of the commercial district, an area of high building density. The site, which is in very good condition, has small landscaped areas featuring low formal plantings that enhance the classical symmetry of the main entrance. The building sits on a concrete foundation, with reinforced concrete first floor framing, masonry bearing walls and steel roof framing.

The building features moderately restrained classical detailing, executed completely in smooth limestone. The recessed portico is defined with four ionic columns, is flanked by flat pilaster framed panels and contains a pair of large 6/6 windows and transomed entrance doors. A newer aluminum and glass projecting vestibule mars the otherwise excellent architectural impact of the street elevation. A denticulated cornice surrounds the entire building, and is capped with a low parapet wall. The roof is a low hip design clad in standing seam metal roofing. A loading platform addition to the rear is faced in buff-colored brick. The exterior walls have recently been cleaned and are in excellent condition; however, there does appear to be some roof leakage.

The lobby, which has white terrazzo floors, white marble wainscot, and plaster walls and moulded ceiling, has been reduced in size and has lost some original trim and marble and the original wood vestibule as well.

8 SIGNIFICANCE

PERIOD		AREAS OF SIGNIFICANCE -- CHECK AND JUSTIFY BELOW				
<input type="checkbox"/> PREHISTORIC	<input type="checkbox"/> ARCHEOLOGY-PREHISTORIC	<input type="checkbox"/> COMMUNITY PLANNING	<input type="checkbox"/> LANDSCAPE ARCHITECTURE	<input type="checkbox"/> RELIGION		
<input type="checkbox"/> 1400-1499	<input type="checkbox"/> ARCHEOLOGY-HISTORIC	<input type="checkbox"/> CONSERVATION	<input type="checkbox"/> LAW	<input type="checkbox"/> SCIENCE		
<input type="checkbox"/> 1500-1599	<input type="checkbox"/> AGRICULTURE	<input type="checkbox"/> ECONOMICS	<input type="checkbox"/> LITERATURE	<input type="checkbox"/> SCULPTURE		
<input type="checkbox"/> 1600-1699	<input checked="" type="checkbox"/> ARCHITECTURE	<input type="checkbox"/> EDUCATION	<input type="checkbox"/> MILITARY	<input type="checkbox"/> SOCIAL/HUMANITARIAN		
<input type="checkbox"/> 1700-1799	<input type="checkbox"/> ART	<input type="checkbox"/> ENGINEERING	<input type="checkbox"/> MUSIC	<input type="checkbox"/> THEATER		
<input type="checkbox"/> 1800-1899	<input type="checkbox"/> COMMERCE	<input type="checkbox"/> EXPLORATION/SETTLEMENT	<input type="checkbox"/> PHILOSOPHY	<input type="checkbox"/> TRANSPORTATION		
<input checked="" type="checkbox"/> 1900-	<input type="checkbox"/> COMMUNICATIONS	<input type="checkbox"/> INDUSTRY	<input type="checkbox"/> POLITICS/GOVERNMENT	<input type="checkbox"/> OTHER (SPECIFY)		
		<input type="checkbox"/> INVENTION				

SPECIFIC DATES	Designed: 1913		BUILDER/ARCHITECT	Oscar Wenderoth, Supervising Architect-U.S. Treasury Department
	Built: 1914	Addition: 1947		

STATEMENT OF SIGNIFICANCE

The original Post Office building was designed in 1913 and built in 1914 by Oscar Wenderoth, the Supervising Architect of the Treasury. He served in that position for only two years (1913-1914) succeeding James Knox Taylor. Wenderoth's architecture is similar to Taylor's characteristically employing Renaissance Revival stylistic details including arcaded loggias, the use of ornament, symmetry and fine materials. The post offices designed during Wenderoth's administration brought the ideals of the Beaux-Arts movement to small cities and towns. This building was only one of forty (40) buildings designed in 1913 throughout the United States.

The building is an excellent example of restrained Classical Revival architecture. It imparts qualities of solidity, security and timelessness, supportive of the Federal Government's image in the community. It is the foremost example of architecture in Ansonia. Unlike most structures on this section of Main Street, the building is set back from the curb, framing a small formal public space important to the streetscape.

9 MAJOR BIBLIOGRAPHICAL REFERENCES

History of Post Office Construction 1900-1940, July, 1982

Craig, Lois, ed., The Federal Presence: Architecture, Politics and Symbols in the United States Government Building, Cambridge, Massachusetts: The MIT Press, 1979

10 GEOGRAPHICAL DATA

ACREAGE OF NOMINATED PROPERTY .75

UTM REFERENCES

A	1 8	6 6 0 7 5 0	4 5 7 8 4 2 0	B			
	ZONE	EASTING	NORTHING		ZONE	EASTING	NORTHING
C				D			

VERBAL BOUNDARY DESCRIPTION

The Post Office is located in the heart of the commercial district. The site has 83 feet of frontage on Main Street and the lot is 232 feet deep. The site is totally occupied by the Post Office building, loading docks and parking.

The building is bordered by a one-story commercial building and a three-story commercial building.

LIST ALL STATES AND COUNTIES FOR PROPERTIES OVERLAPPING STATE OR COUNTY BOUNDARIES

STATE	CODE	COUNTY	CODE
STATE	CODE	COUNTY	CODE

11 FORM PREPARED BY

NAME / TITLE

Richard P. DeCoste, Architect

ORGANIZATION

SULLIVAN DESIGN GROUP, INC.

DATE

July 17, 1985

STREET & NUMBER

44 Adams Street

TELEPHONE

(617) 848-1545

CITY OR TOWN

Braintree

STATE

Massachusetts 02184

12 CERTIFICATION OF NOMINATION

STATE HISTORIC PRESERVATION OFFICER RECOMMENDATION

YES

NO

NONE

[Signature]
STATE HISTORIC PRESERVATION OFFICER SIGNATURE

In compliance with Executive Order 11593, I hereby nominate this property to the National Register, certifying that the State Historic Preservation Officer has been allowed 90 days in which to present the nomination to the State Review Board and to evaluate its significance. The evaluated level of significance is ___ National ___ State Local.

FEDERAL REPRESENTATIVE SIGNATURE

TITLE

[Signature]

Director, Office of Real Estate

DATE

October 28, 1985

FOR NPS USE ONLY

I HEREBY CERTIFY THAT THIS PROPERTY IS INCLUDED IN THE NATIONAL REGISTER

[Signature]
DIRECTOR, OFFICE OF ARCHEOLOGY AND HISTORIC PRESERVATION

DATE

12/12/85

[Signature]
KEEPER OF THE NATIONAL REGISTER

DATE

12/11/85

Kingston Drive

Parking

- 1. Portico
- 2. Public Lobby
- 3. Originally part of lobby
- 4. Postmaster
- 5. Work Room
- 6. Platform (1947 Addition)
- 7. Platform (1957 Addition)

1 story commerical building

232'

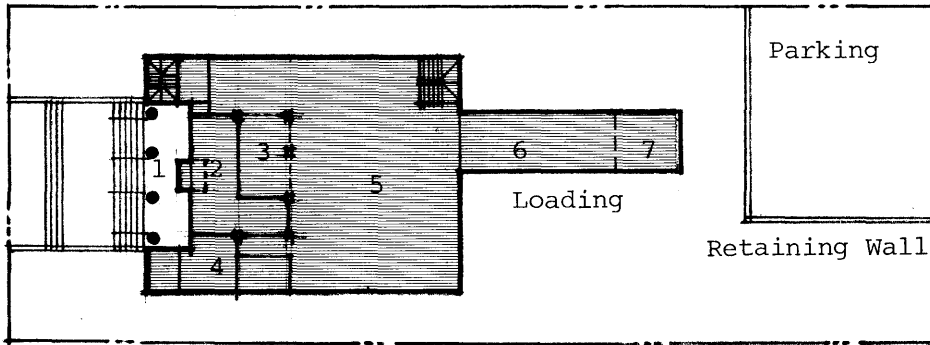

3 story older commercial building modern-front

Victorian Ansonia City Hall

1-2- & 3 Story Older Commercial Buildings

