

UNITED STATES DEPARTMENT OF THE INTERIOR
NATIONAL PARK SERVICE

FOR NPS USE ONLY
RECEIVED MAY 18 1984
DATE ENTERED JUN 14 1984

NATIONAL REGISTER OF HISTORIC PLACES
INVENTORY -- NOMINATION FORM

SEE INSTRUCTIONS IN HOW TO COMPLETE NATIONAL REGISTER FORMS
TYPE ALL ENTRIES -- COMPLETE APPLICABLE SECTIONS

1 NAME

HISTORIC Captain John Jeffries Burial Marker
AND/OR COMMON

LOCATION

STREET & NUMBER Palistine Bible Church Cemetery, Rt. 559 N/A NOT FOR PUBLICATION
CITY, TOWN Egg Harbor Township Somers Point Vic. CONGRESSIONAL DISTRICT
STATE New Jersey 034 CODE COUNTY Atlantic CODE 001

CLASSIFICATION

CATEGORY	OWNERSHIP	STATUS	PRESENT USE
<input type="checkbox"/> DISTRICT	<input type="checkbox"/> PUBLIC	<input checked="" type="checkbox"/> OCCUPIED	<input type="checkbox"/> AGRICULTURE <input type="checkbox"/> MUSEUM
<input type="checkbox"/> BUILDING(S)	<input checked="" type="checkbox"/> PRIVATE	<input type="checkbox"/> UNOCCUPIED	<input type="checkbox"/> COMMERCIAL <input type="checkbox"/> PARK
<input type="checkbox"/> STRUCTURE	<input type="checkbox"/> BOTH	<input type="checkbox"/> WORK IN PROGRESS	<input type="checkbox"/> EDUCATIONAL <input type="checkbox"/> PRIVATE RESIDENCE
<input type="checkbox"/> SITE	PUBLIC ACQUISITION	ACCESSIBLE	<input type="checkbox"/> ENTERTAINMENT <input type="checkbox"/> RELIGIOUS
<input checked="" type="checkbox"/> OBJECT	<input type="checkbox"/> IN PROCESS	<input type="checkbox"/> YES: RESTRICTED	<input type="checkbox"/> GOVERNMENT <input type="checkbox"/> SCIENTIFIC
	<input type="checkbox"/> BEING CONSIDERED	<input checked="" type="checkbox"/> YES: UNRESTRICTED	<input type="checkbox"/> INDUSTRIAL <input type="checkbox"/> TRANSPORTATION
	<u>N/A</u>	<input type="checkbox"/> NO	<input checked="" type="checkbox"/> OTHER: <u>grave marker</u>

OWNER OF PROPERTY

NAME Trustees of Palistine Bible Church
STREET & NUMBER Mays Landing - Somers Point Road
CITY, TOWN Mays Landing VICINITY OF STATE New Jersey 08330

LOCATION OF LEGAL DESCRIPTION

COURTHOUSE, REGISTRY OF DEEDS, ETC. Atlantic County Courthouse
STREET & NUMBER
CITY, TOWN Mays Landing STATE New Jersey

6 REPRESENTATION IN EXISTING SURVEYS

TITLE Survey of Cultural Resources of the Historic Era in the Watersheds of the Great Egg Harbor and Tuckahoe Rivers (#0108-30)
DATE 1981 FEDERAL STATE COUNTY LOCAL
DEPOSITORY FOR SURVEY RECORDS New Jersey Office of Cultural and Environmental Services
109 West State Street
CITY, TOWN Trenton STATE New Jersey

7 DESCRIPTION

CONDITION		CHECK ONE	CHECK ONE
<input type="checkbox"/> EXCELLENT	<input type="checkbox"/> DETERIORATED	<input checked="" type="checkbox"/> UNALTERED	<input checked="" type="checkbox"/> ORIGINAL SITE
<input checked="" type="checkbox"/> GOOD	<input type="checkbox"/> RUINS	<input type="checkbox"/> ALTERED	<input type="checkbox"/> MOVED DATE _____
<input type="checkbox"/> FAIR	<input type="checkbox"/> UNEXPOSED		

DESCRIBE THE PRESENT AND ORIGINAL (IF KNOWN) PHYSICAL APPEARANCE

The Captain John Jeffries Burial Marker is a marble gravestone standing approximately twelve feet tall. Resting on a base measuring about 4' x 4' is the central block which features a shallow bas-relief of the ship "21 FRIENDS" and is inscribed: "Captain John Jeffries/Born Nov. 15, 1829/Died March 17, 1887/A member of the K. of P.". Above this block is a smaller square element in which the initials "J.J." are carved, surrounded by olive/ivy branches. The finial of the burial marker is a three-dimensional draped urn.

The gravestone is located in the cemetery of the Palestine Bible Church, in which it is the most prominent burial marker. Nearby are other members of the Jeffries family.

8 SIGNIFICANCE

PERIOD	AREAS OF SIGNIFICANCE -- CHECK AND JUSTIFY BELOW			
<input type="checkbox"/> PREHISTORIC	<input type="checkbox"/> ARCHEOLOGY-PREHISTORIC	<input type="checkbox"/> COMMUNITY PLANNING	<input type="checkbox"/> LANDSCAPE ARCHITECTURE	<input type="checkbox"/> RELIGION
<input type="checkbox"/> 1400-1499	<input type="checkbox"/> ARCHEOLOGY-HISTORIC	<input type="checkbox"/> CONSERVATION	<input type="checkbox"/> LAW	<input type="checkbox"/> SCIENCE
<input type="checkbox"/> 1500-1599	<input type="checkbox"/> AGRICULTURE	<input type="checkbox"/> ECONOMICS	<input type="checkbox"/> LITERATURE	<input type="checkbox"/> SCULPTURE
<input type="checkbox"/> 1600-1699	<input type="checkbox"/> ARCHITECTURE	<input type="checkbox"/> EDUCATION	<input type="checkbox"/> MILITARY	<input type="checkbox"/> SOCIAL/HUMANITARIAN
<input type="checkbox"/> 1700-1799	<input type="checkbox"/> ART	<input type="checkbox"/> ENGINEERING	<input type="checkbox"/> MUSIC	<input type="checkbox"/> THEATER
<input checked="" type="checkbox"/> 1800-1899	<input checked="" type="checkbox"/> COMMERCE	<input type="checkbox"/> EXPLORATION/SETTLEMENT	<input type="checkbox"/> PHILOSOPHY	<input type="checkbox"/> TRANSPORTATION
<input type="checkbox"/> 1900-	<input type="checkbox"/> COMMUNICATIONS	<input type="checkbox"/> INDUSTRY	<input type="checkbox"/> POLITICS/GOVERNMENT	<input type="checkbox"/> OTHER (SPECIFY)
		<input type="checkbox"/> INVENTION		

SPECIFIC DATES 1887

BUILDER/ARCHITECT

STATEMENT OF SIGNIFICANCE

The Captain John Jeffries Burial Marker is one of the few tangible remnants of the once-thriving shipping and shipbuilding industries in the Great Egg Harbor basin. Because of the paucity of other artifacts relating to this era, the marker represents not just the grave of one man; rather, it addresses two related industries, the people who caused them to prosper, and the calamities which could alter their intertwined lives.

Shipbuilding and shipping in and from the Great Egg Harbor area were facilitated by the area's natural resources: several tributaries of the Great Egg Harbor Bay provide numerous sheltered landing sites adequate to the launching and landing of ships of moderate size, and nearby pine forests and furnaces and forges produced bog iron and forest products. These were useful both as shipbuilding materials and as goods to be transported to coastal markets.

Mays Landing, farther upstream on the Great Egg Harbor River, was the site of shipbuilding activity as early as 1767. About half of the 200 wooden ships built in Atlantic County came from its many yards, one of which was run by Captain Samuel Gaskill. He was in business by 1868, and in 1872 built the three-masted schooner "21 FRIENDS". In 1885 he built the last wooden ship to come out of Mays Landing.

John Jeffries, of English Creek, was born in 1829. His family was undoubtedly related to those who gave their name to Jeffers (or Jeffries') Landing, in existence as Great Egg Harbor Landing by 1775. In 1819 a John Jeffreys was named wharfmaster.

The "21 FRIENDS" was built for John Jeffries (whose stone is the subject of this nomination), and later became well known on both sides of the Atlantic. On a voyage from the south, loaded with lumber, it collided with the schooner "JOHN D. MAY", and was damaged seriously enough to warrant its abandonment. However, it did not sink, and, left to the caprices of wind and current, drifted across the ocean twice. It was sighted and its location noted several times, finally coming ashore in Ireland two years after the supposedly fatal collision. It is a testament to Samuel Gaskill's talents as a shipbuilder that after this period of abuse by the elements, the cargo was salvaged and the "21 FRIENDS" put into service as a fishing vessel.

The story of the ship's travels was of sufficient local significance that it was referenced on Jeffrie's tombstone, erected after his death in 1887 at the age of 57.

SKETCH PLAN OF
CAPTAIN JOHN JEFFRIES BURIAL MARKER
EGG HARBOR TWP, ATLANTIC CO., NJ

NO SCALE

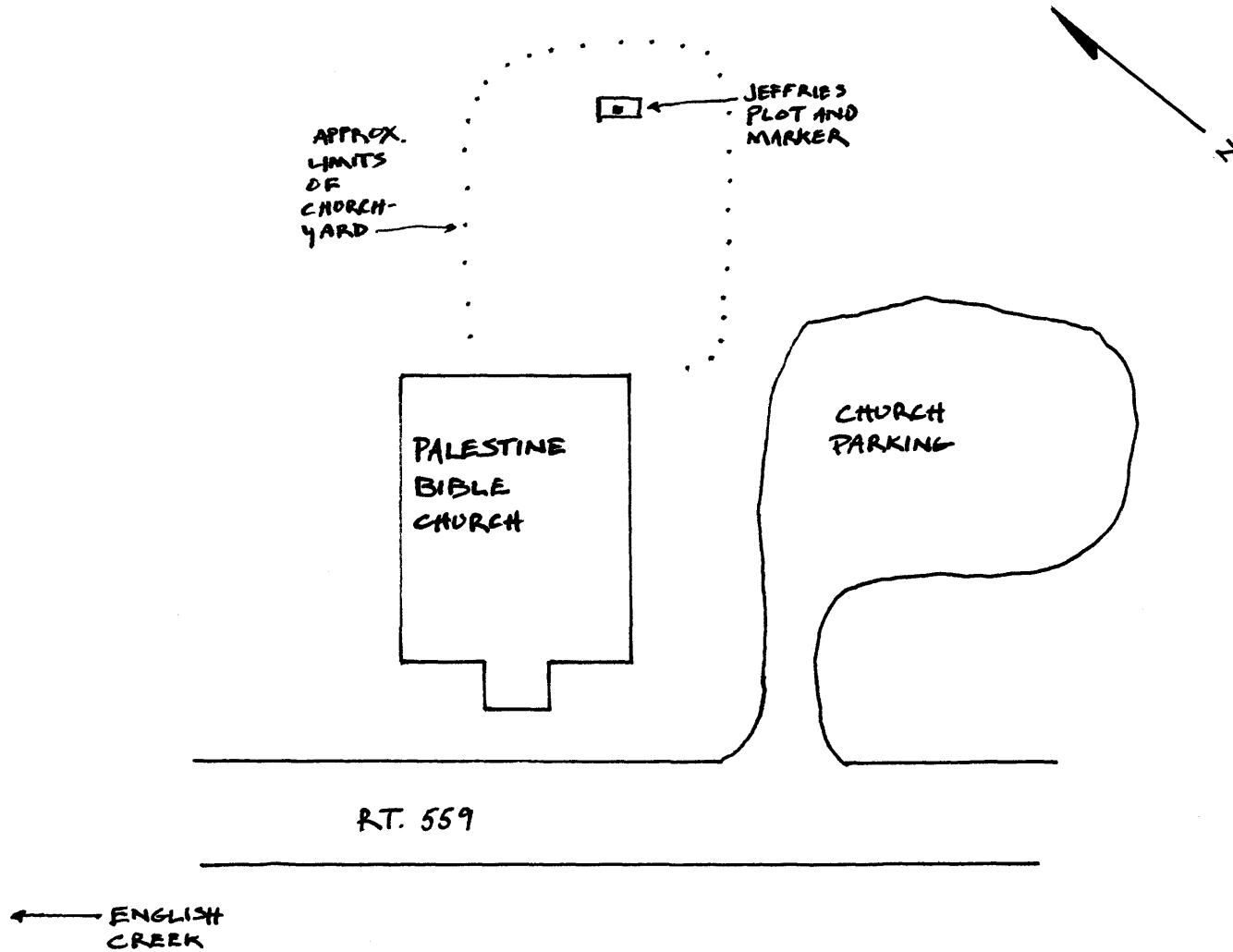

Captain John Jeffries Burial Marker, Egg Harbor Township, Atlantic County

(Act No. 338)

CERTIFICATE OF ENROLMENT

No. 2

Schooner

OF THE

Called the Twenty five Friends

210 15/100 Tons

ISSUED AT THE

Port of Somers Point

District of Kent Co. N. H.

July 22 1882

Israel S. Adams
Collector of Customs

DATE OF SURRENDER:

Sept 14 1888

WHERE SURRENDERED:

Somers Point

CAUSE OF SURRENDER:

Ward Total loss

James Tilton

Collector of Customs.



2490

Permanent

Certificate No. *3* Copies transmitted in place of lost document

OFFICIAL NUMBER.
NUMERALS. LETTERS.
94906 J.L.H.

THE UNITED STATES OF AMERICA.

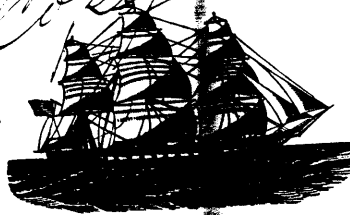

Sec. 4319, Rev. Stats.

Catalogue No. 538.

CERTIFICATE OF ENROLLMENT.

ENROLLMENT. In conformity to Title L, "REGULATION OF VESSELS IN DOMESTIC COMMERCE," of the Revised Statutes of the United States,

John Jeffers of Atlantic Co. State of New Jersey
having taken and subscribed the *Oath* required by law, and having *Sworn* that, he *3/32*
together with his said associates *1/32* *Richard D. Gault*
3/32 *John B. Chapman 1/32* *David P. Smith 1/32* *James Schenk 1/32* *William H. Wood 1/32*
Joseph A. Borge 1/32 *Warren G. B. 1/32* *Robert Chapman 1/32* *James*
John B. Chapman 1/32 *John B. Chapman 1/32* *John B. Chapman 1/32* *John B. Chapman 1/32*
Joseph Deane 1/32 *and Benjamin F. Lee 1/32* *of New Jersey* *Benjamin F. Lee 1/32*
George Taylor 1/16 *Joseph B. Taylor 1/16* *Wm. A. H. Taylor 1/16* *and R. R. Humphrey*
1/32 *D. Phila. Jan. and George Stone 1/32* *of Salem Mass. and Me.*

ship or vessel called the *Twenty one Friends*, citizen of the United States, and sole owner of the
John D. Barrett, of *Somers Point*, whereof
is at present Master, and is a citizen of the
United States, and that the said ship or vessel was built at *Marx Landing N. J.*
in the year *1872* as appears by *Deed No. 34*
June 25, 1881 *from business records changed in 1881*
and the said enrollment

