

PH0013242

NATIONAL REGISTER OF HISTORIC PLACES
INVENTORY - NOMINATION FORM

(Type all entries - complete applicable sections)

STATE: Georgia	
COUNTY: Thomas	
FOR NPS USE ONLY	
ENTRY NUMBER	DATE
70-8-10-0042	8/12/70

1. NAME

COMMON:

AND/OR HISTORIC:
Wright House

2. LOCATION

STREET AND NUMBER:
415 Fletcher Street

CITY OR TOWN:
Thomasville

STATE Georgia	CODE 10	COUNTY: Thomas	CODE 275
-------------------------	-------------------	--------------------------	--------------------

3. CLASSIFICATION

CATEGORY (Check One)	OWNERSHIP	STATUS	ACCESSIBLE TO THE PUBLIC
District <input type="checkbox"/> Building <input checked="" type="checkbox"/>	Public <input type="checkbox"/> Private <input checked="" type="checkbox"/> Both <input type="checkbox"/>	Occupied <input checked="" type="checkbox"/> Unoccupied <input type="checkbox"/> Preservation work in progress <input checked="" type="checkbox"/>	Yes: Restricted <input type="checkbox"/> Unrestricted <input type="checkbox"/> No: <input checked="" type="checkbox"/>
Site <input type="checkbox"/> Object <input type="checkbox"/>	Public Acquisition: In Process <input type="checkbox"/> Being Considered <input type="checkbox"/>		

PRESENT USE (Check One or More as Appropriate)

Agricultural <input type="checkbox"/>	Government <input type="checkbox"/>	Park <input type="checkbox"/>	Transportation <input type="checkbox"/>	Comments <input type="checkbox"/>
Commercial <input type="checkbox"/>	Industrial <input type="checkbox"/>	Private Residence <input checked="" type="checkbox"/>	Other (Specify) <input type="checkbox"/>	
Educational <input type="checkbox"/>	Military <input type="checkbox"/>	Religious <input type="checkbox"/>		
Entertainment <input type="checkbox"/>	Museum <input type="checkbox"/>	Scientific <input type="checkbox"/>		

4. OWNER OF PROPERTY

OWNERS NAME:
Miss Julia Wright - For Sale

STREET AND NUMBER:
Same as above

CITY OR TOWN:

STATE: Georgia	CODE 10
--------------------------	-------------------

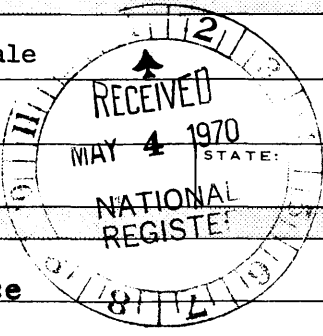

5. LOCATION OF LEGAL DESCRIPTION

COURTHOUSE, REGISTRY OF DEEDS, ETC.:
Thomas County Courthouse

STREET AND NUMBER:
North Broad Street

CITY OR TOWN:
Thomasville

STATE: Georgia	CODE 10
--------------------------	-------------------

APPROXIMATE ACREAGE OF NOMINATED PROPERTY:
1.25 Acres

6. REPRESENTATION IN EXISTING SURVEYS

TITLE OF SURVEY:
Thomasville Landmarks Architectural Inventory

DATE OF SURVEY: **10/1/69** Federal State County Local

DEPOSITORY FOR SURVEY RECORDS:
Thomasville Landmarks, Inc.

STREET AND NUMBER:
Box 44

CITY OR TOWN:
Thomasville

STATE: Georgia	CODE 10
--------------------------	-------------------

STATE: Georgia
COUNTY: Thomas
ENTRY NUMBER: 70-8-10-0042
DATE: 8/12/70
FOR NPS USE ONLY

SEE INSTRUCTIONS

7. DESCRIPTION

CONDITION	(Check One)				
	Excellent <input checked="" type="checkbox"/>	Good <input type="checkbox"/>	Fair <input type="checkbox"/>	Deteriorated <input type="checkbox"/>	Ruins <input type="checkbox"/>
INTEGRITY	(Check One)			(Check One)	
	Altered <input checked="" type="checkbox"/>	Unaltered <input type="checkbox"/>		Moved <input type="checkbox"/>	Original Site <input checked="" type="checkbox"/>

DESCRIBE THE PRESENT AND ORIGINAL (if known) PHYSICAL APPEARANCE

The Wright House is an ante-bellum cottage of rare distinction. A one story hipped roof frame building, the house has a recessed entry porch across the front facade which is supported by six square panelled columns with decorative carved insets. Windows on the side elevations have pedimented frames. The cornice is a flat, undecorated design, and the corner boards are also plain. The front entrance and windows are framed in excellent Greek Revival mouldings, capped by a row of dentils. The double door is panelled and flanked by sidelights and a fixed transom, all of which have finely detailed glass panels. The door frame has carved rosettes and is of exceptional interest. The front facade is flush siding treated as stone, and the remainder of the house is clapboard.

Numerous wings have been added to the house over the years, but the remain hidden from view for the most part. The original interiors in the older section of the house are excellent examples of their period, with good mantels, wainscoting, door and window frames and other detailing.

The Wright House has recently undergone complete restoration and is in excellent condition.

SEE INSTRUCTIONS

8. SIGNIFICANCE

PERIOD (Check One or More as Appropriate)

- Pre-Columbian 16th Century 18th Century 20th Century
 15th Century 17th Century 19th Century

SPECIFIC DATE(S) (If Applicable and Known) **1854**

AREAS OF SIGNIFICANCE (Check One or More as Appropriate)

- | | | | |
|---|---------------------------------------|---|--|
| Aboriginal | Education | Political | Urban Planning |
| Prehistoric <input type="checkbox"/> | Engineering <input type="checkbox"/> | Religion/Phi- | Other (Specify) <input type="checkbox"/> |
| Historic <input type="checkbox"/> | Industry <input type="checkbox"/> | losophy <input type="checkbox"/> | _____ |
| Agriculture <input type="checkbox"/> | Invention <input type="checkbox"/> | Science <input type="checkbox"/> | _____ |
| Art <input checked="" type="checkbox"/> | Landscape | Sculpture <input type="checkbox"/> | _____ |
| Commerce <input type="checkbox"/> | Architecture <input type="checkbox"/> | Social/Human- | _____ |
| Communications <input type="checkbox"/> | Literature <input type="checkbox"/> | itarian <input type="checkbox"/> | _____ |
| Conservation <input type="checkbox"/> | Military <input type="checkbox"/> | Theater <input type="checkbox"/> | _____ |
| | Music <input type="checkbox"/> | Transportation <input type="checkbox"/> | _____ |

STATEMENT OF SIGNIFICANCE (Include Personages, Dates, Events, Etc.)

Built in 1854 for Arthur P. Wright, who later became an Alderman and banker in Thomasville. The house was used for the early meetings of the St. Thomas Episcopal Church, and in 1861, Wright was mayor of the city. The house was until recently the property of Miss Julia Wright, a descendant of the original owner. The Wright House is one of the finest houses in Thomasville.

SEE INSTRUCTIONS

9. MAJOR BIBLIOGRAPHICAL REFERENCES

Perkerson, M.F., White Columns in Georgia
 Balfour, R., History of St. Thomas Episcopal Church

10. GEOGRAPHICAL DATA

LATITUDE AND LONGITUDE COORDINATES DEFINING A RECTANGLE LOCATING THE PROPERTY				OR	LATITUDE AND LONGITUDE COORDINATES DEFINING THE CENTER POINT OF A PROPERTY OF LESS THAN ONE ACRE							
CORNER	LATITUDE				LONGITUDE							
	Degrees	Minutes	Seconds	Degrees	Minutes	Seconds	Degrees	Minutes	Seconds			
NW	°	'	"	°	'	"	30°	49'	53"	83°	58'	55"
NE	°	'	"	°	'	"						
SE	°	'	"	°	'	"						
SW	°	'	"	°	'	"						

NO UTM
CX

LIST ALL STATES AND COUNTIES FOR PROPERTIES OVERLAPPING STATE OR COUNTY BOUNDARIES

STATE:	CODE	COUNTY	CODE

SEE INSTRUCTIONS

11. FORM PREPARED BY

NAME AND TITLE:
Russell Wright, Consultant

ORGANIZATION: **Thomasville Landmarks, Inc** DATE: **12/5/69**

STREET AND NUMBER:
BOX 44

CITY OR TOWN: **Thomasville** STATE: **Georgia** CODE: **10**

12. STATE LIAISON OFFICER CERTIFICATION

NATIONAL REGISTER VERIFICATION

As the designated State Liaison Officer for the National Historic Preservation Act of 1966 (Public Law 89-665), I hereby nominate this property for inclusion in the National Register and certify that it has been evaluated according to the criteria and procedures set forth by the National Park Service. The recommended level of significance of this nomination is:

National State Local

Name: Mary Gregory Jewett
 Title: State Liaison Officer, Ga.
 Date: Apr. 30, 1970

I hereby certify that this property is included in the National Register.

Arund Allen Connally
 Chief, Office of Archeology and Historic Preservation

Date: AUG 12 1970

ATTEST:
William J. Swartz
 Keeper of The National Register

Date: JUN 26 1970

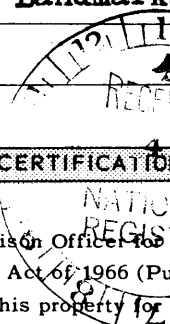
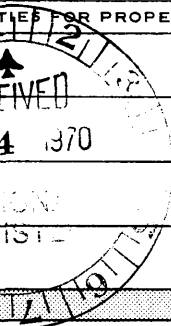

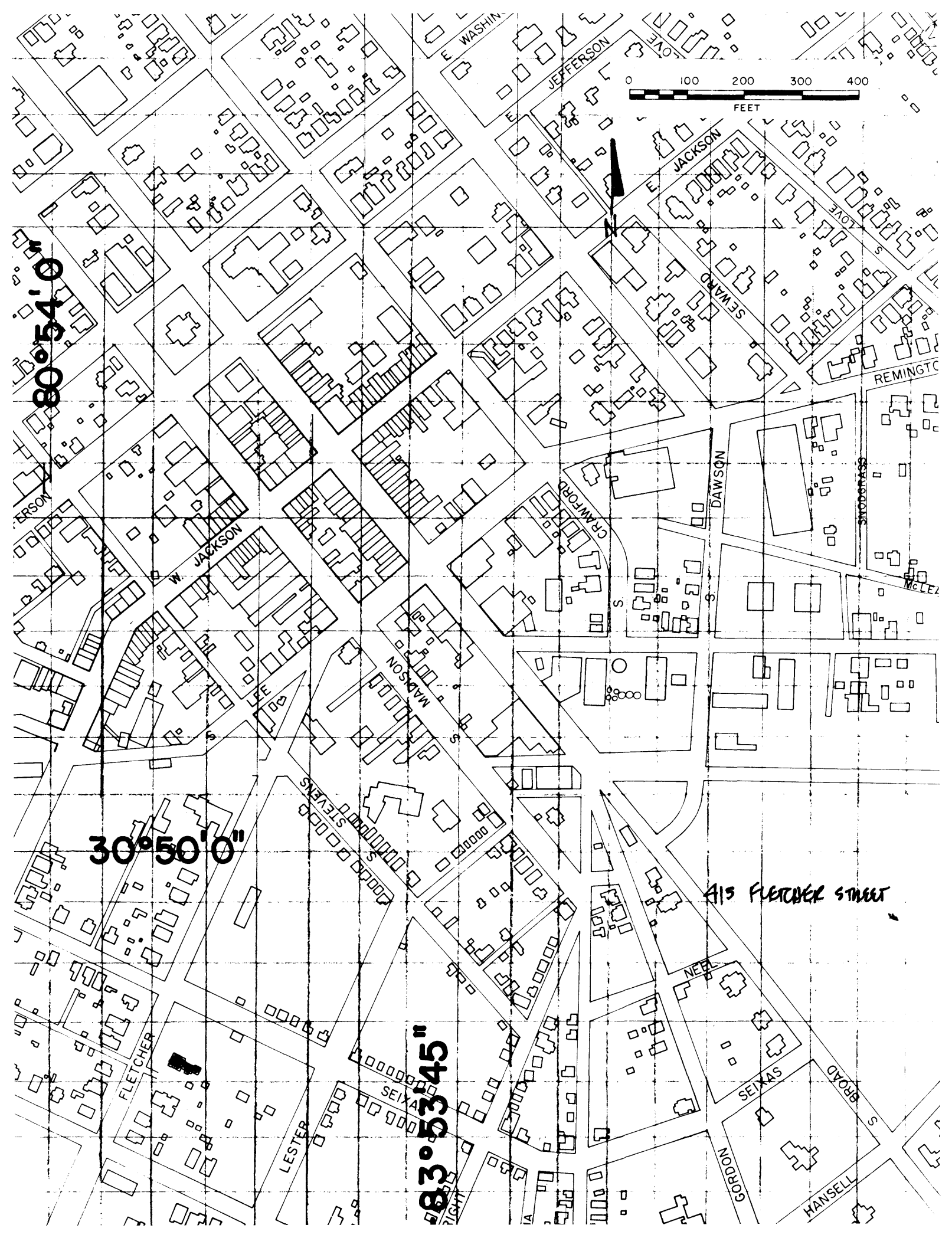

80°54'0"

30°50'0"

63°53'45"

A15 FLETCHER STREET

