

PH0012033

NATIONAL REGISTER OF HISTORIC PLACES  
INVENTORY - NOMINATION FORM

(Type all entries - complete applicable sections)

STATE: Florida	
COUNTY: Alachua	
FOR NPS USE ONLY	
ENTRY NUMBER	DATE
DEC 5	1972

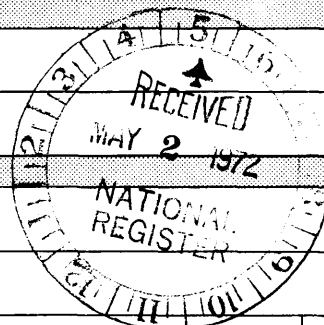

1. NAME

COMMON:  
(Rest Haven)

AND/OR HISTORIC:  
Major James B. Bailey House

2. LOCATION

STREET AND NUMBER:  
1121 Northwest Sixth Street

CITY OR TOWN:  
Gainesville

STATE: Florida CODE: 12 COUNTY: Alachua CODE: 001

3. CLASSIFICATION

CATEGORY (Check One)	OWNERSHIP	STATUS	ACCESSIBLE TO THE PUBLIC
<input type="checkbox"/> District <input type="checkbox"/> Site <input type="checkbox"/> Object	<input checked="" type="checkbox"/> Building <input type="checkbox"/> Structure <input type="checkbox"/> Private <input type="checkbox"/> Both	<input type="checkbox"/> Public <input type="checkbox"/> In Process <input type="checkbox"/> Being Considered	<input checked="" type="checkbox"/> Occupied <input type="checkbox"/> Unoccupied <input type="checkbox"/> Preservation work in progress
PRESENT USE (Check One or More as Appropriate)			
<input type="checkbox"/> Agricultural <input type="checkbox"/> Commercial <input type="checkbox"/> Educational <input type="checkbox"/> Entertainment	<input type="checkbox"/> Government <input type="checkbox"/> Industrial <input type="checkbox"/> Military <input type="checkbox"/> Museum	<input type="checkbox"/> Park <input checked="" type="checkbox"/> Private Residence <input type="checkbox"/> Religious <input type="checkbox"/> Scientific	<input type="checkbox"/> Transportation <input type="checkbox"/> Other (Specify) <u>rest home for the aged</u>

4. OWNER OF PROPERTY

OWNER'S NAME:  
William G. Busch

STREET AND NUMBER:  
1121 Northwest Sixth St.

CITY OR TOWN:  
Gainesville

STATE:  
Florida

CODE:  
12

5. LOCATION OF LEGAL DESCRIPTION

COURTHOUSE, REGISTRY OF DEEDS, ETC.:  
Alachua County Courthouse

STREET AND NUMBER:

CITY OR TOWN:  
Gainesville

STATE:  
Florida

CODE:  
12

6. REPRESENTATION IN EXISTING SURVEYS

TITLE OF SURVEY:  
Historic American Buildings Survey HABS No. Fla. -121

DATE OF SURVEY:  
May 1958  Federal  State  County  Local

DEPOSITORY FOR SURVEY RECORDS:  
Library of Congress

STREET AND NUMBER:

CITY OR TOWN:  
Washington

STATE:  
D.C.

CODE:  
11

SEE INSTRUCTIONS

STATE: Florida

COUNTY: Alachua

ENTRY NUMBER: DEC 5 1972

FOR NPS USE ONLY

DATE:

7. DESCRIPTION

CONDITION	(Check One)					
	<input checked="" type="checkbox"/> Excellent	<input type="checkbox"/> Good	<input type="checkbox"/> Fair	<input type="checkbox"/> Deteriorated	<input type="checkbox"/> Ruins	<input type="checkbox"/> Unexposed
	(Check One)			(Check One)		
	<input checked="" type="checkbox"/> Altered	<input type="checkbox"/> Unaltered		<input type="checkbox"/> Moved	<input checked="" type="checkbox"/> Original Site	

DESCRIBE THE PRESENT AND ORIGINAL (if known) PHYSICAL APPEARANCE

The Bailey House reflects characteristics typical of frontier plantation houses in the mid-nineteenth century. The house is of wood frame construction with some hand-hewn beams with mortised and pinioned joints. The building is one and a half stories high and symmetrically laid out. The foundation is dressed native coquina stone and the two chimneys are coquina and brick. There is a porch on the front of the house, the railing of which appears to be the original. The doorways have simplified Greek Revival details. Windows are nine light double hung sash with wooden louvered shutters. The roof has a double pitch and gabled ends; roofing is of sheet metal. There are three gabled dormers facing south. Alterations on the house include the replacement of the shingle roof with tin. Bathroom and kitchen facilities and a ramp at the front have been added and outbuildings and exterior stairs have been removed. The entire structure is painted white and the fabric is in excellent condition.

SEE INSTRUCTIONS

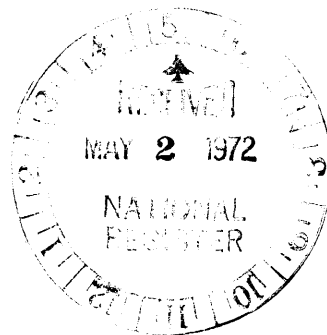

**SIGNIFICANCE**

PERIOD (Check One or More as Appropriate)

- |  |                                       |  |                                       |
|--|---------------------------------------|--|---------------------------------------|
| <input type="checkbox"/> Pre-Columbian | <input type="checkbox"/> 16th Century | <input type="checkbox"/> 18th Century            | <input type="checkbox"/> 20th Century |
| <input type="checkbox"/> 15th Century  | <input type="checkbox"/> 17th Century | <input checked="" type="checkbox"/> 19th Century |                                       |

SPECIFIC DATE(S) (If Applicable and Known) c. 1850

AREAS OF SIGNIFICANCE (Check One or More as Appropriate)

- |  |   |  |
|--|---|--|
| <input type="checkbox"/> Aboriginal              | <input type="checkbox"/> Education              | <input type="checkbox"/> Political           |
| <input type="checkbox"/> Prehistoric             | <input type="checkbox"/> Engineering            | <input type="checkbox"/> Religion/Philosophy |
| <input type="checkbox"/> Historic                | <input type="checkbox"/> Industry               | <input type="checkbox"/> Science             |
| <input type="checkbox"/> Agriculture             | <input type="checkbox"/> Invention              | <input type="checkbox"/> Sculpture           |
| <input checked="" type="checkbox"/> Architecture | <input type="checkbox"/> Landscape Architecture | <input type="checkbox"/> Social/Humanitarian |
| <input type="checkbox"/> Art                     | <input type="checkbox"/> Literature             | <input type="checkbox"/> Theater             |
| <input type="checkbox"/> Commerce                | <input type="checkbox"/> Military               | <input type="checkbox"/> Transportation      |
| <input type="checkbox"/> Communications          | <input type="checkbox"/> Music                  |  |
| <input type="checkbox"/> Conservation            |   |  |

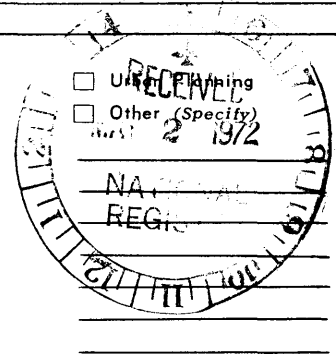

STATEMENT OF SIGNIFICANCE

SEE INSTRUCTIONS

Major James B. Bailey was one of the pioneer settlers of Gainesville. Having acquired extensive acreage within the original boundaries of northwest Gainesville, Major Bailey began construction of his home about 1848, thereby making the house one of the oldest in Gainesville.

Public records indicate that Major Bailey was a very prominent citizen of early Gainesville. He was County Treasurer of Alachua County for six years, was a member of the Patrol Committee and was the man appointed by the County Commissioners to decide on a site for the new jail and then to design the building. It also seems likely that Major Bailey was instrumental in having the county seat moved from Newnansville to Gainesville. In 1852, the legislature passed an act calling for a county-wide vote for the selection of a new seat of government. One source states that "Major Bailey desired the removal of the county seat from Newnansville for he owned a large part of the land on which the new town and the courthouse would be built". In 1854 Major Bailey did sell 63¼ acres of land to the Alachua County Commissioners to be used in part for a public square and for the erection of a courthouse. The present courthouse still stands on that site.

In March of 1862, at a special meeting of the citizens of Alachua County, a motion by the Honorable David L. Yulee was adopted which sent Major J.B. Bailey as a special messenger to Richmond, Virginia to impress upon the Government of the Confederate States the importance of keeping an army in East Florida. At the same time, Bailey was to confer with General Lee and urge him to leave the troops already in East Florida there. Major Bailey died in 1864 while working on fortifications at Baldwin, Florida. In a letter dated March 22, 1864, a friend of Bailey's wrote to General Jernigan that "our worthy townsman Major James B. Bailey is dead".

The Bailey homestead remains today as an excellent example of early plantation architecture and the home of one of Gainesville's most important pioneers.

**9. MAJOR BIBLIOGRAPHICAL REFERENCES**

See attached sheet

**10. GEOGRAPHICAL DATA**

LATITUDE AND LONGITUDE COORDINATES DEFINING A RECTANGLE LOCATING THE PROPERTY			OR	LATITUDE AND LONGITUDE COORDINATES DEFINING THE CENTER POINT OF A PROPERTY OF LESS THAN TEN ACRES		
CORNER	LATITUDE	LONGITUDE		LATITUDE	LONGITUDE	
	Degrees Minutes Seconds	Degrees Minutes Seconds		Degrees Minutes Seconds	Degrees Minutes Seconds	
NW	° ' "	° ' "		29 ° 39 ' 47 "	82 ° 19 ' 52 "	
NE	° ' "	° ' "				
SE	° ' "	° ' "				
SW	° ' "	° ' "				

APPROXIMATE ACREAGE OF NOMINATED PROPERTY: less than an acre

LIST ALL STATES AND COUNTIES FOR PROPERTIES OVERLAPPING STATE OR COUNTY BOUNDARIES

STATE:	CODE	COUNTY	CODE

**11. FORM PREPARED BY**

NAME AND TITLE:  
**Diane D. Greer, Historic Sites Specialist**

ORGANIZATION: **Division of Archives, History & Records Mgt.** DATE: **Jan. 10, 1972**

STREET AND NUMBER:  
**Department of State - The Capitol**

CITY OR TOWN: **Tallahassee** STATE: **Florida** CODE: **12**

**12. STATE LIAISON OFFICER CERTIFICATION**      **NATIONAL REGISTER VERIFICATION**

As the designated State Liaison Officer for the National Historic Preservation Act of 1966 (Public Law 89-665), I hereby nominate this property for inclusion in the National Register and certify that it has been evaluated according to the criteria and procedures set forth by the National Park Service. The recommended level of significance of this nomination is:

National  State  Local

Name: *Robert W. Utley*  
Title: State Liaison Officer  
Date: April 17, 1972

I hereby certify that this property is included in the National Register.

*Robert W. Utley*  
Chief, Office of Archeology and Historic Preservation

Date: 12/5/72

ATTEST:  
*William J. Swartz*  
Keeper of The National Register

Date: 12-4-72

SEE INSTRUCTIONS

NATIONAL REGISTER OF HISTORIC PLACES  
INVENTORY - NOMINATION FORM

(Continuation Sheet)

STATE	
Florida	
COUNTY	
Alachua	
FOR NPS USE ONLY	
ENTRY NUMBER	DATE
DEC 5	1972

(Number all entries)

9. Bibliography

Alachua County Records, Alachua County Courthouse, Gainesville, Florida. Office of the Clerk of the Circuit Court. (Subgroup: Deeds. Deed Book B, pg. 296, Deed Book D, pg. 213, Deed Book H, pg. 384).

Alachua County Records, Alachua County Courthouse, Gainesville, Florida. Office of the County Judge. (Subgroup: Estate Papers of Major James B. Bailey).

Bailey Letters. Letter from James B. Dawkins to General Jernigan. Gainesville, March 22, 1864. P.K. Yonge Library.

Cotton States (Gainesville), March 19, 1864.

Davis, Jess G. History of Gainesville, Florida with Biographical Sketches of Families. Gainesville: 1966.

Doig, James. "Reminiscent Sketches of Gainesville's Early Days," Gainesville Sun, July 15, July 22, July 29, 1917.

General Assembly. The Acts and Resolutions Adopted by the General Assembly of Florida, 6th session. Tallahassee, 1855-1866. Cited as Laws of Florida.

Hildreth, Charles Halsey. A History of Gainesville, Florida. Gainesville: University of Florida Press, 1954.

Minutes of the County Commissioners, 1852-1860. Alachua County Courthouse, Gainesville, Florida.

The War of the Rebellion: A Compilation of the Official Records of the Union and Confederate Armies, 1880-1901. Washington, D.C., Government Printing Office. Series I, Vol. 53.

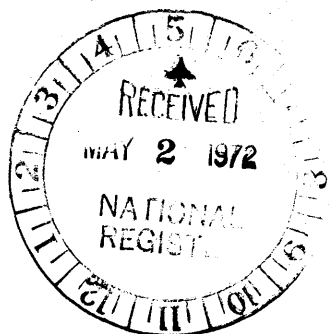

Form 10-301  
(July 1969)

UNITED STATES DEPARTMENT OF THE INTERIOR  
NATIONAL PARK SERVICE

NATIONAL REGISTER OF HISTORIC PLACES

PROPERTY MAP FORM

(Type all entries - attach to or enclose with map)

STATE	
Florida	
COUNTY	
Alachua	
FOR NPS USE ONLY	
ENTRY NUMBER	DATE
DEC 5	1972

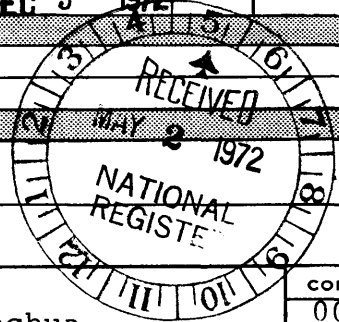

SEE INSTRUCTIONS

<b>1. NAME</b>			
COMMON:		Rest Haven	
AND/OR HISTORIC:		Major James B. Bailey House	
<b>2. LOCATION</b>			
STREET AND NUMBER:			
1121 Northwest Sixth Street			
CITY OR TOWN:			
Gainesville			
STATE:	CODE	COUNTY:	CODE
Florida	12	Alachua	001
<b>3. MAP REFERENCE</b>			
SOURCE:			
USGS Gainesville East Quadrangle, 7.5 minute series			
SCALE:			
1:24000			
DATE:			
1966			
<b>4. REQUIREMENTS</b>			
TO BE INCLUDED ON ALL MAPS			
1. Property boundaries where required.			
2. North arrow.			
3. Latitude and longitude reference.			

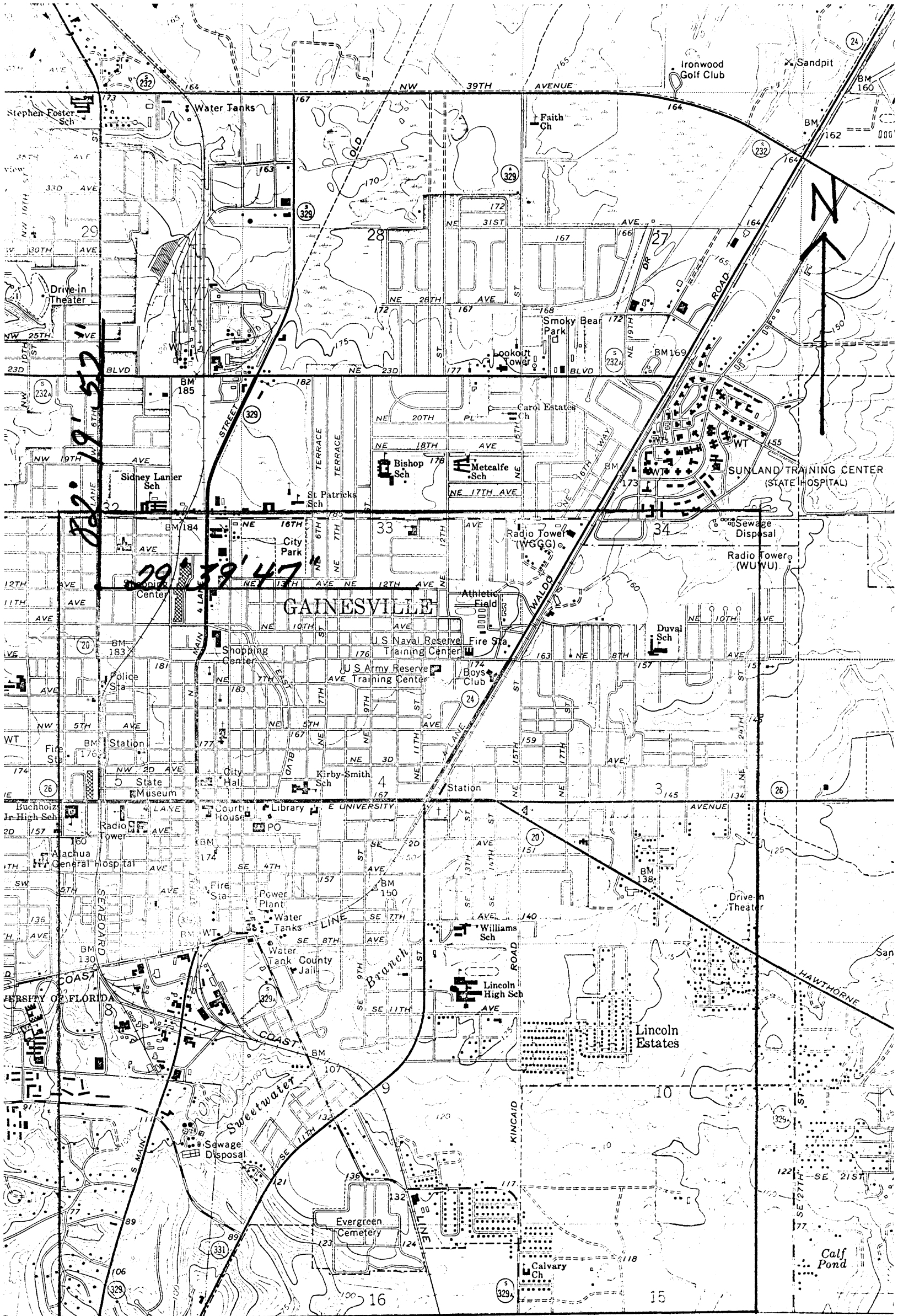

82° 19' 57"

29° 39' 47"

**GAINESVILLE**

20° 37'

1.1 MI. TO U.S. 441

(MICANOPY)  
4543 III SE

374

17° 30'

SCALE 1:24 000

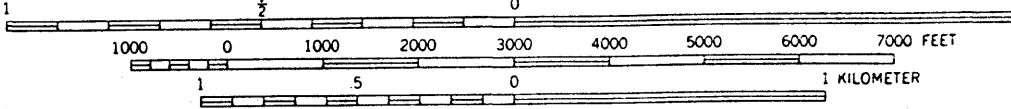

CONTOUR INTERVAL 5 FEET  
DATUM IS MEAN SEA LEVEL