

NATIONAL REGISTER OF HISTORIC PLACES
REGISTRATION FORM

APR 05 1989

NATIONAL REGISTER

1. Name of Property

historic name ABANDONED ROUTE 66: PARKS (1921)

other names/site number Old Route 66 / AR-03-07-02-1003

2. Location

street & number N/A

/ /not for publication

city, town Parks

/xx/vicinity

state Arizona

code AZ

county Coconino

code 005

zip code N/A

3. Classification

Ownership of Property

Category of Property

Number of Resources within Property

- private
- public-local
- public-State
- public-Federal

- building(s)
- district
- site
- structure
- object

Contributing	Noncontributing
_____	_____
_____	_____
<u>1</u>	_____
_____	_____
<u>1</u>	_____
	Total

Name of related multiple property listing:

Number of contributing resources previously listed in the National Register _____

Historic US Route 66 in Arizona

4. State/Federal Agency Certification

As the designated authority under the National Historic Preservation Act of 1966, as amended, I hereby certify that this nomination request for determination of eligibility meets the documentation standards for registering properties in the National Register of Historic Places and meets the procedural and professional requirements set forth in 36 CFR Part 60. In my opinion, the property meets does not meet the National Register criteria. See continuation sheet.

Terrance D. Wilkerson
Signature of certifying official

3-16-89
Date

USDA - Forest Service

In my opinion, the property meets does not meet the National Register criteria. See continuation sheet.

Shereen Kerner
Signature of certifying official

February 22, 1989
Date

Arizona State Historic Preservation Office
State Historic Preservation Office

5. National Park Service Certification

I, hereby, certify that this property is:

entered in the National Register.

See continuation sheet.

determined eligible for the National Register.

See continuation sheet.

determined not eligible for the National Register.

removed from the National Register.

other, (explain:)

Druce J. Noble, Jr.

5/19/89

for Signature of the Keeper

Date of Action

6. Function or Use

Historic Functions (enter categories from instructions)
TRANSPORTATION/Road-related (vehicular)

Current Functions (enter categories from instructions)
Abandoned/not in use

[Interstate Highway]

7. Description

Architectural Classification
(enter categories from instructions)
N/A

Materials enter categories from instructions)
foundation

walls

roof

other Earth fill, bituminous surfacing

Describe present and historic physical appearance.

This abandoned .35 mile (.50 km) long section of Route 66 lies unused today. It retains its cross-section template and bituminous surfacing. Aside from some deterioration of the road surface and intrusive vegetation, this section retains its historic appearance.

This section of road that in 1926 would become Route 66 was built in about 1921. Although pre-1930s alignments of Route 66 were generally not paved, this section appears to have a bituminous surface, formed by spraying hot oil on pebbles or cinders. The roadway is in excellent condition, particularly compared with the portion of this road that continues west, which is discernable but largely obliterated.

The 1931 realignment of Route 66 several feet south left this section abandoned.

8. Statement of Significance

Certifying official has considered the significance of this property in relation to other properties:

nationally statewide locally

Applicable National Register Criteria A B C D

Criteria Considerations (Exceptions) A B C D E F G

Areas of Significance (enter categories from instructions) Period of Significance Significant Dates

Transportation ca. 1921-1931 _____

_____ _____ _____

_____ _____ _____

_____ Cultural Affiliation _____

_____ N/A _____

_____ _____ _____

Significant Person Architect/Affiliation

N/A N/A

State significance of property, and justify criteria, criteria considerations, and areas and periods of significance noted above.

This property is significant for its association with Historic US Route 66 in Arizona and the theme of transportation in America between ca. 1920 and 1944.

This ca. 1921 alignment was part of Route 66 described by the magazine Arizona Highways in 1931 as " . . . narrow, crooked, poorly surfaced road which is particularly dangerous in dry weather due to ravelling and innumerable potholes." A sharp curve just west of the nominated property was the site of many accidents, earning the dreaded title of "dead man's curve" in the local newspaper. The 1931 realignment was straighter and wider, necessitating a shift of the roadbed at Parks (then called Maine). It had passed between the small cluster of businesses there (located just east of the nominated property). After 1931, Route 66 ran a few feet to the south, and the focus of the small community shifted in that direction.

This short section of road is an excellent example of the earliest alignment of Route 66. It is the best preserved section of the ca. 1921 roadway in the Parks area, and aids in our understanding of the various alignments of Route 66 and their relationship to the small community of Parks. Although at .35 mile this is a short segment of road, it nevertheless presents an unbroken view of the roadway to the horizon. The cross-section template and pavement from the historic period remain in good condition. It retains integrity of design, workmanship, location, feeling, association, and setting.

9. Major Bibliographical References

Arizona Highways July, 1931

Williams News Aug. 10, 1928

"As Built" Plans dated 1/24/32. Federal Aid Project 89-E (Ash Fork-Flagstaff highway). On file at ADOT Engineering Records Division, Phoenix.

See continuation sheet.

Previous documentation on file (NPS):

- preliminary determination of individual listing (36 CFR 67) has been requested.
- previously listed in the National Register
- previously determined eligible by the National Register
- designated a National Historic Landmark
- recorded by Historic American Buildings Survey # _____
- recorded by Historic American Engineering Record # _____

Primary location of additional data:

- State hist. preservation office
- Other State agency
- Federal agency
- Local government
- University
- Other

Specify repository:

Kaibab National Forest

10. Geographical Data

Acreage of property 6 acres

UTM References

A 1|2| 4|1|3|1|0|0| 3|9|0|2|1|0|0|

Zone Easting Northing

C | | | | | | | | | | | | | | |

Zone Easting Northing

B 1|2| 4|1|3|5|7|0| 3|9|0|2|1|0|0|

Zone Easting Northing

D | | | | | | | | | | | | | | |

Zone Easting Northing

See continuation sheet

Verbal Boundary Description

This .35 mile (.50 km) long section of Abandoned Route 66 is defined on the west by an intrusive side road and an obliterated road section, and on the east by private property. The original ROW (66 feet to each side of the centerline) defines the width. See UTM references and attached map.

See continuation sheet

Boundary Justification

The boundary includes the property type "Abandoned Route 66" defined in the multiple property form. All improvements associated with this property are contained within the ROW.

See continuation sheet

11. Form Prepared By

name/title Teri A. Cleeland, Archeologist

organization Kaibab National Forest

street & number 800 S. Sixth St.

city or town Williams

date August 2, 1988

telephone (602) 635-2681

state AZ zip code 86046

United States Department of the Interior
National Park Service

NATIONAL REGISTER OF HISTORIC PLACES
CONTINUATION SHEET

PHOTOGRAPHS Page 1

THE FOLLOWING INFORMATION IS THE SAME FOR ALL PHOTOGRAPHS ACCOMPANYING THIS
NOMINATION:

- 1). Abandoned Route 66: Parks (1921)
- 2). Vicinity of Parks, Arizona
- 3). Teri A. Cleeland
- 4). June, 1988
- 5). Kaibab National Forest, Williams, Arizona

INFORMATION FOR INDIVIDUAL PHOTOGRAPHS:

- 6). Facing east, of roadway
- 7). #1

- 6). Facing west, of roadway
- 7). #2

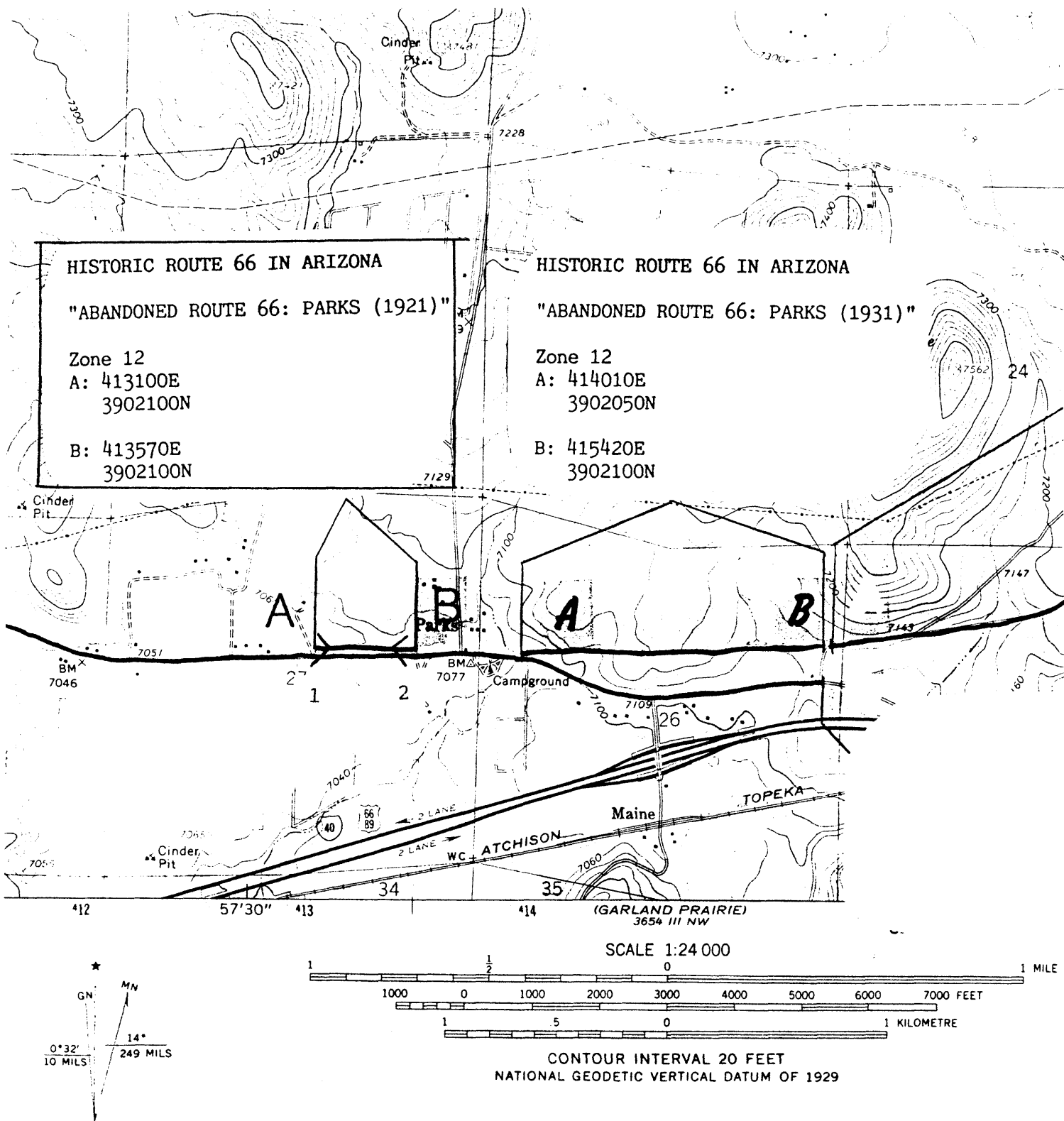

Abandoned Route 66: Parks (1921). Photo points numbered. Note adjacent nominated properties.