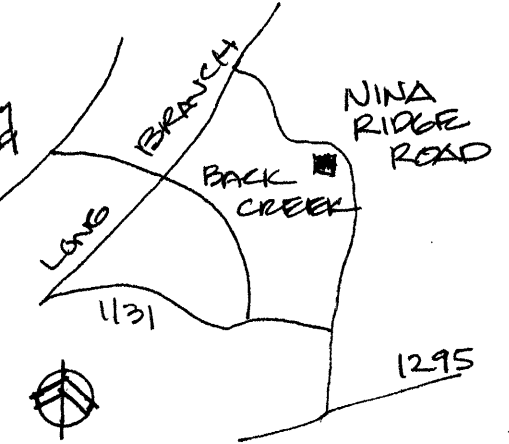

KENTUCKY HISTORIC RESOURCES INVENTORY

Site No. GD 55

1. Historic Name(s) <u>Sebastian Log House</u> Original Owner <u>Sebastian</u>		22. ADD/County BLUEGRASS/ GARRARD 040	
2. Present Name <u>C. C. Prewitt Home</u>		23. U.S.G.S. Quadrant (15'/75') <u>Kirkville</u> 	
3. Location <u>1 1/2 mi off Back Creek on Nina Ridge</u>		24. UTM Reference Zone Easting Northing	
Owner's Name <u>Robert & Phyllis Ruble</u>		25. Coordinate Accuracy 	
Owner's Address <u>Route 1, Richmond, Ky. 40475</u>		26. Prehistoric Site Object Historic Site Structure <input checked="" type="checkbox"/> Building Other	
6. Open to Public Yes <input type="checkbox"/> No <input checked="" type="checkbox"/>	7. Visible from road Yes <input checked="" type="checkbox"/> No <input type="checkbox"/>	8. Ownership Private <input checked="" type="checkbox"/> Local <input type="checkbox"/> State <input type="checkbox"/> Federal <input type="checkbox"/>	
9. Local Contact/Organization GARRARD COUNTY HISTORICAL SOCIETY		27. National Register District Name: 	
10. Site Plan with North Arrow 		28. Significance Evaluation National Register Crit. 	
		29. Status Date National Landmark <input type="checkbox"/> National Register <input type="checkbox"/> Landmark Certificate <input type="checkbox"/> Kentucky Survey <input type="checkbox"/> Local Landmark <input type="checkbox"/> HABS/HAER <input type="checkbox"/>	
18. Description One story five bay log and frame residence; dogtrot plan; gable roof; stone end chimneys		30. Historic Theme Primary <input type="checkbox"/> Secondary <input type="checkbox"/> Other <input type="checkbox"/>	
		31. Endangered Yes <input type="checkbox"/>	
(Continue on Back)		32. Preservation Project Status Actual Cost in \$1,000s 	
		33. Roof Form Gable	
19. History Philip Warmout owned this property in 1854 DB T p. 69; William Harry Sebastian and other members of this family owned the property from 1863 to 1919. Cameron C. Prewitt bought this land in 1919 and a large family was raised in this large log home.		Roll No. <u>25</u> Picture No. <u>7-10</u> Direction _____	
20. Significance A well preserved large log house in this Buckeye community and Garrard County's best example of a one story log and frame dog trot plan residence from the period of early		34. Prepared by: HELEN POWELL	
21. Source of Information <u>agricultural development. Garrard County Court House Records. Personal interview- Mrs. Willie Sebastian</u>		35. Organization CARMAN AND POWELL, INC.	
		36. Date 1983	
		37. Revision Dates 38. Staff Review	

KENTUCKY HISTORIC RESOURCE INVENTORY SUPPLEMENT
BOUNDARY AND LOCATION INFORMATION

Historic Property Name Sebastian Log House Site # GD 55

Multiple Resource/Thematic Nomination Title MULTIPLE RESOURCE AREA OF GARRARD COUNTY

U.T.M. Coordinates - List multiple UTMs if property is ten or more acres.

A. 16 722 460 4173700 D. 16 722380 4173620

B. 16 722 640 4173620 E. _____

C. 16 722 420 4173540 F. _____

Verbal Boundary Description _____ Acreage 3.10

From a point in Nina Ridge Road, then Southwest 700 feet to a point; then Southeast 200 feet to a point; then Northeast 650 feet to a point; then Northwest along Nina Ridge Road 200 feet to the point of Beginning.

Point of beginning in Nina Ridge Road is 70 feet northwest and 570 feet northeast of the northeast corner of the Sebastian House.

Sketch of Site Plan (Showing outbuildings, structures, landscape features and the site boundary as described above.)

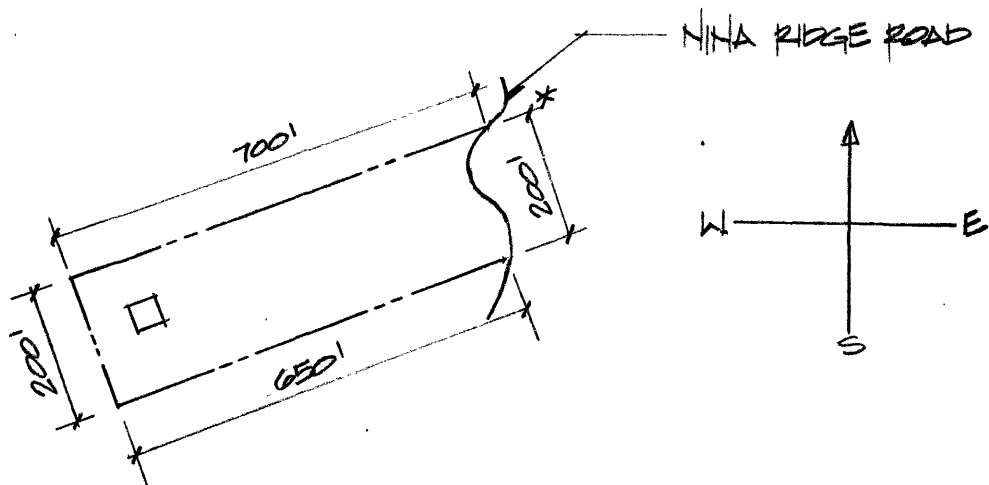

SCALE 1" = 200'

Official Courthouse Property Reference: