

UNITED STATES DEPARTMENT OF THE INTERIOR  
NATIONAL PARK SERVICE

**NATIONAL REGISTER OF HISTORIC PLACES  
INVENTORY -- NOMINATION FORM**

FOR FEDERAL PROPERTIES

FOR NPS USE ONLY

RECEIVED DEC 19 1980

DATE ENTERED

1/22/86

SEE INSTRUCTIONS IN *HOW TO COMPLETE NATIONAL REGISTER FORMS*  
TYPE ALL ENTRIES -- COMPLETE APPLICABLE SECTIONS

**1 NAME**

HISTORIC

Boulder Post Office

AND/OR COMMON

Boulder Main Post Office

**2 LOCATION**

STREET & NUMBER

1905 15th Street

NA NOT FOR PUBLICATION

CITY, TOWN

Boulder

CONGRESSIONAL DISTRICT

1

NA VICINITY OF

STATE

Colorado

CODE

08

COUNTY

Boulder

CODE

013

**2 CLASSIFICATION**

CATEGORY	OWNERSHIP	STATUS	PRESENT USE	
<input type="checkbox"/> DISTRICT	<input checked="" type="checkbox"/> PUBLIC	<input checked="" type="checkbox"/> OCCUPIED	<input type="checkbox"/> AGRICULTURE	<input type="checkbox"/> MUSEUM
<input type="checkbox"/> BUILDING(S)	<input type="checkbox"/> PRIVATE	<input type="checkbox"/> UNOCCUPIED	<input type="checkbox"/> COMMERCIAL	<input type="checkbox"/> PARK
<input type="checkbox"/> STRUCTURE	<input type="checkbox"/> BOTH	<input type="checkbox"/> WORK IN PROGRESS	<input type="checkbox"/> EDUCATIONAL	<input type="checkbox"/> PRIVATE RESIDENCE
<input type="checkbox"/> SITE	<b>PUBLIC ACQUISITION</b>	<b>ACCESSIBLE</b>	<input type="checkbox"/> ENTERTAINMENT	<input type="checkbox"/> RELIGIOUS
<input type="checkbox"/> OBJECT	NA IN PROCESS	<input type="checkbox"/> YES: RESTRICTED	<input checked="" type="checkbox"/> GOVERNMENT	<input type="checkbox"/> SCIENTIFIC
<input checked="" type="checkbox"/> Thematic Group	<input type="checkbox"/> BEING CONSIDERED	<input checked="" type="checkbox"/> YES: UNRESTRICTED	<input type="checkbox"/> INDUSTRIAL	<input type="checkbox"/> TRANSPORTATION
		<input type="checkbox"/> NO	<input type="checkbox"/> MILITARY	<input type="checkbox"/> OTHER:

**4 AGENCY**

REGIONAL HEADQUARTERS: (If applicable)

United States Postal Service, Western Regional Office

STREET & NUMBER

850 Cherry Ave.

CITY, TOWN

San Bruno

NA VICINITY OF

STATE

CA 94099

**5 LOCATION OF LEGAL DESCRIPTION**

COURTHOUSE,  
REGISTRY OF DEEDS, ETC.

Boulder County Assessor  
Boulder County Courthouse

STREET & NUMBER

13th Street and Pearl Street

CITY, TOWN

Boulder

STATE

CO 80306

**6 REPRESENTATION IN EXISTING SURVEYS**

TITLE

Boulder Downtown Historic District-National Register Nomination

DATE

December 1980

FEDERAL  STATE  COUNTY  LOCAL

DEPOSITORY FOR  
SURVEY RECORDS

Colorado State Historic Preservation Office

CITY, TOWN

Denver

STATE

CO 80203

## 7 DESCRIPTION

CONDITION		CHECK ONE	CHECK ONE
<input checked="" type="checkbox"/> EXCELLENT	<input type="checkbox"/> DETERIORATED	<input checked="" type="checkbox"/> UNALTERED	<input checked="" type="checkbox"/> ORIGINAL SITE
<input type="checkbox"/> GOOD	<input type="checkbox"/> RUINS	<input type="checkbox"/> ALTERED	<input type="checkbox"/> MOVED    DATE <u>NA</u>
<input type="checkbox"/> FAIR	<input type="checkbox"/> UNEXPOSED		

---

### DESCRIBE THE PRESENT AND ORIGINAL (IF KNOWN) PHYSICAL APPEARANCE

The Boulder Main Post Office is a rectangular building with Renaissance Revival and Classical detailing. The front elevation of the original structure is defined by five recessed panels topped with segmental arches. The main entrance is located in the center of the original building. (1910) The structure has a hipped metal roof. The lobby has white plaster walls, a terrazzo floor and marble wainscotting.

### LOCAL CONTEXT

Boulder was established in 1859 as a supply center for mining activity in the mountains to the west. The name comes from the profusion of boulders in the vicinity. It is the county seat. The post office is centrally located in the community's principal commercial district. The general area contains a large number of late-19th century and early-20th century buildings.

The post office is within the Downtown Boulder National Register Historic District (established 1980 which contains 168 properties, including the post office, between 9th and 16th and Walnut and Pine Streets.

A site topographic survey (1909) indicates that the site was originally vacant except for a one-story brick commercial building of approximately 4,500 square feet located in the north-western corner of the site (Lots 7 por. and 8 por.). There are no known archaeological or paleontologic sites within or adjacent to the site. Additional subsurface investigation does not appear to be warranted. Basement construction has probably eliminated any trace of previous structures.

### PHYSICAL APPEARANCE

The building appears to be in excellent structural condition and both it and the grounds are well maintained.

The rectangular building's main entrance faces east. The one and one-half story structure is constructed of tan brick and terracotta and limestone detailing. The lobby floors are

**United States Department of the Interior  
National Park Service**

**National Register of Historic Places  
Inventory—Nomination Form**



Continuation sheet

Boulder PO

Item number

7

Page 1

terrazzo, with marble wainscoting. The workroom floor is linoleum. The original building has a hipped metal roof, while the additions have flat composition roofs. There have been three remodelings; the first, a major addition in 1932-33; the second, a minor addition in 1959; and the third, the addition of solar panels in 1980.

The building contains a number of specific features not commonly found on post office buildings of this period. Features of note include: the metal hipped roof over the 1910 portion of the building with three hooded dormer windows facing the front entrance; brickwork suggestive of pilasters; rectangular casement windows recessed and outlined in brick with oversized limestone keystones further having oversized keystone; the pedimented front is pieced over the front (east) and side (south) doors; limestone blocks defining the basement; a simple parapet with limestone detailing, large chimney with over-size keystones above the rectangular side vents and original iron freestanding lamps flanking the front entrance and wall-mounted lamps flanking the side entrance.

The site is roughly 150 by 220 feet (33,171 square feet). The building takes up nearly the entire site, and has a small amount of parking and a loading dock are adjacent the west elevator.

# 8 SIGNIFICANCE

PERIOD		AREAS OF SIGNIFICANCE -- CHECK AND JUSTIFY BELOW				
<input type="checkbox"/> PREHISTORIC	<input type="checkbox"/> ARCHEOLOGY-PREHISTORIC	<input type="checkbox"/> COMMUNITY PLANNING	<input type="checkbox"/> LANDSCAPE ARCHITECTURE	<input type="checkbox"/> RELIGION		
<input type="checkbox"/> 1400-1499	<input type="checkbox"/> ARCHEOLOGY-HISTORIC	<input type="checkbox"/> CONSERVATION	<input type="checkbox"/> LAW	<input type="checkbox"/> SCIENCE		
<input type="checkbox"/> 1500-1599	<input type="checkbox"/> AGRICULTURE	<input type="checkbox"/> ECONOMICS	<input type="checkbox"/> LITERATURE	<input type="checkbox"/> SCULPTURE		
<input type="checkbox"/> 1600-1699	<input checked="" type="checkbox"/> ARCHITECTURE	<input type="checkbox"/> EDUCATION	<input type="checkbox"/> MILITARY	<input type="checkbox"/> SOCIAL/HUMANITARIAN		
<input type="checkbox"/> 1700-1799	<input type="checkbox"/> ART	<input type="checkbox"/> ENGINEERING	<input type="checkbox"/> MUSIC	<input type="checkbox"/> THEATER		
<input type="checkbox"/> 1800-1899	<input type="checkbox"/> COMMERCE	<input type="checkbox"/> EXPLORATION/SETTLEMENT	<input type="checkbox"/> PHILOSOPHY	<input type="checkbox"/> TRANSPORTATION		
<input checked="" type="checkbox"/> 1900-	<input type="checkbox"/> COMMUNICATIONS	<input type="checkbox"/> INDUSTRY	<input type="checkbox"/> POLITICS/GOVERNMENT	<input type="checkbox"/> OTHER (SPECIFY)		
		<input type="checkbox"/> INVENTION				

SPECIFIC DATES 1910, 1932-33, 1959

BUILDER/ARCHITECT OSA/James Knox Taylor  
Supervising Architect

STATEMENT OF SIGNIFICANCE

The Boulder Post Office is a well preserved and rare example of the type of post office building constructed during James Knox Taylor's tenure as Supervising Architect. The building is a notable interpretation of Classical and Renaissance Revival styling and has considerable urban design significance in relation to the town's civic center.

ARCHITECTURE

The structure is consistent with the design concepts prevalent during the administration of James Knox Taylor. Portions of the building are clearly inspired by French Neo-classicism, in particular the metal hipped roof and the three hooded dormer windows. However, the basic symmetry relates to Renaissance Revival design, as interpreted by Beaux-Arts inspired architects in the Office of the Supervising Architect.

The Boulder Main Post Office has importance on the state and local levels as a particularly sophisticated and refined example of Taylor's Renaissance Revival and Beaux-Arts inspired designs, and of the intended didactic quality of federal buildings in the early years of this century. On a local level the Boulder Main post Office is one of the best, if not the best, example of Beaux-Arts influenced architecture in the community.

The post office building is listed in the Boulder Downtown Historic District although it is not well documented.

# 9 MAJOR BIBLIOGRAPHICAL REFERENCES

None Known.

# 10 GEOGRAPHICAL DATA

ACREAGE OF NOMINATED PROPERTY +.76 acres

UTM REFERENCES

A	13	4765210	44307210
	ZONE	EASTING	NORTHING
C			

B			
	ZONE	EASTING	NORTHING
D			

## VERBAL BOUNDARY DESCRIPTION

Lots 7, 8 and a portion of Lot 9, Block 69, original Boulder Townsite.  
(See attached map)

## LIST ALL STATES AND COUNTIES FOR PROPERTIES OVERLAPPING STATE OR COUNTY BOUNDARIES

STATE	CODE	COUNTY	CODE
NA	NA	NA	NA
STATE	CODE	COUNTY	CODE
NA	NA	NA	NA

# 11 FORM PREPARED BY

NAME / TITLE

Paul R. Secord, Vice President/H. James Kolva

ORGANIZATION

Beland/Associates, Inc. / Institute for Urban and Local Studies

DATE

August 1984/August 1985

STREET & NUMBER

16 S. Oakland Ave., Suite 204/ W. 705 1st. Ave.

TELEPHONE

(818) 796-8093 / (509) 458-6219

CITY OR TOWN

Pasadena /Spokane

STATE

CA 91101/WA 99204

# 12 CERTIFICATION OF NOMINATION

STATE HISTORIC PRESERVATION OFFICER RECOMMENDATION

YES

NO

NONE

*Babara Sudler*

STATE HISTORIC PRESERVATION OFFICER SIGNATURE

In compliance with Executive Order 11593, I hereby nominate this property to the National Register, certifying that the State Historic Preservation Officer has been allowed 90 days in which to present the nomination to the State Review Board and to evaluate its significance. The evaluated level of significance is National State Local.

FEDERAL REPRESENTATIVE SIGNATURE

*James T. Col*

TITLE

Director, Office of Real Estate

DATE

December 17, 1985

FOR NPS USE ONLY

I HEREBY CERTIFY THAT THIS PROPERTY IS INCLUDED IN THE NATIONAL REGISTER

*See Continuation sheet for listing*

DATE

DIRECTOR, OFFICE OF ARCHEOLOGY AND HISTORIC PRESERVATION

DATE

ATTEST:

KEEPER OF THE NATIONAL REGISTER

UNITED STATES DEPARTMENT OF THE INTERIOR  
NATIONAL PARK SERVICE

**NATIONAL REGISTER OF HISTORIC PLACES  
INVENTORY -- NOMINATION FORM**

FOR NPS USE ONLY

RECEIVED

MAR 7 1980

DATE ENTERED

CONTINUATION SHEET Boulder MPO ITEM NUMBER 10 PAGE 1

15<sup>TH</sup> STREET

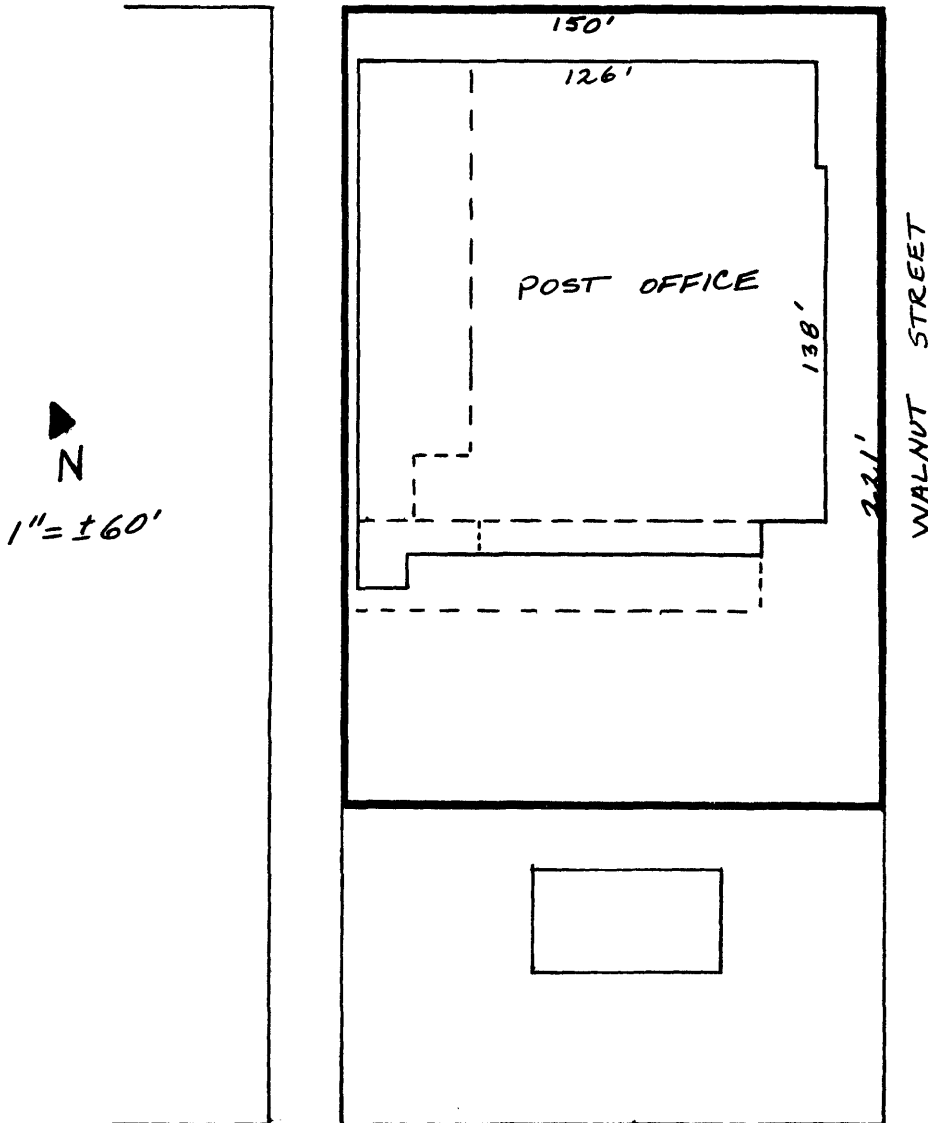

Source: Sanborn Map,  
Boulder, Colo.,  
page 3, Jan.  
1931.