

United States Department of the Interior
National Park Service

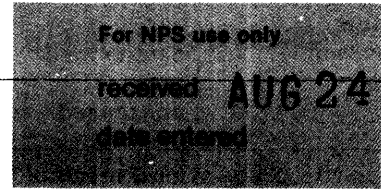

National Register of Historic Places Inventory—Nomination Form

See instructions in *How to Complete National Register Forms*
Type all entries—complete applicable sections

1. Name

historic Montrose Plantation House

and/or common Same

2. Location

street & number LA Hwy. 603, 0.5 1/2 miles SE of Tallulah on LA 603 N/A not for publication

city, town Tallulah vic. vicinity of ~~congressional district~~

state LA code 22 parish ~~XXXX~~ Madison code 065

3. Classification

Category	Ownership	Status	Present Use
<input type="checkbox"/> district	<input type="checkbox"/> public	<input checked="" type="checkbox"/> occupied	<input type="checkbox"/> agriculture
<input checked="" type="checkbox"/> building(s)	<input checked="" type="checkbox"/> private	<input type="checkbox"/> unoccupied	<input type="checkbox"/> commercial
<input type="checkbox"/> structure	<input type="checkbox"/> both	<input type="checkbox"/> work in progress	<input type="checkbox"/> educational
<input type="checkbox"/> site	Public Acquisition	Accessible	<input checked="" type="checkbox"/> private residence
<input type="checkbox"/> object	<u>N/A</u> in process	<input checked="" type="checkbox"/> yes: restricted	<input type="checkbox"/> religious
	<u>N/A</u> being considered	<input type="checkbox"/> yes: unrestricted	<input type="checkbox"/> scientific
		<input type="checkbox"/> no	<input type="checkbox"/> transportation
			<input type="checkbox"/> other:

4. Owner of Property

name Mr. and Mrs. Clement M. Dahlhausser

street & number Route 3, Box 237

city, town Tallulah N/A vicinity of state LA 71282

5. Location of Legal Description

courthouse, registry of deeds, etc. Madison Parish Courthouse

street & number 100 North Cedar Street

city, town Tallulah state LA 71282

6. Representation in Existing Surveys

title LA Historic Sites Survey has this property been determined eligible? yes no

date 1982 federal state county local

depository for survey records Louisiana State Historic Preservation Office

city, town Baton Rouge state LA

7. Description

Condition		Check one	Check one	
<input type="checkbox"/> excellent	<input type="checkbox"/> deteriorated	<input type="checkbox"/> unaltered	<input checked="" type="checkbox"/> original site	
<input type="checkbox"/> good	<input type="checkbox"/> ruins	<input checked="" type="checkbox"/> altered	<input type="checkbox"/> moved	date _____ N/A
<input checked="" type="checkbox"/> fair	<input type="checkbox"/> unexposed			

Describe the present and original (if known) physical appearance

Montrose (c.1880) is a modest, single story, frame, late Greek Revival plantation house located in a rural setting near Roundaway Bayou approximately 6 1/2 miles southeast of Tallulah. Despite several additions, the house retains most of its original features and consequently its architectural value in Madison Parish.

Although documentary sources indicate that a house existed at Montrose as early as 1841, the architectural evidence indicates that the present house, in all likelihood, dates from about 1880. It has a central hall plan, one room deep, and a rear dining room wing. Originally there was a rear gallery, but it has since been enclosed and extended. The five-bay front facade has a five-bay gallery. The house is surmounted by a four plane bell cast pitched roof. Each of the three rooms has an end wall chimney. The house has two primitive features which belie its late date. These are the crude square front gallery posts and the hewn wooden piers which support the circular sawn frame structure. However, its late date is affirmed by the clapboard sheathing under the galleries (which in Louisiana is found almost exclusively in the late-nineteenth century or later) and the Victorian influenced mantels. The two remaining original mantels consist of heavy Greek Revival aedicule motifs with cyma recta moldings and Gothic arches cut in the lower portions of the entablatures. Unlike the mantels, the front doorway with its transom and side lights is pure Greek Revival.

Evidently in the early-twentieth century a pair of side galleries were added and one of the three original mantels was replaced by a crude Colonial Revival style mantel. Also, the original gallery balustrades were replaced.

More recent changes include:

- (1) the extension and enclosure of the old rear gallery;
- (2) the enclosure of the rear portions of the side galleries;
- (3) the construction of an extension to the original dining room wing which included a new gallery on the east side (now screened in); and
- (4) the addition of a small rear overhang to connect the house with an adjacent garage.

Assessment of Integrity:

Montrose's significance is based upon the fact that it is a provincial Greek Revival plantation house. All of the features which establish this identity are intact. Subsequent exterior appendages have not obscured them; they are still plainly visible and easily discernible.

8. Significance

Period	Areas of Significance—Check and justify below			
<input type="checkbox"/> prehistoric	<input type="checkbox"/> archeology-prehistoric	<input type="checkbox"/> community planning	<input type="checkbox"/> landscape architecture	<input type="checkbox"/> religion
<input type="checkbox"/> 1400–1499	<input type="checkbox"/> archeology-historic	<input type="checkbox"/> conservation	<input type="checkbox"/> law	<input type="checkbox"/> science
<input type="checkbox"/> 1500–1599	<input type="checkbox"/> agriculture	<input type="checkbox"/> economics	<input type="checkbox"/> literature	<input type="checkbox"/> sculpture
<input type="checkbox"/> 1600–1699	<input checked="" type="checkbox"/> architecture	<input type="checkbox"/> education	<input type="checkbox"/> military	<input type="checkbox"/> social/ humanitarian
<input type="checkbox"/> 1700–1799	<input type="checkbox"/> art	<input type="checkbox"/> engineering	<input type="checkbox"/> music	<input type="checkbox"/> theater
<input checked="" type="checkbox"/> 1800–1899	<input type="checkbox"/> commerce	<input type="checkbox"/> exploration/settlement	<input type="checkbox"/> philosophy	<input type="checkbox"/> transportation
<input type="checkbox"/> 1900–	<input type="checkbox"/> communications	<input type="checkbox"/> industry	<input type="checkbox"/> politics/government	<input type="checkbox"/> other (specify)
		<input type="checkbox"/> invention		

Specific dates c.1880 **Builder/Architect** Probable Builder: George W. Montgomery, Sr.

Statement of Significance (in one paragraph) Criterion C

Montrose is locally significant in the area of architecture because it is a rare surviving example of a Greek Revival plantation house within the context of Madison Parish.

Montrose is a relatively late, provincial example of a modest size Greek Revival plantation house. This can be seen in the five-bay gallery with its simple posts and entablature, as well as in the mantels, the plan, the basic form, and the central front doorway.

Greek Revival plantation houses were undoubtedly once common in Madison Parish, as can be seen by examining the 1860 census records for the parish. The population of the parish was 88% slaves and there were 99 large slaveholdings (i.e., 50 or more slaves). Of these 99, the average size of a slaveholding was 89.6. The absentee ownership rate was 40%. Hence of the 99 large slaveholdings in the parish, 61 of them involved individuals who resided there. Also, presumably there were many more holdings of less than 50 slaves. Given these statistics, it would be plausible to estimate that there may have been as many as 50 to 75 Greek Revival plantation houses in the parish on the eve of the Civil War. Today little remains of this once impressive building stock. As far as the State Historic Preservation Office can determine, Montrose stands as one of three surviving Greek Revival plantation houses in the parish.

9. Major Bibliographical References

Madison Parish Conveyance Records
Survey of Madison Parish Conducted by Division of Historic Preservation National Register
Staff, February 1981.
Menn, Joseph K. The Large Slaveholders of Louisiana, 1860. New Orleans: Pelican Publishing
Company, 1964.

10. Geographical Data

Acreeage of nominated property approx. .5 acre

Quadrangle name Talla Bena, La./Miss.

Quadrangle scale 1=62500

UMT References

A

1	5	6	7	5	1	2	5	3	5	7	7	6	2	5
Zone			Easting				Northing							

B

Zone			Easting				Northing							

C

Zone			Easting				Northing							

D

Zone			Easting				Northing							

E

Zone			Easting				Northing							

F

Zone			Easting				Northing							

G

Zone			Easting				Northing							

H

Zone			Easting				Northing							

Verbal boundary description and justification

Please refer to sketch map.

List all states and counties for properties overlapping state or county boundaries

state	code	county	code
N/A			

state	code	county	code
-------	------	--------	------

11. Form Prepared By

name/title Mr. and Mrs. Clement M. Dahlhausser

organization N/A

date July 1982

street & number Route 3, Box 237

telephone (318) 574-0424

city or town Tallulah

state LA 71282

12. State Historic Preservation Officer Certification

The evaluated significance of this property within the state is:

national state local

As the designated State Historic Preservation Officer for the National Historic Preservation Act of 1966 (Public Law 89-665), I hereby nominate this property for inclusion in the National Register and certify that it has been evaluated according to the criteria and procedures set forth by the National Park Service.

State Historic Preservation Officer signature

Robert B. DeBlieux
Robert B. DeBlieux

title State Historic Preservation Officer

date August 18, 1982

For NPS use only

I hereby certify that this property is included in the National Register

Francis M. Dwyer
Keeper of the National Register

date 10/5/82

Patrick W. Andrews
Chief of Registration

date 10/5/82

for

APPROX. 0.12 MILES
TO TALLULAH

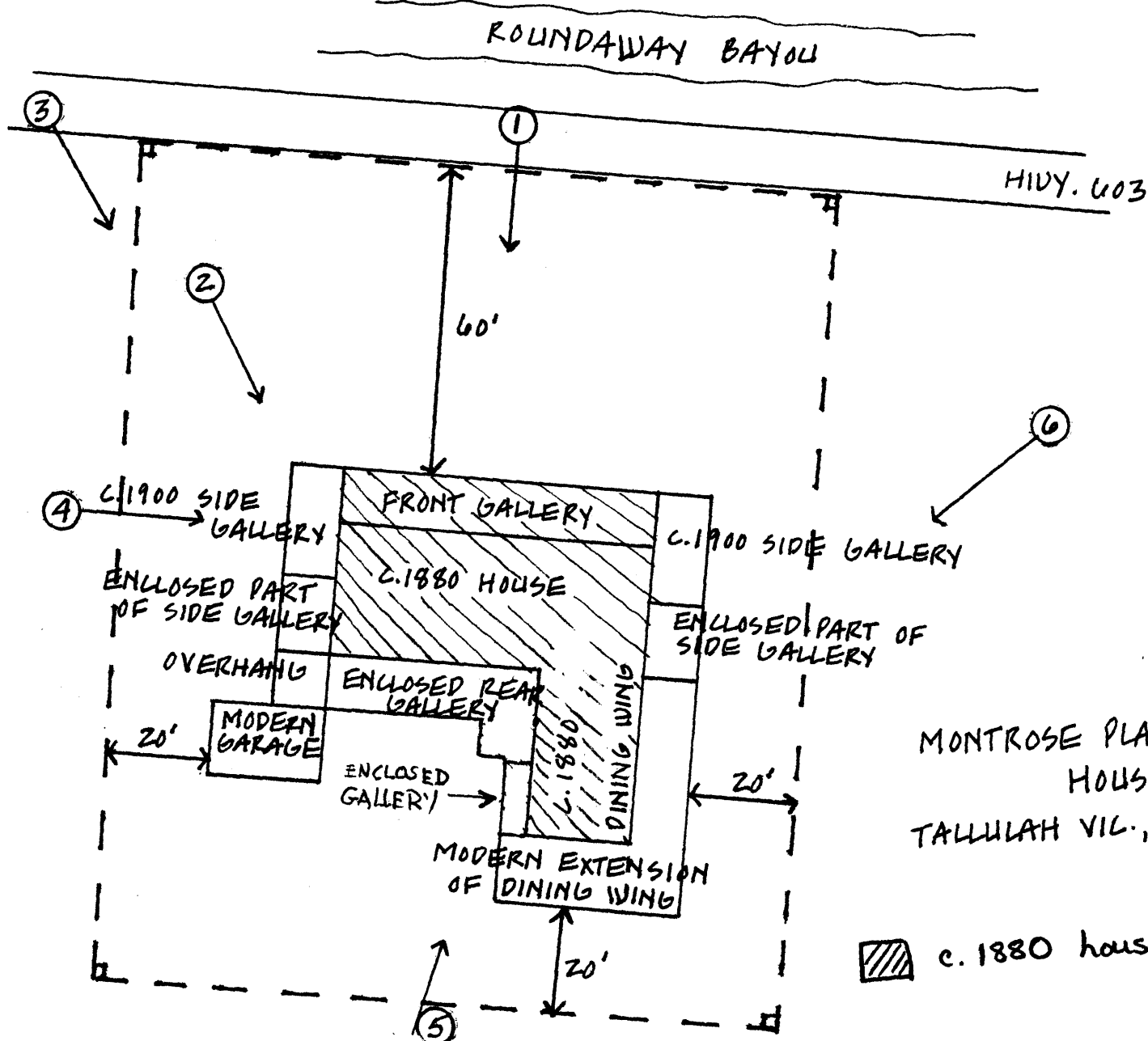

MONTROSE PLANTATION
HOUSE
TALLULAH VIL., LOUISIANA

 c. 1880 house

NOTE: SITE BOUNDARIES
PARALLEL BLDG. FACADES
AT DISTANCES SHOWN. BLDG.
CONFIGURATION
IS INCORRECT ON U.S.G.S. MAP,
THEREFORE THE SKETCH MAP
SUPERCEDES THE U.S.G.S. MAP.

SCALE 1"=30' APPROX.