

UNITED STATES DEPARTMENT OF THE INTERIOR
NATIONAL PARK SERVICE

PH0673889

FOR NPS USE ONLY	
RECEIVED	MAY 1 1979
DATE ENTERED	JUL 6 1979

**NATIONAL REGISTER OF HISTORIC PLACES
INVENTORY -- NOMINATION FORM**

SEE INSTRUCTIONS IN *HOW TO COMPLETE NATIONAL REGISTER FORMS*
TYPE ALL ENTRIES -- COMPLETE APPLICABLE SECTIONS

1 NAME

HISTORIC

Glen Mary Plantation and Tenant House

AND/OR COMMON

Glen Mary Plantation and Tenant House

2 LOCATION

STREET & NUMBER

Route 5, Box 583, Foster Mound Road

NOT FOR PUBLICATION

CITY, TOWN

Natchez

CONGRESSIONAL DISTRICT

Fourth

VICINITY OF

STATE

Mississippi

CODE

28

COUNTY

Adams

CODE

1

3 CLASSIFICATION

CATEGORY

OWNERSHIP

STATUS

PRESENT USE

DISTRICT

PUBLIC

OCCUPIED

AGRICULTURE

MUSEUM

BUILDING(S)

PRIVATE

UNOCCUPIED (Tenant House)

COMMERCIAL

PARK

STRUCTURE

BOTH

WORK IN PROGRESS

EDUCATIONAL

PRIVATE RESIDENCE

SITE

PUBLIC ACQUISITION

ACCESSIBLE

ENTERTAINMENT

RELIGIOUS

OBJECT

IN PROCESS

YES: RESTRICTED

GOVERNMENT

SCIENTIFIC

BEING CONSIDERED

YES: UNRESTRICTED

INDUSTRIAL

TRANSPORTATION

NO

MILITARY

OTHER:

4 OWNER OF PROPERTY

NAME

Mr. and Mrs. Marion Smith

STREET & NUMBER

Route 5, Box 583, Foster Mound Road

CITY, TOWN

Natchez

VICINITY OF

STATE

Mississippi 39120

5 LOCATION OF LEGAL DESCRIPTION

COURTHOUSE,
REGISTRY OF DEEDS, ETC.

Office of the Chancery Clerk
Adams County Courthouse

STREET & NUMBER

Courthouse Square

CITY, TOWN

Natchez

STATE

Mississippi 39120

6 REPRESENTATION IN EXISTING SURVEYS

TITLE

Statewide Survey of Historic Sites

DATE

1977

FEDERAL STATE COUNTY LOCAL

DEPOSITORY FOR
SURVEY RECORDS

Mississippi Department of Archives and History

CITY, TOWN

Jackson

STATE

Mississippi 39205

7 DESCRIPTION

CONDITION		CHECK ONE		CHECK ONE	
<input checked="" type="checkbox"/> EXCELLENT (Plantation House)	<input checked="" type="checkbox"/> DETERIORATED (Tenant House)	<input type="checkbox"/> UNALTERED	<input checked="" type="checkbox"/> ORIGINAL SITE	<input type="checkbox"/> MOVED	DATE _____
<input type="checkbox"/> GOOD	<input type="checkbox"/> RUINS	<input checked="" type="checkbox"/> ALTERED			
<input type="checkbox"/> FAIR	<input type="checkbox"/> UNEXPOSED				

DESCRIBE THE PRESENT AND ORIGINAL (IF KNOWN) PHYSICAL APPEARANCE

Glen Mary, a rectangular plantation house facing northeast, sits prominently on an imposing knoll, accented by a one-acre pond on the northeast, five miles northeast of Natchez and two miles west of Washington, near St. Catherine Creek on Foster Mound Road, approximately one-half mile south of Foster Mound, in Adams County, Mississippi.

The building is a large (forty-eight by sixty-four feet) one-and-a-half-story frame structure in the Greek Revival style, dating to the mid-nineteenth century. The house, with an undercut gallery across the front, sits on a foundation of two-by-four foot brick piers, topped by a high gable roof, and divided on the north (front) facade into five bays by six original wooden columns approximately one foot square with modified Roman Doric wooden capitals. The columns are connected with banisters and balusters. New wooden steps with wooden hand rails, matching the original balustrades, have replaced concrete steps installed in 1941. The north facade is divided into five bays defined by six-over-six sash with matched boarding and by the presence in the center bay of a Greek Revival entryway containing a rectangular transom with an inset transom bar set over a single door with four raised panels, two of which replace a sash inserted in 1941. The exterior door surround is battered with backboard, and the head casing is eared and peaked at the center with backboard mold. The wide lock rail is fully mortised and about one-and-five-eighths inches thick. Louvered blinds modeled after remaining original ones complete the symmetrically spaced window bays.

The east (side) elevation of the original building has an original free-standing chimney tapered above the first-floor fireplace to a single flue just forward of the main roof ridge. This elevation also has three asymmetrically spaced six-over-six windows on the first floor of the original building and two six-over-six windows opening into the former attic, located asymmetrically on the gable and the chimney. A break in the wall line carefully differentiates the original house and a 1977-78 addition to the rear. Two asymmetrically spaced six-over-six windows are on the first floor of the new wing. A partial basement under the new wing has one rectangular window with wooden crossbars and an entryway with a rectangular transom set over a single door with four raised panels. The entryway is reached by a short flight of brick steps running parallel to the east side of the house and bounded by banisters and balusters similar to those on the front gallery. One six-over-six window bay is on the second floor of the new wing. All but the basement windows are completed with louvered blinds, some of which are original.

The west side elevation is similar to the east in most respects. A small enclosed stoop with shed roof surrounds an entryway into the wing added in 1977-78. A single six-over-six window on the first floor and no bays on the second floor of the new wing complete the west side.

The south facade is divided on the first floor in the center into three short bays by two whole columns and two half columns, with an undercut fourteen-foot gallery. Two six-over-six windows flank two doors with single-light sash and a rectangular two-light transom. The gallery columns are connected with banisters and balusters. In the center are a small stoop and two sets of wooden steps leading east and west to the south garden. Banisters and balusters connect the steps. Also on the rear side elevation are one six-over-six window on the first floor, west side; two rectangular windows with wooden crossbars on the basement level, east side; and two symmetrically spaced six-over-six windows in the attic.

8 SIGNIFICANCE

PERIOD	AREAS OF SIGNIFICANCE -- CHECK AND JUSTIFY BELOW			
<input type="checkbox"/> PREHISTORIC	<input checked="" type="checkbox"/> ARCHEOLOGY-PREHISTORIC	<input type="checkbox"/> COMMUNITY PLANNING	<input type="checkbox"/> LANDSCAPE ARCHITECTURE	<input type="checkbox"/> RELIGION
<input type="checkbox"/> 1400-1499	<input type="checkbox"/> ARCHEOLOGY-HISTORIC	<input type="checkbox"/> CONSERVATION	<input type="checkbox"/> LAW	<input type="checkbox"/> SCIENCE
<input type="checkbox"/> 1500-1599	<input type="checkbox"/> AGRICULTURE	<input type="checkbox"/> ECONOMICS	<input type="checkbox"/> LITERATURE	<input type="checkbox"/> SCULPTURE
<input type="checkbox"/> 1600-1699	<input checked="" type="checkbox"/> ARCHITECTURE	<input type="checkbox"/> EDUCATION	<input type="checkbox"/> MILITARY	<input type="checkbox"/> SOCIAL/HUMANITARIAN
<input type="checkbox"/> 1700-1799	<input type="checkbox"/> ART	<input type="checkbox"/> ENGINEERING	<input type="checkbox"/> MUSIC	<input type="checkbox"/> THEATER
<input checked="" type="checkbox"/> 1800-1899	<input type="checkbox"/> COMMERCE	<input type="checkbox"/> EXPLORATION/SETTLEMENT	<input type="checkbox"/> PHILOSOPHY	<input type="checkbox"/> TRANSPORTATION
<input type="checkbox"/> 1900-	<input type="checkbox"/> COMMUNICATIONS	<input type="checkbox"/> INDUSTRY	<input type="checkbox"/> POLITICS/GOVERNMENT	<input type="checkbox"/> OTHER (SPECIFY)
		<input type="checkbox"/> INVENTION		

SPECIFIC DATES

BUILDER/ARCHITECT

STATEMENT OF SIGNIFICANCE

Glen Mary is a very impressive example of a prosperous Greek Revival plantation house associated for many years with pioneer Mississippians, the Foster family, and probably named after either Mary Foster (1727-1819), the pioneer mother of the family, or Mary Maury Foster (1811-1883), wife of William James Foster, who lived at nearby Foster Mound in the nineteenth century. The name Glen Mary was used at least as early as the late 1860s (Adams Co., Miss., Deed Book QQ:429). The house faces historic Foster Mound Road, an early crossroad linking the town of Washington and the Pine Ridge community. It is on the site of early Indian activity, evidenced by a large Indian mound nearby on which sits Foster Mound, and by the many discoveries on Glen Mary Plantation of projectile points and flint. Except for 40 acres, the historic lands of the plantation, comprising 320 acres, remain intact in a single family.

The house was built between 1839 and 1860, though interior evidence shows recycled framing materials from an earlier date than 1839. The house is possibly on the site of a former building of an earlier date, according to the Foster family. The original front-door cast-iron rimlock case was made by the Russell and Erwin Company of Berlin, Connecticut, which began business in 1839. Foster family tradition and the United States Census of 1860 of Adams County, Miss., hold that the William Peter Smith Foster family resided there in 1860. Family tradition also holds that a house was on the property when W. P. S. Foster was given it in 1854 by his parents, William James and Mary Maury Foster, who lived at nearby Foster Mound, then called The Mound or The Mount. The census of 1850 states that the children of William James and Mary Foster lived in a next-door household, probably Glen Mary. Evidence of construction in the early part of the nineteenth century includes the species of wood used in construction (green poplar, magnolia, oak, cypress, and pine); the method of cutting with whip or pit saw; the inch-and-three-fourths width of window frames; no interior or exterior casings on doors and windows; and the use of verge rafters and barge mold. Evidence of mid-nineteenth-century construction includes cut nails with machine-made heads; wood-graining of interior doors to resemble a type of golden oak; marbleizing of mantels and baseboards; and sawn pine laths under wall and ceiling plaster of river-sand lime mixed with horse-hair fibers. Special features are the ten-inch baseboards with molded wood base installed over a plaster ground, interior casings beaded a nominal six inches with molded backband, and stool aprons of the windows beaded and returned at the end. The size and proportion of the rooms indicate the better than average affluence of the original builder.

The property occupies part of a Spanish land grant of 1787 to Richard Harrison, who sold it to James Foster (1752-1835) prior to 1805 (Bureau of Land Management Private Claim #A-346, Commissioner's certificate issued June 20, 1805, based on a Spanish patent dated Feb. 15, 1787). According to Foster family records, James Foster, a Revolutionary War soldier in

9 MAJOR BIBLIOGRAPHICAL REFERENCES

Adams Co., Miss. Chancery Clerk. Deed Books, Bureau of Land Management Private Claims. Division Real Estate Record Book 1.

Addkison, H. M., Jr. Letter. Feb. 6, 1979. Statewide Survey File. Adams Co., Washington. Mississippi Department of Archives and History, Jackson. Glen Mary File.

10 GEOGRAPHICAL DATA

ACREAGE OF NOMINATED PROPERTY 16 acres, more or less, in two parts

QUADRANGLE NAME Washington, Miss. QUADRANGLE SCALE 1:24000

UTM REFERENCES

A	1,5	6,5,8	4,6,5	3,4	9,6	4,5,5	B	1,5	6,5,8	7,8,0	3,4	9,6	4,0,5
	ZONE	EASTING	NORTHING		ZONE	EASTING		ZONE	EASTING	NORTHING		ZONE	EASTING
C	1,5	6,5,8	9,2,5	3,4	9,6	6,4,5	D	1,5	6,5,8	6,2,0	3,4	9,6	6,5,0
E							F						
G							H						

VERBAL BOUNDARY DESCRIPTION

Glen Mary: From the northwest corner of that 15.36 acre tract conveyed to Marion Smith and Carolyn V. Smith, husband and wife, by Frank Levon Smith, the same being a part of Glen Mary Plantation run thence in a general easterly direction along the center line of the Foster

LIST ALL STATES AND COUNTIES FOR PROPERTIES OVERLAPPING STATE OR COUNTY BOUNDARIES

STATE	CODE	COUNTY	CODE
STATE	CODE	COUNTY	CODE

11 FORM PREPARED BY

NAME / TITLE
Carolyn V. Smith (Mrs. Marion Smith)

ORGANIZATION
Owner of Glen Mary

STREET & NUMBER
Route 5, Box 583, Foster Mound Road

CITY OR TOWN
Natchez

DATE
February 21, 1979

TELEPHONE
601-445-5955

STATE
Mississippi 39120

12 STATE HISTORIC PRESERVATION OFFICER CERTIFICATION

THE EVALUATED SIGNIFICANCE OF THIS PROPERTY WITHIN THE STATE IS:

NATIONAL STATE LOCAL

As the designated State Historic Preservation Officer for the National Historic Preservation Act of 1966 (Public Law 89-665), I hereby nominate this property for inclusion in the National Register and certify that it has been evaluated according to the criteria and procedures set forth by the National Park Service.

STATE HISTORIC PRESERVATION OFFICER SIGNATURE Elmer R. Williams

TITLE State Historic Preservation Officer DATE April 25, 1979

FOR NPS USE ONLY

I HEREBY CERTIFY THAT THIS PROPERTY IS INCLUDED IN THE NATIONAL REGISTER

Arath V. Bridges for
KEEPER OF THE NATIONAL REGISTER DATE 7/6/79

ATTEST: Jan H. Gilmore
CHIEF OF REGISTRATION DATE 7/2/79

UNITED STATES DEPARTMENT OF THE INTERIOR
NATIONAL PARK SERVICE

**NATIONAL REGISTER OF HISTORIC PLACES
INVENTORY -- NOMINATION FORM**

FOR NPS USE ONLY	
RECEIVED	MAY 1 1979
DATE ENTERED	JUL 6 1979

CONTINUATION SHEET

ITEM NUMBER 4 & 7 PAGE 1

4 - OWNER OF PROPERTY

Mrs. F. L. Smith
305 High Street
Natchez, Mississippi 39120

Dr. and Mrs. John E. Wimberly
3960 Raintree Drive
Pensacola, Florida 32503 ✓

Mr. and Mrs. F. L. Smith, Jr.
Route 6
Natchez, Mississippi 39120

7 - DESCRIPTION

The high gable roof is finished with a verge rafter and barge board. The present composition fire-rated roof replaces the original wood shingle roof on shingle lath, in place in 1977. Exterior clapboards are beveled and installed with corner boards. A cistern, now unused, remains in place under the new rear addition.

The original part of the house has a twelve-foot-wide central hall flanked by two rooms on each side. All interior doors have four rectangular panels and original cast-iron rimlock cases and cast-iron fixed pin hinges. Fireplaces in the front two rooms have simple wood mantels, one of which is original and the other partially original. Interior doors, painted over before 1941, were originally wood-grained a type of golden oak, and mantels and baseboards were marbled black and gray. The flooring is random-width standard-matched cypress original in all but one room, which has new cypress stained to match the original. A new stairway in the hall leads to the attic bedrooms. It replaced an old steep stairway housed in the southwest room and removed in 1941. Original damaged plaster was removed in 1977, and a thin coat of plaster added to gypsum board over laths in the 1977-78 remodeling.

The 1977-78 addition to the house replaced a badly deteriorated 1941 addition built where a three-room rectangular dependency stood until 1941, parallel to the rear facade. The 1977-78 addition to the first floor, the four-room attic, and the one-room basement were finished with salvaged material similar to that in the original part of the house.

Similar to the Glen Mary plantation house in some ways is the nearby Glen Mary tenant house, facing southwest on Foster Mound Road about one-half mile east of the plantation house. The tenant house is a one-story frame gable-end structure with a tin roof and an undercut thirty-foot gallery across the front. The site is adjacent to an early plantation crossroad. The two-room house is small (twenty-one by thirty feet), with a small lean-to (nine by eighteen feet) on the northeast corner. A cistern on the northwest corner is in

UNITED STATES DEPARTMENT OF THE INTERIOR
NATIONAL PARK SERVICE

**NATIONAL REGISTER OF HISTORIC PLACES
INVENTORY -- NOMINATION FORM**

FOR NPS USE ONLY	
RECEIVED	MAY 1 1979
DATE ENTERED	JUL 6 1979

CONTINUATION SHEET

ITEM NUMBER 7 & 8 PAGE 2

7 - DESCRIPTION

line with the west side of the building and sits ten feet to the rear. Originally white-washed, the building has a box frame, verge trim on front and sides, board-and-batten cypress walls and gallery ceiling, and original brick piers. The front four-bay facade is broken by two doors with Philadelphia hinges and two windows without sash but with parts of original wooden blinds and hardware. Columns and gallery floor are missing. Side elevations have one bay each, originally windows, but now doors. The rear two-bay facade also originally had two windows, now doors, one of which leads to the lean-to, once used as a kitchen and now almost deteriorated. The two major rooms of the building have original mill-run pine flooring and a central tapered brick chimney with fireplaces opening into both rooms. The exterior walls are not covered with an interior wall; the only covering is what remains of wallpaper and cardboard. There is no ceiling.

8 - SIGNIFICANCE

South Carolina, migrated with other family members in the 1780s to the Natchez area. He eventually acquired land in the St. Catherine Creek area and made his home atop a large Natchez Indian mound in an expanded log cabin called first Mount Pleasant, then The Mount, The Mound, and Foster Mound. He and his brothers, Thomas, John, and William, became successful planters. Thomas (1762-1829) owned for over forty years Ibrahima, an American slave called "Prince" because he had been born son to a king in West Africa. James and Thomas were organizing members in 1807 of the Pine Ridge Presbyterian Church, and James, John, and Randall Gibson gave land in Washington which became the site of Jefferson College. James and his wife Elizabeth Smith Brassfield (1763-1837) had several children, one of whom, William James Foster (1798-1870), inherited in 1838 Lot 3 of James Foster's estate (Division Real Estate Record Book 1:332) and acquired from family heirs in 1846-49 Lot 2, upon which Glen Mary is now located (Deed Books FF:518, FF:520, HH:91). The property went on July 24, 1854, to the son of James and Mary Foster, William Peter Smith Foster (1837-1881) (Deed Book KK:571), who by 1860 lived in Glen Mary with his wife Laura and a small child. The property remained in the Foster family until 1902, when it was sold to the Zurhellen family (Deed Book 3W:74). In 1941 the property was bought by Mrs. Annie McLain Smith, grandmother of the present owners and a descendant of several outstanding pioneer Mississippi families (Deed Book 5B:67).

The house, though sturdy and occupied continuously through the years, suffered much abuse, particularly from 1902 to 1941. In 1941 the disintegrating three-room dependency at the rear used as a kitchen was removed, the house restored, and two small wings and a porch added. From 1952 to 1977 the house was again abused by tenants. The present owners purchased the house and 15.36 acres of the plantation from family members in 1976 and began a careful restoration of the original building to its nineteenth-century state, while sympathetically adding space to the rear and to the attic.

UNITED STATES DEPARTMENT OF THE INTERIOR
NATIONAL PARK SERVICE

**NATIONAL REGISTER OF HISTORIC PLACES
INVENTORY -- NOMINATION FORM**

FOR NPS USE ONLY	
RECEIVED	MAY 1 1979
DATE ENTERED	JUL 6 1979

CONTINUATION SHEET

ITEM NUMBER 8 & 9 PAGE 3

8 - SIGNIFICANCE

The nearby unoccupied tenant house is important because it is the last of its kind on the plantation and one of the last in southwest Mississippi, and because it is in its original condition, dating, as evidenced by construction methods and materials, to about 1880. The house was standing at least by 1902 (Deed Book 3W:74) and was occupied by various Negro tenants through the years, one of whose descendants, Hezekiah Franklin, still lives nearby. The house faces historic Foster Mound Road as well as an early plantation crossroad. The present owners of Glen Mary own the tenant house and the remainder of the plantation in an undivided interest with other family members.

9 - MAJOR BIBLIOGRAPHICAL REFERENCES

Alford, Terry. Prince Among Slaves. New York: Harcourt Brace Jovanovic, 1977.

Foster, T. J. Letter. Aug. 17, 1977. Statewide Survey File. Adams Co., Washington. Mississippi Department of Archives and History, Jackson. Glen Mary File.

Foster, T. J. Interviewed by Carolyn V. Smith, owner of Glen Mary, at Natchez, Miss., Feb. 18, 1979.

Franklin, Hezekiah. Interviewed by Carolyn V. Smith, owner of Glen Mary, at Natchez, Miss., Feb. 11, 1979.

Gill, William Lampton. Interviewed by Carolyn V. Smith, owner of Glen Mary, at Natchez, Miss., Feb. 15, 1979.

Gill, William Lampton. Letters. Feb. 21, 1978; Feb. 15, 1979. Statewide Survey File. Adams Co., Washington. Mississippi Department of Archives and History, Jackson. Glen Mary File.

Lum, William D., and Mrs. Lennie Schuchs. "The Foster Family." May 2, 1965. Statewide Survey File. Adams Co., Washington. Mississippi Department of Archives and History, Jackson. Glen Mary File.

United States Census of 1850, Household #85, Family #81, and Household #86, Family #81, Adams County, Miss.; United States Census of 1860, Household #922, Family #922, and Household #923, Family #923. Mississippi Department of Archives and History, Jackson.

UNITED STATES DEPARTMENT OF THE INTERIOR
NATIONAL PARK SERVICE

**NATIONAL REGISTER OF HISTORIC PLACES
INVENTORY -- NOMINATION FORM**

FOR NPS USE ONLY	
RECEIVED	MAY 1 1979
DATE ENTERED	JUL 6 1979

CONTINUATION SHEET

ITEM NUMBER 10 PAGE 4

10 - GEOGRAPHICAL DATA

Mound Road 900' to a point; thence S17°38'W 700' to a point; thence in a western direction to the west line of the said 15.36 acre tract; thence along the westerly line of said 15.36 acre tract to the point of beginning, containing 15 acres, more or less. Tenant House: Beginning at a point on the easterly right-of-way line of the Foster Mound Road formed by the intersection of said easterly right-of-way line with the south line of Glen Mary Plantation; thence in a general easterly direction along the south line of Glen Mary Plantation 210' to a point; thence at a right angle to the left 210' to a point; then at a right angle to the left to the easterly right-of-way line of the Foster Mound Road; thence in a general southerly direction along said right-of-way line to the point of beginning, containing one (1) acre, more or less.

United States Department of the Interior
National Park Service

National Register of Historic Places Continuation Sheet

JUL 7 1987

Section number _____ Page _____

Glen Mary Plantation and Tenant House
Adams County, MS

Address change approved

for Keeper Alonzo Byrum 7/7/87

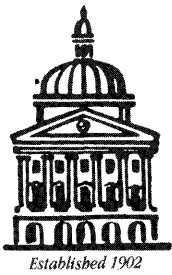

Mississippi Department of Archives and History

Post Office Box 571 • Jackson, Mississippi 39205-0571 • Telephone 601-359-1424
Elbert R. Hilliard, Director

July 1, 1987

JUL 7

Ms. Carol D. Shull
Chief of Registration
National Register of Historic Places
Interagency Resources Division
National Park Service
Department of the Interior
P. O. Box 37127
Code 710
Washington, D. C. 20013-7127

Dear Ms. Shull:

After reviewing our National Register of Historic Places files, we have found that the following corrections need to be made:

- (1) First National Bank of Greenville, Washington County, listed January 30, 1978. The street address should be changed to the East corner of Main and South Poplar Streets. The location was correctly indicated on the map, but the address had been copied incorrectly on block 2 of the nomination form.
- ✓ (2) Glen Mary Plantation and Tenant House, Natchez, Adams County, listed July 6, 1979. The "vicinity of" block should be checked.
- (3) Richmond, Natchez, Adams County, listed November 16, 1978. The street address should be changed to Government Fleet Road. The name had been incorrectly given.

If you have any questions concerning these corrections, please contact Brenda Rubach at (601) 354-7326.

Sincerely,

Kenneth H. P'Pool
Deputy State Historic Preservation Officer

KHP/11

285 11 NW
150KNE

UNITED STATES
DEPARTMENT OF THE INTERIOR
GEOLOGICAL SURVEY

91°22'30"
31°37'30"

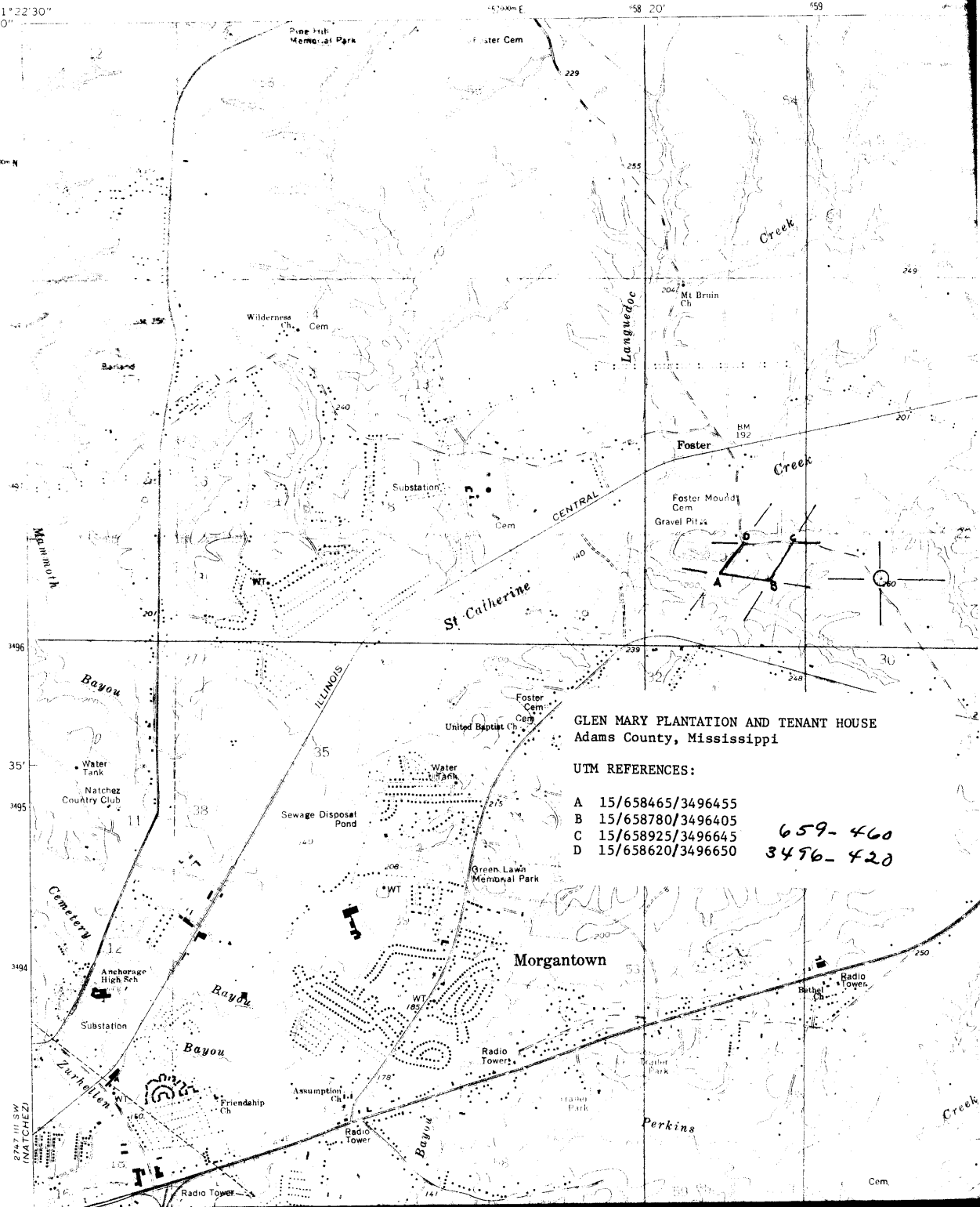

GLEN MARY PLANTATION AND TENANT HOUSE
Adams County, Mississippi

UTM REFERENCES:

- A 15/658465/3496455
- B 15/658780/3496405
- C 15/658925/3496645
- D 15/658620/3496650

659-460
3496-420

285 11 SW
150KNEZ