

**NATIONAL REGISTER OF HISTORIC PLACES
INVENTORY - NOMINATION FORM**

(Type all entries - complete applicable sections)

STATE: Minnesota	
COUNTY: Chisago	
FOR NPS USE ONLY	
ENTRY NUMBER 70,11,27.0027	DATE 11/20/70

1. NAME

COMMON:
Roos House

AND/OR HISTORIC:
Munch-Roos House

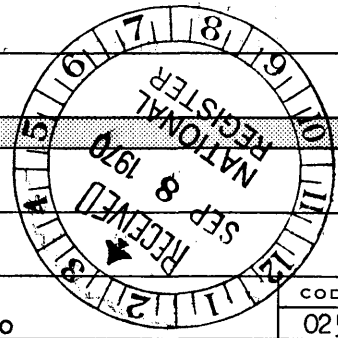

2. LOCATION

STREET AND NUMBER:
360 Bench St. (corner of 2nd and River Streets)

CITY OR TOWN:
Taylors Falls

STATE: **Minnesota** CODE: **55084** COUNTY: **Chisago** CODE: **025**

3. CLASSIFICATION

CATEGORY (Check One)	OWNERSHIP	STATUS	ACCESSIBLE TO THE PUBLIC
<input type="checkbox"/> District <input type="checkbox"/> Site <input type="checkbox"/> Object <input checked="" type="checkbox"/> Building <input type="checkbox"/> Structure	<input type="checkbox"/> Public <input checked="" type="checkbox"/> Private <input type="checkbox"/> Both	<input checked="" type="checkbox"/> Occupied <input type="checkbox"/> Unoccupied <input type="checkbox"/> Preservation work in progress <input type="checkbox"/> In Process <input type="checkbox"/> Being Considered	Yes: <input type="checkbox"/> Restricted <input type="checkbox"/> Unrestricted <input checked="" type="checkbox"/> No
PRESENT USE (Check One or More as Appropriate)			
<input type="checkbox"/> Agricultural <input type="checkbox"/> Commercial <input type="checkbox"/> Educational <input type="checkbox"/> Entertainment	<input type="checkbox"/> Government <input type="checkbox"/> Industrial <input type="checkbox"/> Military <input type="checkbox"/> Museum	<input type="checkbox"/> Park <input checked="" type="checkbox"/> Private Residence <input type="checkbox"/> Religious <input type="checkbox"/> Scientific	<input type="checkbox"/> Transportation <input type="checkbox"/> Other (Specify) _____ <input type="checkbox"/> Comments _____

4. OWNER OF PROPERTY

OWNER'S NAME:
Mr. and Mrs. John W. Larson

STREET AND NUMBER:
360 Bench Street

CITY OR TOWN: **Taylors Falls** STATE: **Minnesota** CODE: **2227**

5. LOCATION OF LEGAL DESCRIPTION

COURTHOUSE, REGISTRY OF DEEDS, ETC.:
Chisago County Courthouse

STREET AND NUMBER:

CITY OR TOWN: **Center City** STATE: **Minnesota** CODE: **2722**

6. REPRESENTATION IN EXISTING SURVEYS

TITLE OF SURVEY:
none

DATE OF SURVEY: Federal State County Local

DEPOSITORY FOR SURVEY RECORDS:

STREET AND NUMBER:

CITY OR TOWN: STATE: CODE:

SEE INSTRUCTIONS

STATE: **Minnesota**

COUNTY: **Chisago**

ENTRY NUMBER: **70,11,27.0027**

DATE: **11/20/70**

FOR NPS USE ONLY

7. DESCRIPTION

CONDITION	(Check One)					
	<input type="checkbox"/> Excellent	<input checked="" type="checkbox"/> Good	<input type="checkbox"/> Fair	<input type="checkbox"/> Deteriorated	<input type="checkbox"/> Ruins	<input type="checkbox"/> Unexposed
	(Check One)			(Check One)		
	<input type="checkbox"/> Altered	<input checked="" type="checkbox"/> Unaltered		<input type="checkbox"/> Moved	<input checked="" type="checkbox"/> Original Site	

DESCRIBE THE PRESENT AND ORIGINAL (if known) PHYSICAL APPEARANCE

The dominant element of the clapboard sided, wood frame structure is a 24'-2" by 36'-5" two story main element, the gable end of which faces the street. Perpendicular to it, and attached to its west side is a 24'-3" by 13'-11" one story kitchen wing. The building is sited close to the steep bank of the St. Croix River and most of the principal rooms have a view of the river and its dalles, the central feature of what is now Interstate Park. As in most early Minnesota examples of classicized houses of the Greek Revival era, this does not have a columned portico nor corner pilasters, but relies on the entrance with glass sidelights and transom, a full pediment enclosing a semi-circular louvered fan, regularly spaced windows and classic proportion for embellishment. Until its recent rehabilitation none of the town's oldest residents recall the building being painted, but faint vestiges of yellow on areas unexposed to weather encouraged its present owners to match that color on the siding. Trim is painted white.

Photographs of the exterior of the house taken in the late 1850's and 1860's indicate that with the exception of a change in the roofline on the porch at the street side of the kitchen wing, no alterations have been made to the exterior. The original porch roof line has now been restored. There are no exterior blinds, as none appeared on any of the early photographs. When the wood shed directly attached to and accessible from the rear of the ell was recently removed because of its ruinous state, foundations for an earlier structure was noted. These were probably the remnant of the carpentry shop of the original owners.

With the exception of extensive patching of plastered wall surfaces, repainting, electrification, the addition of modern toilet facilities in part of what was the old pantry, the creating of a vestibule for exterior doors opening into the one story ell, and the up grading of the remainder of the ell as a kitchen, no interior changes have been made.

Typical of many smaller houses of the classic revival, the main entrance is on one side of the front elevation. This entrance leads into a stair hall onto which opens the front parlor. The hall terminates in a dining room at the rear of the house. The stairway is on the outside west wall and is notable for its plain but handsome tiger maple handrailing. A small room east of the dining room; and the kitchen vestibule and bathroom in the ell to the west of the dining room comprise the rest of the main floor areas.

Below the stairway to the upper floor are stairs leading to a cellar under the front half of the two story wing. The cellar walls as well as the remainder of the foundation structure are of local sandstone. The cellar floor consists of two layers of brick.

The upper floor has four bedrooms and a trunk storage room on the south, east and north sides of the building opening onto a large square shaped central hall at the top of the stairs.

Woodwork throughout the house except for the stair handrail is painted pine and is plain without moulding. As in many of the earlier houses of the area the inside face of the window and door frames are set flush with the plastered wall.

Heating is still furnished by stoves.

SEE INSTRUCTIONS



SIGNIFICANCE

PERIOD (Check One or More as Appropriate)

- | | | | |
|--|---------------------------------------|--|---------------------------------------|
| <input type="checkbox"/> Pre-Columbian | <input type="checkbox"/> 16th Century | <input type="checkbox"/> 18th Century | <input type="checkbox"/> 20th Century |
| <input type="checkbox"/> 15th Century | <input type="checkbox"/> 17th Century | <input checked="" type="checkbox"/> 19th Century | |

SPECIFIC DATE(S) (If Applicable and Known)

AREAS OF SIGNIFICANCE (Check One or More as Appropriate)

- | | | | |
|--|--------------------------------------|--|--|
| <input type="checkbox"/> Aboriginal | <input type="checkbox"/> Education | <input type="checkbox"/> Political | <input type="checkbox"/> Urban Planning |
| <input type="checkbox"/> Prehistoric | <input type="checkbox"/> Engineering | <input type="checkbox"/> Religion/Philosophy | <input type="checkbox"/> Other (Specify) |
| <input type="checkbox"/> Historic | <input type="checkbox"/> Industry | <input type="checkbox"/> Science | _____ |
| <input type="checkbox"/> Agriculture | <input type="checkbox"/> Invention | <input type="checkbox"/> Sculpture | _____ |
| <input checked="" type="checkbox"/> Architecture | <input type="checkbox"/> Landscape | <input type="checkbox"/> Social/Humanitarian | _____ |
| <input type="checkbox"/> Art | <input type="checkbox"/> Literature | <input type="checkbox"/> Theater | _____ |
| <input type="checkbox"/> Commerce | <input type="checkbox"/> Military | <input type="checkbox"/> Transportation | _____ |
| <input type="checkbox"/> Communications | <input type="checkbox"/> Music | | |
| <input type="checkbox"/> Conservation | | | |

STATEMENT OF SIGNIFICANCE

The Munch-Roos house was built in 1853 by the Munch Brothers; Emil, Adolph and Paul; who immigrated to this country from Prussia in 1849 and to Taylors Falls in 1852. The brothers lived in the house and operated a carpentry shop immediately north of it until about 1857. Paul and Emil became Union Officers in the Civil War. Emil also fought against the Minnesota Sioux in their uprising of 1863 and later served as Minnesota State Treasurer from 1868 to 1872. The house is most closely associated with the Roos Family which occupied the building for almost 100 years to 1965. Oscar Roos together with two friends arrived in Minnesota in 1850 as stated on a stone monument near Scandia, Minnesota. These men are said by some sources to be the first permanent Swedish settlers in the state. As a banker, real estate man, and federal, town and state official, Mr. Roos had a prominent role in the early development of the region. Its historic significance as the home of one of Minnesota's earliest Swedish settlers has been recognized by the American Institute of Swedish Arts, Literature and Sciences and this organization as well as the Minnesota Historical Society have sponsored tours of the building.

Architecturally the building is an excellent example of a classicized house of the Greek Revival era, particularly as it appeared in more modest homes of the northern tier of American States from the 1820's to the 1850's.

While many of this type of house were built in territorial Minnesota, few remain, and fewer still are in such relatively unaltered state.

SEE INSTRUCTIONS

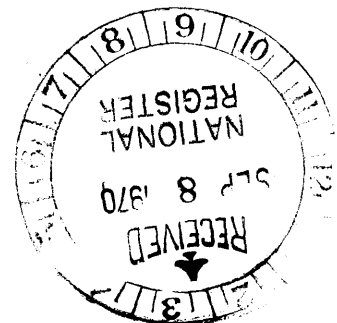

9 MAJOR BIBLIOGRAPHICAL REFERENCES

History of Washington County and the St. Croix Valley, George E. Warner & Charles M. Foote, EDS, North Star Pub. Co. 1881 p. 205.
Minnesota Houses - An Architectural and Historical View, Roger Kennedy, Dillon Press 1967 p. 93.
Fifty Years in the Northwest, W.H.C. Folsom Pioneer Press Pub. Co. 1888.
Standard Press, St. Croix Falls, Wisconsin, March 25, 1970.
Minnesota Biographies, Minnesota Historical Society Collections vol. XIV 1912 P. 532.
Taylor's Falls Journal, Taylor's Falls, Minnesota, Sept. 8, 1887.

10. GEOGRAPHICAL DATA

LATITUDE AND LONGITUDE COORDINATES DEFINING A RECTANGLE LOCATING THE PROPERTY			O R	LATITUDE AND LONGITUDE COORDINATES DEFINING THE CENTER POINT OF A PROPERTY OF LESS THAN TEN ACRES		
CORNER	LATITUDE	LONGITUDE		LATITUDE	LONGITUDE	
	Degrees Minutes Seconds	Degrees Minutes Seconds		Degrees Minutes Seconds	Degrees Minutes Seconds	
NW	° ' "	° ' "		45° 39' 13"	92° 39' 20.4"	
NE	° ' "	° ' "				
SE	° ' "	° ' "				
SW	° ' "	° ' "				

APPROXIMATE ACREAGE OF NOMINATED PROPERTY: 1 acre

LIST ALL STATES AND COUNTIES FOR PROPERTIES OVERLAPPING STATE OF MINNESOTA

STATE:	CODE	COUNTY	CODE

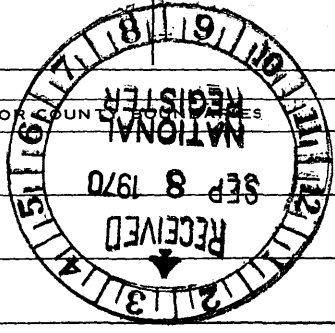

SEE INSTRUCTIONS

11. FORM PREPARED BY

NAME AND TITLE:
Brooks Cavin, A.I.A.

ORGANIZATION: Cavin & Page DATE: August 4, 1970

STREET AND NUMBER:
102 Hubbard Building, 2675 University Avenue

CITY OR TOWN: St. Paul STATE: Minnesota CODE: 22

12. STATE LIAISON OFFICER CERTIFICATION NATIONAL REGISTER VERIFICATION

As the designated State Liaison Officer for the National Historic Preservation Act of 1966 (Public Law 89-665), I hereby nominate this property for inclusion in the National Register and certify that it has been evaluated according to the criteria and procedures set forth by the National Park Service. The recommended level of significance of this nomination is:

National State Local

Name: Russell W. Fridley

Title: Director, Minnesota Historical Society

Date: _____

I hereby certify that this property is included in the National Register.

Ernest Allen Connolly
 Chief, Office of Archeology and Historic Preservation

NOV 20 1970

Date: _____

ATTEST:

William J. Montoya
 Keeper of The National Register

Date: OCT 20 1970

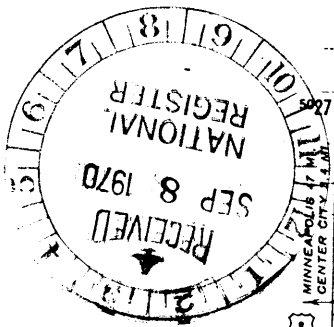

U. S. G. S. 15' Quadrangle
St. Croix Dalles, Minn.--Wisc. 1955
Roos House
Scale: 1:62500

Lat. 45° 39' 13"
Long. 92° 39' 20.4"

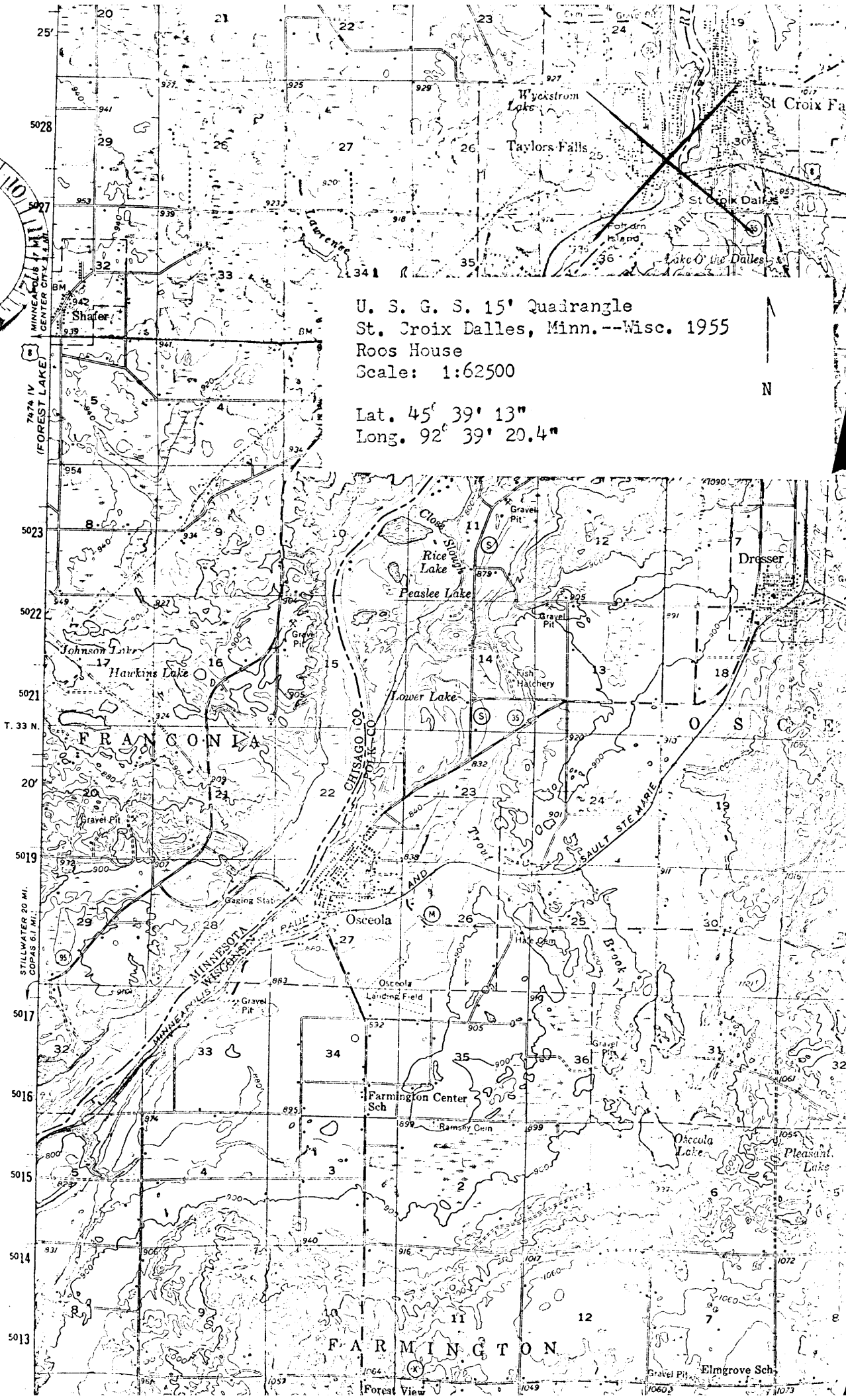

Form 10-301
(Dec. 1968)

UNITED STATES DEPARTMENT OF THE INTERIOR
NATIONAL PARK SERVICE

**NATIONAL REGISTER OF HISTORIC PLACES
PROPERTY MAP FORM**

(Type all entries - attach to or enclose with map)

STATE	
Minnesota	
COUNTY	
Chisago	
FOR NPS USE ONLY	
ENTRY NUMBER	DATE
70.11.27.0027	11/20/70

SEE INSTRUCTIONS

1. NAME			
COMMON:		Roos House	
AND/OR HISTORIC:		Munch-Roos House	
2. LOCATION			
STREET AND NUMBER:			
360 Bench Street			
CITY OR TOWN:			
Taylors Falls			
STATE:	CODE	COUNTY:	CODE
Minnesota	22	Chisago	025
3. MAP REFERENCE			
SOURCE:			
U.S.G.S. 15' Quadrangle			
SCALE:			
1:62500			
DATE:			
1955			
4. REQUIREMENTS			
TO BE INCLUDED ON ALL MAPS			
1. Property boundaries where required.			
2. North arrow.			
3. Latitude and longitude reference.			

