

PH0001147

**NATIONAL REGISTER OF HISTORIC PLACES
INVENTORY - NOMINATION FORM**

(Type all entries - complete applicable sections)

STATE: Delaware	
COUNTY: Kent	
FOR NPS USE ONLY	
ENTRY NUMBER	DATE
	APR 1 1973

1. NAME

COMMON:
Wheel of Fortune

AND/OR HISTORIC:

2. LOCATION

STREET AND NUMBER:
Delaware Route 9

CITY OR TOWN:
Leipsic

STATE: Delaware CODE: 10 COUNTY: Kent CODE: 001

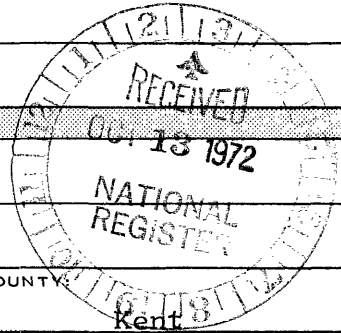

3. CLASSIFICATION

CATEGORY (Check One)	OWNERSHIP	STATUS	ACCESSIBLE TO THE PUBLIC
<input type="checkbox"/> District <input checked="" type="checkbox"/> Site <input type="checkbox"/> Building <input type="checkbox"/> Structure <input type="checkbox"/> Object	<input type="checkbox"/> Public <input checked="" type="checkbox"/> Private <input type="checkbox"/> Both	<input checked="" type="checkbox"/> Occupied <input type="checkbox"/> Unoccupied <input type="checkbox"/> Preservation work in progress	Yes: <input checked="" type="checkbox"/> Restricted <input type="checkbox"/> Unrestricted <input type="checkbox"/> No
PRESENT USE (Check One or More as Appropriate)			
<input type="checkbox"/> Agricultural <input type="checkbox"/> Commercial <input type="checkbox"/> Educational <input type="checkbox"/> Entertainment	<input type="checkbox"/> Government <input type="checkbox"/> Industrial <input type="checkbox"/> Military <input type="checkbox"/> Museum	<input type="checkbox"/> Park <input checked="" type="checkbox"/> Private Residence <input type="checkbox"/> Religious <input type="checkbox"/> Scientific	<input type="checkbox"/> Transportation <input type="checkbox"/> Other (Specify)

4. OWNER OF PROPERTY

OWNER'S NAME:
Hudson E. Gruwell

STREET AND NUMBER:
Wheel of Fortune, Delaware Route 9

CITY OR TOWN: Leipsic STATE: Delaware CODE: 10

5. LOCATION OF LEGAL DESCRIPTION

COURTHOUSE, REGISTRY OF DEEDS, ETC.:
Kent County Court House

STREET AND NUMBER:
The Green

CITY OR TOWN: Dover STATE: Delaware CODE: 10

6. REPRESENTATION IN EXISTING SURVEYS

TITLE OF SURVEY:
Historic American Buildings Survey, Del-76

DATE OF SURVEY: 1936 Federal State County Local

DEPOSITORY FOR SURVEY RECORDS:
Library of Congress

STREET AND NUMBER:
Washington

CITY OR TOWN: Washington STATE: D.C. CODE:

SEE INSTRUCTIONS

STATE:

COUNTY:

ENTRY NUMBER

DATE

FOR NPS USE ONLY

APR 1 1973

7. DESCRIPTION

CONDITION	(Check One)					
	<input type="checkbox"/> Excellent	<input checked="" type="checkbox"/> Good	<input type="checkbox"/> Fair	<input type="checkbox"/> Deteriorated	<input type="checkbox"/> Ruins	<input type="checkbox"/> Unexposed
	(Check One)			(Check One)		
	<input checked="" type="checkbox"/> Altered	<input type="checkbox"/> Unaltered	<input type="checkbox"/> Moved	<input checked="" type="checkbox"/> Original Site		

DESCRIBE THE PRESENT AND ORIGINAL (if known) PHYSICAL APPEARANCE

The Wheel of Fortune is a five-bay, one-room-deep Georgian brick house with an east frontage. Laid in Flemish bond, the east facade is spanned by a box cornice with simple moulding, a four-brick-wide belt course, and a water table. The basement windows are capped by wooden inset lintels, and the remaining fenestration features moulded window sills. Protected by an extended portico, the center portal is surmounted by a transom, and is marked by dog-eared trim detailing. The remaining facades lack even this simple detail, and are laid in five-course common bond.

The center hall connects to two main rooms on the first floor, and is backed by an open stairway to the west. Detailing includes punch-and-gouge chair railing and newel posts, and dog-eared floor trim.

Of the two major rooms, the north receives the finer detailing. The room is edged by punch-and-gouge chair railing and crown moulding. The fireplace, similarly detailed, features two pineapple-motif carvings. The splayed cased windows are trimmed, as is the doorway, by dog-eared moulding details.

The south room, or dining room, contains detailing of a much simpler genre. The fireplace mantel is a simple frame design, no crown moulding exists, nor are the windows splayed. A door in the west wall allows access to a two-story rear wing, originally containing a kitchen and servants' quarters. To compensate for the absence of fenestration on the west wall, a window is located on the south wall, west of the fireplace breast.

Though generally more conservative in detail, the second floor is

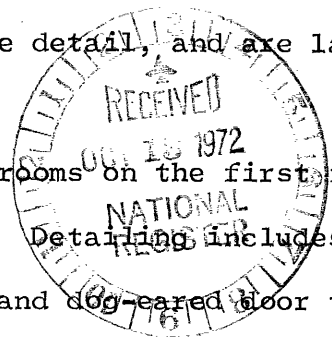

SEE INSTRUCTIONS

SIGNIFICANCE

PERIOD (Check One or More as Appropriate)

- | | | | |
|--|---------------------------------------|--|---------------------------------------|
| <input type="checkbox"/> Pre-Columbian | <input type="checkbox"/> 16th Century | <input checked="" type="checkbox"/> 18th Century | <input type="checkbox"/> 20th Century |
| <input type="checkbox"/> 15th Century | <input type="checkbox"/> 17th Century | <input checked="" type="checkbox"/> 19th Century | |

SPECIFIC DATE(S) (If Applicable and Known)

AREAS OF SIGNIFICANCE (Check One or More as Appropriate)

- | | | | |
|--|---|---|--|
| <input type="checkbox"/> Aboriginal | <input type="checkbox"/> Education | <input checked="" type="checkbox"/> Political | <input type="checkbox"/> Urban Planning |
| <input type="checkbox"/> Prehistoric | <input type="checkbox"/> Engineering | <input type="checkbox"/> Religion/Philosophy | <input type="checkbox"/> Other (Specify) |
| <input type="checkbox"/> Historic | <input type="checkbox"/> Industry | <input type="checkbox"/> Science | |
| <input type="checkbox"/> Agriculture | <input type="checkbox"/> Invention | <input type="checkbox"/> Sculpture | |
| <input checked="" type="checkbox"/> Architecture | <input type="checkbox"/> Landscape Architecture | <input type="checkbox"/> Social/Humanitarian | |
| <input type="checkbox"/> Art | <input type="checkbox"/> Literature | <input type="checkbox"/> Theater | |
| <input type="checkbox"/> Commerce | <input type="checkbox"/> Military | <input type="checkbox"/> Transportation | |
| <input type="checkbox"/> Communications | <input type="checkbox"/> Music | | |
| <input type="checkbox"/> Conservation | | | |

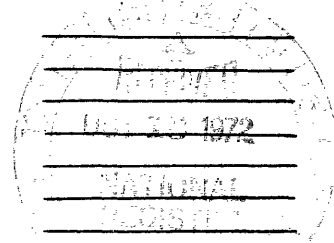

STATEMENT OF SIGNIFICANCE

The intriguing name of "Wheel of Fortune" is taken from a tract known by the same name on Muddy Branch below Leipsic. The name's origin is said to be a pun on the name of John Chance, the owner of the tract in 1738. Three years earlier, however, a John Houseman requested a survey of the tract, which was already known as Wheel of Fortune.

The house itself is based on eighteenth-century Georgian structural plans, although Middle Georgian exterior detailing is not carried through consistently. The porches at front and side are later additions to the house.

The tract passed through several hands during the eighteenth and nineteenth centuries, and at least twice was associated with political figures. John A. Nicholson, the tract's owner before 1888, was graduated from Dickinson College and studied law in Dover. He was elected as a Democrat to the thirty-ninth Congress in 1864, and again to the fortieth Congress. After his second term, he returned to Dover to practice law.

James Hurd Hughes, who bought Wheel of Fortune in 1910, was admitted to the bar in 1890. Although unsuccessful as a candidate for governor in 1916, he became a Democratic Senator in January of

SEE INSTRUCTIONS

9. MAJOR BIBLIOGRAPHICAL REFERENCES

Eberlein, Harold Donaldson and Hubbard, Cortlandt V.D. Historic Houses and Buildings of Delaware. Dover: Public Archives Commission, 1962.
 Federal Writers Project. Delaware: A Guide to the First State. Edited by Jeannette Eckman. New York: The Viking Press, 1938.
 Scharf, J. Thomas. A History of the State of Delaware: 1609-1888. Philadelphia. L.J. Richards & Company, 1888.
 Kent County Deed Book W. Vol. 9, p. 273.
 Kent County Survey Book A, p. 154.

10. GEOGRAPHICAL DATA

LATITUDE AND LONGITUDE COORDINATES DEFINING A RECTANGLE LOCATING THE PROPERTY			O R	LATITUDE AND LONGITUDE COORDINATES DEFINING THE CENTER POINT OF A PROPERTY OF LESS THAN TEN ACRES		
CORNER	LATITUDE	LONGITUDE		LATITUDE	LONGITUDE	
	Degrees Minutes Seconds	Degrees Minutes Seconds		Degrees	Minutes	Seconds
NW	0 ' "	0 ' "		39	12	54
NE	0 ' "	0 ' "		75	30	48
SE	0 ' "	0 ' "				
SW	0 ' "	0 ' "				

APPROXIMATE ACREAGE OF NOMINATED PROPERTY: One

LIST ALL STATES AND COUNTIES FOR PROPERTIES OVERLAPPING STATE OR COUNTY BOUNDARIES

STATE:	CODE	COUNTY	CODE

11. FORM PREPARED BY

NAME AND TITLE:
Mr. Vincent Rogers and Miss Rosemary Troy

ORGANIZATION: Division of Historical and Cultural Affairs DATE: 8/2/72

STREET AND NUMBER:
Hall of Records

CITY OR TOWN: Dover STATE: Delaware CODE: 10

12. STATE LIAISON OFFICER CERTIFICATION

NATIONAL REGISTER VERIFICATION

As the designated State Liaison Officer for the National Historic Preservation Act of 1966 (Public Law 89-665), I hereby nominate this property for inclusion in the National Register and certify that it has been evaluated according to the criteria and procedures set forth by the National Park Service. The recommended level of significance of this nomination is:

National State Local

Name E. Berkeley Tompkins
Dr. E. Berkeley Tompkins

Title Director, Div. of Historical and Cultural Affairs

Date 10-6-72

I hereby certify that this property is included in the National Register.

Robert M. Utley
 Chief, Office of Archeology and Historic Preservation

Date 4/11/73

ATTEST:

W. M. ...
 Keeper of The National Register

Date 4-3-73

SEE INSTRUCTIONS

**NATIONAL REGISTER OF HISTORIC PLACES
INVENTORY - NOMINATION FORM**

(Continuation Sheet)

STATE Delaware	
COUNTY Kent	
FOR NPS USE ONLY	
ENTRY NUMBER	DATE
	APR 11 1972

(Number all entries)

7. DESCRIPTION (continued)---

patterned, both in disposal and in detail, on the first floor. The north room is again graced by splayed window casings and pineapple mantel details, but lacks dog-eared trim. A recently-installed bath now occupies the east, or front, end of the second-story hall.

In addition to the main house, two brick dependencies remain intact. Laid in common bond, the meat house and milk house are located to the south of the house. Like the house itself, the dependencies are whitewashed.



NATIONAL REGISTER OF HISTORIC PLACES
INVENTORY - NOMINATION FORM

(Continuation Sheet)

STATE	
Delaware	
COUNTY	
Kent	
FOR NPS USE ONLY	
ENTRY NUMBER	DATE
	APR 11 1973

(Number all entries)

8. STATE OF SIGNIFICANCE (continued)---

1937. After the expiration of his term in 1943, he returned to the practice of law in Dover.

