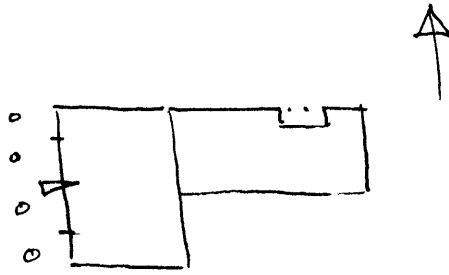

KENTUCKY HISTORIC RESOURCES INVENTORY

JS-3

1. Historic Name (s) <u>Marshall - Bryan House</u>		22. ADD/County <u>Bluegrass/Jessamine</u>							
Original Owner <u>Dr. Lewis Marshall</u>		23. Zoning Classification Magisterial District							
Present Name <u>Fairview</u>		24. U.S.G. S. Quadrant (15'/75') <u>Nicholasville</u>							
3. Owner's Name <u>L. C. Bryan, Jr.</u>		25. UTM Reference <table style="width:100%; border-collapse: collapse;"> <tr> <td style="border: 1px solid black; padding: 2px;"><u>16</u></td> <td style="border: 1px solid black; padding: 2px;"><u>716100</u></td> <td style="border: 1px solid black; padding: 2px;"><u>4202890</u></td> </tr> <tr> <td style="font-size: 8px; text-align: center;">Zone</td> <td style="font-size: 8px; text-align: center;">Easting</td> <td style="font-size: 8px; text-align: center;">Northing</td> </tr> </table>		<u>16</u>	<u>716100</u>	<u>4202890</u>	Zone	Easting	Northing
<u>16</u>	<u>716100</u>	<u>4202890</u>							
Zone	Easting	Northing							
4. Owner's Address <u>813 Willard St., Covington, KY 41011</u>		26. Prehistoric Site Historic Site <input checked="" type="checkbox"/> Building							
5. Location <u>E. side of US 27; 1 mile S. of Fayette County line</u>		Object Structure							
6. Open to Public Yes <input type="checkbox"/> No <input checked="" type="checkbox"/>		27. District Name:							
7. Visible from road Yes <input checked="" type="checkbox"/> No <input type="checkbox"/>		Yes <input type="checkbox"/> No <input checked="" type="checkbox"/>							
8. Ownership Private <input checked="" type="checkbox"/> Local <input type="checkbox"/> State <input type="checkbox"/> Federal <input type="checkbox"/>		28. Significance Evaluation <u>National Register</u>							
9. Local Contact/Organization		29. Status National Landmark <input type="checkbox"/> National Register <input type="checkbox"/> Landmark Certificate <input type="checkbox"/> Kentucky Survey <input checked="" type="checkbox"/> <u>11-18-71</u> Local Landmark <input type="checkbox"/> HABS/HAER <input type="checkbox"/>							
10. Site Plan with North Arrow <div style="text-align: center;">  </div>		11. Architect							
See Attached Sheet		12. Builder							
		13. Date <u>1853*</u>							
		14. Style <u>Greek Revival</u>							
		15. Original Use <u>House</u>							
16. Present Use <u>House</u>		30. Theme Primary <u>architecture</u>							
17. Condition Interior <input type="checkbox"/> Exterior <u>good</u>		Secondary _____ Other _____							
18. Description <u>2-story, 3-bay brick; stuccoed brick columns on west (main) face; Flemish bond; jack arches; 6/6 windows; recessed porch of 2 stories on N face of ell; W portico is joined to main house by hipped roof; main door surround has drip molding cutablature, outer pilasters and inner octagonal columns - all wood.</u>		31. Endangered Yes <input checked="" type="checkbox"/> No <input type="checkbox"/>							
19. History <u>Built for Dr. Lewis Marshall (youngest brother of Chief Justice John Marshall) in 1853. Sold to Daniel Boone Bryan II, Son of William Turner Bryan</u>		32. ATTACH PHOTO							
atlas 1877 - D. B. Bryan		Roll No. <u>46 and 3</u> Picture No. _____ Direction _____							
20. Significance <u>Architecture: one of the most expressive of the county's Greek Revival houses, the Marshall-Bryan house has design features unusual in the county (full front portico, octagonal entry columns, hipped roof, vertical stacking of features).</u>		33. Tape No. _____ Negative No. _____							
21. Source of Information <u>*1971 survey form; Clay Lancaster, Anté Bellum Houses, p. 103.</u>		34. Prepared by: <u>NCP - KTG</u>							
35. Organization <u>KHC</u>		36. Date <u>Summer 1977</u>							
37. Revision Dates		38. Staff Review							

KENTUCKY HISTORIC RESOURCE INVENTORY SUPPLEMENT
BOUNDARY AND LOCATION INFORMATION

Historic Property Name Marshall - Bryan house Site # JS 3
Multiple Resource/Thematic Nomination Title Jessamine Co.

U.T.M. Coordinates - List multiple UTMs if property is ten or more acres.

A. 16 716530 4202900 D. 16 716040 4203120
B. 16 716330 4202390 E. _____
C. 16 715870 4202610 F. _____

Verbal Boundary Description _____ Acreage 64 acres

Site enclosed by A-B-C-D; bounded on W by US27, on N by Ky 1980, and on E by old tree and fence row.

Sketch of Site Plan (Showing outbuildings, structures, landscape features and the site boundary as described above.)

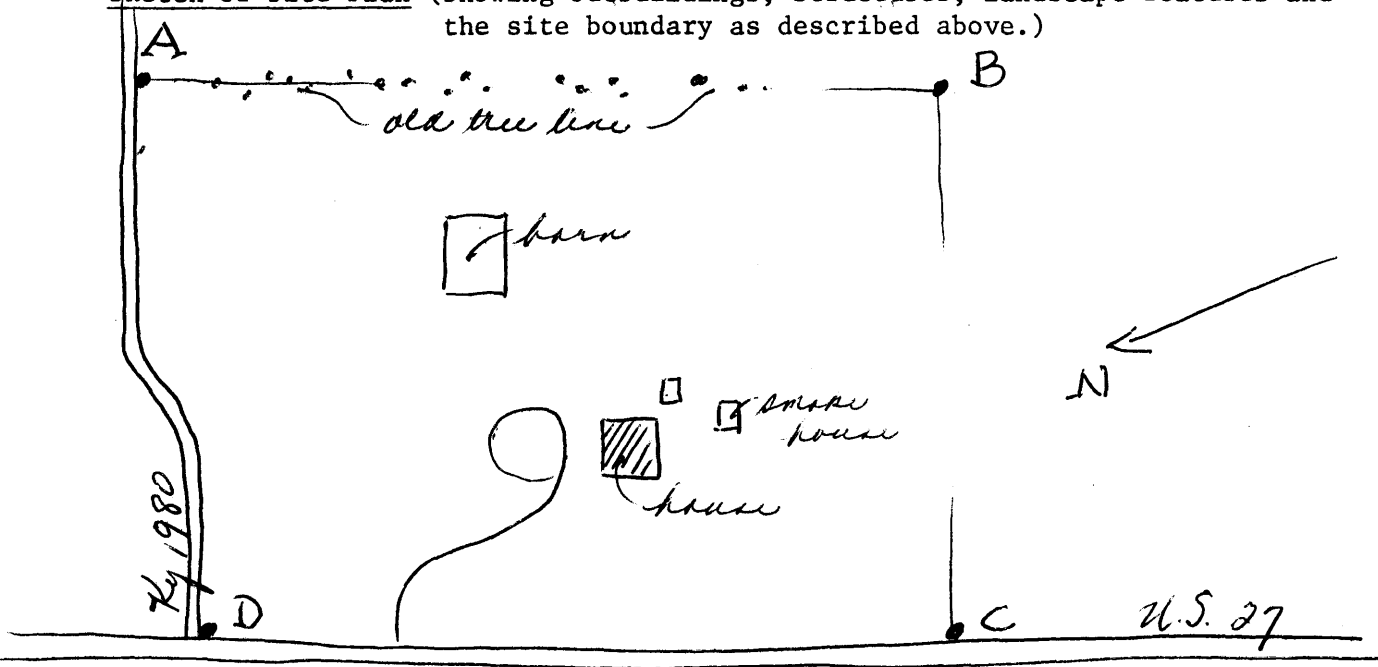

Official Courthouse Property Reference: