

**United States Department of the Interior
National Park Service**

**National Register of Historic Places
Continuation Sheet**

Section number _____ Page _____

SUPPLEMENTARY LISTING RECORD

NRIS Reference Number: 93000957

Date Listed: 10/1/93

Princess-Sweet Shop
Property Name

Hardin
County

IA
State

Architectural & Historical Resources of Iowa Falls, Iowa MPS
Multiple Name

This property is listed in the National Register of Historic Places in accordance with the attached nomination documentation subject to the following exceptions, exclusions, or amendments, notwithstanding the National Park Service certification included in the nomination documentation.

for Patrick W. Andrews

Signature of the Keeper

10/1/93

Date of Action

=====
Amended Items in Nomination:

Level of Significance:
The level of significance for this resource is local.

UTM:
The UTM coordinates were omitted from the nomination form. The correct coordinates were obtained from the attached USGS map.

This information was confirmed with Beth Foster of the Iowa SHPO.

DISTRIBUTION:
National Register property file
Nominating Authority (without nomination attachment)

957

United States Department of the Interior
National Park Service

RECEIVED

AUG 20 1993

National Register of Historic Places
Registration Form

NATIONAL
REGISTER

This form is for use in nominating or requesting determinations for individual properties and districts. See instructions in *How to Complete the National Register of Historic Places Registration Form* (National Register Bulletin 16A). Complete each item by marking "x" in the appropriate box or by entering the information requested. If an item does not apply to the property being documented, enter "N/A" for "not applicable." For functions, architectural classification, materials, and areas of significance, enter only categories and subcategories from the instructions. Place additional entries and narrative items on continuation sheets (NPS Form 10-900a). Use a typewriter, word processor, or computer, to complete all items.

1. Name of Property

historic name Princess - Sweet Shop
other names/site number N.A.

2. Location

street & number 607 Washington Avenue not for publication
city or town Iowa Falls vicinity
state Iowa code IA county Hardin code 083 zip code 50126

3. State/Federal Agency Certification

As the designated authority under the National Historic Preservation Act, as amended, I hereby certify that this nomination request for determination of eligibility meets the documentation standards for registering properties in the National Register of Historic Places and meets the procedural and professional requirements set forth in 36 CFR Part 60. In my opinion, the property meets does not meet the National Register criteria. I recommend that this property be considered significant nationally statewide locally. (See continuation sheet for additional comments.)

8/13/93
Signature of certifying official/Title Date
State Historical Society of Iowa
State of Federal agency and bureau

In my opinion, the property meets does not meet the National Register criteria. (See continuation sheet for additional comments.)

Signature of certifying official/Title Date

State or Federal agency and bureau

4. National Park Service Certification

I hereby certify that the property is:

- entered in the National Register. See continuation sheet.
- determined eligible for the National Register See continuation sheet.
- determined not eligible for the National Register.
- removed from the National Register.
- other. (explain:)

Signature of the Keeper Patrick Andrews Date of Action 10/1/93

Name of Property

County and State

5. Classification

Ownership of Property
(Check as many boxes as apply)

Category of Property
(Check only one box)

Number of Resources within Property
(Do not include previously listed resources in the count.)

- private
- public-local
- public-State
- public-Federal

- building(s)
- district
- site
- structure
- object

Contributing	Noncontributing	
1		buildings
		sites
		structures
		objects
1		Total

Name of related multiple property listing
(Enter "N/A" if property is not part of a multiple property listing.)

Number of contributing resources previously listed
in the National Register

Architectural & Historical Resources of Iowa Falls, IA 0

6. Function or Use

Historic Functions
(Enter categories from instructions)

COMMERCE/Restaurant

Current Functions
(Enter categories from instructions)

COMMERCE/Restaurant

7. Description

Architectural Classification
(Enter categories from instructions)

Modern Movement:

Art Deco

Materials
(Enter categories from instructions)

foundation Limestone

walls Brick

roof Asphalt

other Carrara Glass

Stucco on side elevation

Narrative Description

(Describe the historic and current condition of the property on one or more continuation sheets.)

Name of Property

County and State

8. Statement of Significance

Applicable National Register Criteria

(Mark "x" in one or more boxes for the criteria qualifying the property for National Register listing.)

- A Property is associated with events that have made a significant contribution to the broad patterns of our history.
B Property is associated with the lives of persons significant in our past.
C Property embodies the distinctive characteristics of a type, period, or method of construction or represents the work of a master, or possesses high artistic values, or represents a significant and distinguishable entity whose components lack individual distinction.
D Property has yielded, or is likely to yield, information important in prehistory or history.

Areas of Significance

(Enter categories from instructions)

Architecture

Period of Significance

1935

Significant Dates

1935

Significant Person

(Complete if Criterion B is marked above)

N.A.

Cultural Affiliation

N.A.

Architect/Builder

Designed by L.L.Klippel

Bldr: J.J. Sprague

Criteria Considerations

(Mark "x" in all the boxes that apply.)

Property is:

- A owned by a religious institution or used for religious purposes.
B removed from its original location.
C a birthplace or grave.
D a cemetery.
E a reconstructed building, object, or structure.
F a commemorative property.
G less than 50 years of age or achieved significance within the past 50 years.

Narrative Statement of Significance

(Explain the significance of the property on one or more continuation sheets.)

9. Major Bibliographical References

Bibliography

(Cite the books, articles, and other sources used in preparing this form on one or more continuation sheets.)

Previous documentation on file (NPS):

- preliminary determination of individual listing (36 CFR 67) has been requested
previously listed in the National Register
previously determined eligible by the National Register
designated a National Historic Landmark
recorded by Historic American Buildings Survey
recorded by Historic American Engineering Record

Primary location of additional data:

- State Historic Preservation Office
Other State agency
Federal agency
Local government
University
Other

Name of repository:

Name of Property

County and State

10. Geographical Data

Acreage of Property Less than one acre.

UTM References

(Place additional UTM references on a continuation sheet.)

UTM grid 1: Zone 15, Easting 478280, Northing 4707260

UTM grid 3 and 4: Empty grid boxes

See continuation sheet

Verbal Boundary Description

(Describe the boundaries of the property on a continuation sheet.)

Boundary Justification

(Explain why the boundaries were selected on a continuation sheet.)

11. Form Prepared By

Form prepared by Molly Myers Naumann, Consultant, Iowa Falls Historic Preservation Commission, dated May 1993, address City Hall, 321 Stevens, Iowa Falls, IA 50126.

Additional Documentation

Submit the following items with the completed form:

Continuation Sheets

Maps

- A USGS map (7.5 or 15 minute series) indicating the property's location.
A Sketch map for historic districts and properties having large acreage or numerous resources.

Photographs

Representative black and white photographs of the property.

Additional Items

(Check with the SHPO or FPO for any additional items)

Property Owner

(Complete this item at the request of SHPO or FPO.)

Property owner: Bennie U. and Kay Lynn Engelby, 824 Stevens Street, Iowa Falls, IA 50126, telephone (515) 648-3364.

Paperwork Reduction Act Statement: This information is being collected for applications to the National Register of Historic Places to nominate properties for listing or determine eligibility for listing, to list properties, and to amend existing listings.

Estimated Burden Statement: Public reporting burden for this form is estimated to average 18.1 hours per response including time for reviewing instructions, gathering and maintaining data, and completing and reviewing the form.

United States Department of the Interior
National Park ServiceNational Register of Historic Places
Continuation SheetSection number 7 Page 1

CFN-259-1116

Princess-Sweet Shop
Hardin County, Iowa

Description:

The two story rectangular building that houses the Princess-Sweet Shop is a noteworthy example of Art Deco design from 1935. Located in the middle of the 600 block of Washington, on the south side of the street, the brick structure measures 21'x120', with the narrow end facing the street. The flat roof slopes gently to the rear. The west elevation of the building is now exposed due to a fire which demolished the adjacent building. This brick wall has been covered with stucco for both aesthetic and practical reasons.

The facade of the Princess is outstanding. The street level is of black Carrara glass with a pale green linear design at the corners and sides. The second floor is now of pink stucco, but originally it was painted green to match the lower level. Note the dark zig-zag treatment at the sides of the building, enframing the second floor windows. These two windows are high-lighted by the use of a slightly darker tone around them, expanding in a zig-zag effect near the sill. The street level is asymmetrical due to a stairway entrance located on the right (west) side. The storefront itself is symmetrical, with a recessed entry and large plate glass display windows. The Carrara glass is located both above and below these windows. Trim on the building is of "pitco" metal. "Princess" is spelled out in elongated stylized letters above the door. A long narrow sign directly above the entrance announces "Air-Conditioned." The neon sign on which extends out from the facade was designed by the Pioneer Neon Sign Company of Minneapolis and was one of the largest in central Iowa in 1935. With the exception of the change in the color of the second floor stucco, the facade appears unaltered.

The interior also retains a very high level of integrity. It can best be described in the words written for the Iowa Falls Citizen at the time of the formal opening in July 1935.

The first floor will be given over to the retail candy, ice cream and cafe business... Interior fixtures will include a candy case at the north end of the west wall, three large candy cases and display shelves on the east wall and 24 large, comfortable dining booths.

All the fixtures were custom-built for the Princess by Robert Brand & Sons Company of Osh Kosh, Wisconsin. They are of two-tone walnut. Panels of figured oriental walnut of light shades, imported from Africa, will be placed at the ends of the tables in the booths. Attached to each panel will be a mirror 20x24 inches and a modernistic indirect lighting fixture. Avodire veneer and American black walnut will be used in the booth suits, which will have carved rosettes inlaid at the ends. The same materials will be used in the candy cases, display cases, for wall paneling and for panels inside the front display windows. The tables will have black formic(a) tops with white metal edges. The new fountain is 25 feet long and of the most modern design, electrically refrigerated throughout.

The only apparent change from the above description is that one of the candy cases is missing. Otherwise, the article is as accurate today as it was in 1935.

United States Department of the Interior
National Park Service

National Register of Historic Places Continuation Sheet

Section number 7 Page 2

CFN-259-1116

Princess-Sweet Shop
Hardin County, Iowa

Description (continued):

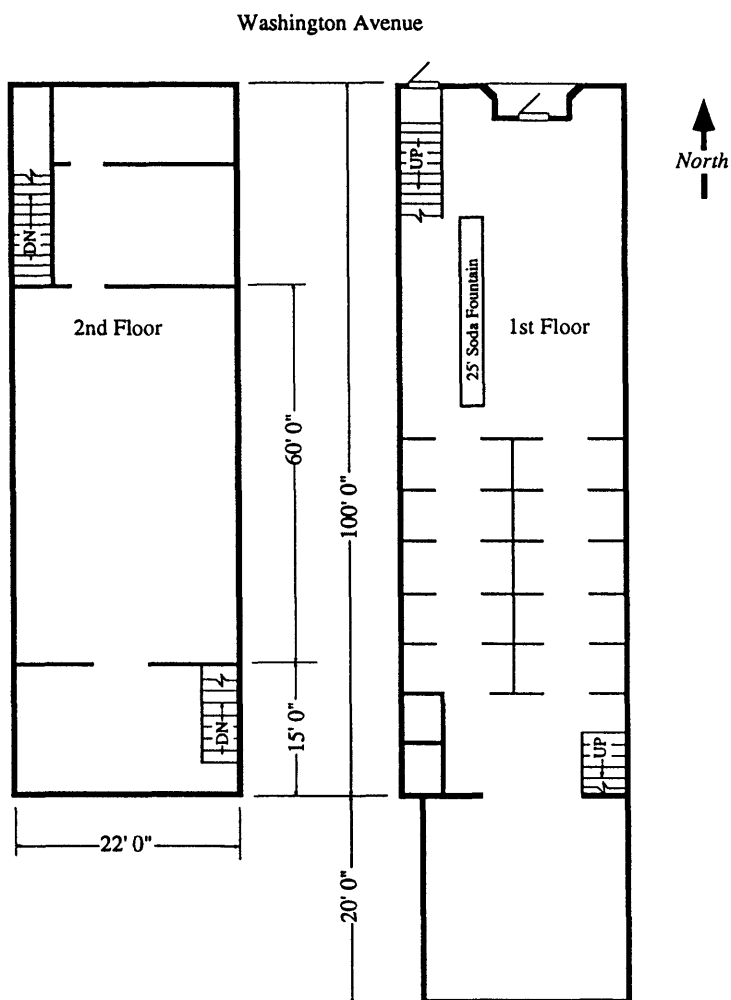

United States Department of the Interior
National Park Service

National Register of Historic Places Continuation Sheet

Section number 7 Page 3

CFN-259-1116

Princess-Sweet Shop
Hardin County, Iowa

Description (continued):

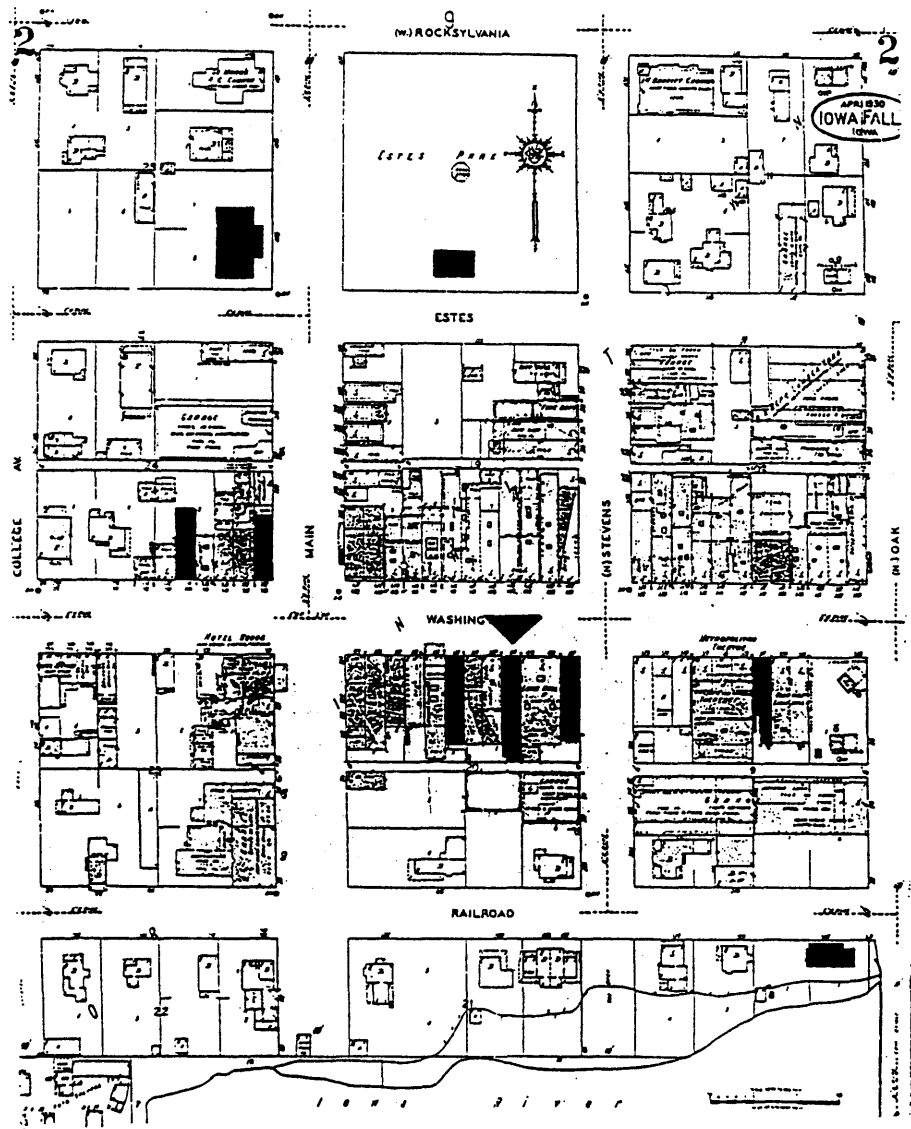

IOWA FALLS BUSINESS DISTRICT

Shaded buildings are those being nominated.



indicates specific building being nominated.

United States Department of the Interior
National Park Service

National Register of Historic Places Continuation Sheet

Section number 7 Page 4

CFN-259-1116

Princess-Sweet Shop
Hardin County, Iowa

Description (continued):

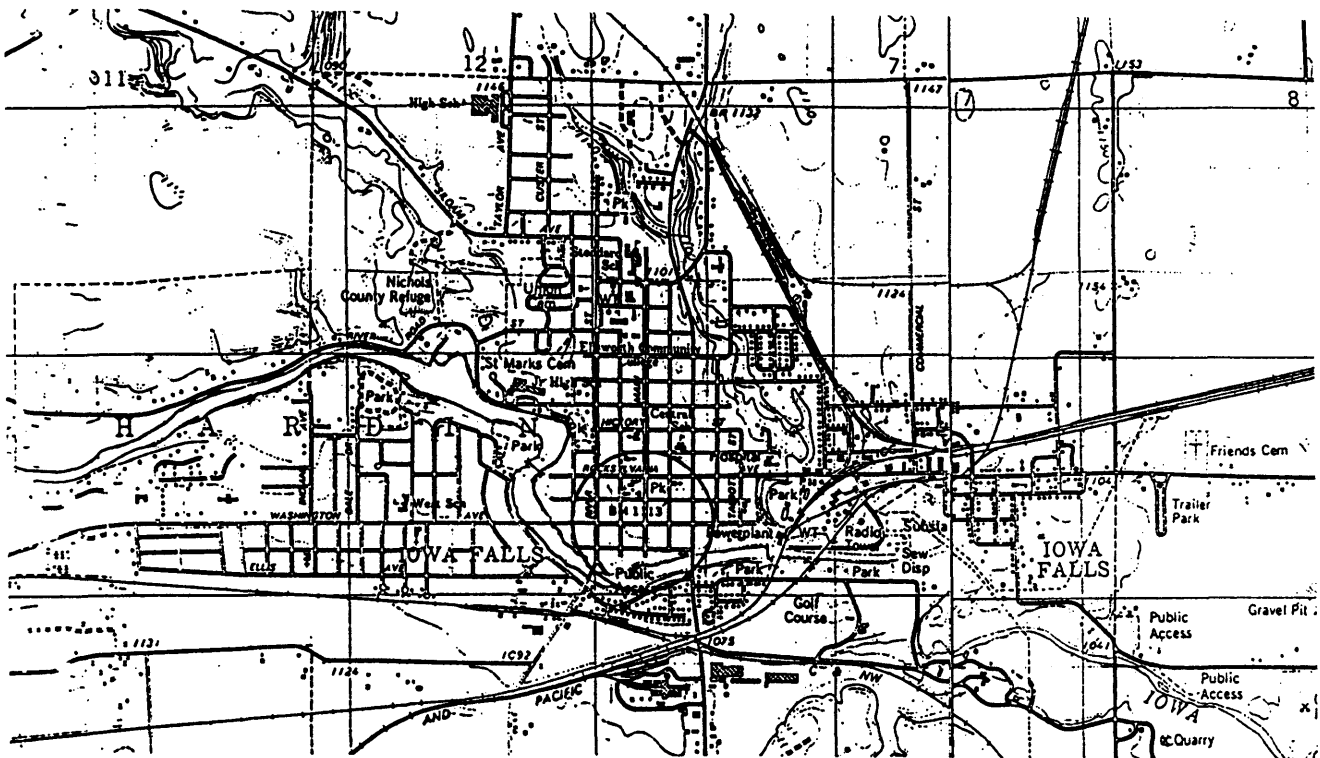
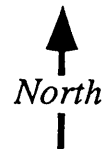

Central Business District is circled.
U.S.G.S. Map

United States Department of the Interior
National Park Service

National Register of Historic Places Continuation Sheet

Section number 8 Page 5

CFN-259-1116

Princess-Sweet Shop
Hardin County, Iowa

Significance:

The Princess-Sweet Shop is locally significant under Criterion C as an outstanding example of Art Deco design from 1935. Although it is not being nominated under Criterion A, it is of local interest due to its origins by Greek emigrants who commonly established candy shops around the country. The period of significance is based on the year of construction.

The Carrara glass facade, and streamlined woodwork of the interior are typical of Art Deco design of the 1920s and '30s, but a rarity in a small town in Iowa. The owners displayed a great deal of faith in the architect, and in the people of Iowa Falls too. The design for the Princess was as unusual as the Spanish Colonial Revival style band shell design had been several years earlier.

The first Princess opened in Iowa Falls on November 20, 1915 and two years later the Sweet Shop opened a half block west of the Princess, with H.K. Pergakis in charge. In 1928 Pergakis and E.J. Karrys (both immigrants from a small Greek town) consolidated and the business was operated from the Princess site (607 Washington) under the name Princess-Sweet Shop. On Christmas Day 1934 a fire left only a brick shell. The decision was made to rebuild on the same site, and architect L.L. Klippel was selected to draw the plans. Klippel had been in Iowa Falls for only a short while, but had already achieved a local reputation. (He was responsible for the 1931 Spanish Colonial Revival style band shell in Estes Park.) The community was somewhat surprised when a drawing of the new facade was released to the newspaper. The old red brick front was to be totally remodeled into an "ultra-modern design."

"Harry and Ernie told me to build the outstanding cafe in the middle west" stated Mr. Klippel, "to accomplish this feat, we inspected outstanding cafes in cities throughout the middle west, studied plans of famous places throughout the United States, and finally took the best points of a number of them and incorporated them into the 'new' Princess. The facade, with its Carrara black glass and pitco metal, is patterned after the famous Commodore of Watertown, New York."

Not only was the design modern, both inside and out, but the equipment was the last word in efficiency and convenience. It was the first building in town to be air conditioned. Gas ranges replaced the old wood and coal stoves that had been used before the fire, and gas water heaters provided sufficient water for the washing and sterilizing of the dishes. The total cost for the building and equipping of the Princess was approximately \$30,000. This, in the middle of the Depression. It was explained by one of the owners,

We realize that we are investing an unusually large sum for such a business in a city the size of this, but Iowa Falls is our home. We expect to remain here.We have all the faith in the world in this community and we believe that the people will appreciate the fact that we are giving them the best to be had.

United States Department of the Interior
National Park Service

National Register of Historic Places Continuation Sheet

Section number 8 Page 6

CFN-259-1116

Princess-Sweet Shop
Hardin County, Iowa

Significance (continued):

When the Princess-Sweet Shop reopened the citizens of Iowa Falls could once more treat themselves to Princess "Velvet" ice cream, Princess Home Made Candies, and Chinese food. The week of the opening Mr. Perkagis "announced the return to the Princess-Sweet Shop of Yee Foong Young, the Chinese chef who was connected with the Princess before the fire. Mr. Young will again specialize in the preparation of Chinese dishes for patrons of the cafe."

The Princess remained in business until 1987. In 1960 Harry Pergakis died and Karrys ran the business for a short time and then sold it. In 1970 Margaret Perkagis Barberra's husband bought the Princess for her as a birthday gift. She, and later her son, ran the business until 1987 when it closed. It was purchased by the present owners in 1992. While most of the original fixtures remain, not enough of the candy making equipment could be located, so handmade candy from Des Moines is sold instead.

The Princess-Sweet Shop retains such a high level of integrity that Pergakis and Karrys would feel right at home. It speaks of the elegance of design that was favored during the dark days of the Great Depression.

United States Department of the Interior
National Park Service

National Register of Historic Places Continuation Sheet

Section number 9 & 10 Page 7

CFN-259-1116

Princess-Sweet Shop
Hardin County, Iowa

Bibliography:

Abstract of Title, City of Iowa Falls, Original Plat, Block 20, N122' of the E 22' Lot 2.

Hardin County Citizen, December 27, 1934, front page
February 21, 1935, P 13
April 11, 1935, p 4, p 14
May 30, 1935, front page
June 27, 1935, p 10
July 4, 1935, front page
July 11, 1935, advertising

Nash, Jan. Wilton Candy Kitchen (Muscatine County), Iowa. Listed on the National Register of Historic Places in 1993.

Nichols, Ira A. History of Iowa Falls, 1900-1950. Iowa Falls: Hecht Printing Co., 1956, p 327.

Sanborn Fire Insurance Maps

Waterloo Courier, June 14, 1992, pp C1 and C3

Verbal Boundary Description:

City of Iowa Falls, Original Plat, Block 20, E 22' of the N 122' Lot 2.

Boundary Justification:

This is the area historically associated with this resource.