

United States Department of the Interior
National Park Service

National Register of Historic Places
Registration Form

NATIONAL
REGISTER

This form is for use in nominating or requesting determinations of eligibility for individual properties or districts. See instructions in *Guidelines for Completing National Register Forms* (National Register Bulletin 16). Complete each item by marking "x" in the appropriate box or by entering the requested information. If an item does not apply to the property being documented, enter "N/A" for "not applicable." For functions, styles, materials, and areas of significance, enter only the categories and subcategories listed in the instructions. For additional space use continuation sheets (Form 10-900a). Type all entries.

1. Name of Property

historic name Rawls Cabin
other names/site number McKeel Cabin

2. Location

street & number 223 Charlie Rawls Road N/A not for publication
city, town West Monroe vicinity
state Louisiana code LA county Ouachita code 073 zip code 71292

3. Classification

Ownership of Property	Category of Property	Number of Resources within Property	
<input checked="" type="checkbox"/> private	<input checked="" type="checkbox"/> building(s)	Contributing	Noncontributing
<input type="checkbox"/> public-local	<input type="checkbox"/> district	<u>2</u>	<u>0</u> buildings
<input type="checkbox"/> public-State	<input type="checkbox"/> site		sites
<input type="checkbox"/> public-Federal	<input type="checkbox"/> structure		structures
	<input type="checkbox"/> object		objects
		<u>2</u>	<u>0</u> Total

Name of related multiple property listing: N/A
Number of contributing resources previously listed in the National Register 0

4. State/Federal Agency Certification

As the designated authority under the National Historic Preservation Act of 1966, as amended, I hereby certify that this nomination request for determination of eligibility meets the documentation standards for registering properties in the National Register of Historic Places and meets the procedural and professional requirements set forth in 36 CFR Part 60. In my opinion, the property meets does not meet the National Register criteria. See continuation sheet.
Jonathan Fricker July 9, 1991
Signature of certifying official Jonathan Fricker, Deputy SHPO, Department Date
of Culture, Recreation and Tourism
State or Federal agency and bureau

In my opinion, the property meets does not meet the National Register criteria. See continuation sheet.
Signature of commenting or other official _____ Date _____
State or Federal agency and bureau _____

5. National Park Service Certification

I, hereby, certify that this property is:
 entered in the National Register. Entered in the National Register
 See continuation sheet. 8/9/91
 determined eligible for the National Register. See continuation sheet.
 determined not eligible for the National Register.
 removed from the National Register.
 other, (explain:) _____
for Signature of the Keeper Date of Action

6. Function or Use

Historic Functions (enter categories from instructions)
DOMESTIC/Single dwelling

Current Functions (enter categories from instructions)
VACANT/Not in use

7. Description

Architectural Classification
(enter categories from instructions)

Other: Single Pen Log Cabin

Materials (enter categories from instructions)

foundation wood
walls logs
weatherboard
roof metal
other _____

Describe present and historic physical appearance.

The Rawls Cabin (c. 1886) is a one story log house which shares a small rural clearing in southern Ouachita Parish with two nearby twentieth century homes. Although the cabin has experienced some changes and losses over time, its rarity makes it a strong candidate for National Register listing.

The two room structure consists of a single log pen approximately 16 feet square and a smaller frame lean-to attached at the rear. A plank door connects the two spaces. A shed roof porch is attached to the facade. The sills forming the foundation are hewn in a rectangular shape and are resting on stone and wooden piers. The pen itself is constructed of round logs split down the center. These logs are peeled rather than hewn. The notching method is somewhat unusual for it appears to combine elements of the "V" and "saddle" notching techniques. The smaller shed room is sheathed on the exterior with sawn weatherboards. Architectural evidence suggests that the two rooms were built at the same time. The pen's low pitched roof has a deep overhang on the side clapboarded gables. An off-center plank door pierces the facade. Additional exterior doors are located on the pen's east side and the shed room's rear wall. The home retains its original wood plank flooring.

Changes to the structure since its construction include the following:

- 1) The original shingled roof has been replaced by corrugated sheet metal.
- 2) The front porch posts have been replaced.
- 3) The fireplace and chimney have been removed and a sheet metal tubular stove chimney has been added in their place.
- 4) The interior walls have been covered by various mid-twentieth century composition materials.

Despite these changes, the home retains the architectural features which make it important. Its rare single pen and shed room floorplan is intact, as are its log walls with unusual notches. Except for the loss of the chimney, the home's massing also remains unchanged. As a rare example of log construction and the single pen plan, the Rawls Cabin would make a significant addition to the National Register listings of Ouachita Parish.

United States Department of the Interior
National Park Service

National Register of Historic Places Continuation Sheet

Rawls Cabin, West Monroe vicinity, Ouachita Parish, LA

Section number 7 Page 1

Contributing Element

To the rear of the cabin is a small log structure which has the size and appearance of a root cellar. It is built of irregularly sized round poles or small logs with what appear to be round notches. It still retains its original wood shingle roof and dirt floor. Because it appears to be contemporaneous with the cabin and is rare in its own right, it is being listed as a contributing element for the purposes of this nomination.

8. Statement of Significance

Certifying official has considered the significance of this property in relation to other properties:

nationally statewide locally

Applicable National Register Criteria A B C D

Criteria Considerations (Exceptions) A B C D E F G N/A

Areas of Significance (enter categories from instructions)
architecture

Period of Significance
c.1886

Significant Dates
c.1886

Cultural Affiliation
N/A

Significant Person
N/A

Architect/Builder
Builder: Abner Rawls

State significance of property, and justify criteria, criteria considerations, and areas and periods of significance noted above.

The Rawls Cabin is locally significant in the area of architecture within Ouachita Parish because it is a rare surviving example of a single pen log house. It also represents the continuing prominence of the Upland South Culture in the area and may be one of the parish's oldest surviving log structures.

The Ouachita River divides the parish into two distinct regions. These two landscapes, in turn, influenced the parish's early settlement patterns. For example, the region east of the river consists of delta lands. In the late eighteenth century this area attracted large scale farmers who established a plantation economy. These planters usually built their permanent dwellings of sawn or milled lumber and raised the homes to protect them from potential flood waters. West of the river the land is hilly and less productive. This region was not settled until the nineteenth century, when Upland South pioneers arrived. These settlers preferred a different type of agriculture and a different settlement pattern. They established small farm holdings in scattered locations throughout the landscape and built log homes constructed around the concept of the "pen". These buildings usually stood very close to the ground on foundations consisting of wood or stone piers. Indeed, it is pens in general and log buildings in particular for which the Upland South settlers are primarily remembered. Whereas planters were quick to replace primitive log buildings as soon as their fortunes improved, Upland South farmers meant their log cabins and houses to serve as their permanent homes. In fact, log outbuildings continued to be built in Ouachita Parish until well after 1900.

Although log buildings once dominated the countryside of western Ouachita Parish, they are now relatively rare. Of the 142 rural buildings recorded in the parish's Historic Structures Survey as being at least fifty years of age, only approximately fourteen are constructed of logs. Of these, six are dwellings and the rest are single crib outbuildings (some with sheds attached at the side). The single pen house is equally rare in Ouachita Parish, for only seven are recorded in the survey. Only four of these single pens are constructed of logs, and one of these has been expanded to the extent that its status as a single pen

See continuation sheet

9. Major Bibliographical References

Historic Structures Survey for Ouachita Parish, LA.

The Architecture of the North Louisiana River Parishes, Vol. 1: Ouachita Parish,
Ruston, LA: Louisiana Tech University, 1988.

See continuation sheet

Previous documentation on file (NPS): N/A

preliminary determination of individual listing (36 CFR 67)
has been requested

previously listed in the National Register

previously determined eligible by the National Register

designated a National Historic Landmark

recorded by Historic American Buildings
Survey # _____

recorded by Historic American Engineering
Record # _____

Primary location of additional data:

State historic preservation office

Other State agency

Federal agency

Local government

University

Other

Specify repository: _____

10. Geographical Data

Acreage of property less than an acre

UTM References

A 15 578160 3579100
Zone Easting Northing

B _____
Zone Easting Northing

C _____

D _____

See continuation sheet

Verbal Boundary Description

Please refer to sketch map.

See continuation sheet

Boundary Justification

Boundary lines cut close to the cabin and its dependency because of the proximity of non-contributing buildings (two less than fifty old residences).

See continuation sheet

11. Form Prepared By

name/title National Register Staff
organization Division of Historic Preservation date May 1991
street & number P. O. Box 44247 telephone 504-342-8160
city or town Baton Rouge state Louisiana zip code 70804

Owner: Mrs. Elizabeth Bamburg
223 Charlie Rawls
West Monroe, LA 71291

**United States Department of the Interior
National Park Service**

**National Register of Historic Places
Continuation Sheet**

Rawls Cabin, West Monroe vicinity, Ouachita Parish, LA

Section number 8 Page 1

home is severely compromised. Thus, the Rawls Cabin is one of only three relatively intact single pen log homes in the parish. In addition, the Rawls Cabin appears to be among the area's oldest remaining log buildings. Although log structures would have been erected from the date of the first arrival of Upland South settlers, none appear to have survived from this early period. With its c. 1886 construction date, the Rawls cabin appears to pre-date all but one or two of the parish's other log buildings, most of which were built in the 1890s or after 1900.

Historical Note

The cabin was built c. 1886 by Abner Rawls. In 1911 it was purchased by the McKeel family, which still owns the building. According to the owner, it was lived in until 1976.

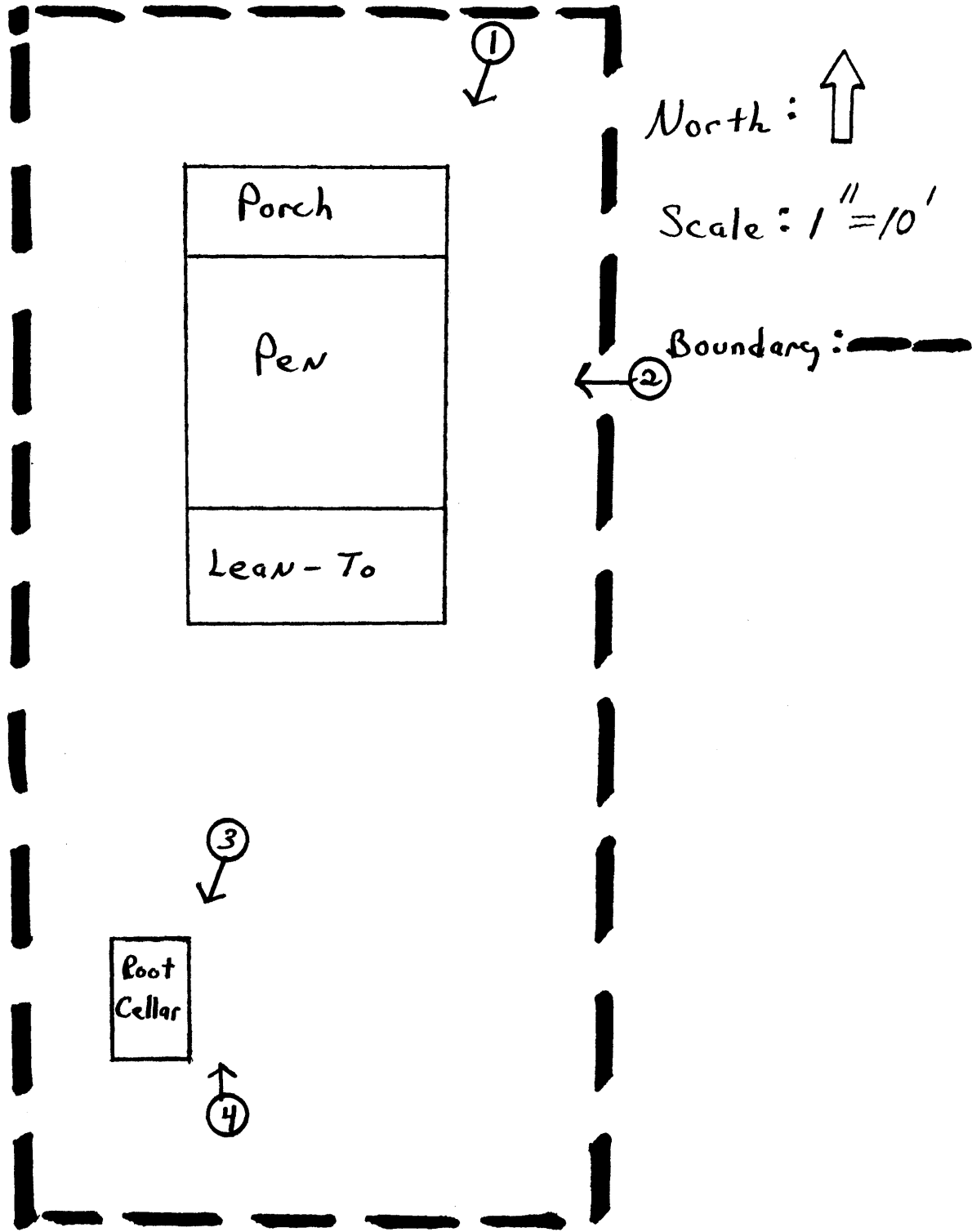

Rawls Cabin
West Monroe vicinity, Ouachita Parish
Louisiana