

DEC 1983 3172

KENTUCKY HISTORIC RESOURCES INVENTORY

Site No. Jo-43

1. Historic Name(s) Mine #5 Store		22. ADD/County BIG SANDY / JOHNSON	
Original Owner Consolidated Coal Company		23. U.S.G.S. Quadrant (15/75) Offutt	
2. Present Name Webb Store		24. UTM Reference 1 7 B 4 7 8 0 0 4 1 8 1 8 2 0	
3. Location Van Lear, Ky.		Zone Easting Northing	
4. Owner's Name Herman Webb		25. Coordinate Accuracy	
5. Owner's Address Van Lear, Kentucky		26. Prehistoric Site Object Historic Site Structure <input checked="" type="checkbox"/> Building Other	
6. Open to Public Yes <input type="checkbox"/> No <input type="checkbox"/>	7. Visible from road Yes <input checked="" type="checkbox"/> No <input type="checkbox"/>	B. Ownership Private <input checked="" type="checkbox"/> Local <input type="checkbox"/> State <input type="checkbox"/> Federal <input type="checkbox"/>	
9. Local Contact/Organization JOHNSON COUNTY HISTORIC SITES SURVEY COMMITTEE		27. National Register District Name	
10. Site Plan with North Arrow		28. Significance Evaluation National Register Criteria <input checked="" type="checkbox"/>	
		11. Architect Unknown	
		12. Builder Unknown	
		13. Date 1918 A <input checked="" type="checkbox"/> B <input type="checkbox"/>	
		14. Style A. Vernacular <input checked="" type="checkbox"/> B. <input type="checkbox"/>	
		15. Original Use Commercial <input type="checkbox"/>	
		16. Present use Commercial <input type="checkbox"/>	
		17. Condition Good <input checked="" type="checkbox"/>	
18. Description Two story, three bay commercial building; high wood parapet; original first floor window pattern; flat roof; built in 1918 with the opening of #5 mine.		29. Status National Landmark <input type="checkbox"/> National Register <input type="checkbox"/> Landmark Certificate <input type="checkbox"/> Kentucky Survey <input type="checkbox"/> Local Landmark <input type="checkbox"/> HABS/HAER <input type="checkbox"/>	
(Continue on Back)		30. Historic Theme Primary <input type="checkbox"/> Secondary <input type="checkbox"/> Other <input type="checkbox"/>	
19. History At the turn of the century, Miller's Creek was a farming community. By 1911, Consolidation Coal Company had transformed the area into a coal company town. The town was named for Van Lear Black, the president of Fidelity and Deposit Co. of Maryland. (Cont. on back)		31. Endangered Yes <input type="checkbox"/> No <input type="checkbox"/>	
20. Significance The Mine #5 Store is significant as an example of the frame architecture built by the coal companies in coal company towns such as Van Lear.		32. Preservation Project Status <input type="checkbox"/>	
21. Source of Information		Actual Cost in \$1,000s <input type="checkbox"/>	
		33. ATTACH PHOTO 	
		Roll No. _____ Picture No. _____ Direction _____	
		34. Prepared by: HELEN POWELL	
		35. Organization CARMAN AND POWELL, INC.	
		36. Date 1983	
		37. Revision Dates _____ 38. Staff Review _____	

19. History continued:

Consolidation Coal Company began operation in Maryland in 1864. By 1901, it had mines in West Virginia and in 1903, in Pennsylvania. The Miller Creek Division in Johnson County began in 1911 with 100,000 ac.

By 1918, Van Lear was a bustling town of 2500. Located about 4 miles from Paintsville, it had a picture show, billard and pool room, soda fountain, churches, schools, barber shop and other conveniences of larger towns.

Two large general stores were located in Van Lear. One was at the center of town near the post office and other main office buildings. The other was near the opening of mine No. 5 which began in 1918.

**KENTUCKY HISTORIC RESOURCE INVENTORY SUPPLEMENT
BOUNDARY AND LOCATION INFORMATION**

Historic Property Name Mine #5 Store Site # Jo-43

Multiple Resource/Thematic Nomination Title MULTIPLE RESOURCES OF JOHNSON COUNTY

U.T.M. Coordinates - List multiple UTM's if property is ten or more acres.

A. _____ D. _____

B. _____ E. _____

C. _____ F. _____

Verbal Boundary Description Acreage .18

From a point in the south right of way of KY 302; then south 70 feet to a point; then west 117 feet to a point; then 70 feet north to a point in the south right of way of KY 302; then east along the right of way of KY 302 to the point of beginning.

The boundary contains the space associated with the Mine#5 Store and one contributing building.

Sketch of Site Plan (Showing outbuildings, structures, landscape features and the site boundary as described above.)

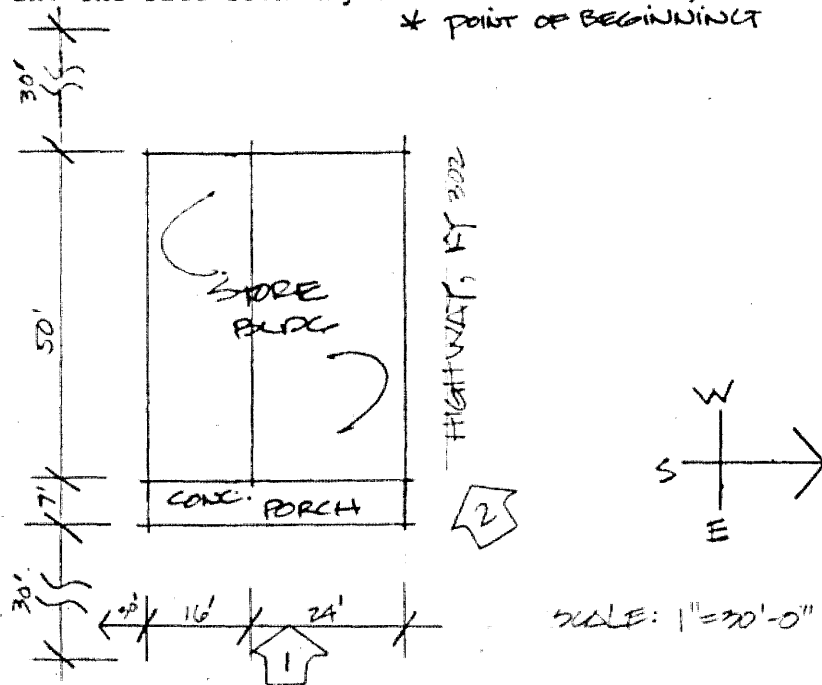

Official Courthouse Property Reference: