

United States Department of Interior
National Park Service
National Register of Historic Places
Registration Form

This form is for use in nominating or requesting determinations of eligibility for listing in the National Register of Historic Places. See instructions in *How to Complete the National Register of Historic Places Registration Form* (National Register Bulletin 16A). Complete each item by marking "x" in the appropriate box or entering the information requested. If an item does not apply to the property being documented, enter "N/A" for "not applicable." For functions, architectural classification, materials, and areas of significance, enter only categories and subcategories from the instructions. Place additional entries and narrative items on continuation sheets (NPS Form 10-900A). Use a typewriter, word processor, or computer, to complete all items.

1. Name of Property

historic name Plana School
other names/site number N/A

2. Location

street & number 7 mi. north of Hwy 12 and 1 mi. east of Hwy 16
N/A not for publication
city or town Plana, Cambria Township x vicinity
state South Dakota code SD county Brown code 013 zip code 57

3. State/Federal Agency Certification

As the designated authority under the National Historic Preservation Act, as amended, I hereby certify that this nomination request for determination of eligibility meets the documentation standards for registering properties in the National Register of Historic Places and meets the procedural and professional requirements set forth in 36 CFR Part 60. In my opinion, the property meets does not meet the National Register criteria. I recommend that this property be considered significant nationally statewide locally. (See continuation sheet for additional comments.)

 /SHAD
Signature of certifying official/Title

5-16-95
Date

State or Federal agency and bureau

In my opinion, the property meets does not meet the National Register criteria.
(See continuation sheet for additional comments.)

Signature of certifying official/Title

Date

State of Federal agency and bureau

Entered in the
National Register

4. National Park Service Certification

- I hereby certify that the property is:
 entered in the National Register.
 See continuation sheet.
- determined eligible for the National Register.
 See continuation sheet.
- determined not eligible for the National Register.
 See continuation sheet.
- removed from the National Register.
- other, (explain:)

Signature of the Keeper
Raymond Kappley

Date of Action
7/7/95

Plana School
Name of Property

Brown, South Dakota
County and State

5. Classification

Ownership of Property (check as many boxes as apply)	Category of Property (Check only one box)	Number of Resources within Property (Do not include listed resources within the count)
<input type="checkbox"/> private	<input checked="" type="checkbox"/> building(s)	Contributing Noncontributing
<input checked="" type="checkbox"/> public-local	<input type="checkbox"/> district	<u> 2 </u> buildings
<input type="checkbox"/> public-state	<input type="checkbox"/> site	_____ sites
<input type="checkbox"/> public-federal	<input type="checkbox"/> structure	_____ structures
	<input type="checkbox"/> object	_____ objects
		<u> 2 </u> <u> 0 </u> Total

Name of related multiple property listing (Enter "N/A" if property is not part of a multiple property listing.)

Number of contributing resources previously listed in the National Register

Rural Architectural and Historical Resources of Brown County, South Dakota

 0

6. Function or Use

Historic Functions
(Enter categories from instructions)

Current Functions
(Enter categories from instructions)

EDUCATION/School

GOVERNMENT/City Hall

7. Description

Architectural Classification
(Enter categories from instructions)

Materials
(Enter categories from instructions)

LATE 19TH AND EARLY 20TH CENTURY AMERICAN MOVEMENTS/BUNGALOW/CRAFTSMAN

foundation concrete
walls weatherboard
roof wood shingle
other glass

Narrative Description

(Describe the historic and current condition of the property on one or more continuation sheets.)

8. Statement of Significance

Applicable National Register Criteria
(Mark "x" in one or more boxes for the criteria qualifying the property for the National Register listing.)

Areas of Significance
(Enter categories from instructions)

A Property is associated with events that have made a significant contribution to the broad patterns of our history.

Architecture

B Property is associated with the lives of persons significant in our past.

Period of Significance

C Property embodies the distinctive characteristics of a type, period, or method of construction or represents the work of a master, or possesses high artistic values, or represents a significant and distinguishable entity whose components lack individual distinction.

1912

Significant Dates

1912

D Property has yielded, or is likely to yield, information important in prehistory or history.

Plana School
Name of Property

Brown, South Dakota
County and State

Additional Documentation

Submit the following items with the completed form:

Continuation Sheets

Maps A USGS map (7.5 or 15 minute series) indicating the property's location.
A sketch map for historic districts and properties having large acreage or numerous resources.

Photographs Representative black and white photographs of the property.

Additional Items (Check with the SHPO or FPO for any additional items)

Property Owner

Complete this item at the request of SHPO or FPO.)

name Cambria Township c/o Ron Ringgenberg
street & number RR 1 Box 118 telephone 605/229-0632
city or town Columbia state South Dakota zip code 57433

Paperwork Reduction Act Statement: This information is being collected for applications to the National Register of Historic Places to nominate properties for listing or determine eligibility for listing, to list properties, and to amend existing listings. Response to this request is required to obtain a benefit in accordance with the National Historic Preservation Act, as amended (16 U.S.C. 470 et seq.).

Estimated Burden Statement: Public reporting burden for this form is estimated to average 18.1 hours per response including time for reviewing instructions, gathering and maintaining data, and completing and reviewing the form. Direct comments regarding this burden estimate or any aspect of this form to the Chief, Administrative Services Division, National Park Service, P.O. Box 37127, Washington, DC 20013-7127; and the Office of Management and Budget, Paperwork Reductions Projects, (1024-0018), Washington, DC 20503.

NPS Form 10-900-a
(Rev. 8-86)
Wisconsin Word Processing Format
(Approved 1/92)

United States Department of the Interior
National Park Service

**National Register of Historic Places
Continuation Sheet**

Section 7 Page 1

Plana School, Plana, Cambria Township, Brown
County, South Dakota

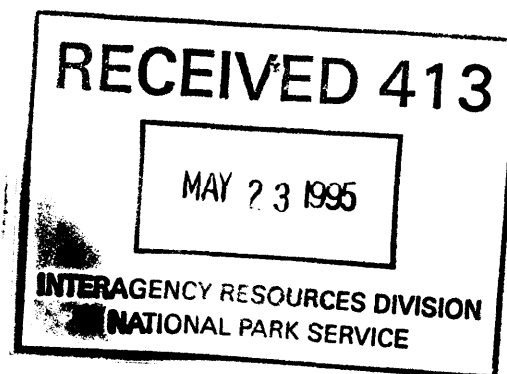

Section 7: Architectural Description

The Plana School is located in Plana, Cambria Township of Brown County, South Dakota one mile east of County Highway 16 in Section 29 of Township 124 North and Range 62 West. The frame, one-story, two-room school is designed in the Craftsman Style and is located in a rural area which was once the village of Plana. The building has a rectangular plan and is constructed with a concrete block foundation, horizontal weatherboard siding about four inches wide, painted white, and a hipped roof covered with wood shingles and exhibiting exposed rafter ends. In addition to the school the site includes a frame outhouse, directly behind (to the west) the school along a concrete sidewalk, and abandoned playground equipment also located behind the school. A concrete sidewalk leads from the road to the main entrance of the school. Although the building is used infrequently the grounds are maintained.

Plana School
1912
Contributing

The main (east) facade of the building exhibits a central double door entrance with an open gable hood with brackets and a rounded metal ridge top ornament. The wooden entrance doors display nine pane glass over three vertical panels, and a five pane glass transom above the double doors. Four concrete stairs lead to the main entrance and to the north there is a modern wooden handicap ramp with handrails. Detailing on the main facade includes corner boards and a rectangular section outlined by wider wooden boards on either side of the entry way that wrap around the north and south sides of the building, in addition to a wide (about ten inches) horizontal board at the foundation line. A wooden engraved sign to the south of the entrance to the school reads, "Plana School, Davis School, Everson School, Griffith School, In Memory of Students and Teachers." The schools cited were other rural schools in Cambria Township.

United States Department of the Interior
National Park Service

**National Register of Historic Places
Continuation Sheet**

Section 7 Page 2

Plana School, Plana, Cambria Township, Brown
County, South Dakota

The north elevation contains a band of five tall and narrow windows, that display nine-over-three sashes. Detailing on the north elevation includes corner boards, a wood water table at the foundation line and the rectangular outlined section whose base is parallel to the bottom sill line of the windows. At the foundation line there are also two small basement windows.

The rear (west) elevation has an interior brick chimney centrally located on the west side of the roof. The rear elevation contains three small upper level windows to the north, with three vertical panes, a centrally located rear exit displaying five horizontal panels, and a tall narrow window to the south of the door that displays nine-over-three sashes. The rear elevation continues to feature corner boards, the wide band at the foundation line and the defined rectangular section across the middle of the entire elevation and at the foundation line there are two small basement windows.

The south elevation is identical to the north elevation. It features the five tall and narrow windows with nine panes over three vertical panes, as well as corner boards, the wide board at the foundation line and the definition of the rectangular middle section. The foundation also contains two small basement windows.

The interior space of the building includes a full basement, two classrooms, vestibule, bathroom, and hallway on the main level. The entryway vestibule has a wooden floor with narrow floor boards about four inches wide and modern wood paneling on the walls. From the main entrance one enters a vestibule and then through a set of double doors to a central hallway. The doors are identical to the main entrance doors, with nine panes over three vertical panels and a glass transom. To the south of the hallway there is large classroom and to the north the classroom has been divided by a modern partition which allows for a bathroom and sink area in the northwest corner of the building. Immediately to the west of the hallway there is a storage closet to the south and stairs to the basement on the north side. The majority of the interior doors are wide wooden and display five horizontal panels. The rest room facilities have a modern slab

United States Department of the Interior
National Park Service

**National Register of Historic Places
Continuation Sheet**

Section 7 Page 3

Plana School, Plana, Cambria Township, Brown
County, South Dakota

door installed at the time of the alterations. The southern classroom displays a chalkboard on the west and east walls, a bulletin board on the north wall and a span of windows on the southern wall and features wood floors and plaster walls. The basement is used for storage and the original coal furnace, converted to oil, remains in use.

Outhouse

Ca. 1912

Contributing

The frame outhouse is located to the west of the school and there is a concrete path from the rear entrance to the outhouse. The two-seater outhouse has a concrete foundation, a shed roof covered in metal sheeting, and displays wide weatherboard siding and corner boards. The entrance door is located on the southern side and is constructed of vertical boards. Small open windows are located on the east and the west sides for ventilation. The outhouse is in fair condition and contributes to the architectural character of the Plana School.

The grounds of the school also contain playground equipment on the north and west sides of the building including two metal swing sets with slides and a teeter-totter. The school building remains in excellent condition despite the fact that it was closed in the 1960s and is currently being used only a few times a year.

United States Department of the Interior
National Park Service

**National Register of Historic Places
Continuation Sheet**

Section 8 Page 1

Plana School, Plana, Cambria Township, Brown
County, South Dakota

Section 8: Statement of Significance

The rural Plana School is located in Cambria Township and was once located near the village of Plana. Today the only other indication of the town is the Welsh Presbyterian Church which is located to the west of the school. The two-room, frame Plana School was designed in the Craftsman Style and is eligible for the National Register of Historic Places under Criterion C: Architecture. The Plana School can be placed in the historic context "Depression and Rebuilding (1893-1929): Civic Improvement and New Government-Related Structures" as defined by the South Dakota State Historical Preservation Center in *Historic Contexts for Historic and Architectural Resources in South Dakota*. The Plana School can also be placed within the Multiple Property Document, "Rural Architectural and Historical Resources of Brown County, South Dakota."

History of Area

Cambria Township was settled in 1878 (Brown County Territorial Pioneer Committee, 79). Plana was established in 1887, following the placement of the Great Northern Railroad, now Burlington Northern Railroad, through the township. Welsh settlers came from Wisconsin to settle in the area after hearing about the rich soil and available land from the railroad agents. The first name of the town was Hadley, but since that was the name of another town in the territory the name was changed to Plana. The name Plana may have derived from the Plana (or Plano) Manufacturing Company of Chicago, Illinois that had intended to establish a manufacturing plant there to produce horse-drawn farming equipment, but never materialized. In the late 1880s the development of the village began with the construction of a store by D.D. Jones in 1887 (not extant), the establishment of the post office the same year and the construction of the Welsh Presbyterian Church (extant)¹. The village grew to include three

¹See Welsh Presbyterian Church National Register Nomination, prepared in 1994.

United States Department of the Interior
National Park Service

**National Register of Historic Places
Continuation Sheet**

Section 8 Page 2

Plana School, Plana, Cambria Township, Brown
County, South Dakota

grain elevators, a depot, community hall, school, barber shop and several residences (Sneve ca.1950s, 119; Brown County Territorial Pioneer Committee 1970, 79; Brown County Museum and Historical Society 1980, 48-49, 338-339). The general store burnt in 1927 and the town gradually declined after that time ("Brown County Towns File - Plana," Dacotah Prairie Museum). In 1994 the only structures that remain to indicate that the village of Plana once existed are the community hall, now a garage, the Welsh Presbyterian Church and the Plana School.

Plana School

The Plana School, constructed in 1912, was first open for the 1912-1913 school year and was the fourth frame schoolhouse in District 15, Cambria Township. The *Superintendent Annual Reports of Brown County 1912-1913* recorded the erection of a new frame schoolhouse during that school year and the Plana School became the only two-room school in the township, as the other three schools had only one-room (*Superintendent Annual Report, Brown County 1912-1913*). The total value of houses, sites and furniture in the Cambria school district totalled \$3,000 in 1912, but with the erection of the Plana School the total value increased to \$5,000 in 1913 (*Superintendent Annual Report, Brown County, 1911-1912 and 1912-1913*). The four schools remained in use through 1920, at which time the *Superintendent Annual Report for 1921-1922* reported that only three of the four schoolhouses were being utilized (*Superintendent Annual Report, Brown County 1921-1922*).

The Plana School's first teachers were Hazel Wolcott and Margaret Griffith and the enrollment of students was thirty-five. Over the early years of the school the attendance of the two classrooms averaged between 20 and 30 students (*Teachers Term Reports 1912-1927*). The school closed during the 1960s as a result of the consolidation of schools in Brown County.

United States Department of the Interior
National Park Service

**National Register of Historic Places
Continuation Sheet**

Section 8 Page 3

Plana School, Plana, Cambria Township, Brown
County, South Dakota

Since the school closed the building, which is owned and maintained by Cambria township, it has been used for township meetings and until recently was also being used as an election day polling place.

Architecture

The Plana School, Town of Plana, is a strong example of a rural two-room schoolhouse in Brown County. The rural school, as a building type, has been continuously vanishing from the rural landscape, particularly as a result of the consolidation of schools. The movement to consolidate schools encouraged the construction of larger schools, and thus forced the smaller rural schools to close and became vacant.

It is very likely that the design of the Plana School was based on a standard plan for rural schools which were common in the late nineteenth century and continued popularity into the twentieth century (Gulliford 1984, 166-167). By the twentieth century, the plan books, which had largely been commercial publications, were being issued by state and federal educators. The plans of the twentieth century often called for hipped roofs and the placement of windows on one side of the room, close together to produce the effect of one large window. The Plana School displays both the hipped roof and bands of windows on the north and south elevations, providing light for each of the classrooms.

In addition to the national trend to use standard plans for schools, the South Dakota legislature passed, in 1907, Section 237 of Article XV: "Plans for school buildings approved by State Superintendent." The law called for strict standards in the design of schools to provide a healthy environment for the school children, forcing the rural schools, in particular, to meet certain standards for heating, ventilating and lighting. The *Eleventh Biennial Report of the Superintendent of Public Instruction of the State of South Dakota* even included standard plans that incorporated the required elements. There is no doubt that the plans for the Plana School were effected by this

United States Department of the Interior
National Park Service

**National Register of Historic Places
Continuation Sheet**

Section 8 Page 4 Plana School, Plana, Cambria Township, Brown
County, South Dakota

legislation, and it is likely that the school design was based on similar approved standard plans (*Eleventh Biennial Report 1912*, 151).

By the 1920s the plan book schools were mostly architect-designed and a number of the school designs features "creat(ed) a striking resemblance to bungalow houses of the same period" (Gulliford 1984, 194). The Plana School, although not verified as a standard plan school, represents the principles and the popular style of the time period. The Plana School depicts a number of the architectural features that are used in the Craftsman/Bungalow Style. For example the low pitched hipped roof, the wide overhanging eaves, the multiple pane doors, the multiple pane windows, and the exposed rafter ends are all dominant design features of the Craftsman Style that are depicted in the Plana School.

In conclusion, the Plana School in the Town of Plana is a legacy to rural education in Brown County and is an excellent example of a rural two-room school designed in the Craftsman Style. The school has undergone very few exterior alterations and minor interior alterations allowing it to retain its original integrity.

United States Department of the Interior
National Park Service

**National Register of Historic Places
Continuation Sheet**

Section 9 Page 1 Plana School, Plana, Cambria Township, Brown
County, South Dakota

Section 9: Bibliography

- Brown County Territorial Pioneer Committee. *Early History of Brown County, South Dakota*. Aberdeen, SD: North Plains Press, 1970.
- Butler, W.P. *Map of Brown County*. Aberdeen, South Dakota: News Printing Company. 1918. Located at the Aberdeen Public Library, South Dakota.
- Dacotah Prairie Museum. Brown County Towns Box, Plana and Bath Township Files. Located in the collection of the Dacotah Prairie Museum, Aberdeen, South Dakota.
- Doak Company. *Brown County Plat Map*. Aberdeen, South Dakota: The Doak Company. 1923. Located at the Aberdeen Public Library, South Dakota.
- Eleventh Biennial Report of the Superintendent of Public Instruction of the State of South Dakota*. July 1, 1910-June 30, 1912. Aberdeen, SD: News Printing Company. 1912.
- Gulliford, Andrew. *America's County Schools*. Washington D.C.: The Preservation Press, 1984.
- History Committee of Brown County Museum and Historical Society. *Brown County History*. Aberdeen, SD: North Plains Press, 1980.
- Kooiman, Barbara M. and Mary Kay Schmidt, U.S. West Research, Inc. "A Survey of Standing Structures in Southwestern Brown County, South Dakota, Final Project Report." 1992. Prepared for the Aberdeen/Brown County Historic Preservation Commission, Aberdeen, South Dakota.
- Sneve, Virginia Driving Hawk. *South Dakota Geographic Names*. Sioux Falls, South Dakota: South Dakota Department of Agriculture. ca.1950s.

NPS Form 10-900-a
(Rev. 8-86)
Wisconsin Word Processing Format
(Approved 1/92)

United States Department of the Interior
National Park Service

**National Register of Historic Places
Continuation Sheet**

Section 9 Page 2 Plana School, Plana, Cambria Township, Brown
County, South Dakota

South Dakota Historical Preservation Center. *Historic Contexts
for Historic and Architectural Resources in South Dakota.*
Vermillion, South Dakota: South Dakota Historical
Preservation Center. 1989.

Superintendent Annual Reports, Brown County, 1911-1923.
Microfilm: Elementary and Secondary Education Statistical
Services, Superintendent Annual Reports. Located at the
South Dakota State Archives, Pierre, South Dakota.

*Teachers Term Reports, Plana School, Cambria Township, District
No. 15, Brown County, 1912-1930.* Unsorted collections of
Brown County School Records located at South Dakota State
Archives, Pierre, South Dakota.

NPS Form 10-900-a
(Rev. 8-86)
Wisconsin Word Processing Format
(Approved 1/92)

United States Department of the Interior
National Park Service

**National Register of Historic Places
Continuation Sheet**

Section 10 Page 1

Plana School, Plana, Cambria Township, Brown
County, South Dakota

Section 10: Geographical Data

Verbal Boundary Description

The Plana School is located in the Southeast 1/4 of Section 29 of Township 124 North and Range 62 West. Lot number 6 of the plat of the Original Town of Plana.

Boundary Justification

The boundary of the Plana School encompasses the area of the school, outhouse and play equipment that were historically associated with the property.

United States Department of the Interior
National Park Service

**National Register of Historic Places
Continuation Sheet**

Section Photos Page 1

Plana School, Plana, Cambria Township, Brown
County, South Dakota

Photographs:

The following information applies to all photographs.

Plana School
Town of Plana, Cambria Township
Brown County, South Dakota
Photographer: Barbara M. Kooiman, U.S. West Research, Inc.
Date: July 1994
Negatives located at the State Historical Preservation Office,
Vermillion, South Dakota

Photo #1 of 8
Exterior, entrance, east elevation
Photographer facing west

Photo #2 of 8
Exterior, east and south elevations
Photographer facing northwest

Photo #3 of 8
Exterior, south and west elevations
Photographer facing northeast

Photo #4 of 8
Exterior, west elevation
Photographer facing east

Photo #5 of 8
Exterior, west and north elevations
Photographer facing southeast

Photo #6 of 8
Exterior, north and east elevations
Photographer facing southwest

Photo #7 of 8
Exterior, outhouse
Photographer facing northeast

NPS Form 10-900-a
(Rev. 8-86)
Wisconsin Word Processing Format
(Approved 1/92)

United States Department of the Interior
National Park Service

**National Register of Historic Places
Continuation Sheet**

Section Photos Page 2

Plana School, Plana, Cambria Township, Brown
County, South Dakota

Photo #8 of 8
Interior, entrance vestibule detail
Photographer facing east

**Plana School
Plana, Cambria Township
Brown County, South Dakota**

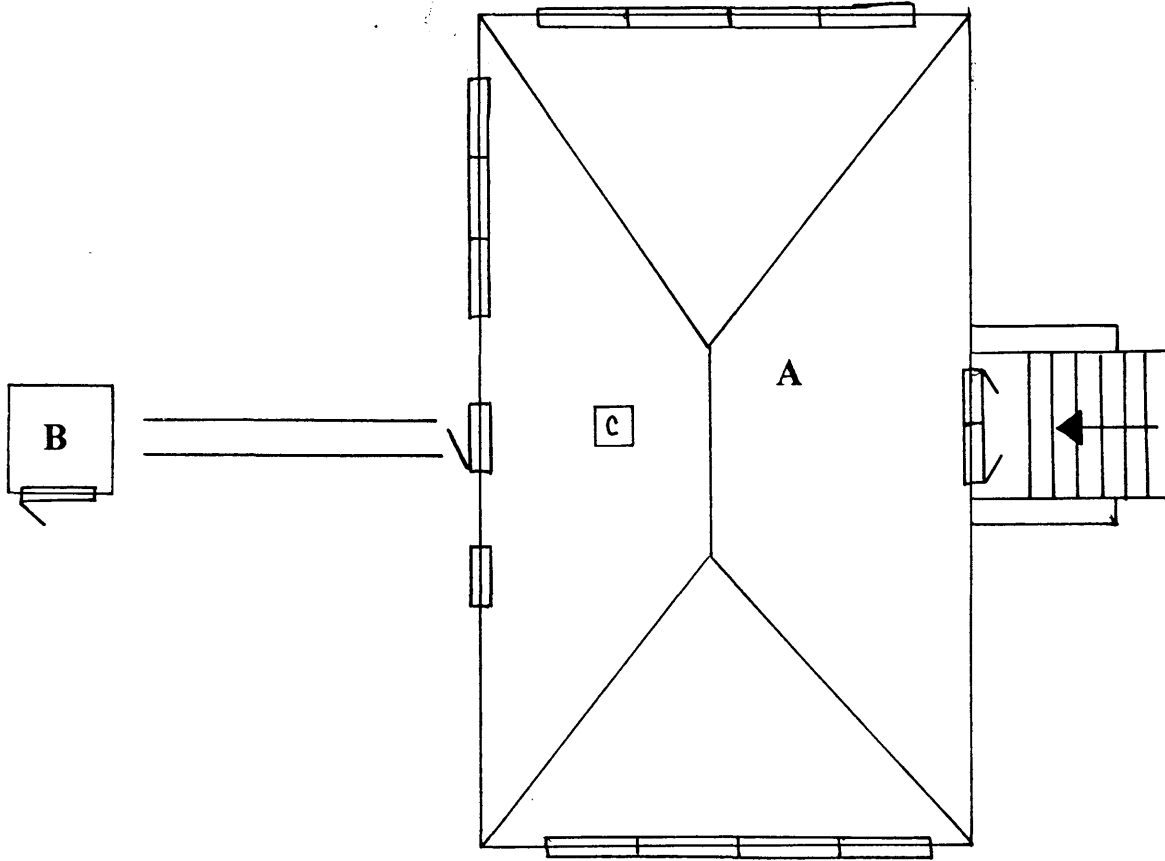
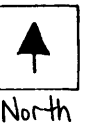

A = School (contributing)
B = Outhouse (contributing)