

DEC 8 1988

3315

KENTUCKY HISTORIC RESOURCES
Individual Inventory Form

Resource # 45
Madison County

1. Name of Resource: Moberly House

2. Original Owner: James Moberly

3. Other Names: N.A.

4. Prehistoric Site _____ Building _____ Object _____
Historic Site _____ Structure Other _____

5. Location: .3 mile North of Old Hwy. 52
North of Moberly.

6. Owner's Name: Mrs. Harold Moberly [P]

7. Owner's Address: Rt. 8, Box 92
Richmond, KY 40475

8. Evaluation: [N]

9. Recognition & Date:
Nat.Landmark _____ Local Landmark _____
Nat.Register _____ HABS/HAER _____
Highway Marker _____ KY Inventory 1979
KY Landmark Certificate _____

10. N.R.Status & Date: _____

11. N.R.Group:
District Name: []
Mult.Resource Area: Madison County []
Thematic Name: []

12. Historical Theme:
Primary: Architecture [030]
Secondary: []
Other: []

13. Statement of Significance:

See attached.

[A]

16. Date:
Original Building 1800-1824 [B]
Addition 1825-1849 [7]

17. Style:
Settlement Vernacular [2v]
Greek Revival [31]

18. Architect/Builder: Unknown

19. No. of Stories: [2.0]

20. Original Floor Plan: Single Pen; Rectangular [1R]

21. Single Pile Double Pile _____ N.A. _____

22. Roof Form & Material: Original
Gable/Raised seam tin Not Original

23. Structural Material: Log [L]

24. Exterior Material: Frame/Weatherboard [W]

25. Foundation Material: Stone [S]

26. Major Alterations: None
Moved/Rebuilt Other _____
Additions

27. Special Features: N.A.

28. Outbuildings: Log Office []

29. Original Function: Single Dwelling [01A]

30. Present Use: Single Dwelling []

31. Condition: Good [G]

32. Endangered: Yes _____
No

33. Attach Photos:
Roll: Photo Nos: No. of Slides:



14. History:
The first Moberlys in Madison County were John, Benjamin, and Edward who came to this area from South Carolina in 1790. James Moberly was the first owner of this land and was followed by Dr. Tom Moberly. The land for the Flat Woods Christian Church was donated off this land in 1815.

15. Source of historical information and/or contact person:
DAR Place Names

34. Prepared by: S. Willis and H. Powell

35. Organization: Madison County His. Society

36. Date: 1985

37. New Survey _____ Resurvey

KENTUCKY HISTORIC RESOURCES
 Individual Inventory Form

Resource # 45

38. UTM Point of Primary Building: Zone Easting Northing 39. G.I.S. Mod. []
 Quadrant: Moberly 16 749700 4181130 40. Coordi.Accuracy []

41. UTM Points of Boundary (for N. R. eligible sites only):

A.	---	---	---	D.	---	---	---
B.	---	---	---	E.	---	---	---
C.	---	---	---	F.	---	---	---

42. Total Acreage in Present Property: _____ 43. Acreage included in proposed N.R. boundary: _____

44. Site Plan (and boundary description and justification for N.R. sites):

See Attached.

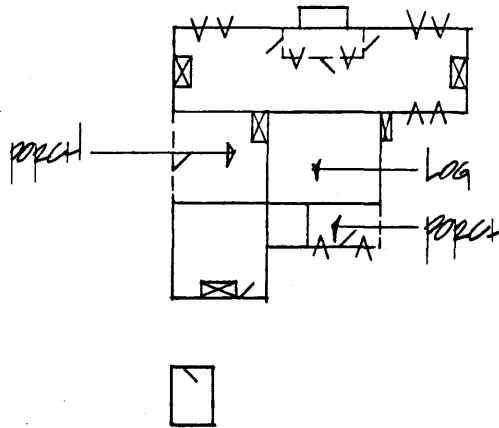

45. Description and House Plan:

The Moberly House was originally a log rectangular pen, two stories in height with massive exterior stone chimneys. In the mid 19th century a two story frame dwelling was added to log structure. The front or southwest facade is seven bays. The central three bays, containing a central door flanked on either side by a window is recessed 10-12 feet behind other bays. The central doorway is contained in elaborate entablature and architrave with pilasters and fluted ionic columns. The recessed porch has been screened in. Doors open to front rooms off east and west sides of porch. The Greek Revival portion of house has interior brick end chimneys and a limestone foundation. Windows are 6/6 with drip moldings. The shed porches on northeast facade have been enclosed.*

*Site Plan - To the northeast of the residence is a rectangular pen, 1 bay, log building made of Hewn logs with full dovetail notches.



KENTUCKY HISTORIC RESOURCE INVENTORY SUPPLEMENT
BOUNDARY AND LOCATION INFORMATION

Historic Property Name Moberly House Site # Ma 45
Multiple Resource/Thematic Nomination Title MULTIPLE RESOURCES OF MADISON
COUNTY, KENTUCKY

U.T.M. Coordinates - List multiple UTMs if property is ten or more acres.

A. _____ D. _____
B. _____ E. _____
C. _____ F. _____

Verbal Boundary Description _____ Acreage 1.3

From the northwest corner of the building, north 23 feet and west 210 feet to a point of beginning; then east 348 feet to a point; then south 164 feet to a point; then west 348 feet to a point; then north 164 feet to the point of beginning.

Sketch of Site Plan (Showing outbuildings, structures, landscape features and the site boundary as described above.)

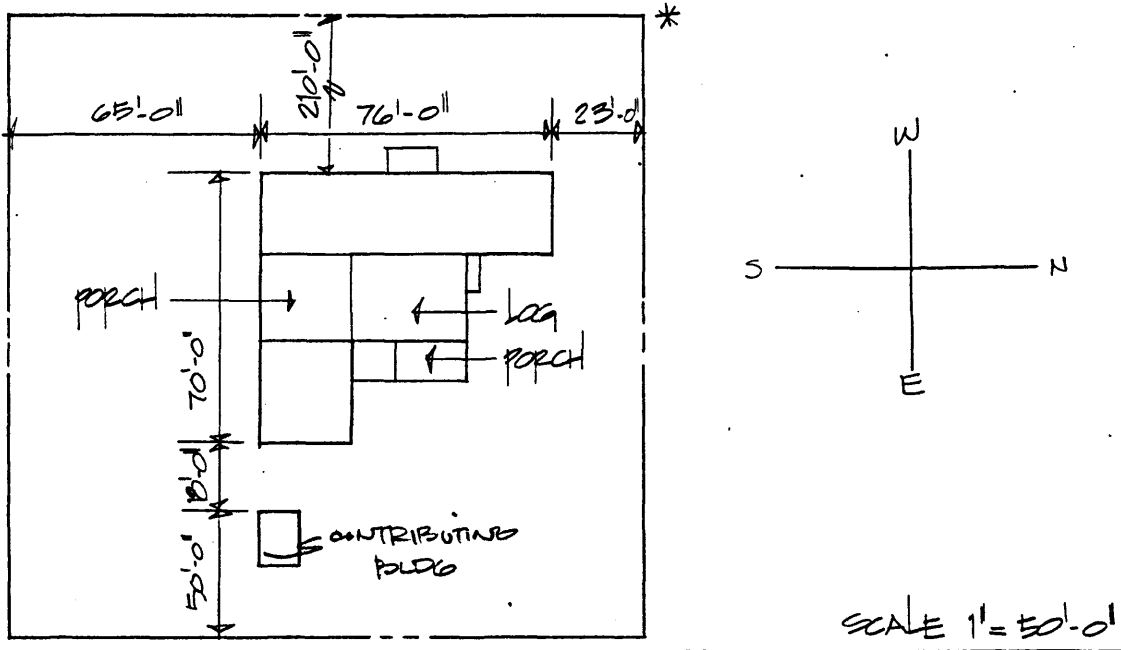

Official Courthouse Property Reference:

Page 4 of 4
Ma-45
Moberley House

Statement of Significance

The Moberly House is significant under criterion C for the period ca. 1820 to 1840 to demonstrate how rectangular pen log houses were incorporated into newer houses when the owner decided to rebuild. The log section became an ell and the new addition was placed closer to the road. The outbuilding dates from the period of the addition.

Verbal Boundary Justification

The boundary was chosen to provide a minimal setting for the house and to include all of contributing domestic buildings.

The boundary contains two contributing buildings.

United States Department of the Interior
National Park Service

National Register of Historic Places
Continuation Sheet

Section number _____ Page _____

SUPPLEMENTARY LISTING RECORD

NRIS Reference Number: 88003315

Date Listed: 2/8/89

Moberly House
Property Name

Madison
County

KY
State

Madison County MRA
Multiple Name

This property is listed in the National Register of Historic Places in accordance with the attached nomination documentation subject to the following exceptions, exclusions, or amendments, notwithstanding the National Park Service certification included in the nomination documentation.

Patrick Andrus
Signature of the Keeper

2/8/89
Date of Action

=====
Amended Items in Nomination:

On the nomination form this building is incorrectly listed as a structure. Marty Perry with the KY SHPO says that this was an oversight. The form is now officially amended to list this as a building.

DISTRIBUTION:

- National Register property file
- Nominating Authority (without nomination attachment)